

**SHEET NOTES**

- 01 CONTRACTION/CONSTRUCTION JOINT. RE: STRUCTURAL DRAWINGS FOR MORE INFORMATION.
- 02 FLOOR SENSOR FOR OVERHEAD DOOR. RE: PROJECT MANUAL SECTION 08 33 23 FOR MORE INFORMATION.
- 03 DOCK LEVELER PIT. RE: STRUCTURAL DRAWINGS FOR PIT LOCATIONS AND DIMENSIONS. COORDINATE WITH EQUIPMENT.
- 04 PIPE BOLLARD. RE: DETAIL 11/A12.15
- 05 BAGGAGE EQUIPMENT. RE: BAGGAGE DRAWINGS FOR MORE INFORMATION.
- 06 ESCALATOR PIT. RE: STRUCTURAL FOR PIT LOCATIONS AND DIMENSIONS
- 07 ELEVATOR PIT. RE: STRUCTURAL FOR PIT LOCATIONS AND DIMENSIONS.
- 08 TRENCH DRAIN AT BOTTOM OF RAMP. REFER TO ENGINEERING DRAWINGS C02 SERIES
- 09 AREA OF FILL UNDERNEATH STAIR SLAB. RE: STRUCTURAL DRAWINGS
- 10 ALL EXISTING COLUMNS IN BAGGAGE OUTBOUND TO HAVE 48" AFF CONCRETE PIER. FORM NEW CONCRETE PIER OVER EXISTING CONCRETE PIER AS REQUIRED TO ACHIEVE 48" AFF. RE: DETAIL 1 & 2/A12.70 AND STRUCTURAL DRAWINGS.
- 11 ALL NEW COLUMNS IN BAGGAGE OUTBOUND TO HAVE 48" AFF CONCRETE PIER. RE: DETAIL 1 & 2/A12.70 AND STRUCTURAL DRAWINGS.
- 12 FIRE/SECURITY OVERHEAD COILING DOOR. RE: BAGGAGE DRAWINGS FOR DETAILS AND MORE INFORMATION. COORDINATE WALL AND FIRE/SECURITY DOOR LOCATIONS WITH BAGGAGE DRAWINGS. PROVIDE FURRING TO MAINTAIN RATING OF WALL AND PROVIDE FINISHED WALL PERPENDICULAR TO BAG BELT TYPICAL FOR INSTALLATION OF COILING DOOR.
- 13 PBB PEDESTAL. RE: STRUCTURAL DRAWINGS FOR FOUNDATION DETAIL AND SIZE.
- 14 PROVIDE METAL OXIDE WATERPROOFING ON ALL EXTERIOR WALLS OF PIT.
- 15 EXISTING PBB PEDESTAL TO REMAIN.
- 16 ALL EXISTING TO REMAIN. ROOM TO BE USED BY OWNER FOR BHS STORAGE AND MAINTENANCE
- 17 GUARDRAIL. REFER TO 2/A12.20 FOR ADDITIONAL INFORMATION
- 18 PIPE GUARD @ WALL
- 19 PIPE GUARD @ COLUMN
- 20 SUMP PIT. RE: STRUCTURAL DRAWINGS.
- 21 EMBED ANGLES ON TOP EDGE OF CONCRETE CURB TO TAKE IMPACT
- 22 EXISTING DOOR
- 23 PROVIDE STEEL TUBE GUARD RAIL 3' - 6" HIGH AT RETAINING WALLS. VERTICALS TO BE SLEEVED INTO CONCRETE WALL

**Portland International Jetport**

1001 Westbrook Street  
Portland, Maine 04102

**Gensler**

2020 K Street, Northwest  
Suite 200  
Washington DC 20006  
Telephone 202.721.5200  
Facsimile 202.872.8587

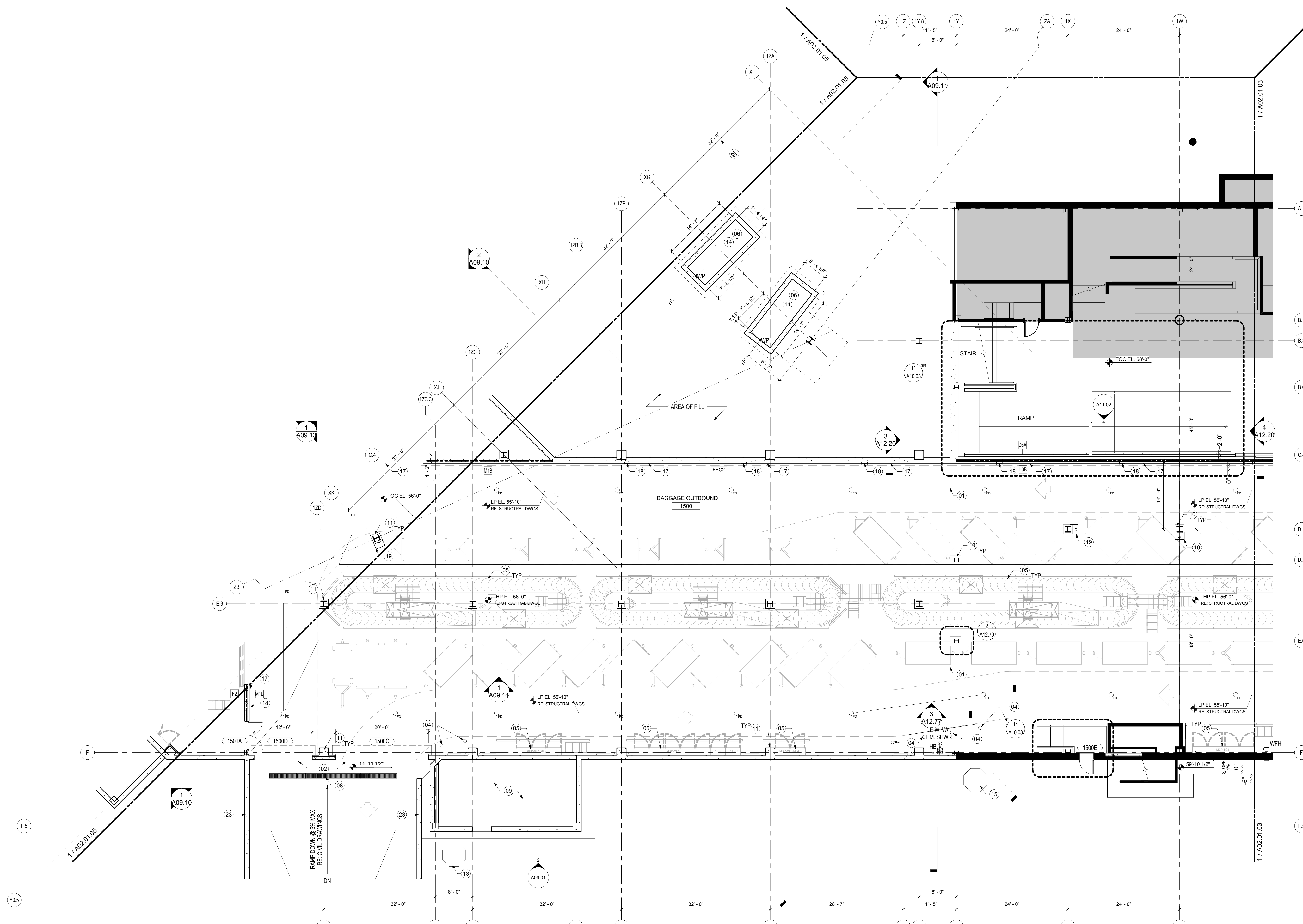

**GENERAL NOTES**

- A NOT IN CONTRACT (NIC)
- B ALL COLUMNS TO BE FIREPROOFED, TYP. RE: PROJECT MANUAL SECTION 07 81 00
- C HATCHED WALLS INDICATE RATING REQUIREMENT. RE: A00.12 FOR GRAPHIC SYMBOLS
- D ALL BAGGAGE CONVEYORS SHOWN FOR REFERENCE ONLY
- E REFER TO BAGGAGE DRAWINGS FOR LOCATION IMPACT PROTECTION OF BAG BELTS.
- F REFER TO BAGGAGE, MEP, IT AND SECURITY DRAWINGS FOR EQUIPMENT AND SYSTEM INFORMATION
- G PROVIDE 3-HOUR SPRAY-ON FIREPROOFING ON UNDERSIDE OF LEVEL 3 SLAB
- H EXTERIOR FACE OF FOUNDATION WALLS TO HAVE COLD FLUID APPLIED WATERPROOFING. TYPICAL. RE: SECTION 07 14 16 IN PROJECT MANUAL FOR MORE INFORMATION.

**KEY PLAN**

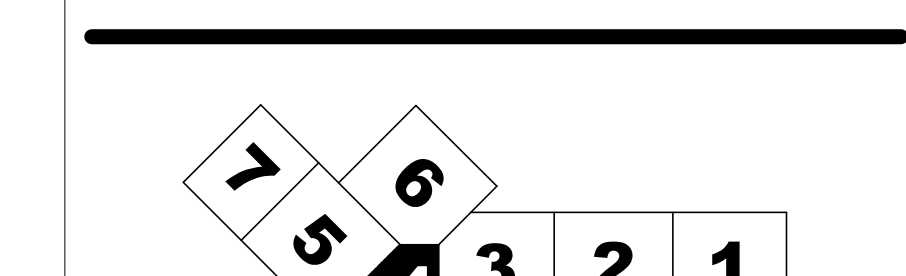

Issue	Date & Issue Description	By	Check
01	07/11/08		
02	09/22/08		
03	12/03/08		
04	01/23/09		
05	10/26/09		

Seal/Signature  
  
 Project Name  
 PWM Terminal Enhancement

Project Number  
 09 6395 000  
 Description  
 CONSTRUCTION PLAN - LEVEL 1 - ZONE 4

Scale  
 As indicated

**A02.01.04**

© 2009 Gensler