

SHEET NOTES

- 01 DEMOLISH EXISTING CANOPY STRUCTURE. COORDINATE EXTENT WITH NEW CONSTRUCTION. RE: STRUCTURAL DRAWINGS FOR MORE INFORMATION.
- 02 DEMOLISH EXISTING CONCRETE SLAB ON GRADE, RADIANT HEATING SYSTEM PIPING, INTERIOR PARTITIONS, DOORS AND DOOR FRAMES. EXISTING COLUMNS AND FOOTING TO REMAIN.
- 03 EXISTING FLOOR FINISH TO REMAIN. PROTECT FROM AREAS OF DEMOLITION TO PREVENT DAMAGE TO SURROUNDING FINISHES. RETAIN AS MUCH FINISH AS POSSIBLE.
- 04 DEMOLISH IN ITS ENTIRETY EXISTING OVERHEAD COILING DOOR AND ASSOCIATED STRUCTURE.
- 05 DEMOLISH EXISTING DOOR, DOOR FRAME, THRESHOLD AND ASSOCIATED HARDWARE.
- 06 DEMOLISH EXISTING PRECAST WALL PANEL, CMU BACK UP, WINDOW UNIT, STOOL AND INTERIOR GYPSUM BOARD FURROUT.
- 07 DEMOLISH IN ITS ENTIRETY CONCRETE STAIR, RAILING, PRECAST ENCLOSURE AND STEEL FRAMING.
- 08 DEMOLISH EXISTING PRECAST WALL PANELS, CMU BACK UP AND ASSOCIATED PIPE COLUMNS AND ROOF IN THIS AREA.
- 09 DEMOLISH EXISTING STONE BENCH AND STEEL POST W/ ASSOCIATED HARDWARE.
- 10 DEMOLISH IN ITS ENTIRETY EXISTING BAGGAGE HANDLING SYSTEM AT CURBSIDE CHECK.
- 11 COORDINATE EXTENT OF DEMOLITION WITH NEW WORK.

**Portland International
Jetport**

1001 Westbrook Street
Portland, Maine 04102

Gensler 2020 K Street, Northwest
Suite 200
Washington DC 20006
Telephone 202.721.5200
Facsimile 202.872.8587

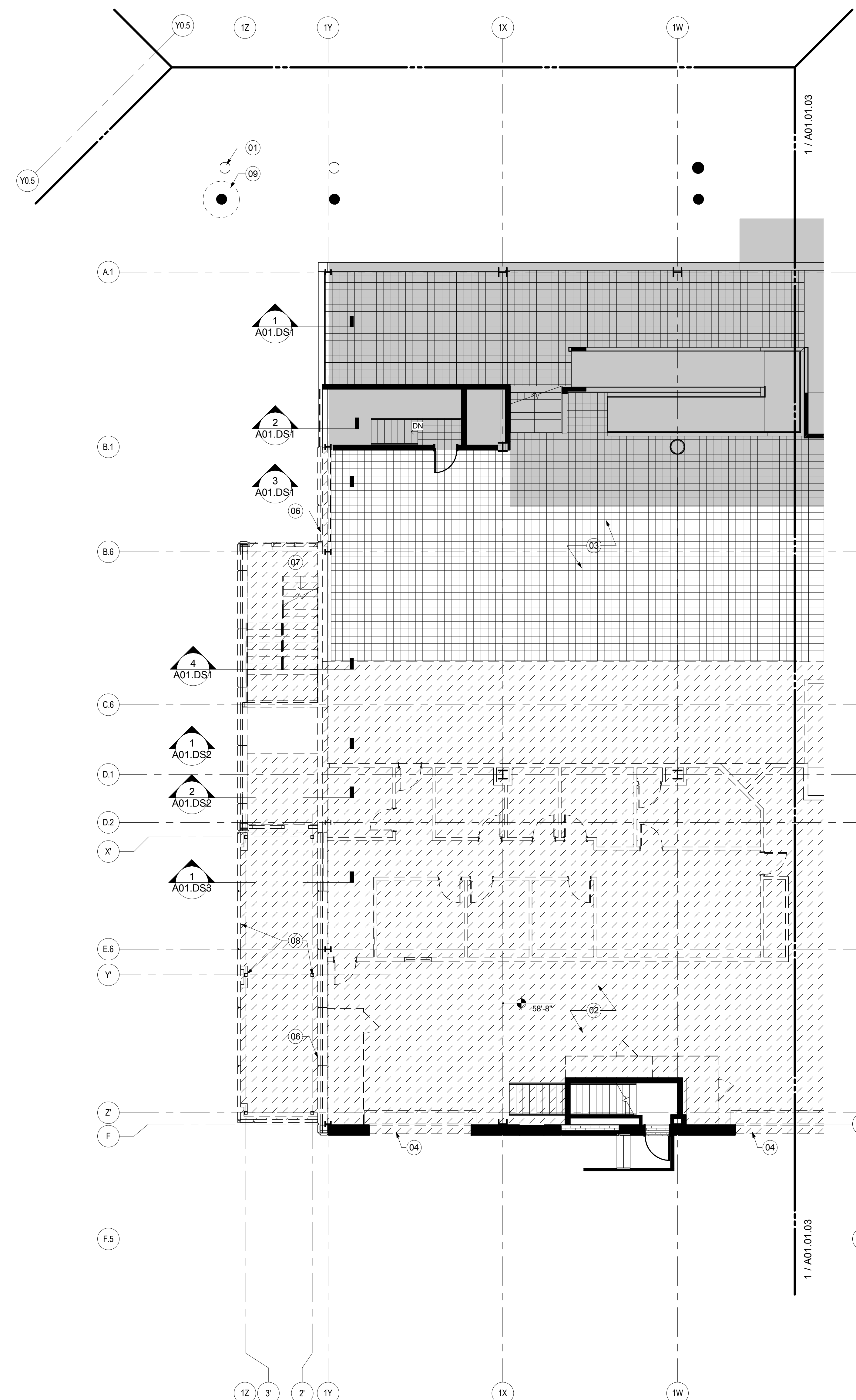

GENERAL NOTES

- A ALL ELEMENTS SHOWN DASHED (INCLUDING BUT NOT LIMITED TO: CONCRETE WALLS, FOOTINGS, FACADE ASSEMBLY FINISHES, DOORS, FRAMES, HARDWARE) TO BE DEMOLISHED IN ITS ENTIRETY.
- B PROVIDE ALL NECESSARY DEMOLITION PRIOR TO CONSTRUCTION.
- C IT IS THE INTENT OF THESE DRAWINGS THAT EXISTING WALLS AND FINISHES TO REMAIN, U.O.N.
- D CONTRACTOR SHALL VERIFY FIELD CONDITIONS AND NOTIFY ARCHITECT OF ALL DISCREPANCIES BEFORE PROCEEDING WITH WORK.

KEY PLAN



Issue	Date & Issue Description	By	Check
01	07/11/08		
02	09/22/08		
03	12/03/08		
04	01/23/09		
05	10/26/09		

Seal/Signature

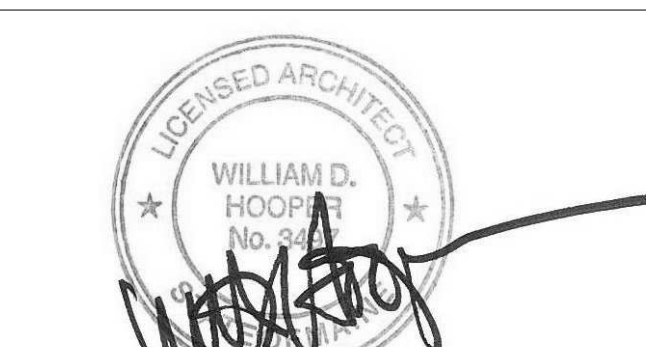

Project Name
PJM Terminal Enhancement

Project Number
09-6395-000

Description
DEMOLITION PLAN - LEVEL 1 - ZONE 4

Scale
As indicated

A01.01.04

© 2009 Gensler