

# AVIATION ACRONYMS & ABBREV.

ACS	AIRLINE CUSTOMER SERVICE
ADSS	AIRPORT DOCKING GUIDANCE SYSTEM
AGT(S)	AUTOMATED GUIDEWAY TRANSIT SYSTEM
AI	APRON ILLUMINATION
ALP	AIRPORT LAYOUT PLAN
AMP	AIRPORT MASTER PLAN
AOA	AIRLINE OPERATING AREA
ADG/NA	AIRPORT OPERATORS COUNCIL INTERNATIONAL-NORTH AMERICA
APHIS	ANIMAL PLANT HEALTH INSPECTION SERVICE
APU	AUXILIARY POWER UNIT
ARFF	AIRPORT RESCUE AND FIRE FIGHTING
BC	BABY CHANGE
BCUBCD	BAGGAGE CLAIM UNIT OR DEVICE
BHS	BAGGAGE HANDLING SYSTEM
BHS CR	BAGGAGE HANDLING SYSTEM CONTROL RM
BHS MCP	BAGGAGE HANDLING SYSTEM MOTOR CONTROL PANEL
BIDS	BAGGAGE INFORMATION DISPLAY SYSTEM
BMS	BUILDING MANAGEMENT SYSTEM
BOS	BACK OF STAND ROADWAY
C. COMM	COMMUNICATIONS SYSTEMS RM. (TELECOMMUNICATION)
CAB	CIVIL AERONAUTICS BOARD
CC	COMPANION CARE
CCTV	CLOSED CIRCUIT TELEVISION
CUTE	COMMON USE TERMINAL EQUIPMENT
DBH	DAY BAG HOLDROOM
DOT	DEPARTMENT OF TRANSPORTATION
ECS	ENVIRONMENTAL CONTROL SYSTEM
EFSD	EMERGENCY FUEL SHUT OFF
EMB	EMBARKER REGIONAL JET (BRAND NAME TYPE)
EM GEN	EMERGENCY GENERATOR
FA	FAMILY ASSIST
FAA	FEDERAL AVIATION ADMINISTRATION
FIDS	FLIGHT INFORMATION DISPLAY SYSTEM
FIS	FEDERAL INSPECTION SERVICE
GIDS	GATE INFORMATION DISPLAY SYSTEM
GSE	GROUND SERVICE EQUIPMENT
HOS	HEAD OF STAND ROADWAY
HR	HOLDROOM
HZ	HERZ
400HZ	POWER SYSTEM FOR PARKED AIRCRAFT
ICAO	INTERNATIONAL CIVIL AVIATION ORGANIZATION
IE	INDEPENDENT ELECTRICAL
IGR	INTELLIGENT GATE READER (BOARDINGPASS VALIDATOR)
LOG	LOGISTICS
LOB	LEFT OVER BAGGAGE
MAINT	MAINTENANCE
MGR	MANAGER
ML ACS	MAINLINE AIRLINE CUSTOMER SERVICE
NFPA	NATIONAL FIRE PROTECTION ASSOCIATION
OL	OCCUPANT LOAD
OLF	OCCUPANT LOAD FACTOR
OPS	OPERATIONS
OSB	OVERSIZED BAGGAGE
PAX	PASSENGER(S)
PBB	PASSENGER BOARDING BRIDGE (AKA LOADING BRIDGES & JETWAYS)
PCA	PRECONDITIONED AIR
PHS	PUBLIC HEALTH SERVICE
PSA	PASSENGER SERVICE AGENTS
PWC	POTABLE WATER CABINET
RAC	RENTAL CAR FACILITIES
RAMP OPS	RAMP OPERATIONS
RCC	ROVER COMMAND CENTER
RIDS	RAMP INFORMATION DISPLAY SYSTEM
ROW	RIGHT OF WAY
SEC Y	SECRETARY
SIDA	SITE IDENTIFICATION DISPLAY AREA
SRCH	SEARCH RM
SUPV	SUPERVISOR
SVC	SERVICE
TECH	TECHNOLOGY, TECHNICAL
TKT	TICKET
TKTNG	TICKETING
TL	TAXILANE
TW	TAXIWAY
UPS	UNINTERRUPTED POWER SOURCE
USCS	UNITED STATES CUSTOM SERVICE
USPS	UNITED STATES POSTAL SERVICE
VSR	VEHICLE SERVICE ROAD

# SHEET NUMBERING SYSTEM

**A02.03.04**

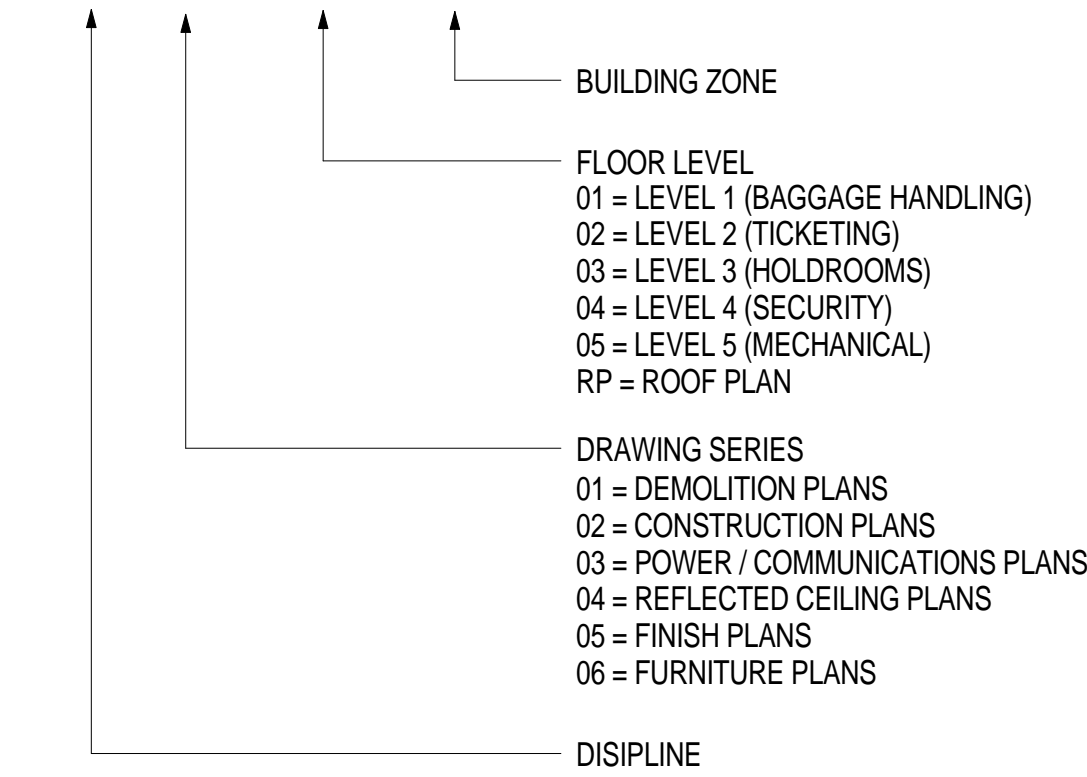

# KEY PLAN

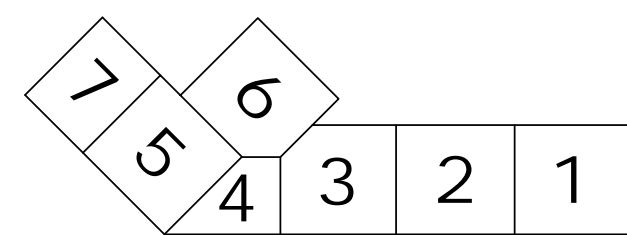

# GRAPHIC SYMBOLS (CONT.)

## ELEVATION INDICATIONS

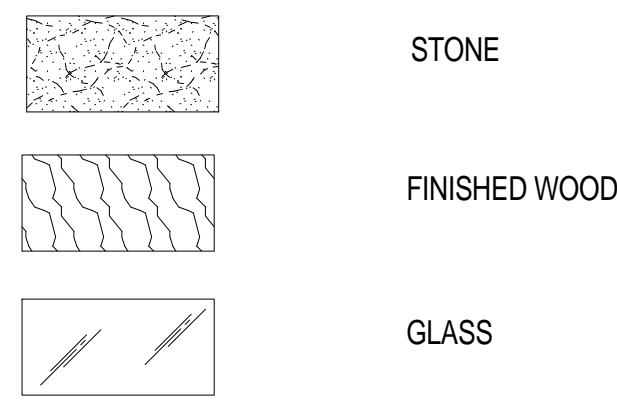

## SECTION INDICATIONS

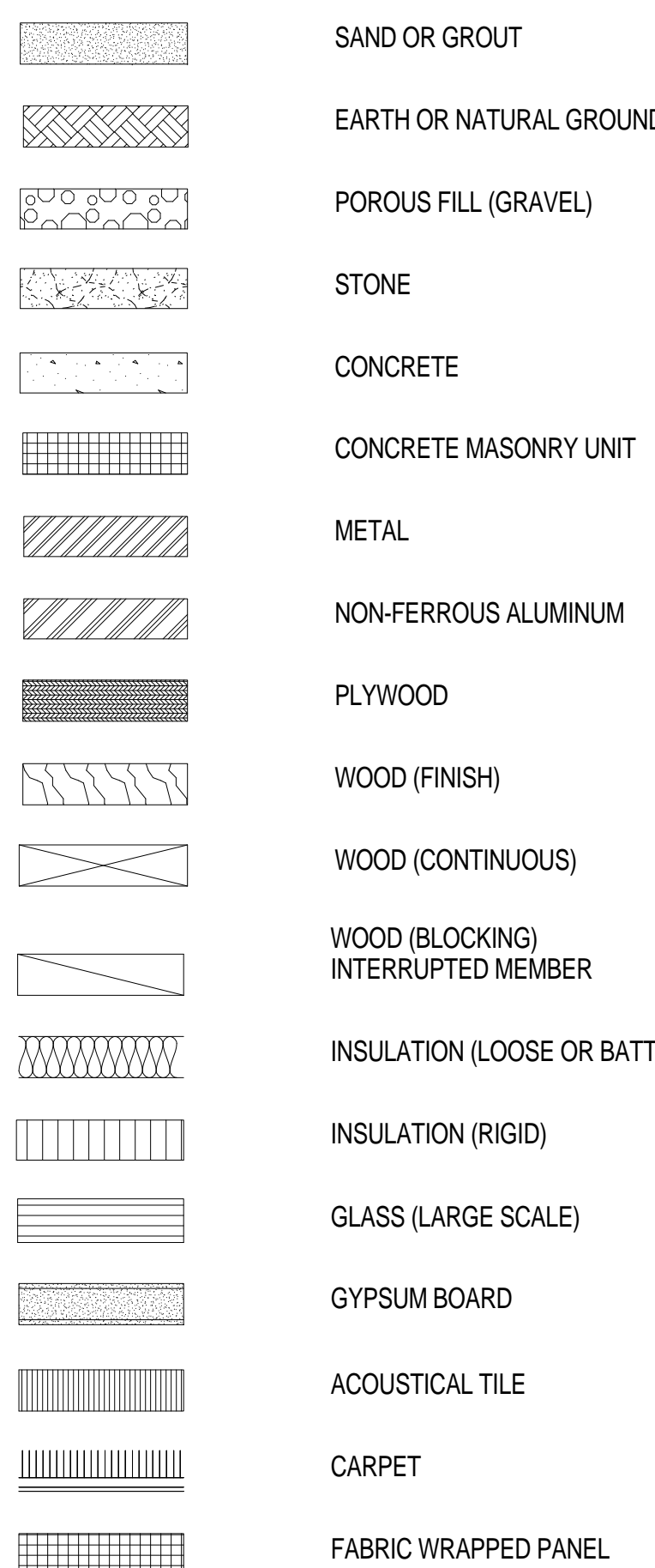

# GRAPHIC SYMBOLS (CONT.)

## POWER & COMMUNICATION CONT.

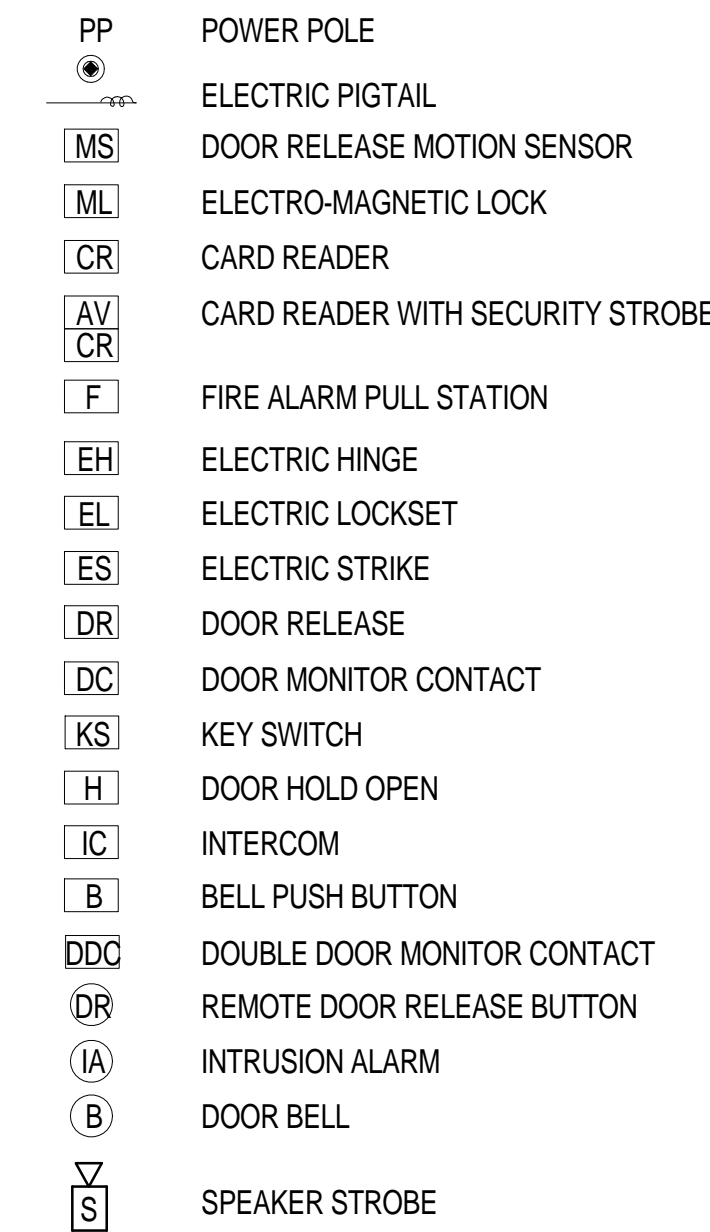

## REFLECTED CEILING

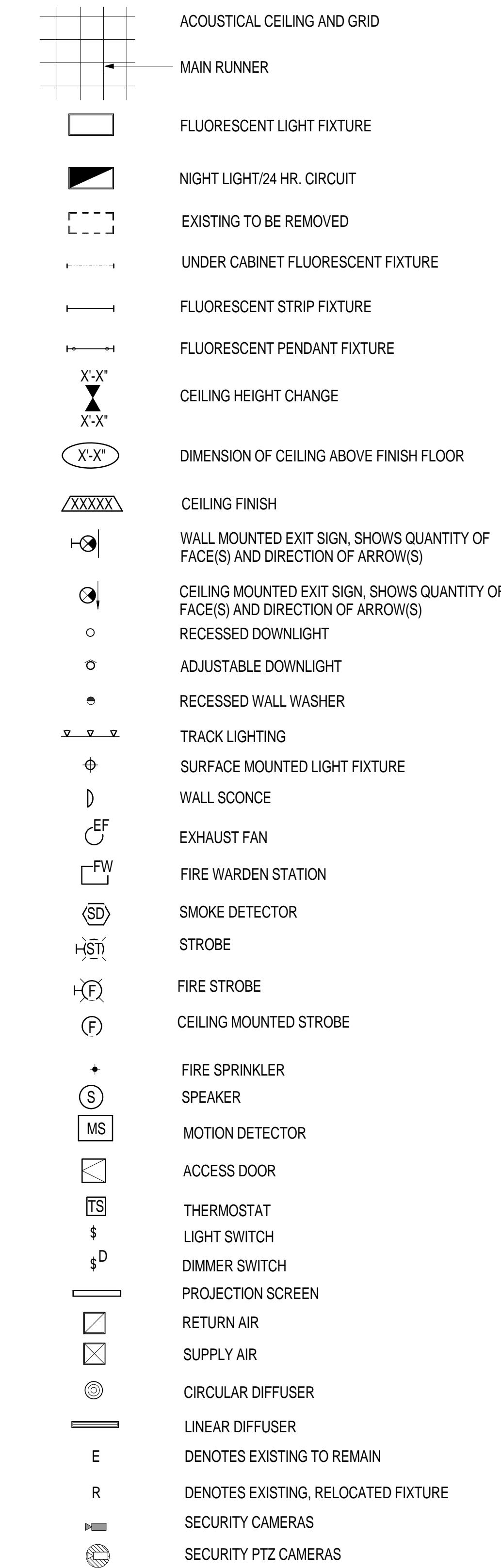

# GRAPHIC SYMBOLS (CONT.)

## POWER & COMMUNICATION

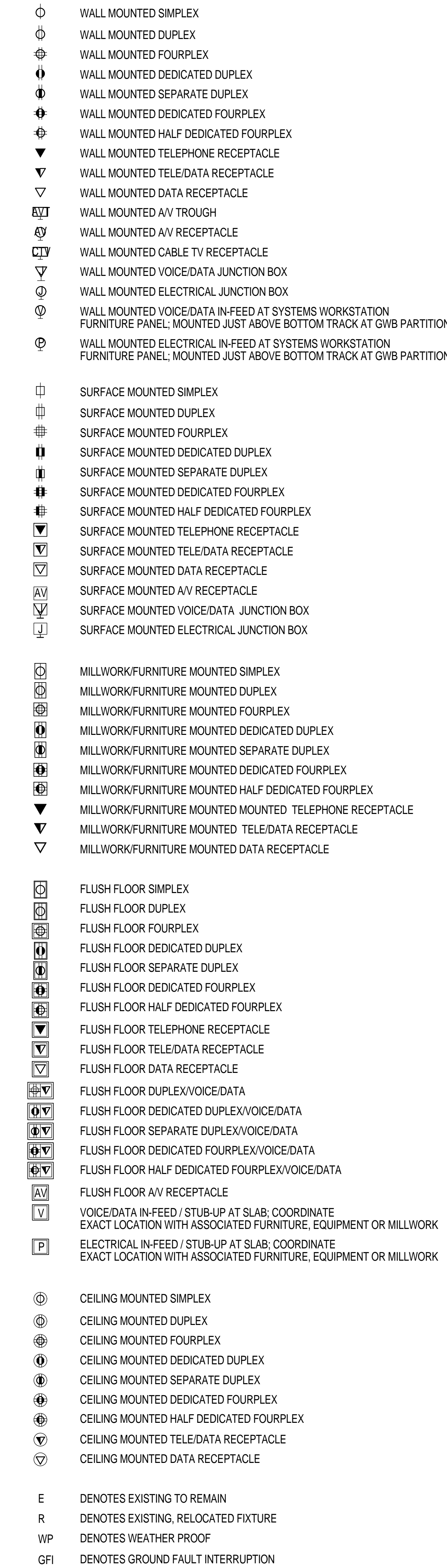

THESE SYMBOLS REPRESENT THE MOUNTING METHOD AND TYPE. REFER TO ENGINEERING DRAWINGS FOR EXACT CONFIGURATION AND ADDITIONAL INFORMATION.

# GRAPHIC SYMBOLS

## CONSTRUCTION

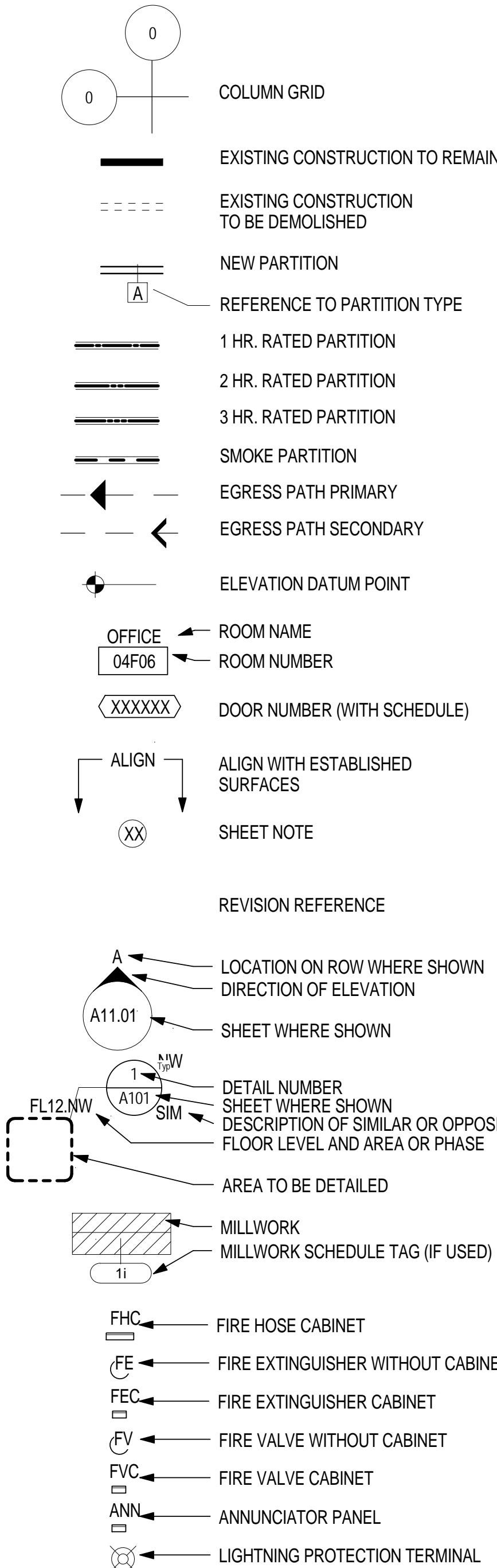

## DEMOLITION

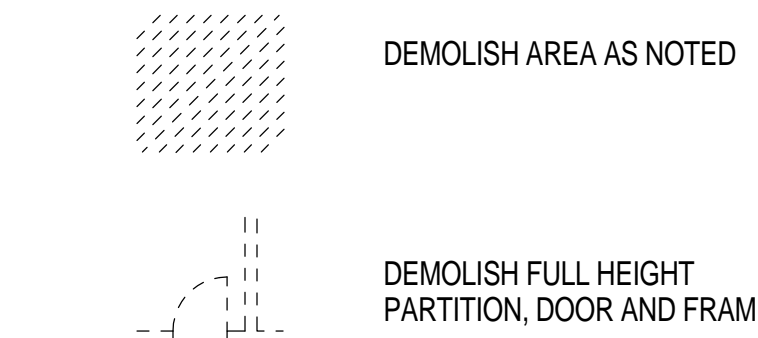

## FINISH

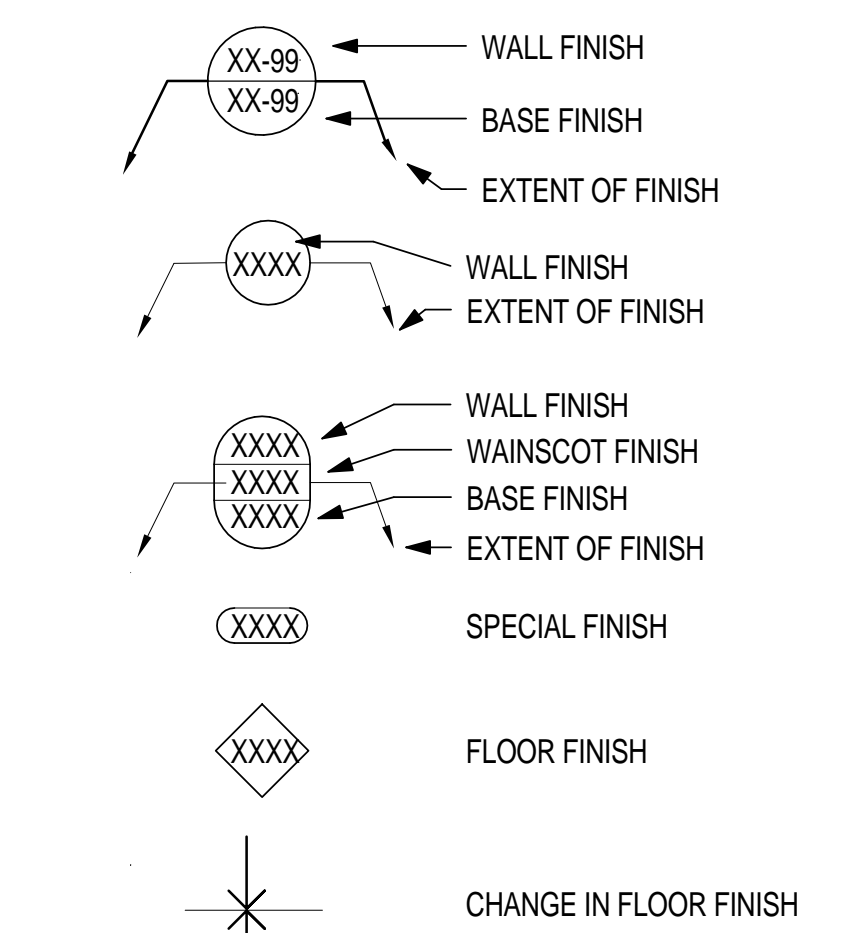

Portland International Jetport  
1001 Westbrook Street  
Portland, Maine 04102

**Gensler**

2020 K Street, Northwest  
Suite 200  
Washington DC 20006  
Telephone 202.721.5200  
Facsimile 202.872.8587

# BUILDING ZONES

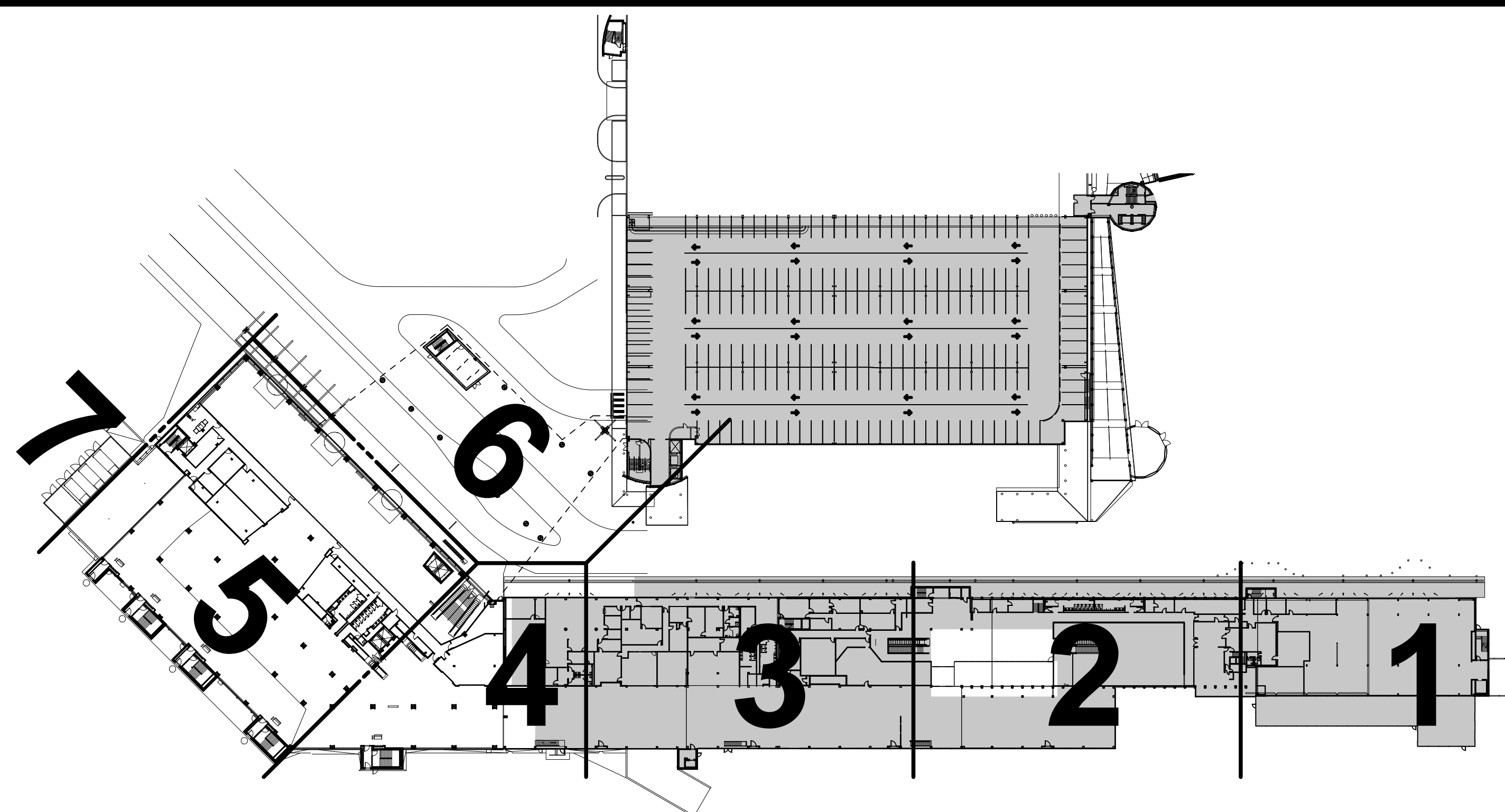

Date	Description
07/11/08	SCHEMATIC DESIGN
09/22/08	DESIGN DEVELOPMENT
12/03/08	75% CONSTRUCTION DOCUMENTS
01/23/09	95% CONSTRUCTION DOCUMENTS
10/26/09	ISSUED FOR PERMIT
2	11/12/09 ADDENDUM #2

Seal/Signature

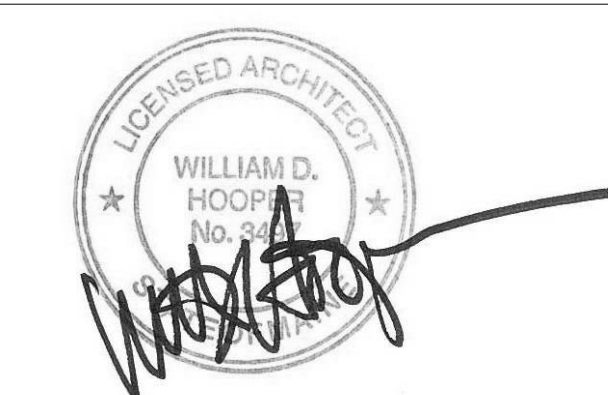

Project Name  
PWM Terminal Enhancement

Project Number  
09.6395.000

Description  
GRAPHIC SYMBOLS

Scale  
As indicated

**A00.12**

© 2009 Gensler