

SUBSURFACE WASTEWATER DISPOSAL SYSTEM APPLICATION

Maine Department of Human Services
 Division of Health Engineering, Station 10 SHS
 (207) 287-5672 FAX (207) 287-4172

Town, City, Plantation
PORTLAND

Street, Road, Subdivision
134 FENWAY STREET

Owner's Name
MICHELLE & ROBERT BROOKS

SUBSURFACE WASTEWATER DISPOSAL PLAN

SCALE 1" = 20 FT.

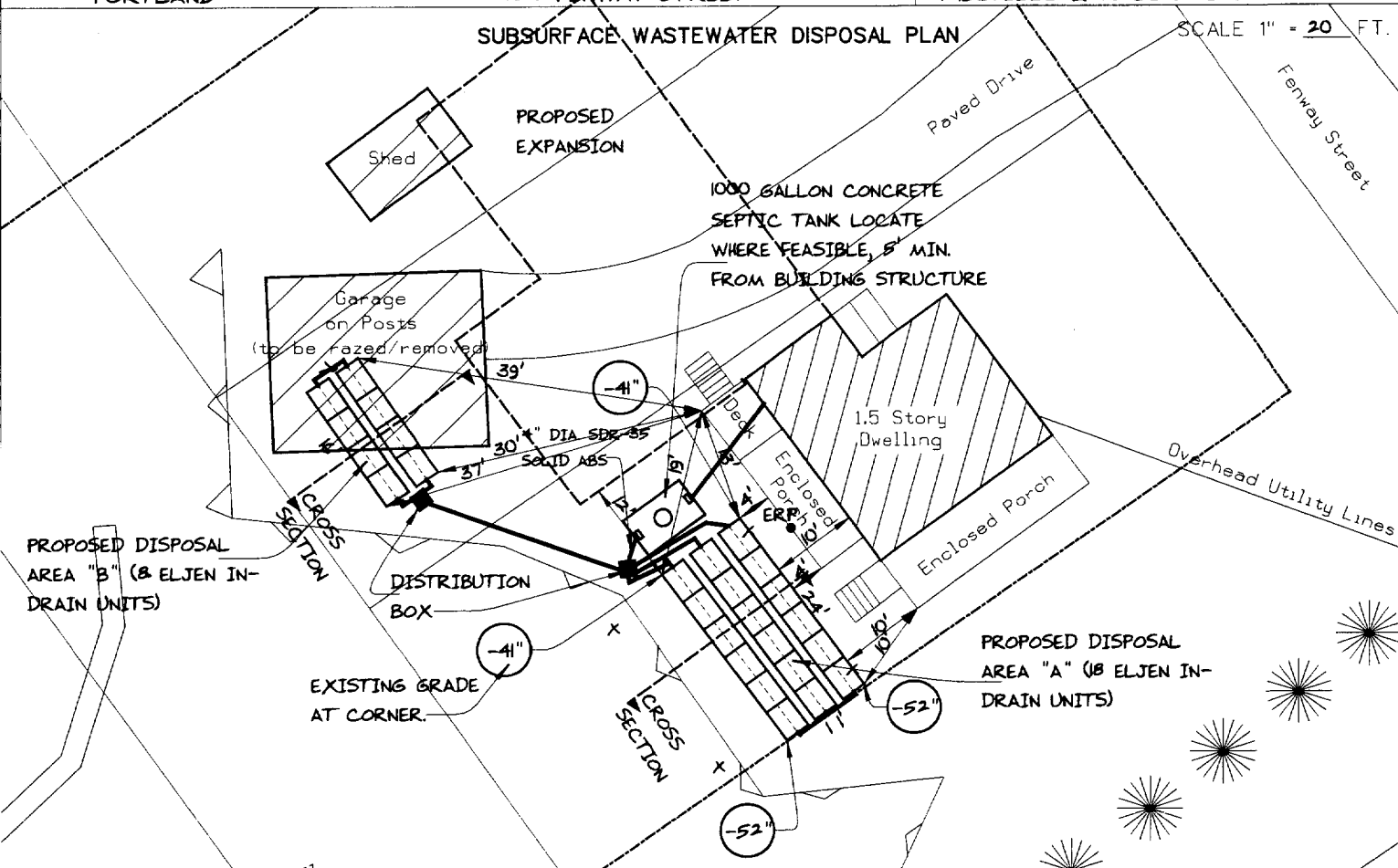

FILL REQUIREMENTS

Depth of Fill (Upslope) $\pm 0"$
 Depth of Fill (Downslope) $\pm 0"$
 DEPTHS AT CROSS-SECTION (shown below)

CONSTRUCTION ELEVATIONS

Finished Grade Elevation
 Top of _____ Proprietary Device
 Bottom of Disposal Area

SEE
 DETAIL
 BELOW

ELEVATION REFERENCE POINT

Location & Description BOTTOM OF GRAY SIDING ON PORCH, 44" ABOVE GRADE
 Reference Elevation is: 0.0" or _____

DISPOSAL AREA CROSS SECTION

REMOVE ALL PORTIONS OF FINER TEXTURED FILL TO A MINIMUM DEPTH OF 18" UNDERNEATH DISPOSAL AREA AND REPLACE WITH CLEAN GRAVELLY COARSE SAND FILL

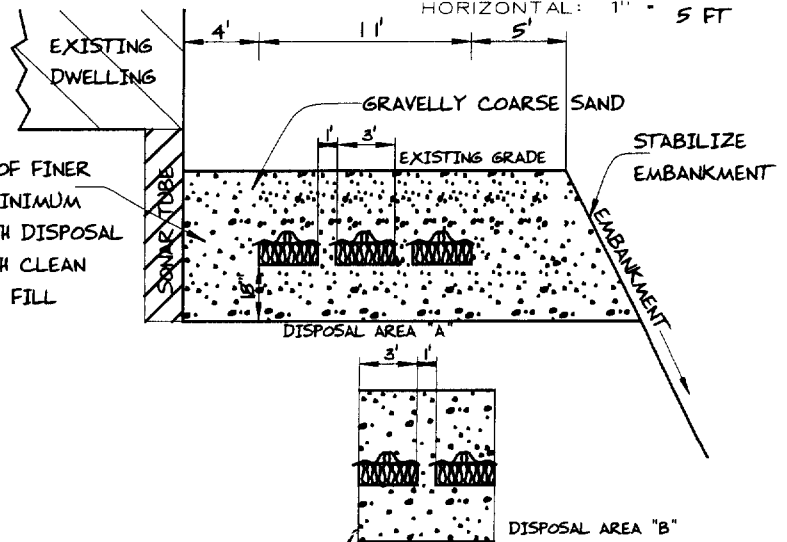

SCALE:
 VERTICAL: 1" = 5 FT
 HORIZONTAL: 1" = 5 FT

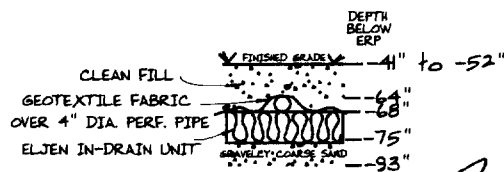

Albert Frick
 Site Evaluator Signature

163
 SE *

4/26/2004
 Date

Page 3 of 3
 HHE-200 Rev. 10/02