

Form # P 04

DISPLAY THIS CARD ON PRINCIPAL FRONTAGE OF WORK
CITY OF PORTLAND

Please Read
Application And
Notes, If Any,
Attached

BUILDING INSPECTION

PERMIT

Permit Number 10081
PERMIT ISSUED

This is to certify that CHARTER WESTGATE LLC/Sign Design Inc

has permission to 5' x 10' Freestanding sign face replacement & 1 Building wall sign 30" x 13" JUL 16 2010

AT 1412 CONGRESS ST CBL 197 B018001

provided that the person or persons, firm or corporation accepting this permit shall comply with all of the provisions of the Statutes of Maine and of the Ordinances of the City of Portland regulating the construction, maintenance and use of buildings and structures, and of the application on file in this department.

Apply to Public Works for street line and grade if nature of work requires such information.

Notification of inspection must be given and written permission procured before this building or part thereof is lathed or otherwise closed-in. 24 HOUR NOTICE IS REQUIRED.

A certificate of occupancy must be procured by owner before this building or part thereof is occupied.

OTHER REQUIRED APPROVALS

Fire Dept. _____

Health Dept. _____

Appeal Board _____

Other _____

Department Name

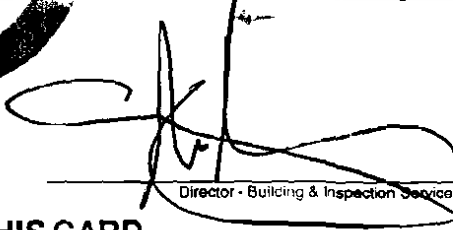
Director - Building & Inspection Services

PENALTY FOR REMOVING THIS CARD

City of Portland, Maine - Building or Use Permit Application

389 Congress Street, 04101 Tel: (207) 874-8703, Fax: (207) 874-8716

Permit No: 10-0811	Issue Date:	CBL: 197 B018001
-----------------------	-------------	---------------------

Location of Construction: 1412 CONGRESS ST	Owner Name: CHARTER WESTGATE LLC	Owner Address: 4150 TULLER RD STE 236	Phone:
Business Name:	Contractor Name: Sign Design Inc	Contractor Address: PO Box 207 Westbrook	Phone: 2078562600
Lessee/Buyer's Name	Phone:	Permit Type: Signs - Permanent	Zone: B-2

Past Use: Commercial - Tim Horton's	Proposed Use: Commercial - 5' x 10' Freestanding sign face replacement & 1 Building wall sign 30" x 13' - Tim Horton's Creamery Cold Stone Creamery	Permit Fee: \$235.00	Cost of Work: \$235.00	CEO District: 3
--	--	-------------------------	---------------------------	--------------------

Proposed Project Description: 5' x 10' Freestanding sign face replacement & 1 Building wall sign 30" x 13'	FIRE DEPT: <input type="checkbox"/> Approved <input checked="" type="checkbox"/> Denied <i>N/A</i>	INSPECTION: Use Group: U Type: Sign <i>IBC 2003</i>
	Signature:	Signature:
PEDESTRIAN ACTIVITIES DISTRICT (P.A.D.)		
Action: <input type="checkbox"/> Approved <input type="checkbox"/> Approved w/Conditions <input checked="" type="checkbox"/> Denied		
Signature:		Date:

Permit Taken By: Idobson	Date Applied For: 07/08/2010	Zoning Approval
-----------------------------	---------------------------------	------------------------

<p>1. This permit application does not preclude the Applicant(s) from meeting applicable State and Federal Rules.</p> <p>2. Building permits do not include plumbing, septic or electrical work.</p> <p>3. Building permits are void if work is not started within six (6) months of the date of issuance. False information may invalidate a building permit and stop all work..</p> <p style="font-size: 24pt; font-weight: bold; text-align: center;">PERMIT ISSUED</p> <p style="font-size: 18pt; text-align: center;">JUL 16 2010</p> <p style="text-align: center;">City of Portland</p>	<p>Special Zone or Reviews</p> <input type="checkbox"/> Shoreland <input type="checkbox"/> Wetland <input type="checkbox"/> Flood Zone <input type="checkbox"/> Subdivision <input type="checkbox"/> Site Plan Maj <input type="checkbox"/> Minor <input type="checkbox"/> MM <input type="checkbox"/> Date:	<p>Zoning Appeal</p> <input type="checkbox"/> Variance <input type="checkbox"/> Miscellaneous <input type="checkbox"/> Conditional Use <input type="checkbox"/> Interpretation <input type="checkbox"/> Approved <input type="checkbox"/> Denied Date:	<p>Historic Preservation</p> <input checked="" type="checkbox"/> Not in District or Landmark <input type="checkbox"/> Does Not Require Review <input type="checkbox"/> Requires Review <input type="checkbox"/> Approved <input type="checkbox"/> Approved w/Conditions <input type="checkbox"/> Denied Date: <i>AKU</i>
--	---	---	---

CERTIFICATION

I hereby certify that I am the owner of record of the named property, or that the proposed work is authorized by the owner of record and that I have been authorized by the owner to make this application as his authorized agent and I agree to conform to all applicable laws of this jurisdiction. In addition, if a permit for work described in the application is issued, I certify that the code official's authorized representative shall have the authority to enter all areas covered by such permit at any reasonable hour to enforce the provision of the code(s) applicable to such permit.

SIGNATURE OF APPLICANT	ADDRESS	DATE	PHONE
RESPONSIBLE PERSON IN CHARGE OF WORK, TITLE		DATE	PHONE

City of Portland, Maine - Building or Use Permit

389 Congress Street, 04101 Tel: (207) 874-8703, Fax: (207) 874-8716

Permit No: 10-0811	Date Applied For: 07/08/2010	CBL: 197 B018001
------------------------------	--	----------------------------

Location of Construction: 1412 CONGRESS ST	Owner Name: CHARTER WESTGATE LLC	Owner Address: 4150 TULLER RD STE 236	Phone:
Business Name:	Contractor Name: Sign Design Inc	Contractor Address: PO Box 207 Westbrook	Phone: (207) 856-2600
Lessee/Buyer's Name	Phone:	Permit Type: Signs - Permanent	

Proposed Use: Commercial - 5' x 10' Freestanding sign face replacement & 1 Building wall sign 30" x 13'	Proposed Project Description: 5' x 10' Freestanding sign face replacement & 1 Building wall sign 30" x 13' - "Tim Horton's" & "Cold Stone Creamery"
---	---

Dept: Zoning	Status: Approved	Reviewer: Ann Machado	Approval Date: 07/12/2010
Note: Original sign permit #08-1352.			Ok to Issue: ✓
Dept: Building	Status: Approved with Conditions	Reviewer: Tammy Munson	Approval Date: 07/16/2010
Note: 1) Signage Installation to comply with Chapters 31 & 32 of the IBC 2003 building code.			Ok to Issue: ✓

PERMIT ISSUED

JUL 16 2010

City of Portland

BUILDING PERMIT INSPECTION PROCEDURES

Please call 874-8703 or 874-8693 (ONLY)

or email: buildinginspections@portlandmaine.gov

With the issuance of this permit, the owner, builder or their designee is required to provide adequate notice to the City of Portland Inspection Services for the following inspections. Appointments must be requested 48 to 72 hours in advance of the required inspection. The inspection date will need to be confirmed by this office.

- **Please read the conditions of approval that is attached to this permit!! Contact this office if you have any questions.**
- **Permits expire in 6 months, if the project is not started or ceases for 6 months.**
- **If the inspection requirements are not followed as stated below additional fees may be incurred due to the issuance of a "Stop Work Order" and subsequent release to continue with construction.**

 X **Final inspection required at completion of work.**

The project cannot move to the next phase prior to the required inspection and approval to continue, REGARDLESS OF THE NOTICE OR CIRCUMSTANCES.

IF THE PERMIT REQUIRES A CERTIFICATE OF OCCUPANCY, IT MUST BE PAID FOR AND ISSUED TO THE OWNER OR DESIGNEE BEFORE THE SPACE MAY BE OCCUPIED.

PERMIT ISSUED

JUL 16 2010

City of Portland



Signage/Awning Permit Application

If you or the property owner owes real estate or personal property taxes or user charges on any property within the City, payment arrangements must be made before permits of any kind are accepted.

Location/Address of Construction: <u>1412 Congress St</u>		
Tax Assessor's Chart, Block & Lot Chart# <u>197</u> Block# <u>B</u> Lot# <u>18</u>	Owner: <u>Tim Horton's</u>	Telephone: <u>775-1579</u>
Lessee/Buyer's Name (if Applicable)	Contractor name, address & telephone: <u>Sign Design, Inc.</u> <u>P.O. Box 2015</u> <u>Westbrook, ME 04098</u> <u>856-2600</u>	Total s.f. of signage x \$2.00 Per s.f. plus \$30.00/\$65.00 For H.D. signage = Total Fee: \$ _____ Awning Fee = cost of work _____ Total Fee: \$ _____
Who should we contact when the permit is ready: <u>Roger/Diana</u> phone: <u>856-2600</u>		
Tenant/allocated building space frontage (feet): Length: <u>27'</u> Height: <u>20'</u> Lot Frontage (feet) <u>1160'</u> Single Tenant or Multi Tenant Lot _____		
Current Specific use: <u>fast food restaurant</u> If vacant, what was prior use: <u>N/A</u> Proposed Use: _____		
Information on proposed sign(s): <u>faces only (existing)</u> Freestanding (e.g., pole) sign? Yes <input checked="" type="checkbox"/> No _____ Dimensions proposed: <u>5' x 10'</u> Height from grade: <u>20'</u> Bldg. wall sign? (attached to bldg) Yes <input checked="" type="checkbox"/> No _____ Dimensions proposed: <u>30" x 13'</u> (<u>32.50 SF</u>)		
Proposed awning? Yes _____ No <input checked="" type="checkbox"/> Is awning backlit? Yes _____ No _____ Height of awning: _____ Length of awning: _____ Depth: _____ Is there any communication, message, trademark or symbol on it? Yes _____ No _____ If yes, total s.f. of panels w/communications, message, trademark or symbol: _____ s.f.		
Information on existing and previously permitted sign(s): Freestanding (e.g., pole) sign? Yes <input checked="" type="checkbox"/> No _____ Dimensions: <u>5' x 10'</u> <u>50 SF</u> Bldg. wall sign? (attached to bldg) Yes <input checked="" type="checkbox"/> No _____ Dimensions: <u>42" x 15'</u> <u>52.5 SF</u> Awning? Yes _____ No <input checked="" type="checkbox"/> Sq. ft. area of awning w/communication: _____		
A site sketch and building sketch showing exactly where existing and new signage is located must be provided. Sketches and/or pictures of proposed signage and existing building are also required.		

102.50 x 2 + 30

Please submit all of the information outlined in the Sign/Awning Application Checklist. Failure to do so may result in the automatic denial of your permit.

In order to be sure the City fully understands the full scope of the project, the Planning and Development Department may request additional information prior to the issuance of a permit. For further information visit us on-line at www.portlandmaine.gov, stop by the Building Inspections office, room 315 City Hall or call 874-8703.

I hereby certify that I am the Owner of record of the named property, or that the owner of record authorizes the proposed work and that I have been authorized by the owner to make this application as his/her authorized agent. I agree to conform to all applicable laws of this jurisdiction. In addition, if a permit for work described in this application is issued, I certify that the Code Official's authorized representative shall have the authority to enter all areas covered by this permit at any reasonable hour to enforce the provisions of the codes applicable to this permit.

Signature of applicant: Diana Olmstead Date: 7/16/2010

RECEIVED

This is not a permit; you may not commence ANY work until the permit is issued.

JUL - 8 2010

freestanding - 6' max - 5x10 = 50 + 7.25x11 = 10.69 = 60.59 sq ft
18' max - 16' on original
building 1 pr bldg - facade - phone one - total of two - facade 8' x 2 = 160 sq ft

Dept. of Building Inspections
City of Portland Maine
172 2.5 x 13 = 32.5 sq ft

John Goff
32.5
SP. 9
914 OK
LCC Main 10

Exit



Proposed

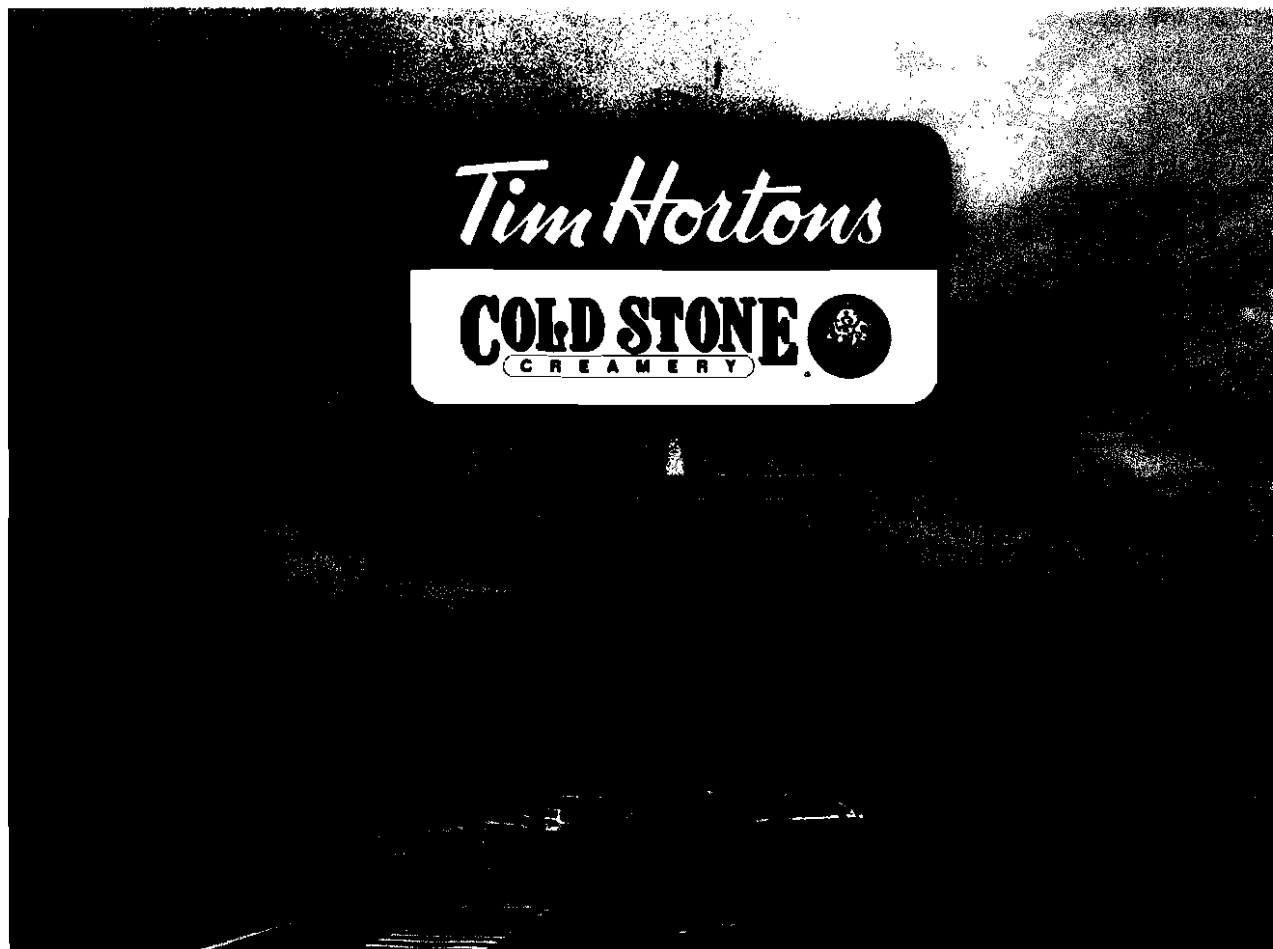

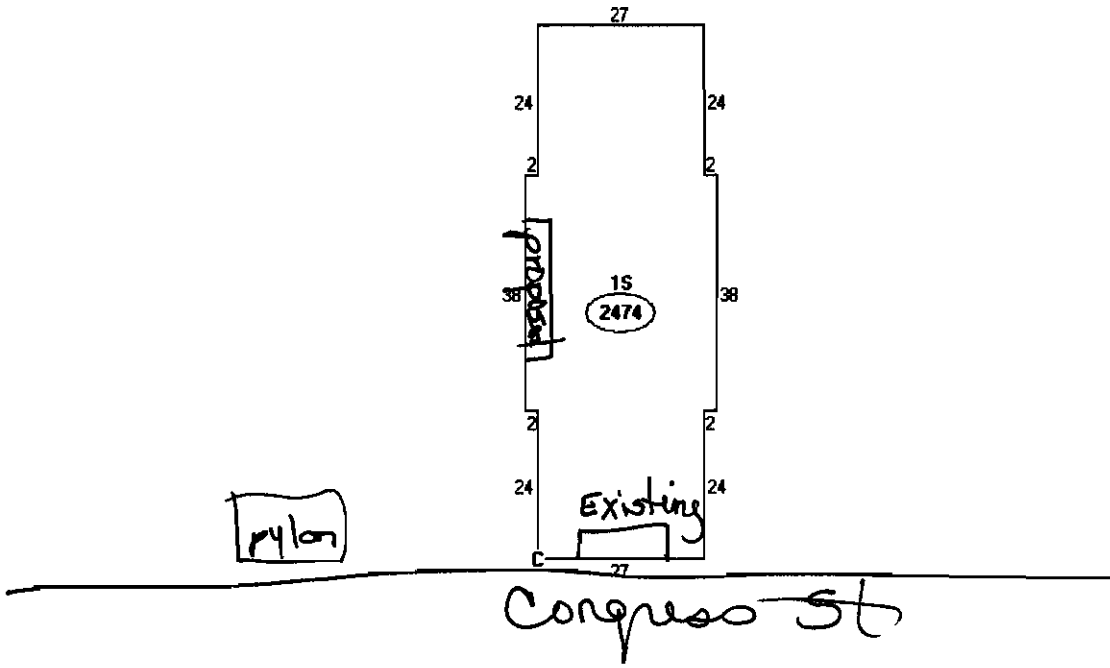

Descriptor/Area

- A: 100
2474 sqft
- B: 1S
2474 sqft
- C: PA1
16000 sqft

COLD STONE CREAMERY- 30"



SEE SECTION DETAIL BELOW

COLD STONE LOGO @ 30"

SCALE: 1/2"=1'

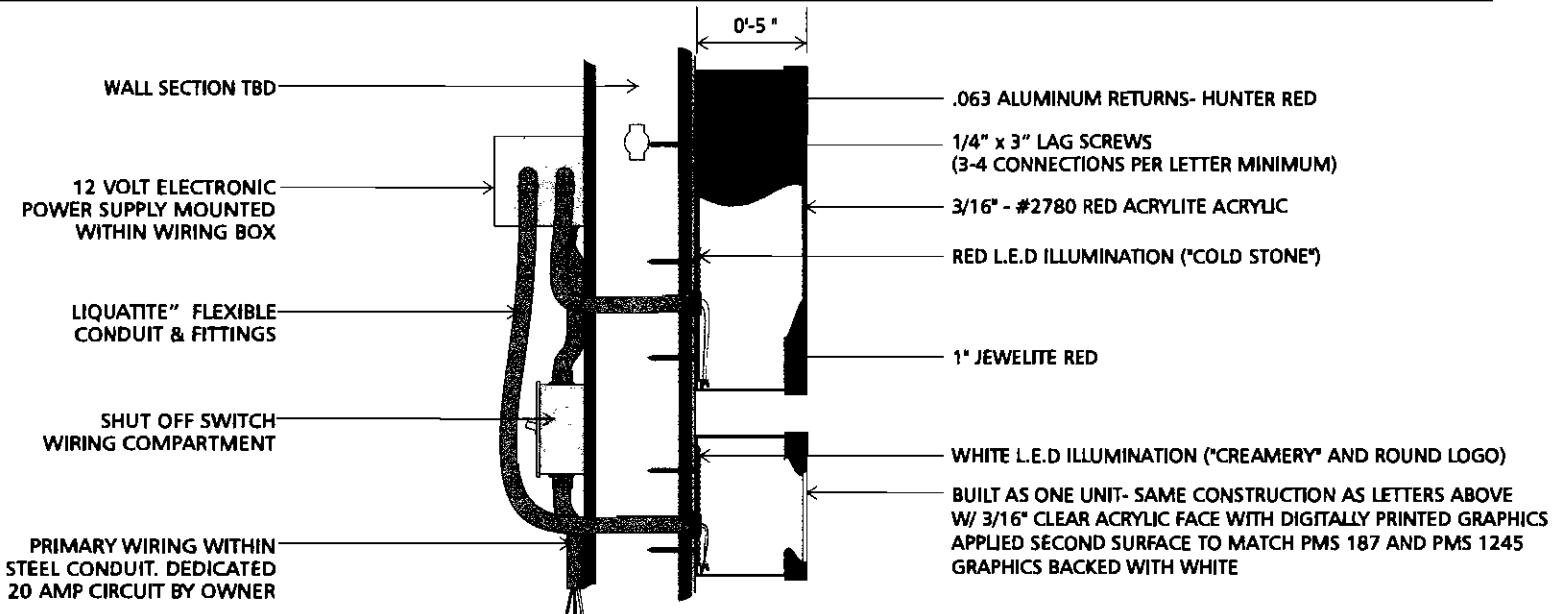

COLD STONE CHANNEL LETTER SECTION VIEW

NTS

TOTAL POWER LOAD: 2.0 AMPS

SIGN TYPE	SPECIFICATIONS	COLORS	SIGN SURVEY	ARTWORK
<input checked="" type="checkbox"/> SINGLE FACE <input checked="" type="checkbox"/> ILLUMINATED <input checked="" type="checkbox"/> WALL	COLD STONE CREAMERY 30" CHANNEL LETTERS - .040" ALUMINUM BACKS - .063" ALUMINUM RETURNS - FINISHED HUNTER RED - 1" TRUE RED JEWELITE TRIMCAP - 3/16" #2780 RED ACRYLITE ("COLD STONE") - 3/16" CLEAR ACRYLITE FACE W/ DIGITALLY PRINTED GRAPHICS APPLIED 2ND SRFC. BACKED WITH WHITE ("CREAMERY" TAGLINE AND ROUND LOGO) - RED L.E.D.'S WITH REMOTE POWER SUPPLIES AS REQUIRED FOR PROPER ILLUMINATION ("COLD STONE") - WHITE L.E.D.'S WITH REMOTE POWER SUPPLIES AS REQUIRED FOR PROPER ILLUMINATION ("CREAMERY" TAGLINE AND ROUND LOGO)	<input checked="" type="checkbox"/> PMS 187 <input checked="" type="checkbox"/> PMS 1807 <input checked="" type="checkbox"/> PMS 123 <input checked="" type="checkbox"/> PMS 1245 <input checked="" type="checkbox"/> WHT. BACKER <input checked="" type="checkbox"/> CLEAR ACRYLIC <input checked="" type="checkbox"/> HUNTER RED RETURNS	<input type="checkbox"/> FACE TRIMS <input type="checkbox"/> FASCIA COLOR <input type="checkbox"/> RADIUS DIM. <input type="checkbox"/> BUILDING DIM. <input type="checkbox"/> FACADE ANGLE <input type="checkbox"/> OTHER	<input checked="" type="checkbox"/> PROVIDED <input type="checkbox"/> REQUIRED If required, customer to provide Custom Sign Center, Inc. with camera ready or appropriate digital file. Please contact your salesperson or Design Staff for appropriate file types.
FILENAME: COLDSTONE_30IN DATE:	REV.#2 REV.DATE: 3/26/09 DGNR: RV/LAE SALES: T. SHEEHY	Approval Signatures Required to insure that all spelling, colors, and specifications for sign(s) rendered meets customer & landlord approvals.	CUSTOMER: _____ DATE: _____	LANDLORD: _____ DATE: _____

This Design Is The Property Of **Sign Design Inc.**

306 Warren Ave. Portland, ME
Phone: 207.856.2600 Fax: 207.856.7600
signdesi@maine.rr.com

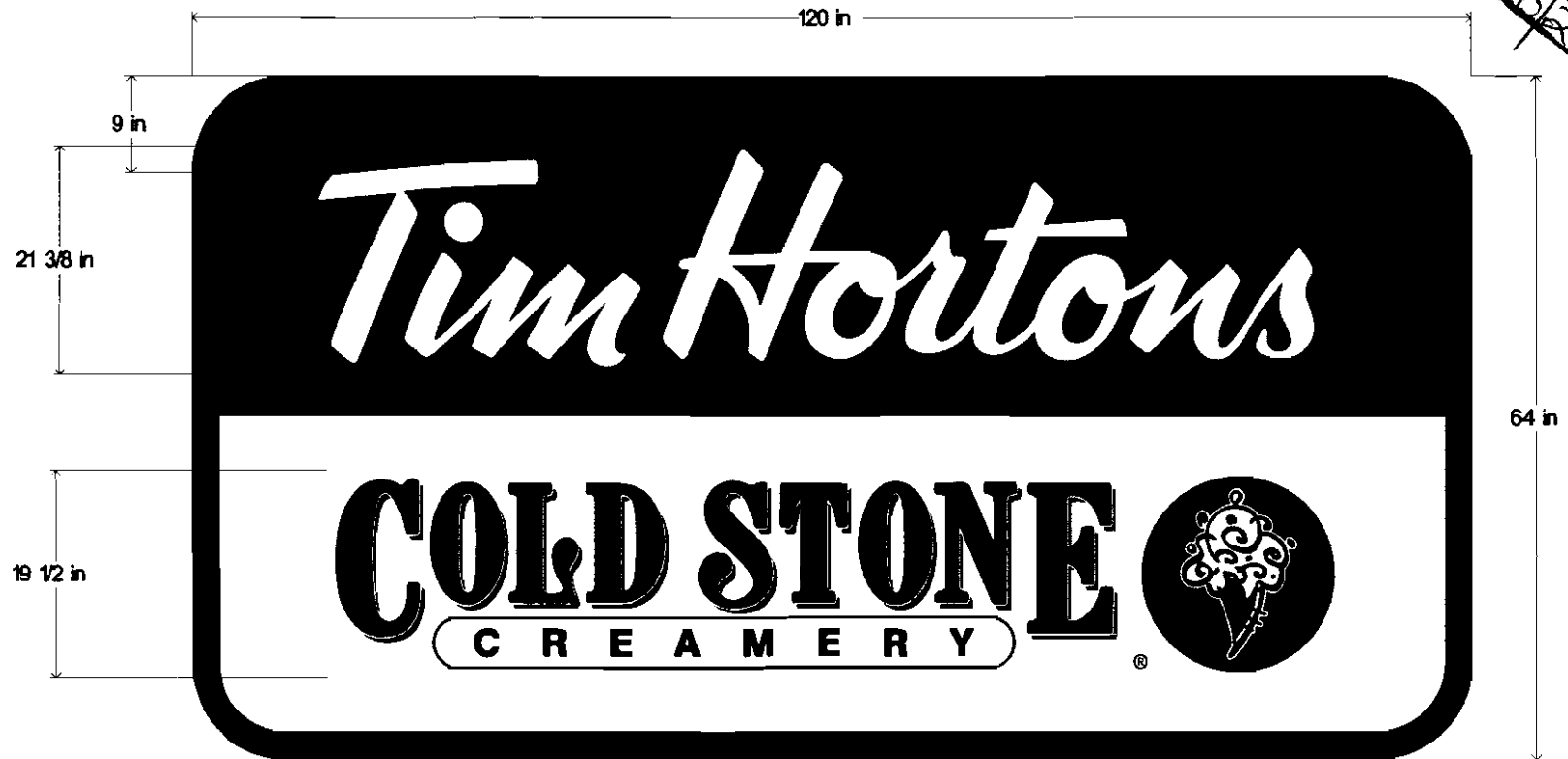

Bronze, Double Sided Interior Illuminated Sign Cabinet, Lexan Faces With Vinyl Graphics

This proof may reflect color shifts due to the color conversion from ink to paint and or vinyl. Also, PMS colors will be approximated to the best of our ability.

Customer supplied artwork files (300 dpi required) will be used as is, and Sign Design Inc. is not responsible for any faults in the design.

Any black outlines appearing on this proof are for representation only. They are to distinguish sign components such as borders, retainers, faces and reveals. Unless otherwise specified, they are not considered as part of the sign graphics.

Sign Design Inc. is not responsible for errors occurring due to improper review of this submitted proof.

Client: Tim Hortons Rev.1
File: presque isle comp. 2
Date: 6.28.10

Approval:

Customer approval is a signed confirmation that dimensions, colors, spelling, graphics and all other job specifics are correct.



Sign Contractors

P.O. Box 207
Westbrook, ME 04098
(207) 898-2900 * FAX: (207) 898-7600
1-800-848-9037
signdesal@maine.rr.com
A Full Service Sign Company

RE:

To Whom It May Concern:

As the owner (or owner representative) of the property located at:

TIM HORTONS
1412 CONGRESS STREET
PORTLAND, ME. 04102

I authorize Sign Design Inc. to install signs/sign face replacements as detailed on attached paperwork.

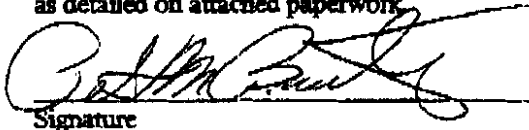
Signature

6/30/2010
Date

Peter M. Busselle
Print Name
NEW ENGLAND CONSTRUCTION MANAGER
TIM HORTONS

ACORD CERTIFICATE OF LIABILITY INSURANCE

DATE (MM/DD/YYYY)
06/30/2010

PRODUCER Bilodeau Insurance Agency, Inc. 541 Lisbon Street Lewiston ME 04240		THIS CERTIFICATE IS ISSUED AS A MATTER OF INFORMATION ONLY AND CONFERS NO RIGHTS UPON THE CERTIFICATE HOLDER. THIS CERTIFICATE DOES NOT AMEND, EXTEND OR ALTER THE COVERAGE AFFORDED BY THE POLICIES BELOW.	
INSURED DCS Limited DBA: Tim Horton's / Cold Stone Creamery 27 Harvest Hill Lane Auburn ME 04210		INSURERS AFFORDING COVERAGE	NAIC #
		INSURER A: Patriot Insurance	
		INSURER B: Hartford Casualty	
		INSURER C:	
		INSURER D:	
		INSURER E:	

COVERAGES
 THE POLICIES OF INSURANCE LISTED BELOW HAVE BEEN ISSUED TO THE INSURED NAMED ABOVE FOR THE POLICY PERIOD INDICATED. NOTWITHSTANDING ANY REQUIREMENT, TERM OR CONDITION OF ANY CONTRACT OR OTHER DOCUMENT WITH RESPECT TO WHICH THIS CERTIFICATE MAY BE ISSUED OR MAY PERTAIN, THE INSURANCE AFFORDED BY THE POLICIES DESCRIBED HEREIN IS SUBJECT TO ALL THE TERMS, EXCLUSIONS AND CONDITIONS OF SUCH POLICIES. AGGREGATE LIMITS SHOWN MAY HAVE BEEN REDUCED BY PAID CLAIMS.

INSR LTR	ADD'L INSRD	TYPE OF INSURANCE	POLICY NUMBER	POLICY EFFECTIVE DATE (MM/DD/YY)	POLICY EXPIRATION DATE (MM/DD/YY)	LIMITS
A		GENERAL LIABILITY <input checked="" type="checkbox"/> COMMERCIAL GENERAL LIABILITY <input type="checkbox"/> CLAIMS MADE <input checked="" type="checkbox"/> OCCUR GEN'L AGGREGATE LIMIT APPLIES PER: <input type="checkbox"/> POLICY <input type="checkbox"/> PRO-JECT <input type="checkbox"/> LOC	6090179	1/17/2010	1/17/2011	EACH OCCURRENCE \$ 2,000,000 DAMAGE TO RENTED PREMISES (Ea occurrence) \$ 500,000 MED EXP (Any one person) \$ 5,000 PERSONAL & ADV INJURY \$ 2,000,000 GENERAL AGGREGATE \$ 4,000,000 PRODUCTS - COMP/OP AGG \$ 4,000,000
A		AUTOMOBILE LIABILITY <input type="checkbox"/> ANY AUTO <input type="checkbox"/> ALL OWNED AUTOS <input type="checkbox"/> SCHEDULED AUTOS <input checked="" type="checkbox"/> HIRED AUTOS <input checked="" type="checkbox"/> NON-OWNED AUTOS	6090179	1/17/2010	1/17/2011	COMBINED SINGLE LIMIT (Ea accident) \$ 2,000,000 BODILY INJURY (Per person) \$ BODILY INJURY (Per accident) \$ PROPERTY DAMAGE (Per accident) \$
		GARAGE LIABILITY <input type="checkbox"/> ANY AUTO				AUTO ONLY - EA ACCIDENT \$ OTHER THAN EA ACC \$ AUTO ONLY: AGG \$
A		EXCESS/UMBRELLA LIABILITY <input checked="" type="checkbox"/> OCCUR <input type="checkbox"/> CLAIMS MADE DEDUCTIBLE \$ RETENTION \$	6090179	1/17/2010	1/17/2011	EACH OCCURRENCE \$ 3,000,000 AGGREGATE \$ 3,000,000
B		WORKERS COMPENSATION AND EMPLOYERS' LIABILITY ANY PROPRIETOR/PARTNER/EXECUTIVE OFFICER/ MEMBER EXCLUDED? If yes, describe under SPECIAL PROVISIONS below	04 WEC LD4367	1/17/2010	1/17/2011	<input checked="" type="checkbox"/> WC STATU-TORY LIMITS <input type="checkbox"/> OTH-ER E.L. EACH ACCIDENT \$ 1,000,000 E.L. DISEASE - EA EMPLOYEE \$ 1,000,000 E.L. DISEASE - POLICY LIMIT \$ 1,000,000
		OTHER				

DESCRIPTION OF OPERATIONS/LOCATIONS/VEHICLES/EXCLUSIONS ADDED BY ENDORSEMENT/SPECIAL PROVISIONS
 1412 Congress Street, Portland, ME 04102
 Certificate holder is hereby named as additional insured

CERTIFICATE HOLDER City of Portland	CANCELLATION SHOULD ANY OF THE ABOVE DESCRIBED POLICIES BE CANCELLED BEFORE THE EXPIRATION DATE THEREOF, THE ISSUING INSURER WILL ENDEAVOR TO MAIL <u>10</u> DAYS WRITTEN NOTICE TO THE CERTIFICATE HOLDER NAMED TO THE LEFT, BUT FAILURE TO DO SO SHALL IMPOSE NO OBLIGATION OR LIABILITY OF ANY KIND UPON THE INSURER, ITS AGENTS OR REPRESENTATIVES. AUTHORIZED REPRESENTATIVE 
---	--