

**DEMOLITION GENERAL NOTES**

- A. ITEMS INDICATED TO BE REMOVED AND SALVAGED REMAIN OWNER'S PROPERTY. REMOVE, CLEAN, AND DELIVER TO OWNER'S DESIGNATED STORAGE AREA.
- B. COMPLY WITH EPA REGULATIONS AND HAULING AND DISPOSAL REGULATIONS OF AUTHORITIES HAVING JURISDICTION.
- C. OWNER WILL OCCUPY PORTIONS OF BUILDING IMMEDIATELY ADJACENT TO SELECTIVE DEMOLITION AREA. CONDUCT SELECTIVE DEMOLITION SO OWNER'S OPERATIONS WILL NOT BE DISRUPTED.
- D. IT IS NOT EXPECTED THAT HAZARDOUS MATERIALS WILL BE ENCOUNTERED IN THE WORK. IF MATERIALS SUSPECTED OF CONTAINING HAZARDOUS MATERIALS ARE ENCOUNTERED, DO NOT DISTURB; IMMEDIATELY NOTIFY ARCHITECT AND OWNER. OWNER WILL REMOVE HAZARDOUS MATERIALS UNDER A SEPARATE CONTRACT.
- E. MAINTAIN SERVICES/SYSTEMS INDICATED TO REMAIN AND PROTECT THEM AGAINST DAMAGE DURING SELECTIVE DEMOLITION OPERATIONS. BEFORE PROCEEDING WITH DEMOLITION, PROVIDE TEMPORARY SERVICES/SYSTEMS THAT BYPASS AREA OF SELECTIVE DEMOLITION AND THAT MAINTAIN CONTINUITY OF SERVICES/SYSTEMS TO OTHER PARTS OF THE BUILDING.
- F. LOCATE, IDENTIFY, SHUT OFF, DISCONNECT, AND CAP OFF UTILITY SERVICES AND MECHANICAL/ELECTRICAL SYSTEMS SERVING AREAS TO BE SELECTIVELY DEMOLISHED.
- G. PROVIDE TEMPORARY BARRICADES AND OTHER PROTECTION REQUIRED TO PREVENT INJURY TO PEOPLE AND DAMAGE TO ADJACENT BUILDINGS AND FACILITIES TO REMAIN.

- H. PROVIDE AND MAINTAIN SHORING, BRACING, AND STRUCTURAL SUPPORTS AS REQUIRED TO PRESERVE STABILITY AND PREVENT MOVEMENT, SETTLEMENT, OR COLLAPSE OF CONSTRUCTION AND FINISHES TO REMAIN OR CONSTRUCTION BEING DEMOLISHED.
- I. PROVIDE TEMPORARY WEATHER PROTECTION TO PREVENT WATER LEAKAGE AND DAMAGE TO STRUCTURE AND INTERIOR AREAS.
- J. PROTECT WALLS, CEILINGS, FLOORS, AND OTHER EXISTING FINISH WORK THAT ARE TO REMAIN. ERECT AND MAINTAIN DUSTPROOF PARTITIONS, COVER AND PROTECT FURNITURE, FURNISHINGS, AND EQUIPMENT THAT HAVE NOT BEEN REMOVED.
- K. NEATLY CUT OPENINGS AND HOLES PLUMB, SQUARE, AND TRUE TO DIMENSIONS REQUIRED. USE CUTTING METHODS LEAST LIKELY TO DAMAGE CONSTRUCTION TO REMAIN OR ADJOINING CONSTRUCTION.
- L. PROMPTLY REMOVE DEMOLISHED MATERIALS FROM OWNER'S PROPERTY AND LEGALLY DISPOSE OF THEM. DO NOT BURN DEMOLISHED MATERIALS.
- M. ITEMS TO BE REMOVED:
  1. SPECIFIC ITEMS AS INDICATED BY KEYNOTE AND LEGEND.
  2. FINISH FLOORING AND BASE IN ALL AREAS, EXCEPT AS NOTED.
  3. SUSPENDED CEILING GRID AND TILE, ALL AREAS.
  4. ALL HVAC EQUIPMENT IN CEILING INCLUDING DIFFUSERS AND GRILLES.
  5. LIGHT FIXTURES AND MISC. ELECTRICAL ITEMS.

**DEMOLITION KEYNOTES - THIS SHEET ONLY**

- D001 REMOVE PARTITION
- D002 REMOVE DOOR AND FRAME
- D003 REMOVE WINDOW AND BARS
- D004 REMOVE STOREFRONT DOOR, FRAMING, AND GLASS IN THIS OPENING
- D005 REMOVE PORTION OF COLUMN COVER TO PROVIDE CLEARANCE FOR NEW CORRIDOR
- D006 REMOVE WATER METER COVER BOX
- D007 REMOVE CERAMIC WALL TILE
- D008 REMOVE PLUMBING FIXTURE, SUPPLY AND WASTE PIPING
- D009 REMOVE GREASE TRAP AND WASTE PIPING
- D010 REMOVE FLOOR DRAIN AND WASTE PIPING
- D011 REMOVE DRAIN PIPING
- D012 REMOVE WATER HEATER
- D013 REMOVE WATER HEATER AND EXHAUST VENT
- D014 REMOVE CERAMIC FLOOR TILE

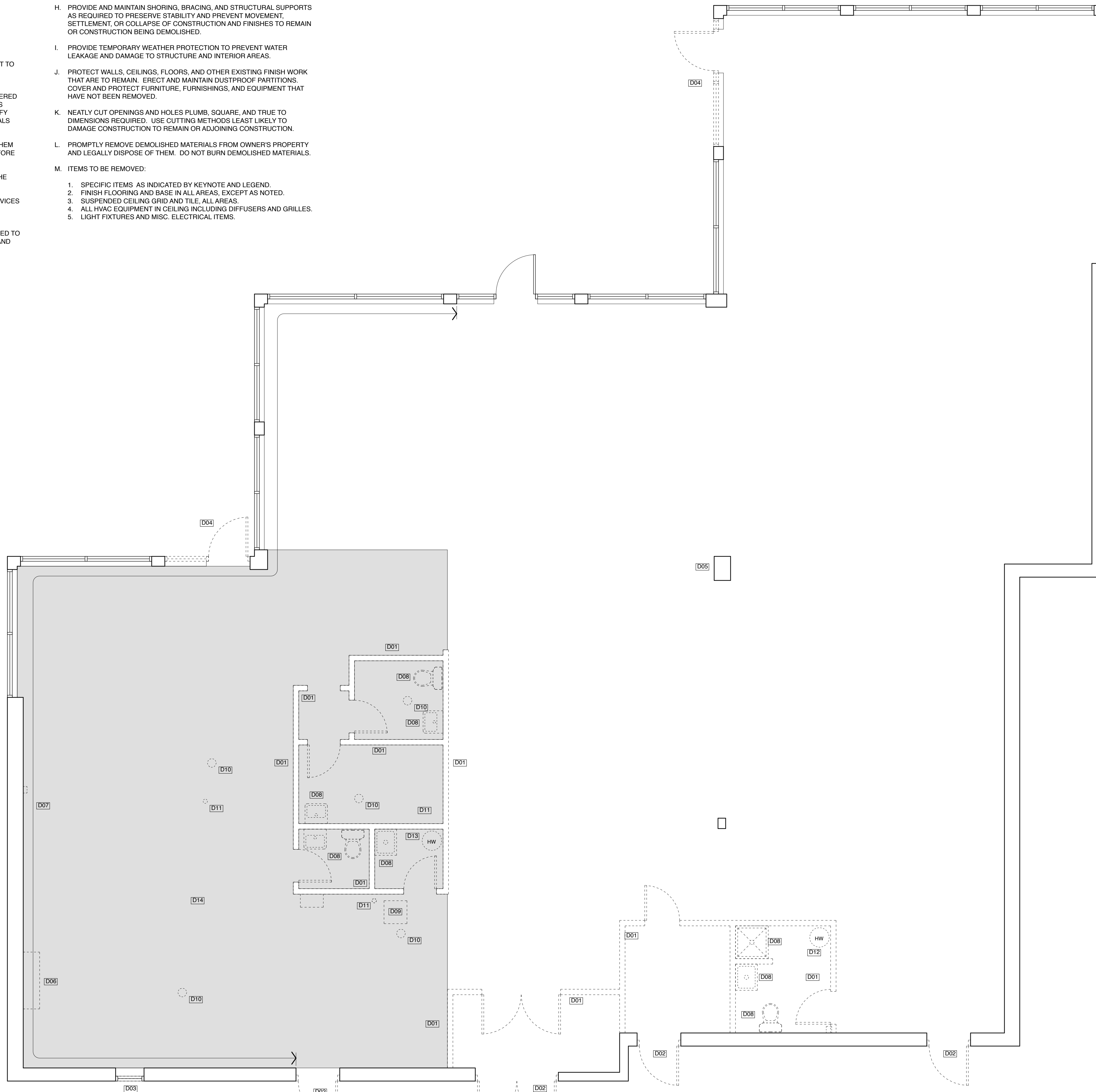

**1 DEMOLITION PLAN**  
 SCALE: 1/4" = 1'-0"  
 1' 2' 4' 8'

**PARTITIONS/WALLS KEY**  
 ——— EXISTING TO REMAIN  
 - - - - - PARTITION/WALL TO BE REMOVED

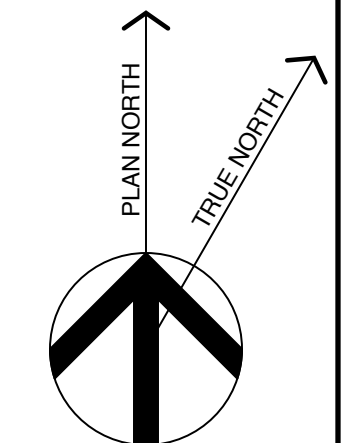

**Michael Charek Architects**

25 Hartley Street  
 Portland, Maine 04103  
 (207) 761-0656



**Offices for Casco Bay Eyecare**

1440 Congress Street  
 Portland, ME 04102

**Title**

DEMOLITION PLAN

**Scale:** 1/4" = 1'-0"

**Date:** 5/17/16

**Revisions**

**ISSUED FOR CONSTRUCTION**

**Sheet**

**D1**