

GENERAL NOTES

- BEFORE BEGINNING WORK AT THE SITE, AND THROUGHOUT THE COURSE OF THE WORK, INSPECT AND VERIFY THE LOCATION AND CONDITION OF EVERY ITEM AFFECTED BY THE WORK UNDER THIS CONTRACT AND REPORT DISCREPANCIES TO ARCHITECT BEFORE BEGINNING WORK RELATED TO THAT BEING INSPECTED.
- THE ARCHITECTURAL DRAWINGS SHOW PRINCIPAL AREAS WHERE WORK MUST BE ACCOMPLISHED UNDER THIS CONTRACT. INCIDENTAL WORK MAY ALSO BE NECESSARY IN AREAS NOT SHOWN ON THE ARCHITECTURAL DRAWINGS DUE TO CHANGES AFFECTING EXISTING MECHANICAL, ELECTRICAL, PLUMBING, OR OTHER SYSTEMS. SUCH INCIDENTAL WORK IS ALSO PART OF THIS CONTRACT. INSPECT THOSE AREAS, ASCERTAIN WORK NEEDED, AND DO THAT WORK IN ACCORDANCE WITH THE CONTRACT REQUIREMENTS, AT NO ADDITIONAL COST.
- DO NOT DRILL OR CUT EXISTING FLOOR JOISTS, BEAMS, COLUMNS, OR OTHER STRUCTURAL MEMBERS UNLESS SPECIFICALLY INDICATED.
- PROTECT EXISTING WORK TO REMAIN FROM DAMAGE.
- REPAIR, PATCH, AND FINISH, OR REFINISH AS APPLICABLE, TO MATCH ADJACENT EXISTING FINISHES, THOSE EXISTING SURFACES DAMAGED OR NEWLY EXPOSED DURING PERFORMANCE OF THE WORK. PATCH OPENINGS IN EXISTING WALLS LEFT BY REMOVAL OF EXISTING ELECTRICAL BOXES. SEE ELECTRICAL DRAWINGS FOR LOCATIONS AND QUANTITIES.
- PATCH EXISTING WALL SURFACES AS NEEDED TO PROVIDE A SMOOTH SURFACE FOR FINISHES.
- EXCEPT IN SPACES WHERE NO WORK UNDER THIS CONTRACT IS REQUIRED, ENCLOSE EXISTING AND NEW CONDUITS, DUCTS, PIPES, AND SIMILAR ITEMS IN FURRING WHERE SUCH ITEMS PASS THROUGH FINISHED SPACES WHETHER OR NOT FURRING IS INDICATED. INSULATE IN UNHEATED SPACES.
- WHERE CONDUITS, WIRES, PIPES, AND SIMILAR ITEMS ARE TO BE INSTALLED IN EXISTING WALLS OR PARTITIONS, NEATLY CHASE THE WALLS OR PARTITIONS, INSTALL THE ITEMS, AND PATCH THE WALLS OR PARTITIONS TO MAKE THE INSTALLATION NOT DISCERNIBLE IN THE FINISHED WORK.
- WHERE "MATCH EXISTING" IS INDICATED, NEW CONSTRUCTION OR FINISHES, AS APPROPRIATE TO THE NOTE, SHALL MATCH THE EXISTING IN EVERY PARTICULAR.
- DIMENSIONS ARE TO FINISH WALL SURFACE AND TO OPENING CENTERLINE UNLESS NOTED OTHERWISE.
- FURNITURE SHOWN ON PLAN IS BY OWNER.

PARTITION TYPES - SEE DETAIL SECTIONS ON SHEET A5

- P1** ALL NEW PARTITIONS UNLESS NOTED OTHERWISE:
3 5/8" STEEL STUD FRAMING 16" O.C.
5/8" GYPSUM BOARD BOTH SIDES
ACOUSTIC INSULATION FULL HEIGHT
PARTITION HEAD AT 9'-0" A.F.F. - BRACE TO STRUCTURE ABOVE
ACOUSTICAL SEALANT AT FLOOR TRACK
- P2** 6" STEEL STUD FRAMING 16" O.C.
5/8" GYPSUM BOARD BOTH SIDES
ACOUSTIC INSULATION FULL HEIGHT
PARTITION HEAD AT 9'-0" A.F.F. - BRACE TO STRUCTURE ABOVE
ACOUSTICAL SEALANT AT FLOOR TRACK
- P3** 1 5/8" STEEL STUDS 16" O.C. BOTH SIDES OF PARTITION
CONNECT TWO SIDES OF PARTITION WITH 3 5/8" RUNNER TRACK SPACED MAX 4'-0" O.C. VERTICALLY, EACH STUD
5/8" GYPSUM WALLBOARD ON FINISH SIDES OF STUDS
ACOUSTIC INSULATION FULL HEIGHT, ONE SIDE OF PARTITION
PARTITION HEAD AT 9'-0" A.F.F. - BRACE TO STRUCTURE ABOVE
ACOUSTICAL SEALANT AT FLOOR TRACK
- P4** 3 5/8" STEEL STUD FRAMING 16" O.C.
5/8" GYPSUM BOARD BOTH SIDES
ACOUSTIC INSULATION TO 6" ABOVE CEILING
PARTITION HEAD TO STRUCTURE ABOVE
ACOUSTICAL SEALANT AT FLOOR TRACK

NOTE: PARTITIONS AND WALLS NOT OTHERWISE NOTED BY PARTITION TYPE OR BY NEW WORK KEYNOTE ARE EXISTING TO REMAIN. PATCH AS NECESSARY AND PAINT.

NEW WORK KEYNOTES -- THIS SHEET ONLY

- N01** FILL IN STOREFRONT OPENING WITH ALUMINUM FRAMING AND GLASS AND INFILL WALL AT EXISTING DOOR OPENING. MATCH EXISTING.
- N02** PROVIDE CLOSET ROD AND SHELF.
- N03** WATER HEATER AND SUPPORT SHELF ABOVE MOP SINK.
- N04** FILL IN OPENING IN EXISTING WALL WITH CMU AND FINISHES TO MATCH EXISTING WALL.
- N05** PATCH COLUMN COVER TO MAKE FLUSH WITH NEW PARTITION.
- N06** FLOOR OUTLET, POWER AND DATA. IF NO DIMENSIONS ARE SHOWN, THE LOCATION IS TBD BY OWNER.
- N07** FURR WALL TO MAKE FLUSH WITH EXISTING WALL SURFACE.
- N08** FURR AND INSULATE CMU WALL SURFACE.
- N09** 24" X 24" METAL ACCESS PANEL FOR WATER METER ACCESS.
- N10** 4" DIAMETER INSET FOR TRASH DISPOSAL THROUGH COUNTERTOP, TYP.
- N11** WIRING GROMMET, TYP.
- N12** PROVIDE 1/2" PLYWOOD UNDER GYPSUM BOARD TO THIS SIDE OF PARTITION.
- N13** BABY CHANGING STATION

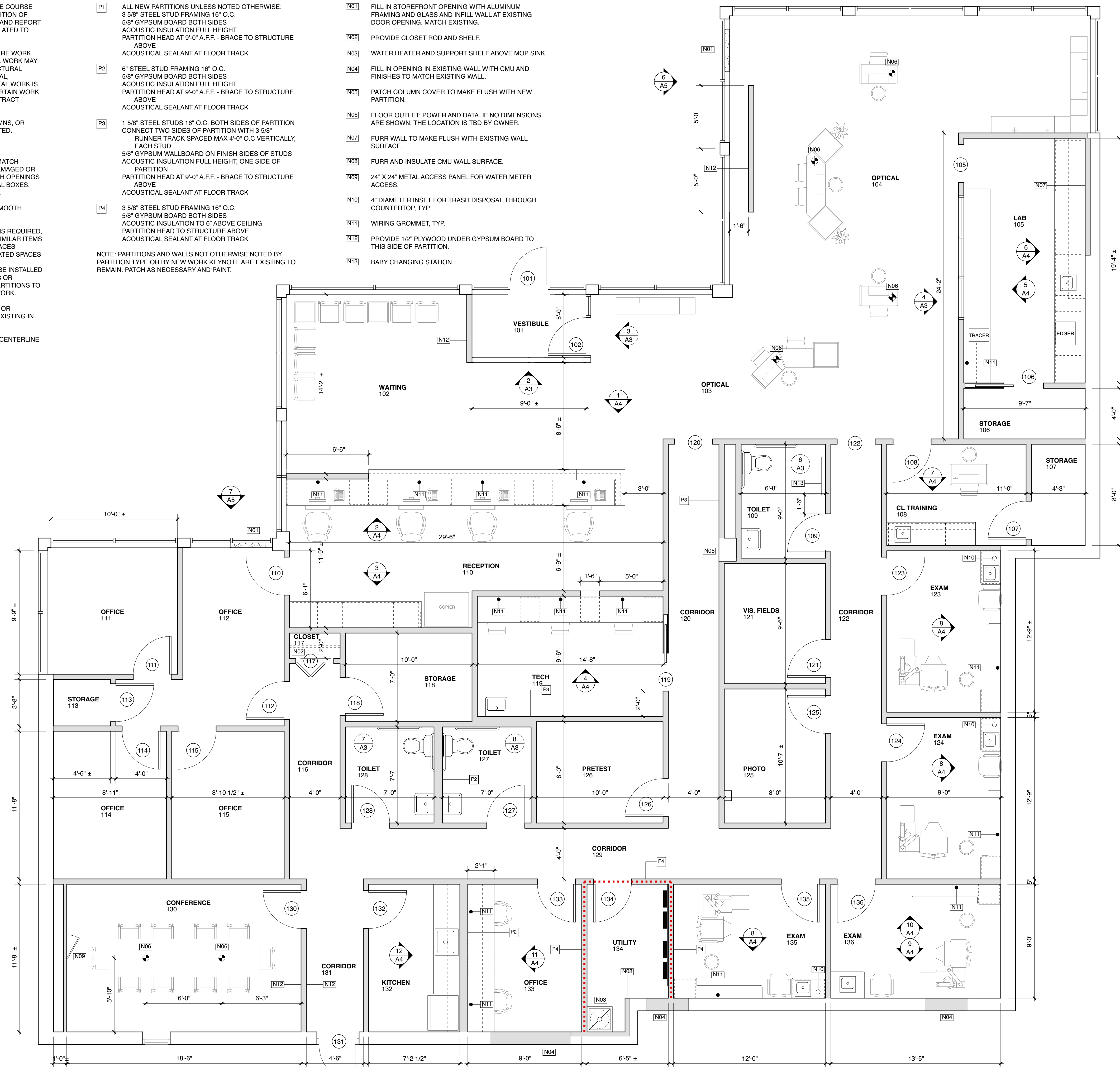

1 FLOOR PLAN
SCALE: 1/4" = 1'-0"
1' 2' 4' 8'

PARTITIONS/WALLS KEY
 ——— EXISTING TO REMAIN
 ——— NEW PARTITION WALL
 - - - - - 1-HOUR RATED PARTITION

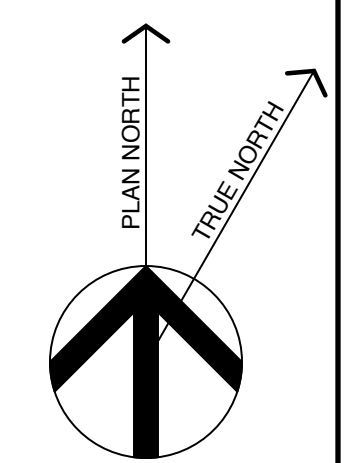

Michael Charek Architects
 25 Hartley Street
 Portland, Maine 04103
 (207) 761-0556

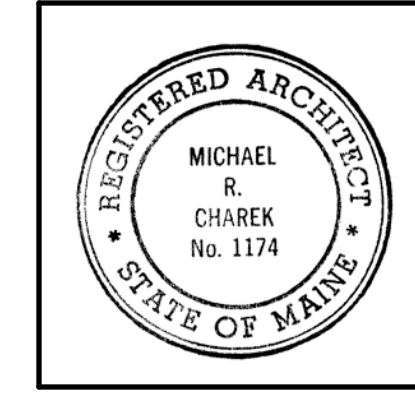

Offices for Casco Bay Eyecare
 1440 Congress Street
 Portland, ME 04102

Title	FLOOR PLAN
Scale:	1/4" = 1'-0"
Date:	5/17/16
Revisions	
ISSUED FOR CONSTRUCTION	
Sheet	A1