

SUBSURFACE WASTEWATER DISPOSAL SYSTEM APPLICATION

Maine Department of Human Services
Division of Health Engineering, Station 10
(207) 287-5672 FAX (207) 287-4172

Town, City, Plantation
PORTLAND

Street, Road, Subdivision
93 WESTLAND AVE.

Owner or Applicant Name
CHAD THOMPSON

INSTALLER TO CONFIRM ELEVATIONS
NECESSARY TO OBTAIN PROPER GRAVITY
DISTRIBUTION OR PUMP STATION MAY BE REQUIRED

SUBSURFACE WASTEWATER DISPOSAL PLAN

SCALE 1" = 20' FT.

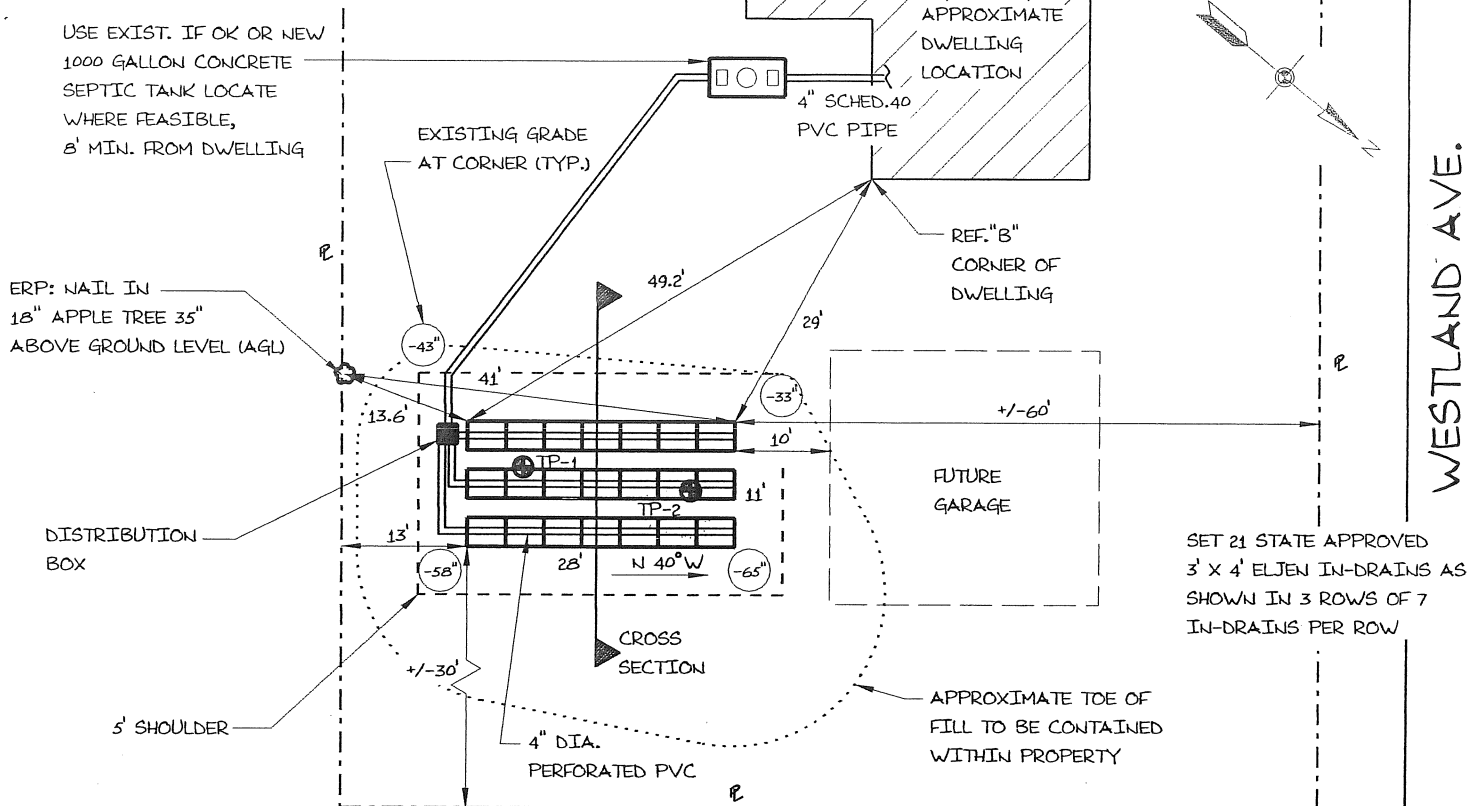

* IT IS THE OWNER'S RESPONSIBILITY TO VERIFY THAT THERE ARE NO UNIDENTIFIED WELLS LOCATED WITHIN 100' OF DISPOSAL SYSTEM.
* ALL INFORMATION CONTAINED WITHIN THIS APPLICATION IS AS REPRESENTED BY OWNER, APPLICANT OR OWNER'S/APPLICANT'S REPRESENTATIVE.
THE SITE EVALUATOR WILL NOT BE HELD RESPONSIBLE FOR ANY PERTINENT FACTORS NOT IDENTIFIED, DISCLOSED OR INACCURATELY DISCLOSED.

FILL REQUIREMENTS

Depth of Fill (Upslope) ± 5" - 15"
Depth of Fill (Downslope) ± 14" - 21"

CONSTRUCTION ELEVATIONS

Finished Grade Elevation -28" to -44"
Top of Distribution Pipe or Proprietary Device -40" to -56"
Bottom of Disposal Area -51" to -67"

ELEVATION REFERENCE POINT

Location & Description NAIL IN 18"
APPLE TREE 35" AGL
Reference Elevation -0"

DISPOSAL FIELD CROSS-SECTION

NOTES: * IN-DRAINS TO BE INSTALLED PER MANUFACTURER'S RECOMMENDATIONS
* BACKFILL TO BE GRAVELLY COARSE SAND FREE OF FINES AND ORGANIC DEBRIS
* FINAL GRADES SHALL BE LOAMED, SEEDED AND OR MULCHED TO PREVENT EROSION
* ANY STONE REQUIRED TO BE FREE OF FINES AND ORGANIC DEBRIS
AT A SIZE OF +/- 1 1/2" IN DIAMETER.

SCALES:

VERTICAL: 1" = 5 FT
HORIZONTAL: 1" = 5 FT

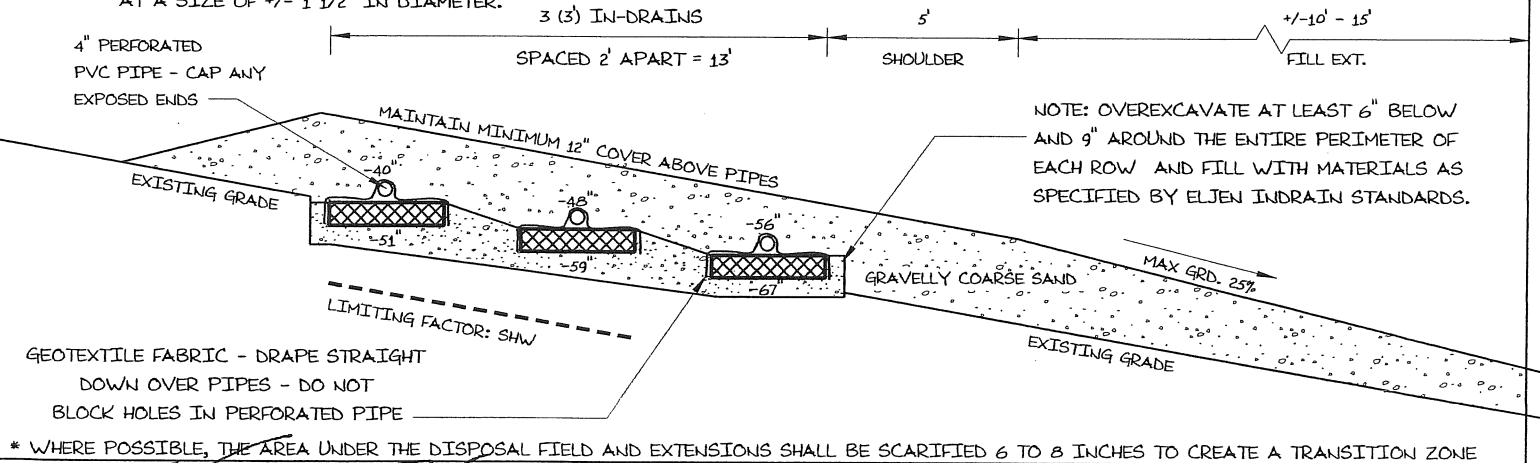

* WHERE POSSIBLE, THE AREA UNDER THE DISPOSAL FIELD AND EXTENSIONS SHALL BE SCARIFIED 6 TO 8 INCHES TO CREATE A TRANSITION ZONE

Site Evaluator Signature
NORMAN "BUD" HARRIS (HARRIS SEPTIC SOLUTIONS, INC.) (207) 892-2435

#348
SE

4/14/14
Date

Page 3 of 3
HHE-200 Rev. 10/02