

SITE NOTES:

1. STRIPE PARKING AREAS AS SHOWN, INCLUDING PARKING SPACES, STOP BARS, HANDICAP SYMBOLS, PAINTED ISLANDS, ARROWS, LEGENDS AND CENTERLINES (ALL MARKINGS EXCEPT CENTERLINE AND MEDIAN ISLANDS TO BE CONSTRUCTED USING WHITE TRAFFIC PAINT, CENTERLINE AND MEDIAN ISLANDS TO BE CONSTRUCTED USING YELLOW TRAFFIC PAINT. ALL TRAFFIC PAINT SHALL MEET THE REQUIREMENTS OF AASHTO M248 TYPE "F").
2. ALL PAVEMENT MARKINGS AND SIGNS TO CONFORM TO "MANUAL ON UNIFORM TRAFFIC CONTROL DEVICES", "STANDARD ALPHABETS FOR HIGHWAY SIGNS AND PAVEMENT MARKINGS", AND THE AMERICANS WITH DISABILITIES ACT REQUIREMENTS, LATEST EDITIONS.
3. SEE DETAILS FOR PARKING STALL MARKINGS, HANDICAP SYMBOLS, SIGNS AND SIGN POSTS.
4. CENTERLINES SHALL BE FOUR (4) INCH WIDE YELLOW LINES. STOP BARS SHALL BE EIGHTEEN (18) INCHES WIDE.
5. PAINTED ISLANDS SHALL BE FOUR (4) INCH WIDE DIAGONAL LINES AT 3'-0" O.C. BORDERED BY FOUR (4) INCH WIDE LINES.
6. THE CONTRACTOR SHALL EMPLOY A LICENSED ENGINEER/SURVEYOR TO DETERMINE ALL LINES AND GRADES. DESIGN ENGINEER TO PROVIDE COORDINATES FOR EDGE OF PAVEMENT, PC'S & PT'S.
7. CLEAN AND COAT VERTICAL FACE OF EXISTING PAVEMENT AT SAWCUT LINE WITH RS-1 EMULSION IMMEDIATELY PRIOR TO PLACING NEW BITUMINOUS CONCRETE.
8. ALL MATERIALS AND CONSTRUCTION SHALL CONFORM WITH APPLICABLE FEDERAL, STATE AND/OR CITY CODES & SPECIFICATIONS.
9. WORK WITHIN CONGRESS STREET SHALL BE COORDINATED WITH CITY OF PORTLAND AND THE MEDOT.
10. CONTRACTOR TO SUBMIT AS-BUILT PLANS ON REPRODUCIBLE MYLARS AND IN DIGITAL FORMAT (.DWG FILE) ON DISK TO THE OWNER AND ARCHITECT UPON COMPLETION OF THE PROJECT. AS-BUILTS SHALL BE PREPARED AND CERTIFIED BY A LICENSED LAND SURVEYOR OR PROFESSIONAL ENGINEER.
11. SEE ARCHITECTURAL DRAWINGS FOR ALL CONCRETE PADS & SIDEWALKS ADJACENT TO BUILDING.
12. ALL WORK SHALL CONFORM TO THE CITY OF PORTLAND DEPARTMENT OF PUBLIC WORKS, STANDARD SPECIFICATIONS.
13. CONTRACTOR TO PROVIDE BACKFILL AND COMPACTION AT CURB LINE AFTER CONCRETE FORMS FOR SIDEWALKS AND PADS HAVE BEEN STRIPPED. COORDINATE WITH BUILDING CONTRACTOR.
14. ALL LIGHT POLE BASES NOT PROTECTED BY A RAISED CURB SHALL BE PAINTED YELLOW.
15. COORDINATE ALL WORK ADJACENT TO BUILDING WITH BUILDING CONTRACTOR.
16. COORDINATE ALL CONSTRUCTION ADJACENT TO THE LIMIT OF WORK WITH THE LANDLORD SITE CONTRACTOR.

LEGEND

	PROPERTY LINE
	EXISTING CONCRETE/BITUMINOUS SIDEWALK
	PROPOSED CONCRETE SIDEWALK
	PROPOSED BITUMINOUS SIDEWALK
	PROPOSED CONCRETE PAD
	EXISTING SIGN
	PROPOSED SIGN
	PROPOSED LIGHT POLE BASE
	PROPOSED ACCESSIBLE PARKING SPACE
	PROPOSED PAINTED ARROWS
	SINGLE WHITE LANE LINE
	DOUBLE YELLOW LANE LINE
	VERTICAL GRANITE CURB
	SLOPED GRANITE CURB
	PROPOSED DOOR LOCATION
	PROPOSED CURB
	CURB RADIUS
	BIKE RACK

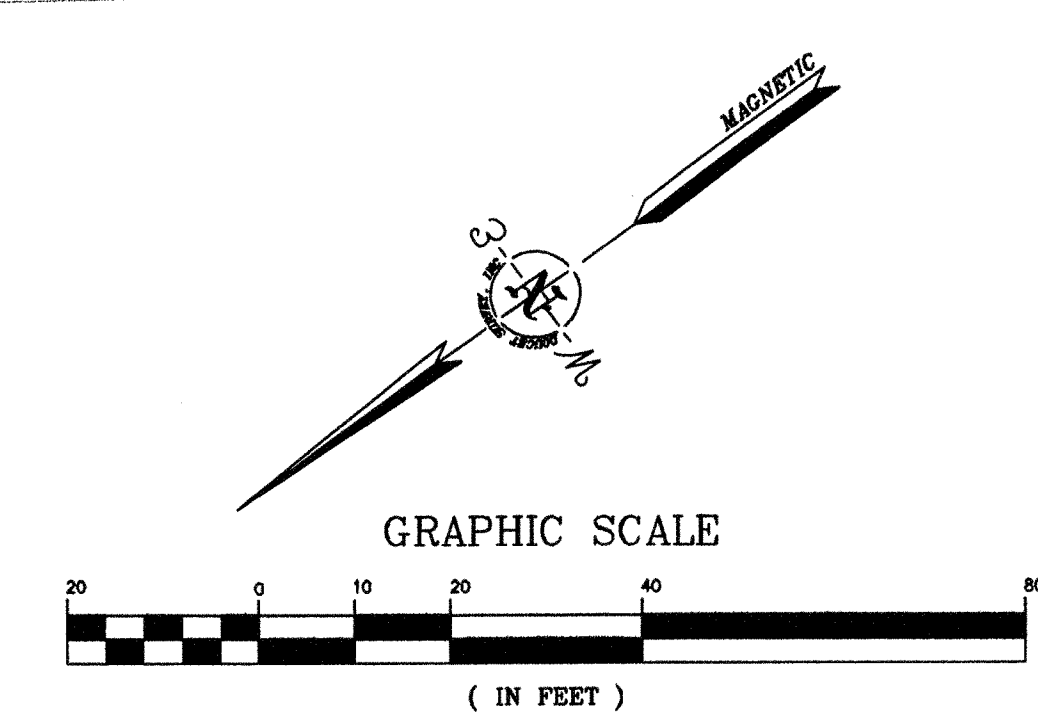
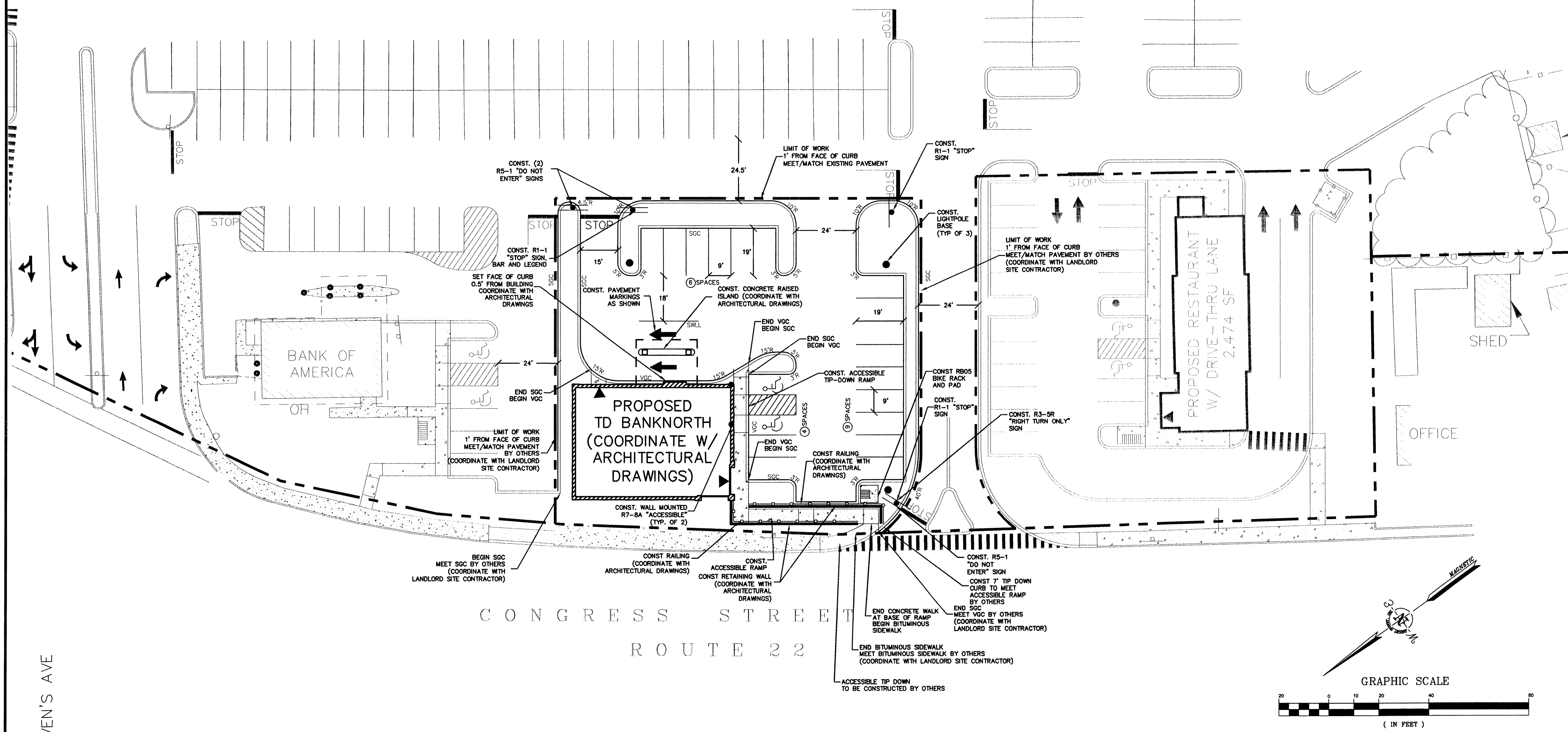

No.	Description	Appd	Date

REVISIONS

DATE: JUNE 23, 2008
 SCALE: AS SHOWN
 DESIGNED BY: GY/BLM
 DRAWN BY: SAM/KAM
 APPROVED BY: BLM
 PROJECT NO.: 2256
 FILE NO.: 2256-CONST.DWG

**TD BANKNORTH
 CONGRESS STREET
 PORTLAND, MAINE**

APPLEDORE ENGINEERING
 177 CORPORATE DRIVE
 PORTSMOUTH, NEW HAMPSHIRE 03801
 (603) 433-8818
 aei@appledoreeng.com

SITE PLAN

C-3

STEVEN'S AVE

CONGRESS STREET
 ROUTE 22