

C
H
I
J
K
M



CENTRAL MAINE POWER CO. N/F

INTERNALLY ILLUMINATED SIGN

ITALIAN HERITAGE CENTER
BANQUET & FUNCTION FACILITY

WELCOME

LED COLOR MESSAGE SIGN

16' MAX.

12'

30'

20

C.M.P. C
EASEMENT
881/259

B-1 Zone

max Sq. footage = 32' [#]

Showing 30' [#]

max height = 16'

16' Show

OK
OK

Marge Schmuckal - Re: Sign

From: Marge Schmuckal
To: Cammy Reali
Date: 5/9/2013 11:09 AM
Subject: Re: Sign

Hi Cammy,
 thank you for this. Can I also get a couple sketches of how the sign will actually look like? I am not understanding your written description that states a 3x6 cabinet with a 2x6 LED display. I also need in writing that the LED display will not flash, blink or scroll, nor change text more than once every 20 minutes.
 Thank you,
 Marge

>>> Cammy Reali <italian_heritage_center@yahoo.com> 5/9/2013 10:49 AM >>>

At the corner of Congress street and Westland Ave Italian Heritage Center

1. Excavate holes For sign base 3x4x4 Concrete base 3000psi
2. set 6x6 steel poles in grade 4 ft below grade
3. Install sign
4. (Trench Digging) Approximately 100 Ft from base of Telephone pole
5. Connect power to underground service for new sign, set a CMP certified meter
6. 3x6 Illuminated sign cabinet
7. 2x6 Monochrome LED Message Center cabinet

18[#]

12[#]

30[#]

Call to let me know you got all the information you needed

Frank Reali
 207-318-9567

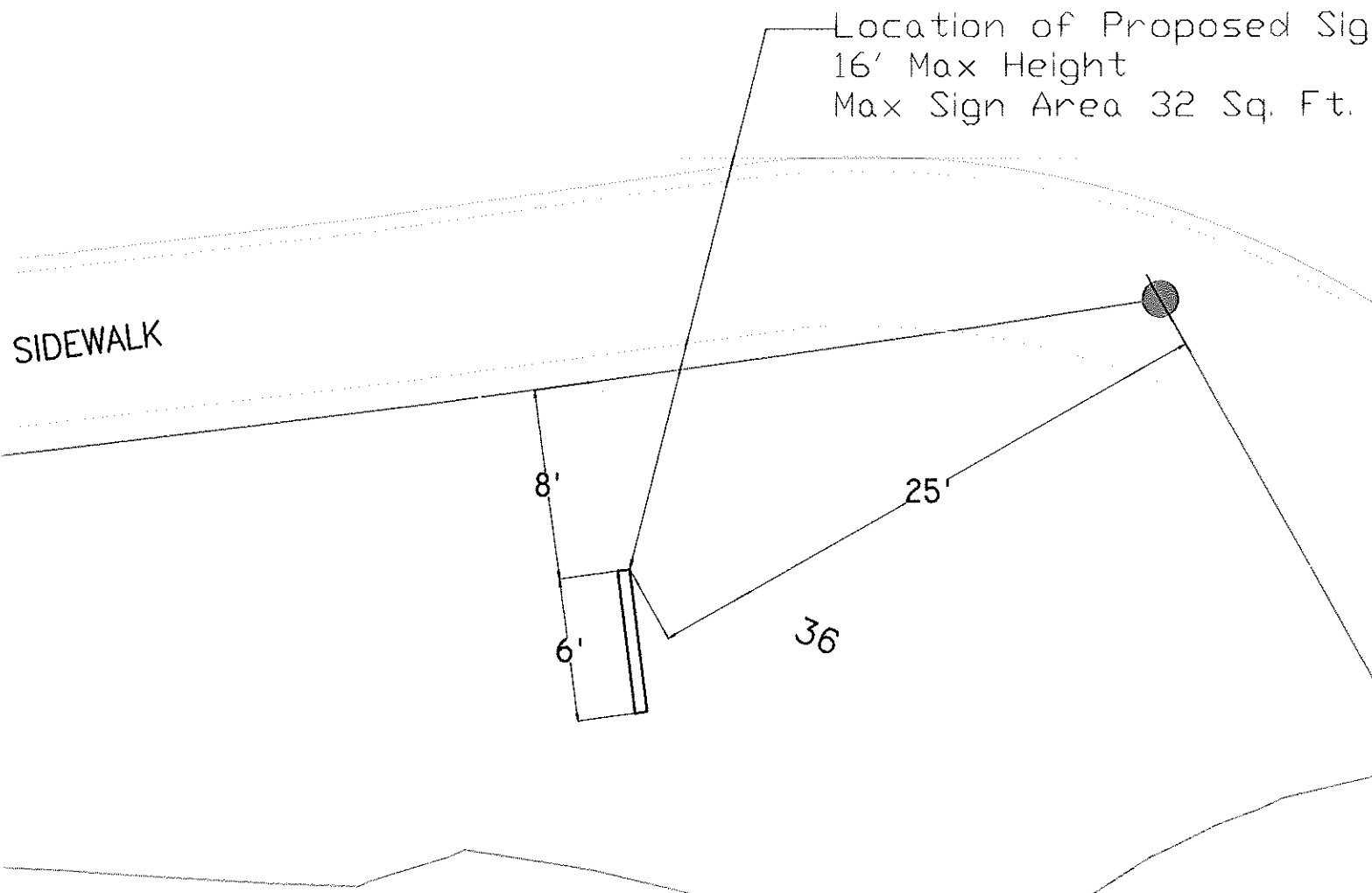

B-1 Zone

min setback is 5'³⁵ - 8' & 25' shown
OK

1399 Main St, Portland, Maine, United States



© 2018 Google. Image Date: July 2009

[Report a problem](#)

