

DISPLAY THIS CARD ON PRINCIPAL FRONTAGE OF WORK



CITY OF PORTLAND BUILDING PERMIT

This is to certify that AMY MALLEN

Located At 32 RABBIT RUN

Job ID: 2012-02-3306-ALTER

CBL: 196-G-015-001

has permission to Remove load bearing column & add new steel beam
provided that the person or persons, firm or corporation accepting this permit shall comply with all of the provisions of
the Statutes of Maine and of the Ordinances of the City of Portland regulating the construction, maintenance and use of
the buildings and structures, and of the application on file in the department.

Notification of inspection and written permission procured
before this building or part thereof is lathed or otherwise
closed-in. 48 HOUR NOTICE IS REQUIRED.

A final inspection must be completed by owner
before this building or part thereof is occupied. If a
certificate of occupancy is required, it must be

Fire Prevention Officer

Code Enforcement Officer / Plan Reviewer

THIS CARD MUST BE POSTED ON THE STREET SIDE OF THE PROPERTY

PENALTY FOR REMOVING THIS CARD

BUILDING PERMIT INSPECTION PROCEDURES

Please call 874-8703 or 874-8693 (ONLY)

or email: buildinginspections@portlandmaine.gov

With the issuance of this permit, the owner, builder or their designee is required to provide adequate notice to the city of Portland Inspections Services for the following inspections. Appointments must be requested 48 to 72 hours in advance of the required inspection. The inspection date will need to be confirmed by this office.

- **Please read the conditions of approval that is attached to this permit!! Contact this office if you have any questions.**
- **Permits expire in 6 months. If the project is not started or ceases for 6 months.**
- **If the inspection requirements are not followed as stated below additional fees may be incurred due to the issuance of a "Stop Work Order" and subsequent release to continue.**

Required Inspections:

Close In Elec/Plmb/Frame prior to insulate or gyp

Final Inspection

The project cannot move to the next phase prior to the required inspection and approval to continue, REGARDLESS OF THE NOTICE OF CIRCUMSTANCES.

IF THE PERMIT REQUIRES A CERTIFICATE OF OCCUPANCY, IT MUST BE PAID FOR AND ISSUED TO THE OWNER OR DESIGNEE BEFORE THE SPACE MAY BE OCCUPIED.

City of Portland, Maine - Building or Use Permit Application

389 Congress Street, 04101 Tel: (207) 874-8703, FAX: (207) 8716

Job No: 2012-02-3306-ALTR	Date Applied: 2/17/2012	CBL: 196- G-015-001	
Location of Construction: 32 RABBIT RUN	Owner Name: AMY M ALLEN ABBOTT	Owner Address: 32 RABBIT RUN, PORTLAND, ME 04102	Phone: 871-7917
Business Name:	Contractor Name: Vincent Diyenno- Portland Handyman Services	Contractor Address: 40 KENILWORTH, PORTLAND MAINE 04102	Phone: 450-5947
Lessee/Buyer's Name:	Phone:	Permit Type: BLDG ALT.	Zone: R-3
Past Use: Single Family	Proposed Use: Same: Single Family – to remove load bearing column and add new steel beam in kitchen	Cost of Work: \$4,000.00	CEO District:
		Fire Dept: <input checked="" type="checkbox"/> Approved <input type="checkbox"/> Denied <input type="checkbox"/> N/A	Inspection: Use Group: <i>123</i> Type: <i>SB</i> <i>JRC 09</i> Signature:
Proposed Project Description: Remove load bearing column & add new steel beam		Pedestrian Activities District (P.A.D.)	
Permit Taken By: Brad		Zoning Approval	

<p>1. This permit application does not preclude the Applicant(s) from meeting applicable State and Federal Rules.</p> <p>2. Building Permits do not include plumbing, septic or electrical work.</p> <p>3. Building permits are void if work is not started within six (6) months of the date of issuance. False informatin may invalidate a building permit and stop all work.</p>	<p>Special Zone or Reviews</p> <p><input type="checkbox"/> Shoreland</p> <p><input type="checkbox"/> Wetlands</p> <p><input type="checkbox"/> Flood Zone</p> <p><input type="checkbox"/> Subdivision</p> <p><input type="checkbox"/> Site Plan</p> <p>___ Maj ___ Min ___ MM</p> <p>Date: <i>OK</i> <i>2/17/12</i></p>	<p>Zoning Appeal</p> <p><input type="checkbox"/> Variance</p> <p><input type="checkbox"/> Miscellaneous</p> <p><input type="checkbox"/> Conditional Use</p> <p><input type="checkbox"/> Interpretation</p> <p><input type="checkbox"/> Approved</p> <p><input type="checkbox"/> Denied</p> <p>Date:</p>	<p>Historic Preservation</p> <p><input checked="" type="checkbox"/> Not in Dist or Landmark</p> <p><input type="checkbox"/> Does not Require Review</p> <p><input type="checkbox"/> Requires Review</p> <p><input type="checkbox"/> Approved</p> <p><input type="checkbox"/> Approved w/Conditions</p> <p><input type="checkbox"/> Denied</p> <p>Date: </p>
	CERTIFICATION		

I hereby certify that I am the owner of record of the named property, or that the proposed work is authorized by the owner of record and that I have been authorized by the owner to make this application as his authorized agent and I agree to conform to all applicable laws of this jurisdiction. In addition, if a permit for work described in the appication is issued, I certify that the code official's authorized representative shall have the authority to enter all areas covered by such permit at any reasonable hour to enforce the provision of the code(s) applicable to such permit.

SIGNATURE OF APPLICANT	ADDRESS	DATE	PHONE
RESPONSIBLE PERSON IN CHARGE OF WORK, TITLE		DATE	PHONE

R-3

647



General Building Permit Application

If you or the property owner owes real estate or personal property taxes or user charges on any property within the City, payment arrangements must be made before permits of any kind are accepted.

Location/Address of Construction: <u>32 RABBIT RUN PORTLAND, ME 04102</u>		
Total Square Footage of Proposed Structure/Area <u>N/A</u>	Square Footage of Lot <u>13737</u>	Number of Stories <u>2</u>
Tax Assessor's Chart, Block & Lot Chart# <u>196</u> Block# <u>G</u> Lot# <u>15</u>	Applicant *must be owner, Lessee or Buyer* Name <u>AMY ALLEN ABBOTT</u> Address <u>32 RABBIT RUN</u> City, State & Zip <u>PORTLAND, ME 04102</u>	Telephone: <u>871-7917</u>
Lessee/DBA (If Applicable) <u>/</u>	Owner (if different from Applicant) Name <u>AMY ALLEN ABBOTT</u> Address <u>32 RABBIT RUN</u> City, State & Zip <u>PORTLAND, ME 04102</u>	Cost Of Work: \$ <u>4,000</u> C of O Fee: \$ <u>—</u> Total Fee: \$ <u>60.00</u>
Current legal use (i.e. single family) <u>SINGLE FAMILY</u> Number of Residential Units <u>1</u> If vacant, what was the previous use? <u>—</u> Proposed Specific use: <u>KITCHEN COLUMN REMOVAL</u> Is property part of a subdivision? <u>NO</u> If yes, please name <u>—</u> Project description: <u>REMOVE LOAD BEARING COLUMN AND ADD NEW STEEL BEAM</u>		
Contractor's name: <u>PORTLAND HANDYMAN SERVICES</u> Address: <u>40 KENILWORTH ST</u> City, State & Zip <u>PORTLAND, ME 04102</u> Telephone: <u>450-5947</u> Who should we contact when the permit is ready: <u>VINCENT DIENNO</u> Telephone: <u>450-5947</u> Mailing address: <u>SAME AS ABOVE</u>		

Please submit all of the information outlined on the applicable Checklist. Failure to do so will result in the automatic denial of your permit.

In order to be sure the City fully understands the full scope of the project, the Planning and Development Department may request additional information prior to the issuance of a permit. For further information or to download copies of this form and other applications visit the Inspections Division on-line at www.portlandmaine.gov, or stop by the Inspections Division office, room 315 City Hall or call 874-8703.

I hereby certify that I am the Owner of record of the named property, or that the owner of record authorizes the proposed work and that I have been authorized by the owner to make this application as his/her authorized agent. I agree to conform to all applicable laws of this jurisdiction. In addition, if a permit for work described in this application is issued, I certify that the Code Official's authorized representative shall have the authority to enter all areas covered by this permit at any reasonable hour to enforce the provisions of the codes applicable to this permit.

Signature: [Signature]

Date: 2/17/2012

This is not a permit; you may not commence ANY work until the permit is issued

RECEIVED
FEB 17 2012
INSPECTIONS DIVISION

2012 02 3306

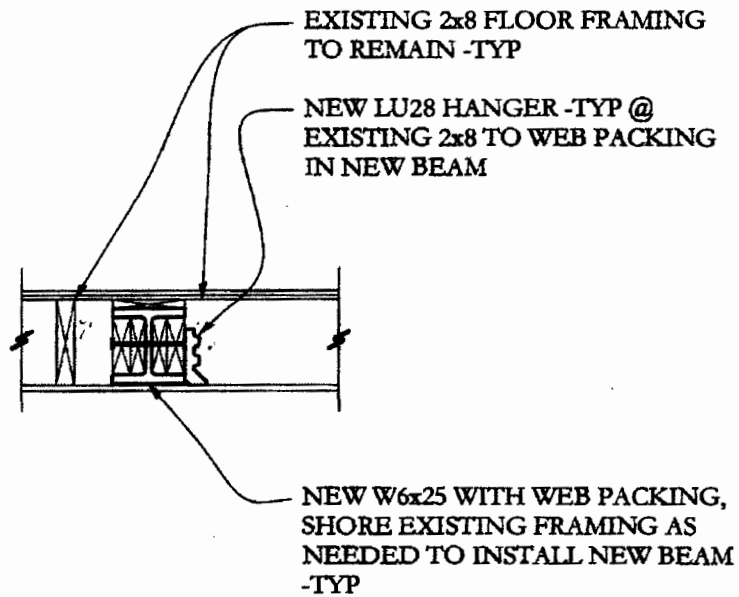

SECTION



3/4"=1'-0"



Title: Section

Structural Integrity
Engineering & Construction, Inc.

77 Oak Street
Portland, ME, 04106
P. 207-774-6534
F. 207-798-7838
www.structuralintegrity.com

BUILD WITH CONFIDENCE
©2012 Structural Integrity Consulting Engineers, Inc.

SI JOB# 12-0006

New Beam/ Column Removal

32 Rabbit Run
Portland, ME

Scale: 3/4"=1'-0"

Date: 2/7/12

SKS-2

ABBOTT
32 RABBIT RUN

