

No 196

196

CITY OF PORTLAND
ASSESSORS PLAN
SCALE 1" = 50'

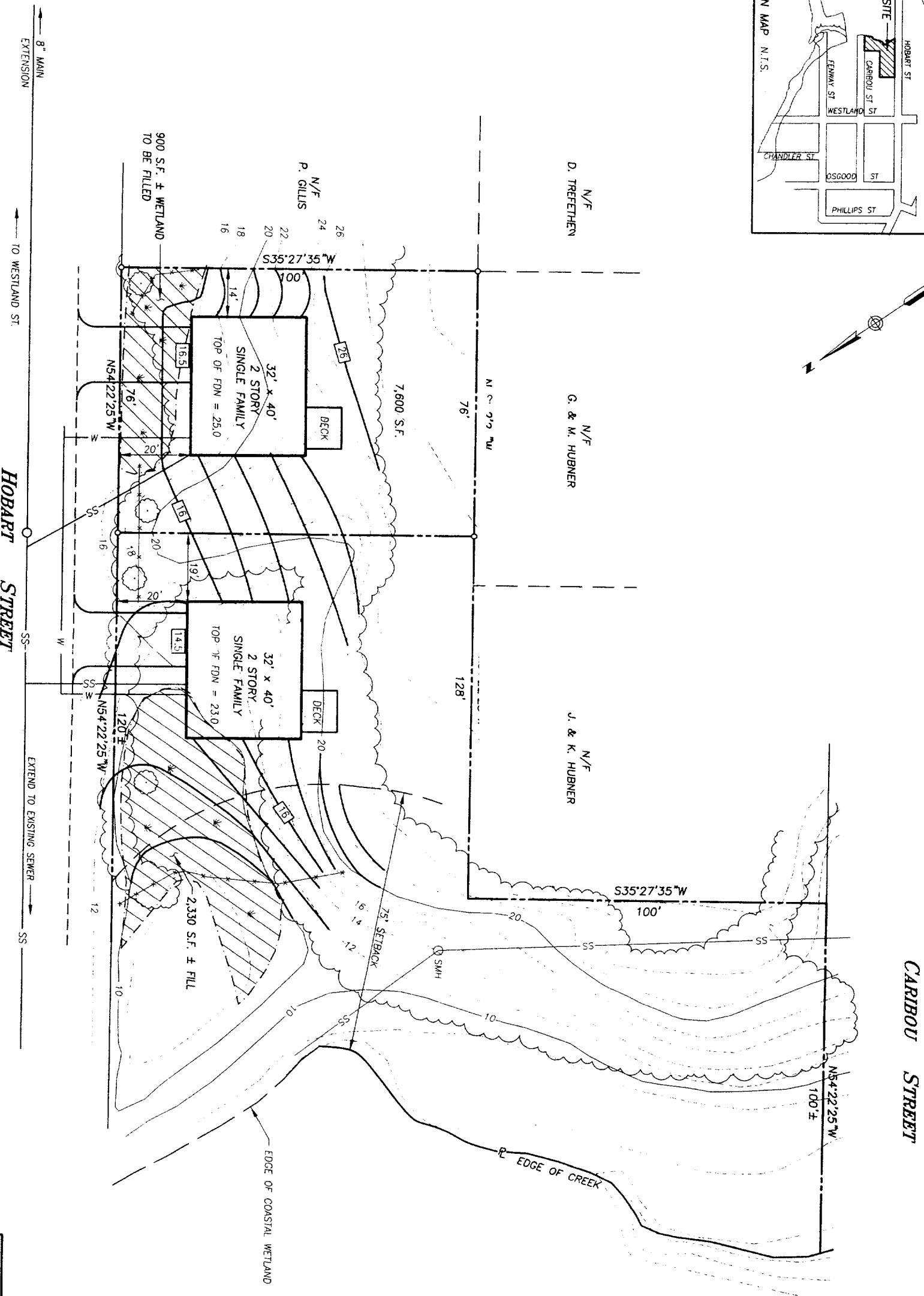
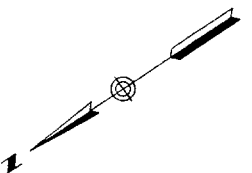
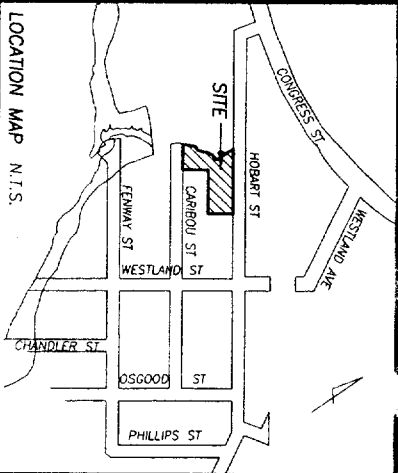

- LEGEND:**
- IRON ROD TO BE SET
 - SILT FENCE
 - 2" MAPLE
- ZONING:**
- AREA: 6,000 S.F.
 - AREA/DWELLING UNIT: 3,000 S.F.
 - FRONTAGE: 50 FT.
 - LOT WIDTH: 60 FT.
 - FRONT SETBACK: 20 FT.
 - SIDE SETBACK: 8 FT. TO 14 FT.
 - REAR SETBACK: 20 FT.
- GRAPHIC SCALE**
- 0 10' 20' 40'

- NOTES:**
- 1) ALL UNITS TO BE HOOKED TO WATER MAIN IN HOBART ST.
 - 2) TOTAL WETLANDS FILL 1,300 S.F. ±.
 - 3) EACH LOT TO HAVE TWO (2) STREET TREES.
 - 4) EACH LOT TO RUN FOUNDATION DRAIN TO DAYLIGHT.
 - 5) TOPOGRAPHY IS AERIAL BASED ON CITY DATUM.
 - 6) PARKING IN GARAGE FOR 2 CARS ON EACH LOT.

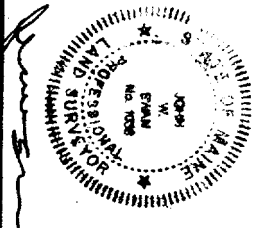

PLAN OF LAND	
#53-65 HOBART STREET PORTLAND, MAINE	
MADE FOR HIGGINS BUILDERS, INC.	
242 VERANDA STREET, PORTLAND, MAINE	
OWEN HASKELL, INC.	
PROFESSIONAL LAND SURVEYORS	
16 CASCO ST., PORTLAND, ME 04101 (207) 774-0424	
Drawn By	ECL
Trace By	JLW
Check By	JWS
Date	AUGUST 11, 2004
Scale	1" = 20'
Job No.	2005-122P
Draw. No.	1