

- Page 1 Description of the shed, picture from Website
- Page 2 Drawing of the placement, same location as old shed
- Page 3 Picture of the house, showing old shed, from the street

Shed Application to remove old 8'X8' shed and install a new 8'X8' shed. The Shed is made by ShedsUSA. It will look like this picture, light gray with white trim and black shingles and sitting on blocks. I have included the site drawing showing dimensions from property lines and the house. The sidewalls are 4' high and the peak will be 8' high, same as old shed.

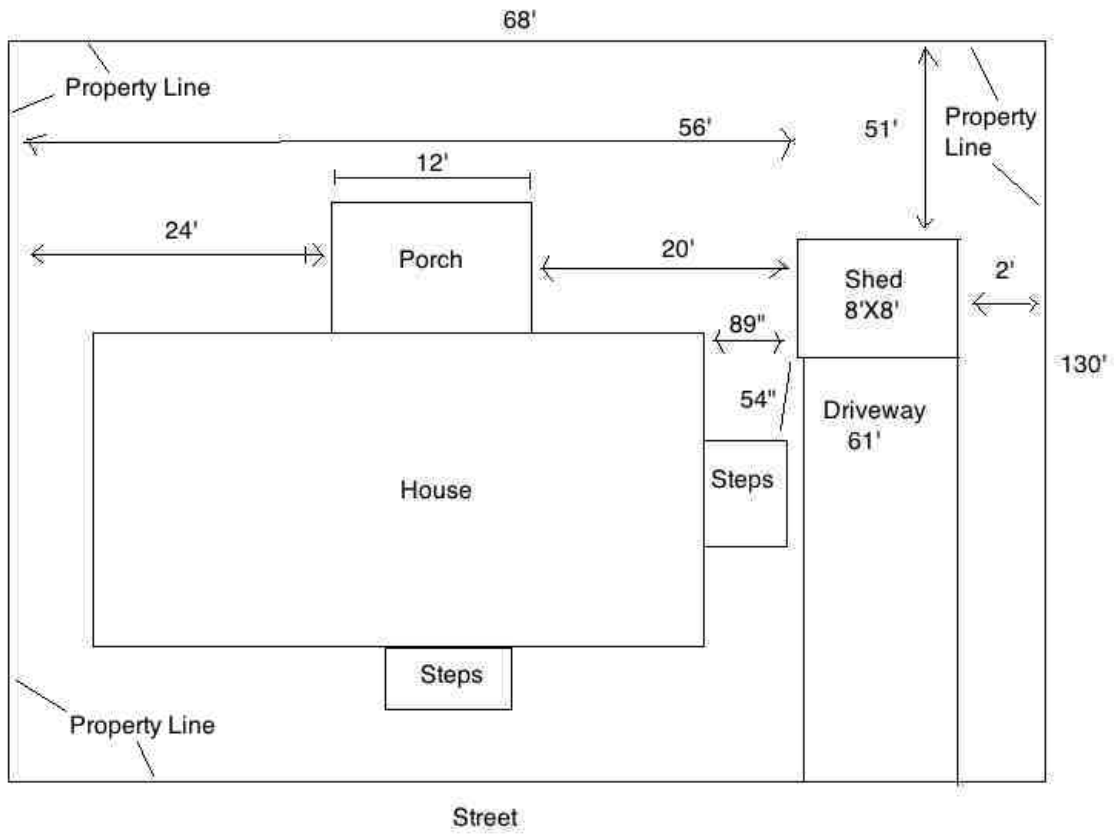

238 Bancroft St.
Portland, ME 04102

