

LOCATION MAP
SCALE: 1" = .5 MILES

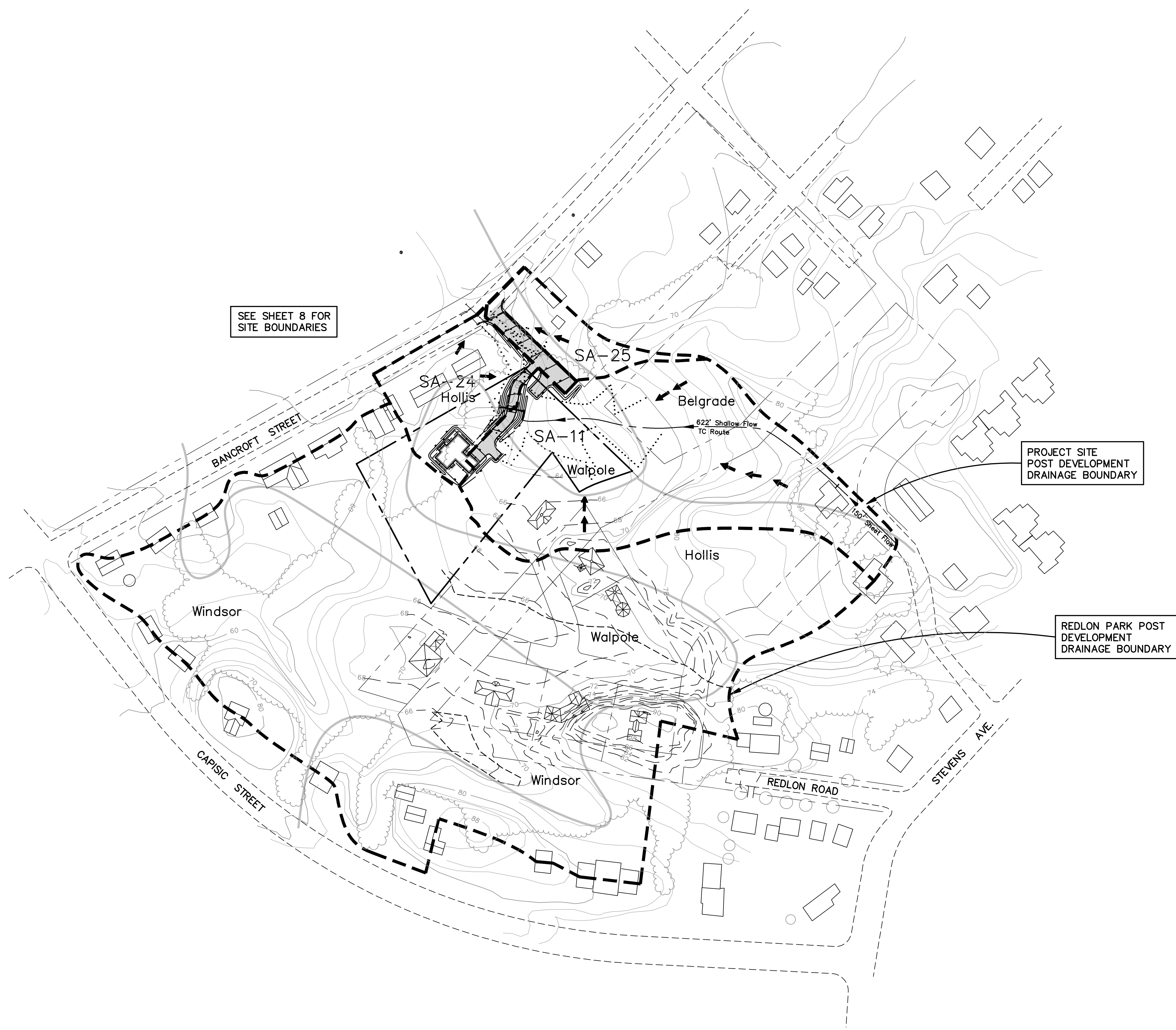

SEE SHEET 8 FOR
SITE BOUNDARIES

PROJECT SITE
POST DEVELOPMENT
DRAINAGE BOUNDARY

REDLON PARK POST
DEVELOPMENT
DRAINAGE BOUNDARY

SOILS LEGEND

SYMBOL	DESCRIPTION
	SOIL BOUNDARY LINES
	LIMIT OF WETLANDS
	DRAINAGE BOUNDARY
	FLOW DIRECTION

HYDROLOGIC SOIL GROUP	
SOIL	GROUP
HOLLIS	C/D
WINDSOR	A
WALPOLE	C
BELGRADE	B

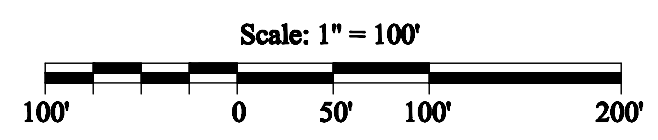

NOTES:

- TOPOGRAPHY: PLAN ENTITLED "DRAINAGE ANALYSIS, REDLON PARK" DATED JUNE 4, 1997, BY PINKHAM & GREER.
- BOUNDARY: BH2M
ROBER C. LIBBY JR. PLS #2190
28 STATE STREET
GORHAM, MAINE
- WETLAND DELINEATION: MARK HAMPTON & ASSOCIATES
PORTLAND, MAINE
- BENCHMARK: SURVEY CONTROL POINT #9
PK NAIL SET IN PAVEMENT ON BANCROFT STREET, ELEVATION=58.89'
CITY OF PORTLAND DATUM
- SOILS: CUMBERLAND COUNTY SOILS SURVEY, MEDIUM INTENSITY SOILS MAPS.

NO.	DATE	REVISION DESCRIPTION
1	3/12/12	Submitted Level I & II Site Plans
2	8/29/12	Revisions for Level I & II Applications
3	11/12/12	Revisions for Level I & II Applications Per City Comments
4	4/15/13	Revisions for Level I & II Applications Per City Comments



BH2M
Berry, Huff, McDonald, Milligan Inc.
Engineers, Surveyors
28 State Street
Gorham, Maine 04038
Tel: (207) 859-2771
Fax: (207) 859-8550

FOR
Chabad Lubobitch
Bancroft Street
Portland, Maine

VICINITY
POST DEVELOPMENT
LAND OF
CHABAD LUBOBITCH OF MAINE INC.
POMEROY STREET
PORTLAND, MAINE

DESIGNED L. Berry	DATE Jan. 2012
DRAWN Dept.	SCALE As Noted
CHECKED L. Berry	JOB. NO. 11093

SHEET
7

REPRODUCTION OR REUSE OF THIS DOCUMENT WITHOUT THE EXPRESSED WRITTEN CONSENT OF BH2M INC. IS PROHIBITED