

TYPICAL FOUNDATION DETAIL

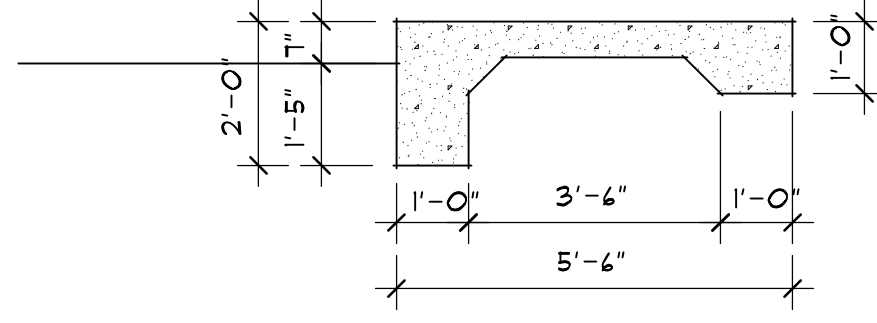

DETAIL AT FRONT ENTRY

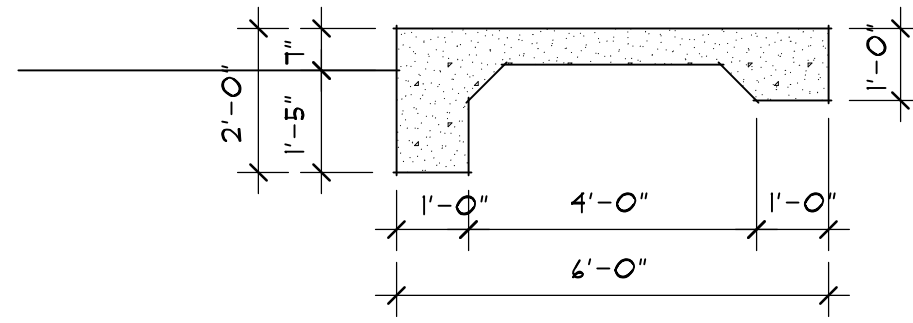

DETAIL AT SIDE ENTRY

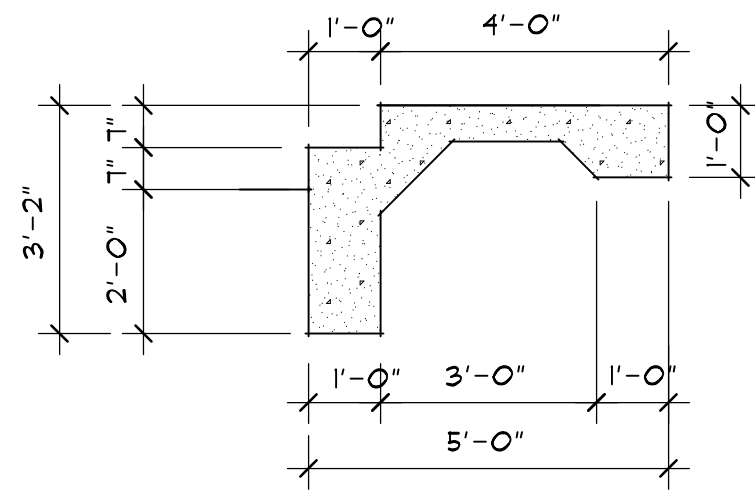

DETAIL AT REAR ENTRY

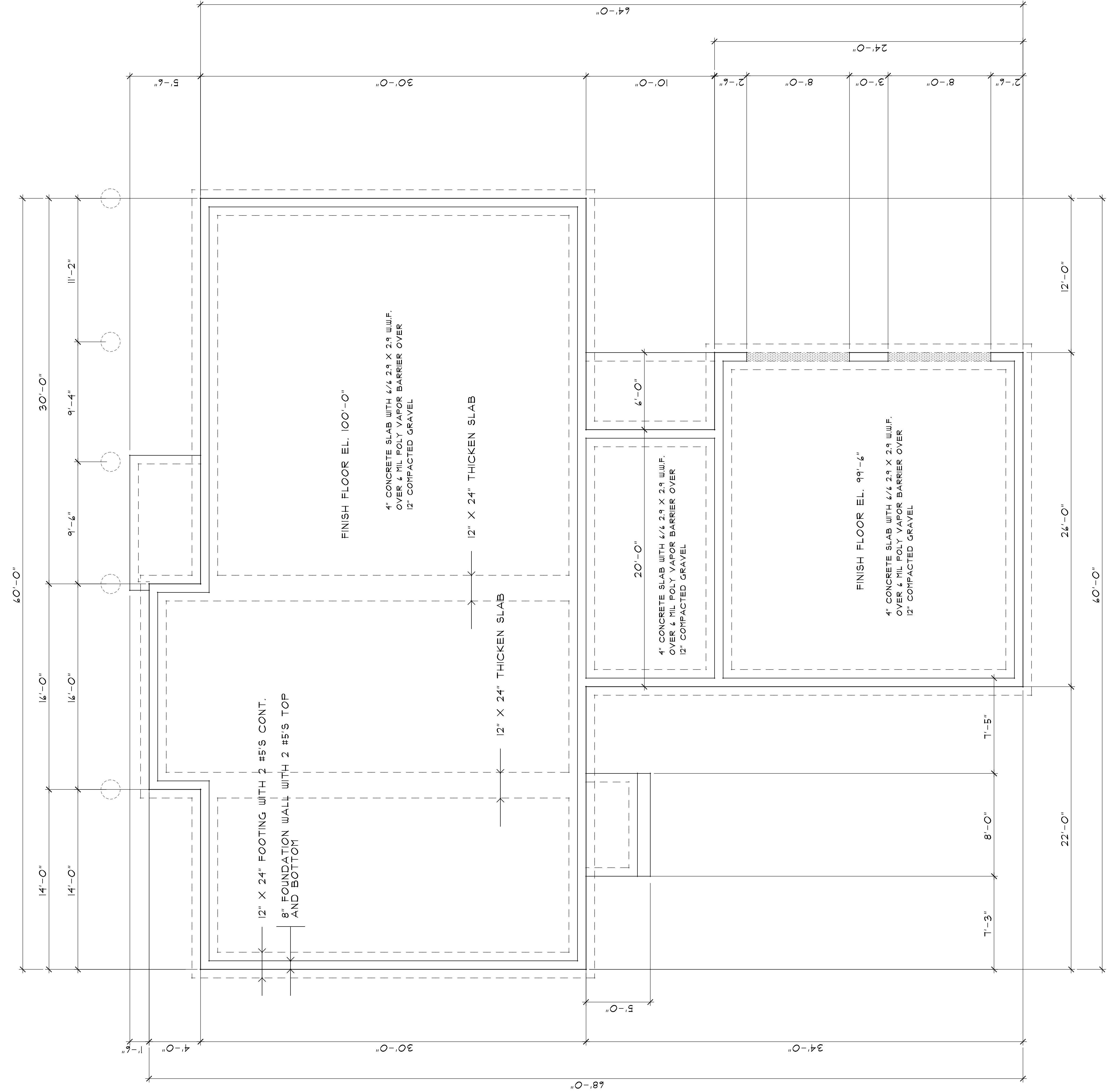

FOUNDATION PLAN

SCALE: 1/4" = 1'-0"

NO.	DESCRIPTION OF REVISION	DATE

NEW RESIDENCE
POMEROY STREET
PORTLAND, MAINE

Gleason Architects
P.O. BOX 596, 152 PORTSMOUTH AVENUE
STRATHAM, NEW HAMPSHIRE 03885
603 772-7370 FAX. NO. 603 772-6044

ARCHITECT

ENGINEER
DATE: 04/15/12
PROJECT NO. 201207
SHEET NO.

A-1
OF SHEETS