

PERMIT SET ONLY -
FOR REVIEW
BY AUTHORITIES HAVING
JURISDICTION

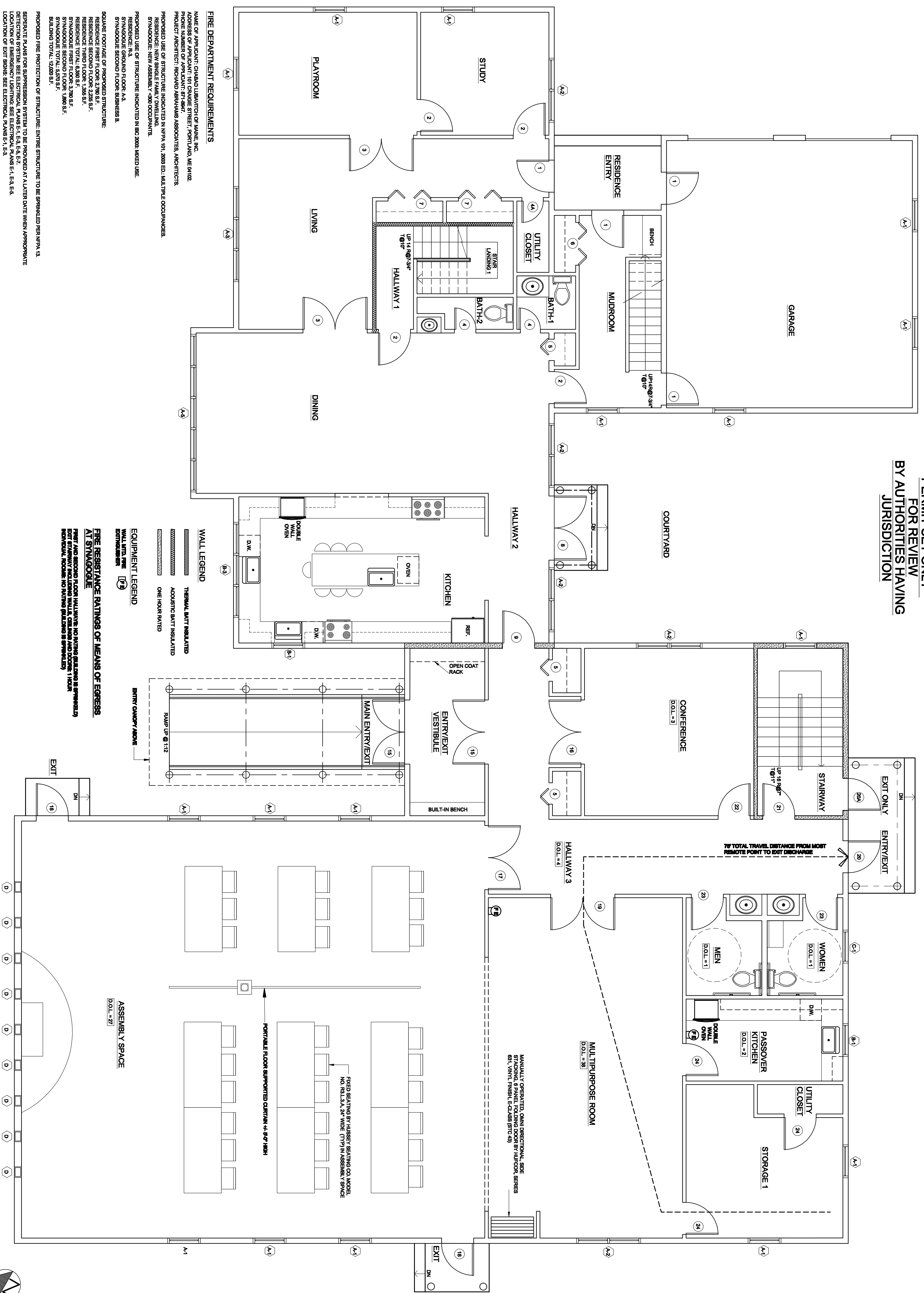

FIRE DEPARTMENT REQUIREMENTS

NAME OF APPLICANT: CHANA LIBRANTO-OF MAINE, INC.
ADDRESS OF APPLICANT: 101 CRAIGIE STREET, PORTLAND, ME 04102
PHONE NUMBER OF APPLICANT: 877-8847
PROJECT ARCHITECT: RICHARD ABRAHAM'S ASSOCIATES, ARCHITECTS
PROPOSED USE OF STRUCTURE INDICATED IN NFPA 101, 2009 ED.: MULTIPLE OCCUPANCIES
RESIDENCE: NEW SINGLE FAMILY DWELLING
SYNAGOGUE: NEW ASSEMBLY - 200 OCCUPANTS

PROPOSED USE OF STRUCTURE INDICATED IN IRC 2003 MIXED USE.

RESIDENCE: 1A
SYNAGOGUE: 2A
SYNAGOGUE SECOND FLOOR: BUSINESS B.

SQUARE FOOTAGE OF PROPOSED STRUCTURE:

RESIDENCE FIRST FLOOR: 2,780 S.F.
RESIDENCE SECOND FLOOR: 1,228 S.F.
RESIDENCE THIRD FLOOR: 1,228 S.F.
RESIDENCE TOTAL: 5,236 S.F.
SYNAGOGUE FIRST FLOOR: 3,780 S.F.
SYNAGOGUE SECOND FLOOR: 1,880 S.F.
SYNAGOGUE TOTAL: 5,660 S.F.
BUILDING TOTAL: 10,896 S.F.

PROPOSED FIRE PROTECTION OF STRUCTURE: ENTIRE STRUCTURE TO BE SPRINKLED PER NFPA 13.

SEPARATE PLANS FOR SUPPRESSION SYSTEM TO BE PROVIDED AT LATER DATE WHEN APPROPRIATE DETECTION SYSTEMS ARE FIELDING. SEE E-1, E-2, E-3, E-4, E-5, E-6, E-7, E-8, E-9, E-10, E-11, E-12, E-13, E-14, E-15, E-16, E-17, E-18, E-19, E-20, E-21, E-22, E-23, E-24, E-25, E-26, E-27, E-28, E-29, E-30, E-31, E-32, E-33, E-34, E-35, E-36, E-37, E-38, E-39, E-40, E-41, E-42, E-43, E-44, E-45, E-46, E-47, E-48, E-49, E-50, E-51, E-52, E-53, E-54, E-55, E-56, E-57, E-58, E-59, E-60, E-61, E-62, E-63, E-64, E-65, E-66, E-67, E-68, E-69, E-70, E-71, E-72, E-73, E-74, E-75, E-76, E-77, E-78, E-79, E-80, E-81, E-82, E-83, E-84, E-85, E-86, E-87, E-88, E-89, E-90, E-91, E-92, E-93, E-94, E-95, E-96, E-97, E-98, E-99, E-100.

REQUIRED NUMBER OF MEANS OF ESCAPE FOR SYNAGOGUE (NEW ASSEMBLY) PER NFPA 101, 2009 ED.:
SECOND FLOOR: TWO MIN. (PAR. 8.2.4.2 (1)(C))
PROVIDED ONE STAIRWAY EXITING DIRECTLY TO OUTSIDE WITH SELF-CLOSING DOORS TO FIRST AND SECOND FLOOR CORRIDORS.
THIRD FLOOR: TWO MIN.
FOURTH FLOOR: TWO MIN.
PROVIDED THREE.

SYNAGOGUE FIRST FLOOR LIFE SAFETY PLAN
1/4" = 1'-0"

WALL LEGEND

———— THERMAL BATT INSULATED
- - - - - ACOUSTIC BATT INSULATED
- - - - - ONE HOUR RATED

EQUIPMENT LEGEND

WALL MOUNTED FIRE EXTINGUISHER [E]

FIRE RESISTANCE RATINGS OF MEANS OF EGRESS AT SYNAGOGUE

FIRST AND SECOND FLOOR HALLWAYS: NO RATING (BUILDING IS SPRINKLED)
EXIT STAIRWAY INCLUDING WALLS: ONE HOUR AND DOORS: 1 HOUR
INDIVIDUAL ROOMS: NO RATING (BUILDING IS SPRINKLED)

ASSEMBLY SPACE
D.O.L. = 27'

FIXED SEATING BY HURSEY SEATING CO. MODEL NO. RBL 3.4, 24" WIDE (TYP) IN ASSEMBLY SPACE

PORTABLE FLOOR SUPPORTED CURTAIN 4'-8 1/2" HIGH

OWNER
CHANA LIBRANTO
OF MAINE, INC.
101 CRAIGIE STREET
PORTLAND, MAINE 04102

DATE 6-28-07
SCALE 1/4" = 1'-0"
DRAWN BY RWVA
JOB NO. 0702

DESIGN STAGE DOCUMENTS
SHEET TITLE SYNAGOGUE FIRST FLOOR LIFE SAFETY PLAN

PROPOSED NEW RESIDENCE AND SYNAGOGUE

RABBI MOSHE AND CHANA WILANSKY
POMEROY STREET
PORTLAND, MAINE

| REVISION | | |
|----------|-----------------------------------------------------|---------|
| NO. | DESCRIPTION | DATE |
| 1 | CHANGE DWG SCALE TO 1/4"=1'-0", ADD FIRE DEPT. REG. | 6-28-07 |

THIS DRAWING, SPECIFICATIONS AND CONDITIONS ARE THE PROPERTY OF RICHARD ABRAHAM'S ASSOCIATES ARCHITECTS. NO PART OF THIS DRAWING OR ANY OTHER DRAWING OF THIS PROJECT MAY BE REPRODUCED OR TRANSMITTED IN ANY FORM OR BY ANY MEANS, ELECTRONIC OR MECHANICAL, INCLUDING PHOTOCOPYING, RECORDING, OR BY ANY INFORMATION STORAGE AND RETRIEVAL SYSTEM, WITHOUT THE WRITTEN PERMISSION OF RICHARD ABRAHAM'S ASSOCIATES ARCHITECTS.

RICHARD ABRAHAM'S ASSOCIATES ARCHITECTS

1000 STATE ST.
PORTLAND, ME 04102
PHONE: (603) 879-8847
E-MAIL: RAB@RAAARCHITECTS.COM

A-12