

RICHARD ABRAHAMS ARCHITECTS

5 BIRCH DRIVE
SCARBOROUGH, ME 04074
PHONE: FAX: (207) 886-6214
EMAIL: rha@rhaarchitects.com

STATE OF MAINE
Professional Engineer
Magnusson
10257

THIS DRAWING, DESIGN AND ELECTRONIC FILE ARE THE PROPERTY OF RICHARD ABRAHAMS ARCHITECTS. THE REPRODUCTION, TRANSMISSION, OR DISTRIBUTION OF THIS DRAWING, DESIGN OR ELECTRONIC FILE WITHOUT WRITTEN CONSENT OF RICHARD ABRAHAMS ARCHITECTS IS STRICTLY FORBIDDEN BY FEDERAL COPYRIGHT LAW.

NO.	DESCRIPTION	DATE

PROPOSED NEW SYNAGOGUE AND RESIDENCE

POMEROY STREET
PORTLAND, MAINE

OWNER
CHABAD LUBAVITCH OF MAINE, INC.
101 CRAGIE STREET
PORTLAND, ME 04102

DATE	06.28.2007
SCALE	1/4" = 1'-0"
DRAWN BY	E.J.P.
JOB NO.	0702
DESIGN STAGE	REVIEW DOCUMENTS
SHEET TITLE	THIRD FLOOR PLUMBING PLAN

P-4

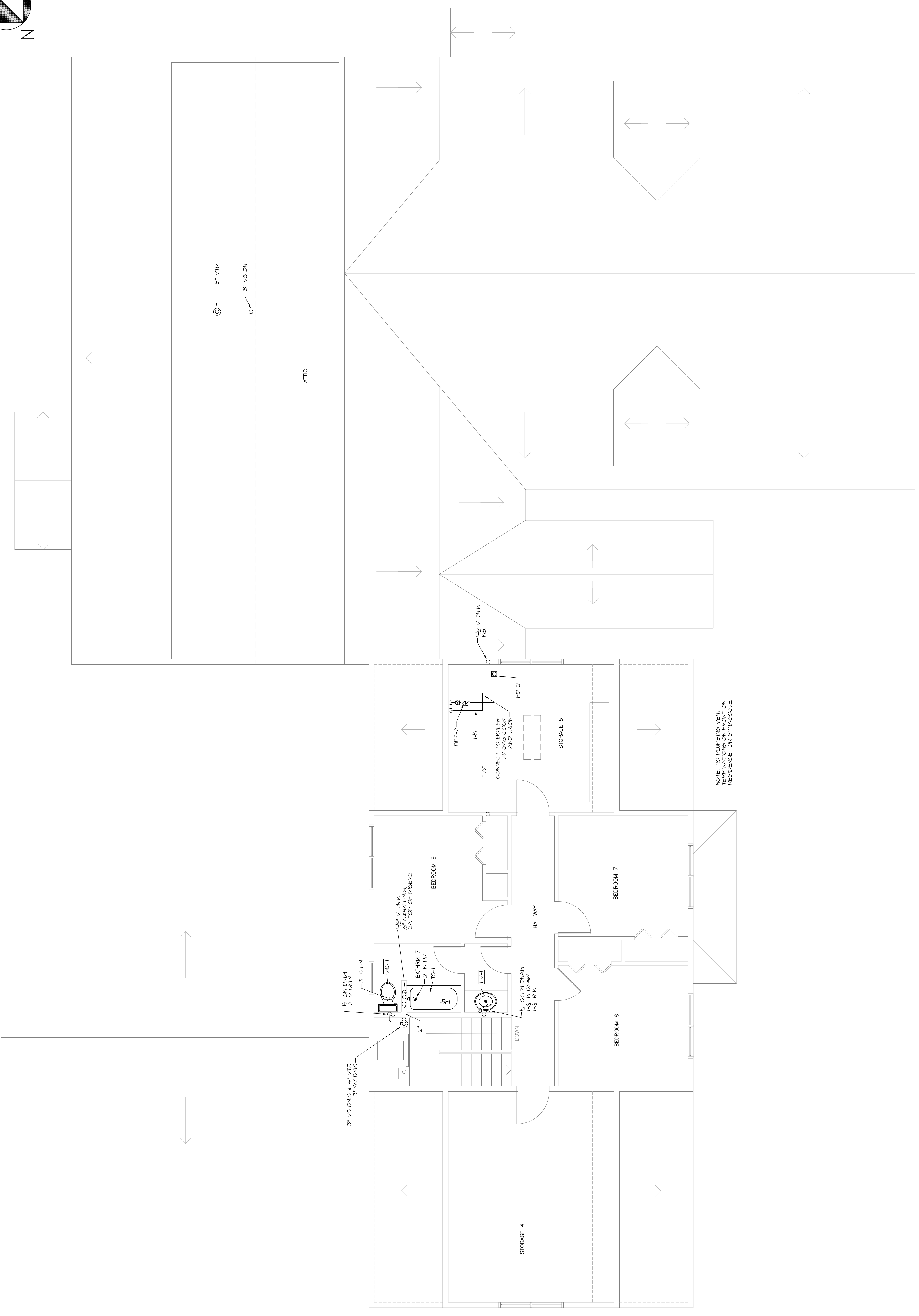
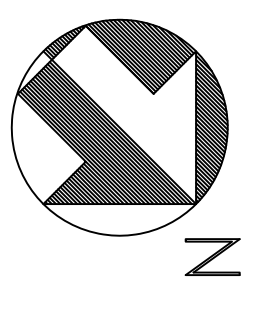

NOTE: NO PLUMBING VENT TERMINATION SHALL BE PERMITTED ON RESIDENCE OR SYNAGOGUE.

MECHANICAL SYSTEMS ENGINEERS
ROYAL RIVER CENTER, UNIT #10
10 FOREST FALLS DRIVE
YORK, ME 04097
VOICE: (207) 846-1441
FAX: (207) 846-1443
mece@copyright.com

FOR REVIEW BY AUTHORITIES
HAVING JURISDICTION 1/4" = 1'-0"

0' 1' 2' 3' 4' 8' 12' 16'

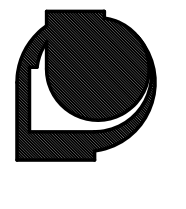

THIRD FLOOR
PLUMBING PLAN