

- Perimeter foundations drainage was planned but illustrated on the drawings. The drains will be "extended 12" beyond the outside edge of the footings, 6" above the top of the footing covered with a filter membrane. These lines will drain to daylight or a drywell which will be located on site.
- The anchor bolts were indicated but not defined or illustrated on the drawings. These will be a maximum of 6' on center, the plans reflect 4' on center and 12" from each corner. They will be 1/2" diameter, 12" steel bolts with a bend at the embedded end and be in the concrete foundation wall at least 7".
- The design load of the roof is 50 psf ground snow load.
- The roof framing will be 2 X 10's at 16" o.c. as is illustrated on the drawings.
- The sheathing will be 5/8" T & G, exterior grade plywood or equal and be nailed at 12" o.c..
- The roof sheathing will be nailed with 1 3/4" galvanized roofing nails, 4" on center on the edges, 8" on center on support members.
- The window schedule is illustrated on the drawings.
- The roof will have ice and water shield 4' from the roof edges at the fascia and minimum of 15 pound felt under the architectural asphalt shingles.
- The stair cross section is illustrated on the drawings.
- The C/O monitor will be located in each bedroom and have a battery back-up.
- The fire separation detail for the wall between the garage and the house is illustrated on the drawings.
- Windows to be ALLSIDE CUSTOM

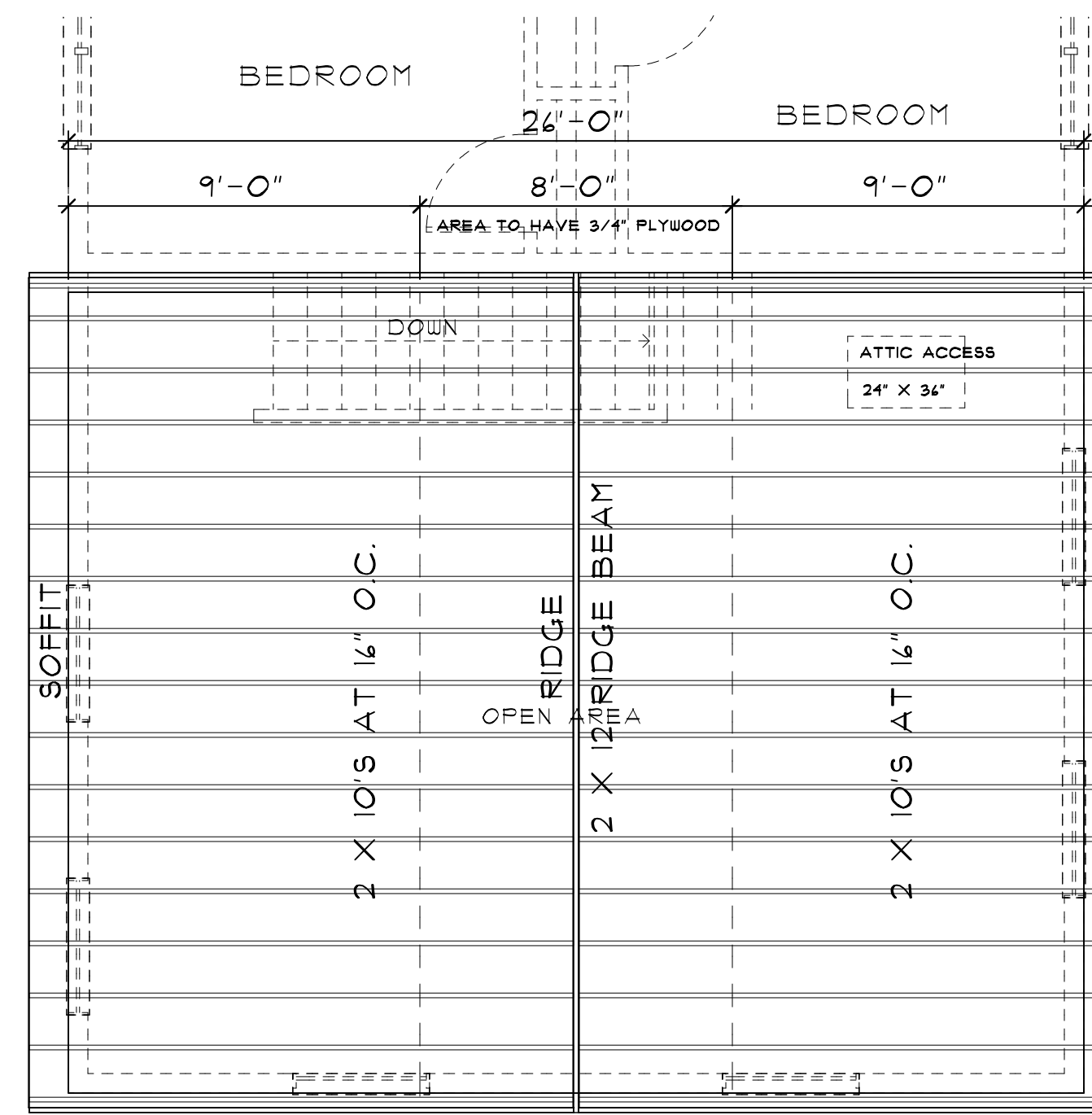

ROOF FRAMING PLAN
SCALE: 1/4" = 1'-0"

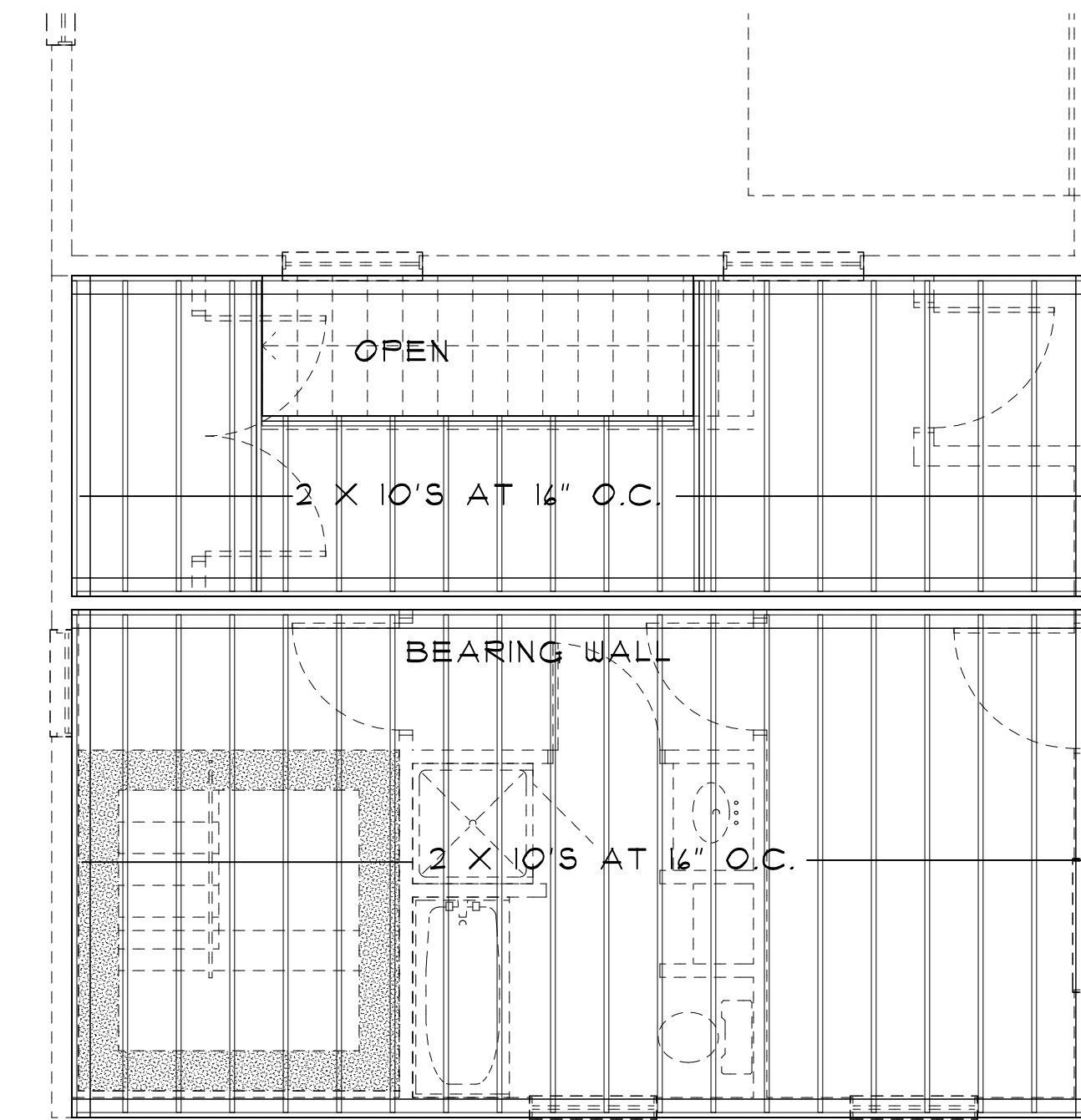

SECOND FLOOR FRAMING PLAN
SCALE: 1/4" = 1'-0"

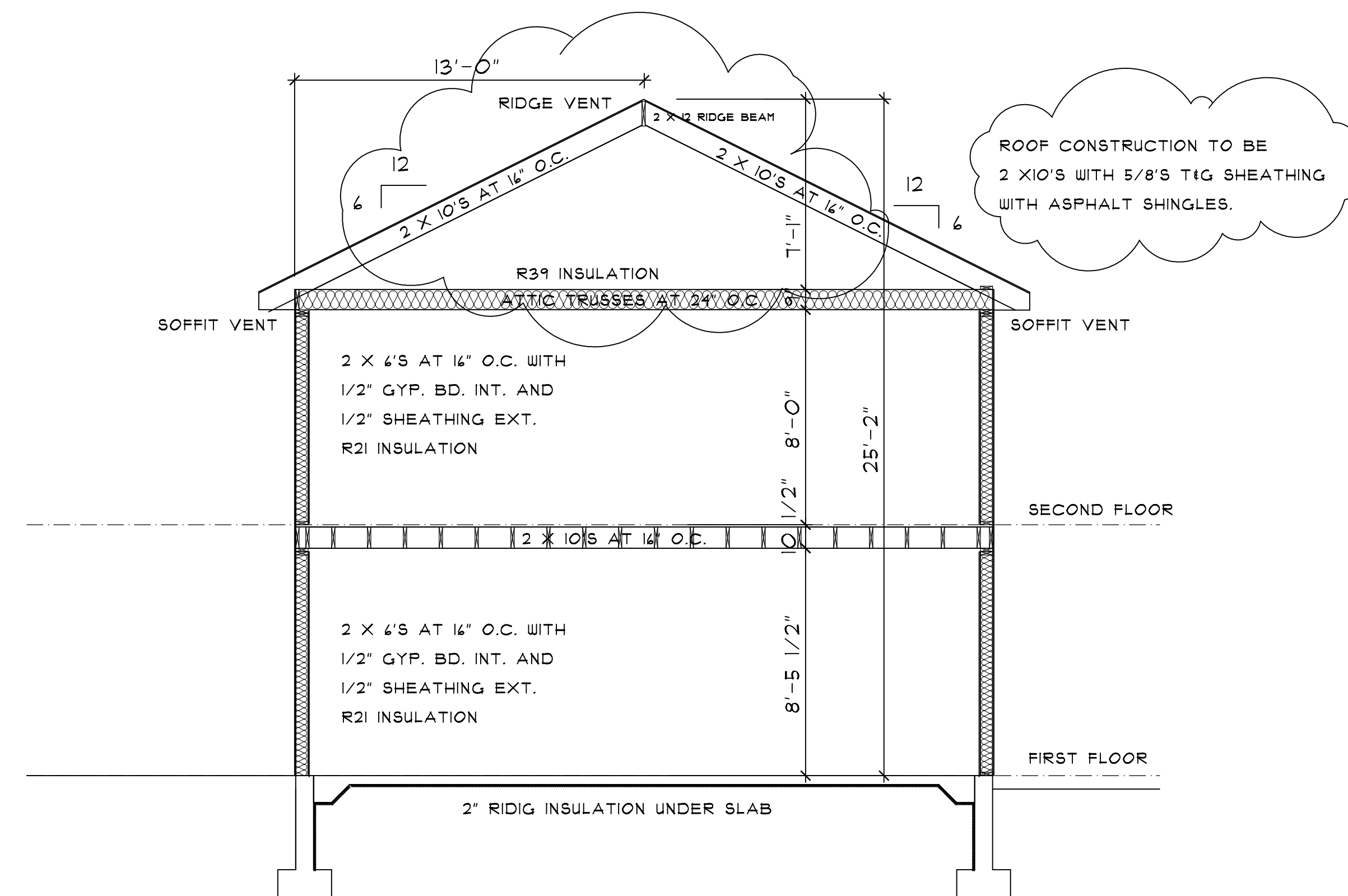
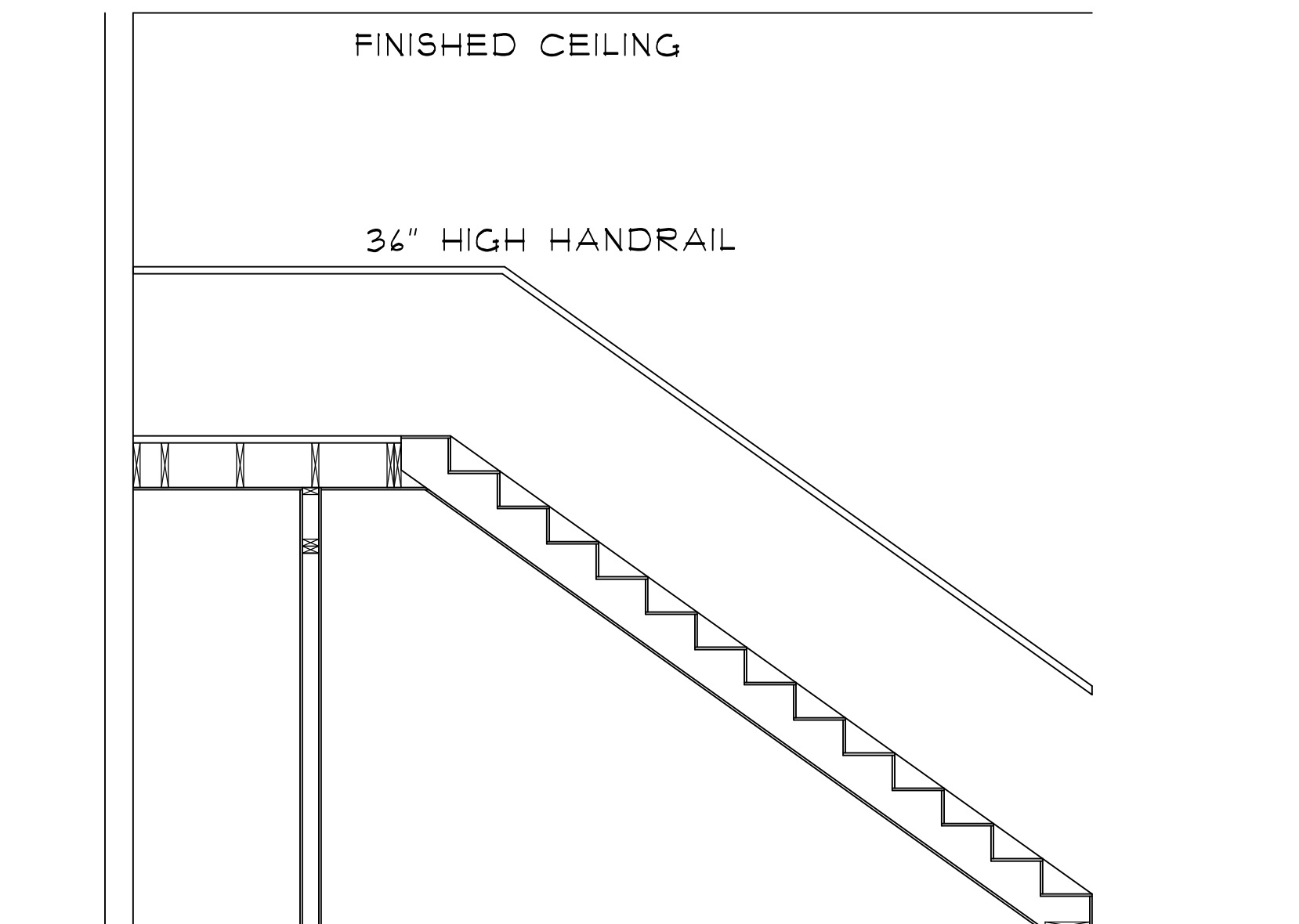

BUILDING SECTION
SCALE: 1/4" = 1'-0"

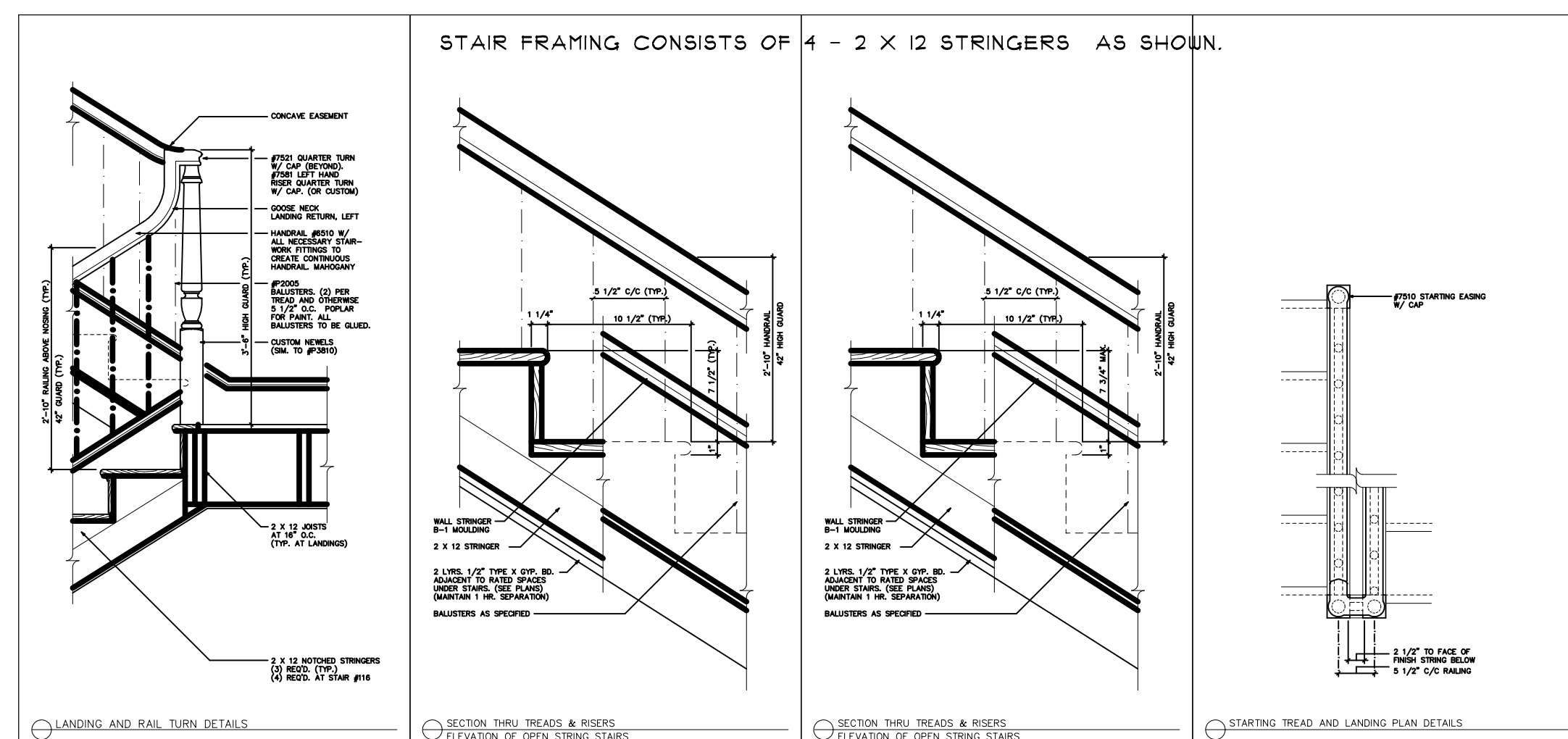

NO.	DESCRIPTION OF REVISION	DATE
1	REVISED PER CODE	04/20/17
NEW RESIDENCE 11 POMEROY STREET PORTLAND, MAINE		
Gleason Architects P.O. BOX 596 STRATHAM, NEW HAMPSHIRE 03885 603 772-7370		
ARCHITECT		
ENGINEER		
DATE: 02/15/17		
PROJECT NO. 201618		
SHEET NO.		
A-2		
OF SHEETS		