

GENERAL NOTES:

- SITE AND TOPOGRAPHIC DATA COMPILED FROM NUMEROUS SOURCES INCLUDING A BASE PLAN PREPARED BY KAPP & MAPPING, INC. 6 STATE STREET, SUITE 301 BANGOR, MAINE 04401 UTILIZING AERIAL PHOTOGRAPHY FLOWN ON 4/16/2012 AND BASE PLAN DATA COMPILED FOR THE WEST SIDE INTERCEPTOR SEWER REPLACEMENT PROJECT (APRIL 19, 2010 BY WOODARD & CURRAN INC). BORING INFORMATION TAKEN FROM ROCKLAND AVENUE SEWER SEPARATION PLANS (AUGUST 2000, BY DELUCA-HOFFMAN).
- MAPPING CONTROL SYSTEMS PROJECTION: MAINE WEST ZONE SPCS HORIZONTAL DATUM, NAD83, VERTICAL DATUM: NGVD29, UNITS: US FEET
- ADJACENT PROPERTY AND STREET RIGHT OF WAY LINES ARE CITY OF PORTLAND TAX MAP G.I.S. DATA (APPROXIMATE).
- CAPISIC PARK PROPERTY LINE DERIVED FROM "PLAN OF CITY PROPERTY AT CAPISIC POND", BY J.M. ROBBINS, P.D.P.W. 9475
- THE UTILITY LOCATIONS SHOWN IN PLAN AND PROFILE ARE APPROXIMATE AND REQUIRE FIELD VERIFICATION BY THE CONTRACTOR. CONTACT THE CITY IMMEDIATELY UPON DISCOVERING ANY CONFLICTS WITH EXISTING AND PROPOSED UTILITY LOCATIONS. NOT ALL EXISTING UTILITIES ARE SHOWN ON PLANS.
- CLEAN AND/OR FLUSH ALL MANHOLES, CATCH BASINS, AND ASSOCIATED PIPING AFTER THE WORK HAS BEEN COMPLETED.
- COORDINATE CONSTRUCTION ACTIVITY WITH UTILITY COMPANIES, EMERGENCY SERVICES AND CITY. CONTACTS ARE LISTED IN SPECIFICATIONS. NOTIFY UTILITY COMPANIES WITHIN 48 HOURS OF WORK ACTIVITY ADJACENT TO THOSE UTILITIES.
- CONTRACTOR SHALL NOTIFY ALL UTILITIES PRIOR TO COMMENCING WORK, ALLOWING SUFFICIENT TIME TO LOCATE AND MARK THE LOCATION OF BURIED UTILITIES. CONTRACTOR SHALL CONTACT "DIG SAFE", TELEPHONE 811, PRIOR TO EXCAVATION.
- RESTORE ALL AREAS DISTURBED BY CONTRACTOR'S OPERATIONS TO ORIGINAL FINISH (GRAVEL, PAVEMENT, GRASS, ETC.). RESTORATION OF PAVED SURFACES, GRAVEL SURFACES, DRIVEWAYS, AND LAWNS DAMAGED BY CONSTRUCTION ACTIVITIES OUTSIDE OF LIMITS OF WORK INDICATED ON THE PLANS SHALL BE PERFORMED AT NO ADDITIONAL COST TO OWNER. ANY CURB DAMAGED BY CONSTRUCTION ACTIVITIES SHALL BE REPLACED IN KIND AND SHALL CONFORM TO CITY OF PORTLAND AND MAINE DOT SPECIFICATIONS AT NO ADDITIONAL COST TO OWNER.
- PROPERLY PROTECT AND DO NOT DISTURB PROPERTY IRONS AND MONUMENTS. IF DISTURBED, THE PROPERTY MONUMENT SHALL BE RESET AT THE CONTRACTOR'S EXPENSE BY A LICENSED LAND SURVEYOR ACCEPTABLE TO THE CITY.
- EXISTING FACILITIES (I.E. TREES, POLES, LIGHT POSTS, CATCH BASINS, ETC.) SHALL BE REMOVED AND PROTECTED DURING CONSTRUCTION. CITY RETAINS RIGHT TO KEEP ANY AND ALL REMOVED FACILITIES. CONTRACTOR SHALL DISPOSE OF ANY REMOVED FACILITY AT THE REQUEST OF CITY AT CONTRACTOR'S EXPENSE.
- ALL TREES NOT NOTED TO BE REMOVED OR RELOCATED SHALL BE PROTECTED BY CONTRACTOR DURING CONSTRUCTION.
- ALL WORK WITHIN THE RIGHT OF WAY OF CITY STREETS SHALL BE PERFORMED IN ACCORDANCE WITH THE REQUIREMENTS OF THE CITY TRAFFIC ENGINEER. THE CONTRACTOR SHALL SUBMIT A PROPOSED TRAFFIC CONTROL PLAN TO THE TRAFFIC ENGINEER AT LEAST 7 DAYS BEFORE BEGINNING CONSTRUCTION IN ANY STREET. THE PROPOSED TRAFFIC CONTROL PLAN SHALL BE SUBJECT TO APPROVAL BY THE TRAFFIC ENGINEER, WHO MAY ATTACH SPECIAL CONDITIONS TO, OR REQUIRE MODIFICATIONS OF, THE TRAFFIC CONTROL PLAN. WORK SHALL NOT BEGIN UNTIL THE PLAN IS APPROVED BY THE TRAFFIC ENGINEER.
- DO NOT PARK, IMPEDE ACCESS TO, OR STORE EQUIPMENT ON ADJACENT CITY OR PRIVATELY OWNED LOTS, UNLESS PERMISSION HAS BEEN GRANTED IN WRITING BY CITY AND/OR LAND OWNER.
- COORDINATE DISRUPTION OF PRIVATE UTILITY SERVICES WITH LANDOWNERS AT LEAST TWO DAYS (48 HOURS) PRIOR TO DISRUPTION. ALL UTILITY COORDINATION IS RESPONSIBILITY OF CONTRACTOR.
- RESTRICT ACCESS TO SITE THROUGH THE USE OF APPROPRIATE SIGNAGE, BARRIERS, FENCES, ETC. SITE SHALL BE LEFT WITH APPROPRIATE SAFETY MEASURES IN PLACE DURING NON-WORKING HOURS. NO TRENCH SHALL BE LEFT OPEN DURING NON-WORKING HOURS. SITE CONTAINS ACTIVE WALKING TRAIL. TRAIL MAY BE CLOSED TO PUBLIC ACCESS AS NECESSARY TO ALLOW FOR CONSTRUCTION. SITE SAFETY IS THE RESPONSIBILITY OF CONTRACTOR, DURING BOTH WORKING AND NON-WORKING HOURS.
- CONTRACTOR IS RESPONSIBLE FOR OBTAINING ALL NECESSARY CONSTRUCTION PERMITS. PERMIT APPLICATIONS SHALL BE SUBMITTED WITH ADEQUATE TIME SO AS NOT TO DELAY CONSTRUCTION.
- CONTRACTOR SHALL OBTAIN A CITY STREET OPENING PERMIT FOR ALL WORK IN THE CITY RIGHT OF WAY BEFORE BEGINNING CONSTRUCTION. THE FEE FOR THIS PERMIT WILL BE WAIVED BY THE CITY. THE CONTRACTOR WILL ALSO BE REQUIRED TO HAVE A CURRENT EXCAVATOR'S LICENSE IN THE CITY. THE EXCAVATOR'S LICENSE FEE WILL NOT BE WAIVED BY THE CITY.
- ALL WORK ASSOCIATED WITH THE PROJECT SHALL BE COMPLETED IN ACCORDANCE WITH ARTICLES VI, VII, AND IX OF CHAPTER 25--STREETS, SIDEWALKS, AND OTHER PUBLIC PLACES OF THE CITY OF PORTLAND CODE OF ORDINANCES.
- ALL SEWER CONSTRUCTION IN THE PUBLIC WAY SHALL BE COMPLETED IN ACCORDANCE WITH ARTICLE II OF CHAPTER 24--SEWERS OF THE CITY OF PORTLAND CODE OF ORDINANCES.
- THE CITY OF PORTLAND ENGINEERING DIVISION REQUIRES THAT UPON COMPLETION OF CONSTRUCTION A COMPLETE SET OF "RECORD" DRAWINGS THAT REFLECT ANY AND ALL MODIFICATIONS TO THE SANITARY SEWER SYSTEM, STORM SEWER SYSTEM AND ANY OTHER UTILITY INSTALLATIONS OR ALTERATIONS WITHIN THE PROJECT LIMITS BE SUBMITTED TO THE DIVISION. THESE DRAWINGS SHALL BE SUBMITTED IN BOTH DIGITAL AND HARD COPY FORMAT AS DEFINED IN THE SPECIFICATIONS PRIOR TO PAYMENT OF FINAL RETAINAGE.
- WORK IS IN CLOSE PROXIMITY TO EXISTING UTILITIES. PROTECTION OF EXISTING UTILITIES DURING CONSTRUCTION SHALL BE INCIDENTAL TO THE PAY ITEM UNDER WHICH WORK TO INSTALL SAID UTILITY IS PERFORMED.
- FOR TEST PIT LOCATIONS SHOWN ON PLANS, FIELD VERIFY UTILITY ELEVATIONS PRIOR TO ORDERING CATCH BASIN & MANHOLE STRUCTURES. NOTIFY ENGINEER OF ANY CONFLICTS.
- CONTACT CITY OF PORTLAND ARBORIST AND ENGINEER PRIOR TO CUTTING ROOTS, TRIMMING BRANCHES, OR DISTURBING TREES THAT NOT HAVE BEEN NOTED FOR REMOVAL ON THE PLANS.
- DEMOLITION (REMOVAL AND DISPOSAL) OF EXISTING PIPE WITHIN 4 FEET OF THE HORIZONTAL LIMITS OF EXCAVATION FOR PROPOSED PIPES OR STRUCTURES SHALL BE INCIDENTAL TO THE PAY ITEM FOR WHICH THE PROPOSED PIPE IS INSTALLED. NO ADDITIONAL PAYMENT SHALL BE MADE. REFER TO SUPPLEMENTAL SPECIFICATION SECTION 202.
- DEMOLITION (REMOVAL AND DISPOSAL) OF EXISTING MANHOLE OR CATCH BASIN IN WHICH THE CENTER OF THE EXISTING STRUCTURE IS WITHIN 8 FEET OF THE CENTER OF THE NEW STRUCTURE SHALL BE INCIDENTAL TO THE PAY ITEM FOR THE NEW STRUCTURE BEING INSTALLED. NO ADDITIONAL PAYMENT SHALL BE MADE. REFER TO SUPPLEMENTAL SPECIFICATION SECTION 202.
- PROVIDE 4-INCHES OF LOAM AND SEED IN ALL LAWN AREAS DISTURBED BY CONTRACTOR'S OPERATIONS.
- IF CONTRACTOR PROPOSES TO TEMPORARILY STOCKPILE ANY SURPLUS SOIL AND ROCK IN THE CITY OF PORTLAND, THE CONTRACTOR SHALL OBTAIN APPROVAL FOR EACH STOCKPILE LOCATION FROM THE ENGINEER. IF CONTRACTOR PROPOSES TO PERMANENTLY STOCKPILE ANY SURPLUS SOIL AND ROCK ON PROPERTY IN THE CITY OF PORTLAND, THE CONTRACTOR MUST OBTAIN ANY SITE PLAN PERMITS REQUIRED FROM THE CITY PLANNING AUTHORITY OR ANY FILL PERMITS REQUIRED FROM MDEP OR U.S. ARMY CORPS OF ENGINEERS. BOTH TEMPORARY AND PERMANENT STOCKPILE LOCATIONS SHALL MEET THE APPLICABLE SETBACK REQUIREMENTS IN THE CITY LAND USE CODE AND SHALL RECEIVE PROPER STABILIZATION AND EROSION & SEDIMENT CONTROL MEASURES IN ACCORDANCE WITH APPROVED SOIL EROSION & WATER POLLUTION CONTROL PLAN.
- PROJECT IS SUBJECT TO THE CONDITIONS SET FORTH IN PERMITS ISSUED BY THE MAINE DEP AND US ARMY CORPS OF ENGINEERS, SPECIFICALLY RELATED TO LIMITS OF IMPACT, EROSION CONTROL MEASURES, RESTORATION ACTIVITIES, AND TIMEFRAME RESTRICTIONS. CONTRACTOR SHALL READ PERMIT DOCUMENTS FULLY AND CARRY OUT WORK IN ACCORDANCE WITH PERMIT DOCUMENTS. COPIES OF PERMIT DOCUMENTS ARE APPENDED TO THE PROJECT SPECIFICATIONS.
- CONTRACTOR SHALL BE RESPONSIBLE FOR KEEPING ROCKLAND AVENUE AND MACHIGONNE STREET FREE OF SEDIMENT. A STABILIZED CONSTRUCTION EXIST SHALL BE CONSTRUCTED AT ALL ACCESS POINTS AND ROCKLAND AVENUE AND MACHIGONNE STREET WILL BE SWEEPED ON A DAILY BASIS OR AT A MORE FREQUENT RATE AS NECESSARY AS REQUESTED BY THE CITY.

- CONSTRUCTION ACCESS WILL BE THROUGH RESIDENTIAL NEIGHBORHOODS, AND WORK WILL BE IN CLOSE PROXIMITY TO PRIVATE RESIDENCES. THE CONTRACTOR SHALL NOT STORE MATERIALS OR EQUIPMENT ON PRIVATE OR CITY PROPERTY UNLESS WRITTEN PERMISSION HAS BEEN RECEIVED. CONTRACTOR SHALL TAKE CARE TO NOT IMPACT ADJACENT PRIVATE PROPERTIES, AND WILL REPAIR ANY DAMAGE ON PRIVATE PROPERTIES AT NO ADDITIONAL COST TO THE PROPERTY OWNERS OR THE CITY.

SYMBOLS

DESCRIPTION	EXISTING	PROPOSED
SANITARY SEWER MANHOLE		
STORM DRAIN MANHOLE		
CATCH BASIN W/ HEADSTONE		
CATCH BASIN, FIELD INLET		
DRAIN BASIN		
UTILITY POLE W/GUY		
UTILITY POLE		
WATER GATE		
WATER VALVE		
WATER SHUT OFF		
HYDRANT		
SIGN		
MAILBOX		
TREE		
IRON PIN (FOUND)		
MONUMENTS (FOUND)		
BORING		
STONE CHECK DAM		
GRAVEL		
PLACED STONE		

ABBREVIATIONS

&	AND
A.G.	ABOVE GROUND
BIT	BITUMINOUS
B/W	BETWEEN
CB	CATCH BASIN
CI	CAST IRON
OMP	CENTRAL MAINE POWER
OMP	CORRUGATED METAL PIPE
CONC	CONCRETE
DI	DUCTILE IRON
DIA.	DIAMETER
DMH	DRAIN MANHOLE
DTL.	DETAIL
E	UNDERGROUND ELECTRICAL
EL.	ELEVATION
E.O.P.	EDGE OF PAVEMENT
EXIST.	EXISTING
FF	FINISH FLOOR
FT	FOOT/FEET
G	GAS MAIN
GS	GAS SERVICE
GALV.	GALVANIZED
GRAN.	GRANITE
HDPE	HIGH DENSITY POLYETHYLENE
HDPP	HIGH DENSITY POLYPROPYLENE
HYD	HYDRANT
INV.	INVERT
LF	LINEAR FEET
MAX.	MAXIMUM
MDOT	MAINE DEPARTMENT OF TRANSPORTATION
MIN.	MINIMUM
MON	MONUMENT
N.I.C.	NOT IN CONTRACT
NO.	NUMBER
NR	NO REFUSAL
N.T.S.	NOT TO SCALE
OE	OVERHEAD ELECTRICAL
OH	OVERHEAD
±	PLUS OR MINUS
LLS	LICENSED LAND SURVEYOR
PROP.	PROPOSED
PT.	POINT
PVC	POLYVINYL CHLORIDE
PWD	PORTLAND WATER DISTRICT
R.O.W.	RIGHT-OF-WAY
RCP	REINFORCED CONCRETE PIPE
REINF.	REINFORCED
REQ'D	REQUIRED
RPP	RIBBED PLASTIC PIPE
S	SLOPE (FT./FT.)
S	SEWER
SD	STORM DRAIN
SMH	SEWER MANHOLE
SCH	SCHEDULE
STA.	STATION
TYP.	TYPICAL
UP	UTILITY POLE
VC	VITRIFIED CLAY
VT.	VITRIFIED CLAY
W	WEST
W	WATER
W	WITH
W	WATERMAIN
WS	WATER SERVICE
WSI	WEST SIDE INTERCEPTOR
WV	WATER VALVE

LINE TYPES

DESCRIPTION	EXISTING	PROPOSED
CONTOUR (1' INTERVAL)		
CONTOUR (INDEX)		
SANITARY SEWER		
STORM DRAIN		
UNDERDRAIN		
WATER MAIN		
UNDERGROUND ELECTRIC		
GAS LINE		
OVERHEAD ELECTRIC		
PROPERTY LINE		
PROJECT AREA		
RIGHT OF WAY		
EASEMENT		
EDGE OF VEGETATION		
FENCE		
CENTERLINE		
RETAINING WALL		
STONEWALL		
CURB		
EDGE OF PAVEMENT		
EDGE OF GRAVEL		
DESCRIPTION	EXISTING	PROPOSED
CONTOUR (1' INTERVAL)		
CONTOUR (INDEX)		
EDGE OF GRAVEL		
CONSTRUCTION FENCE		

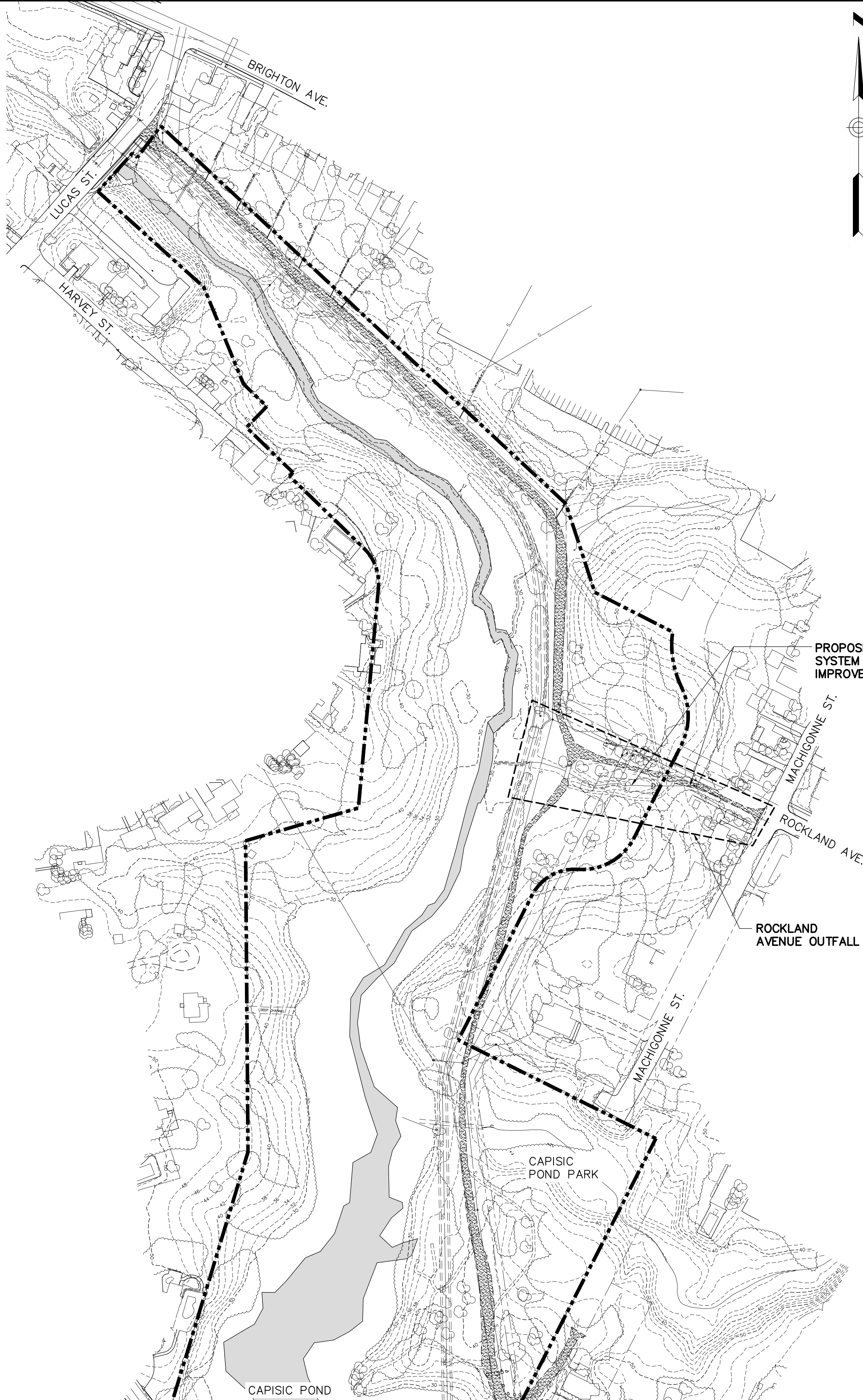

OVERALL PARK PLAN

SCALE: 1"=100'

PERMITTING SET - NOT FOR CONSTRUCTION

41 HUTCHINS DRIVE
PORTLAND, MAINE 04102
800.426.6262 | www.woodardcurran.com



COMMITMENT & INTEGRITY DRIVE RESULTS

LDD PROJECT NAME:
N/A
DRAWING NAME:
225672.77 C10X.DWG
FIELD BOOK USED:
N/A

REFERENCES:

Design: J.L.2012.dwg

DESIGNED BY:	BCM/ALJ
DRAWN BY:	BCM
CHECKED BY:	DAS
SCALE:	1"=20'
DATE:	MARCH 2014

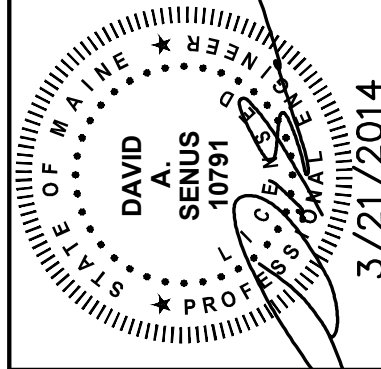

ROCKLAND AVENUE OUTFALL
GENERAL NOTES, LEGEND & ABBREVIATIONS

CITY OF PORTLAND, MAINE
PUBLIC SERVICES DEPARTMENT
ENGINEERING SECTION



SHEET #
1 OF 7
PLAN NUMBER
G-001

Z:\225672_portland-gen_eng_scs\wp_77_capisic_pond_ph_11\Drawings\Design Drawings\225672.77_C10X.dwg, Mar 26, 2014 - 4:36pm