

Z:\225672\_portland-gen\_eng\_sves\wp\_77\_capiolic\_pond\_ph\_in\Drawings\Design Drawings\225672.77\_C20X\_24x36.dwg, Mar 26, 2014 - 4:36pm

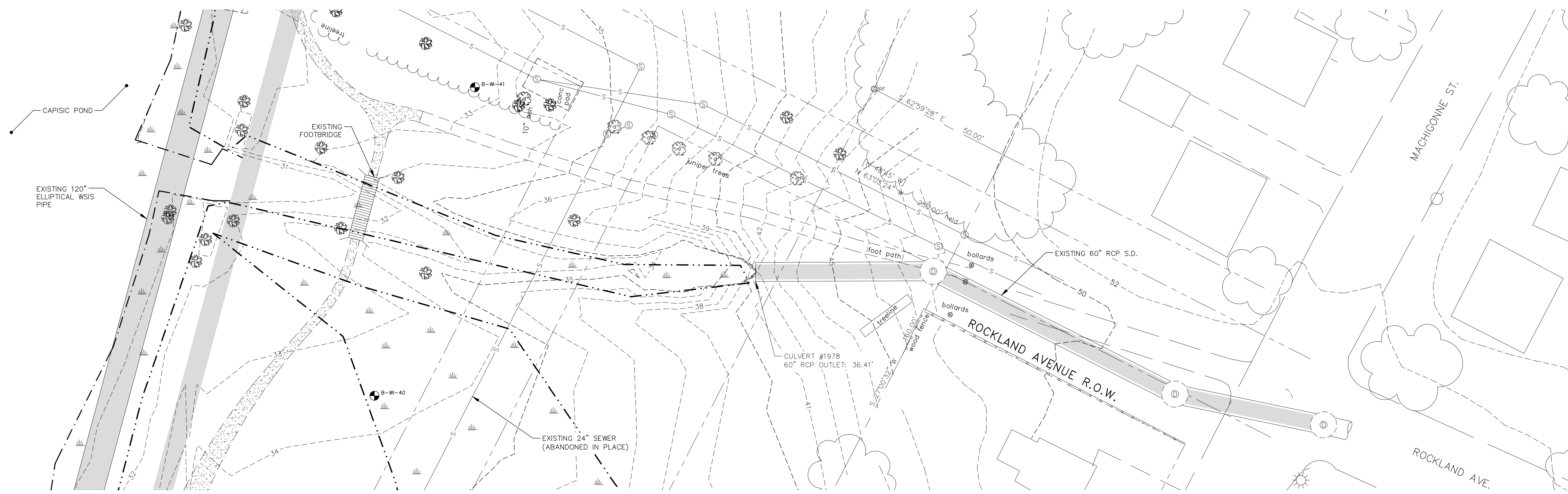

**EXISTING CONDITIONS PLAN**  
SCALE: 1" = 20'

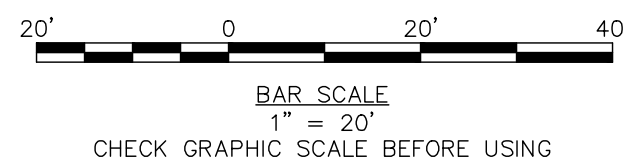

41 HUTCHINS DRIVE  
PORTLAND, MAINE 04102  
800.426.4262 | www.woodardcurran.com



COMMITMENT & INTEGRITY DRIVE RESULTS

LDD PROJECT NAME:  
N/A  
DRAWING NAME:  
225672.77\_C20X\_24x36.DWG  
FIELD BOOK USED:  
N/A

REFERENCES:  
DeeringSL\_2012.dwg

DESIGNED BY:	BCM/ALJ
DRAWN BY:	BCM
CHECKED BY:	DAS
SCALE:	1"=20'
DATE:	MARCH 2014

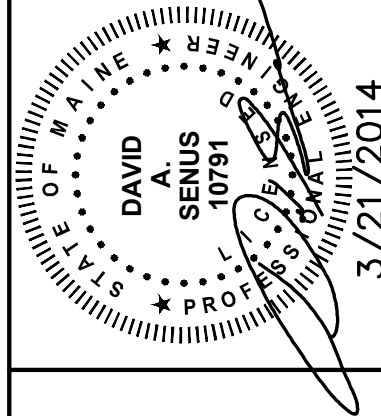

ROCKLAND AVENUE OUTFALL  
EXISTING CONDITIONS

CITY OF PORTLAND, MAINE  
PUBLIC SERVICES DEPARTMENT  
ENGINEERING SECTION



SHEET #  
2 OF 7  
PLAN NUMBER  
C-200

PERMITTING SET - NOT FOR CONSTRUCTION