

# TYPICAL WETLAND CROSS SECTION

## TARGET FUTURE CONDITION

**Pond & Edge Habitat**

**Wetland Shrub  
Habitat Area**

**Transition  
Zone**

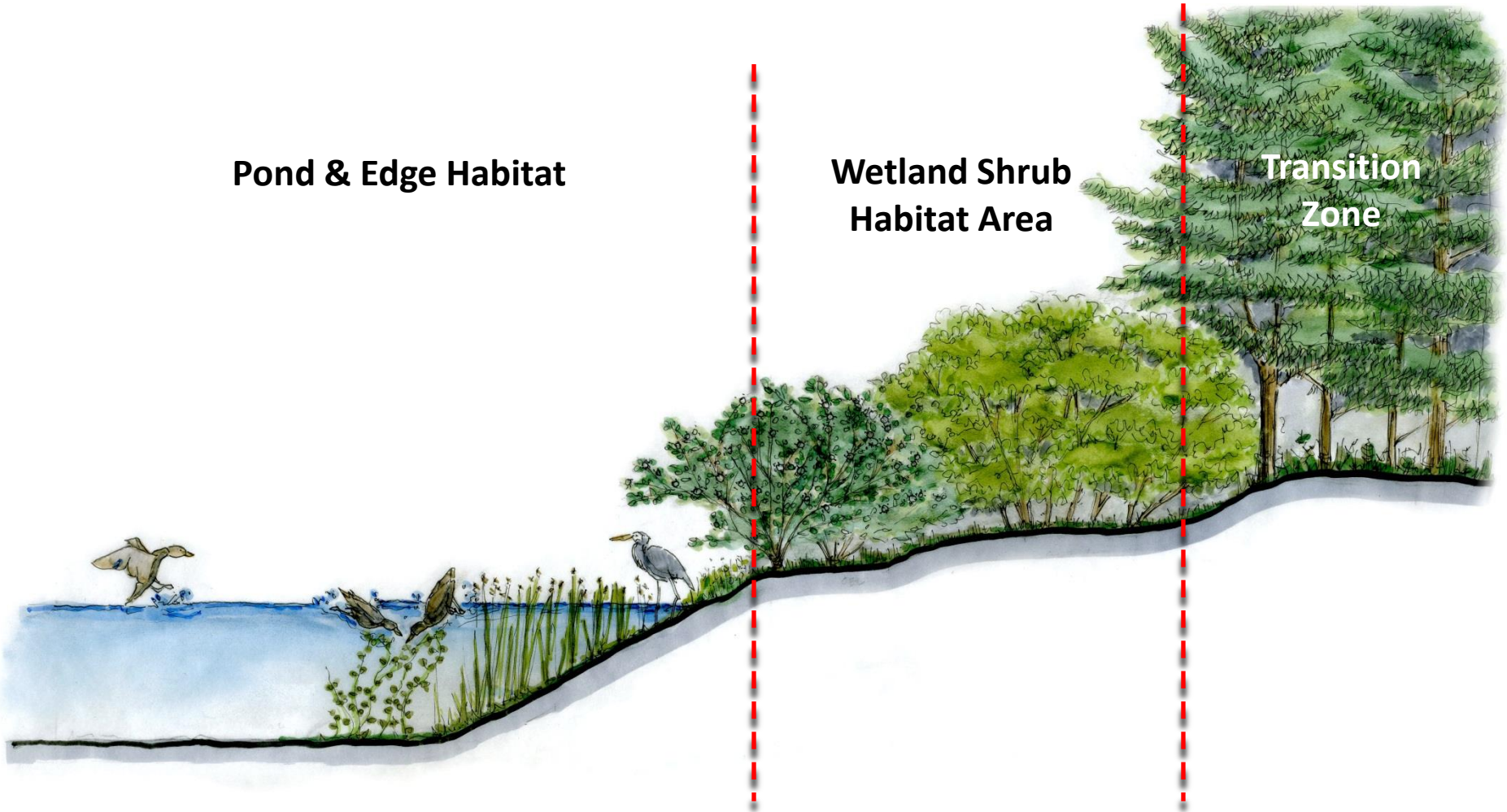

# RESTORATION PLANTINGS

## TYPICAL CROSS SECTION

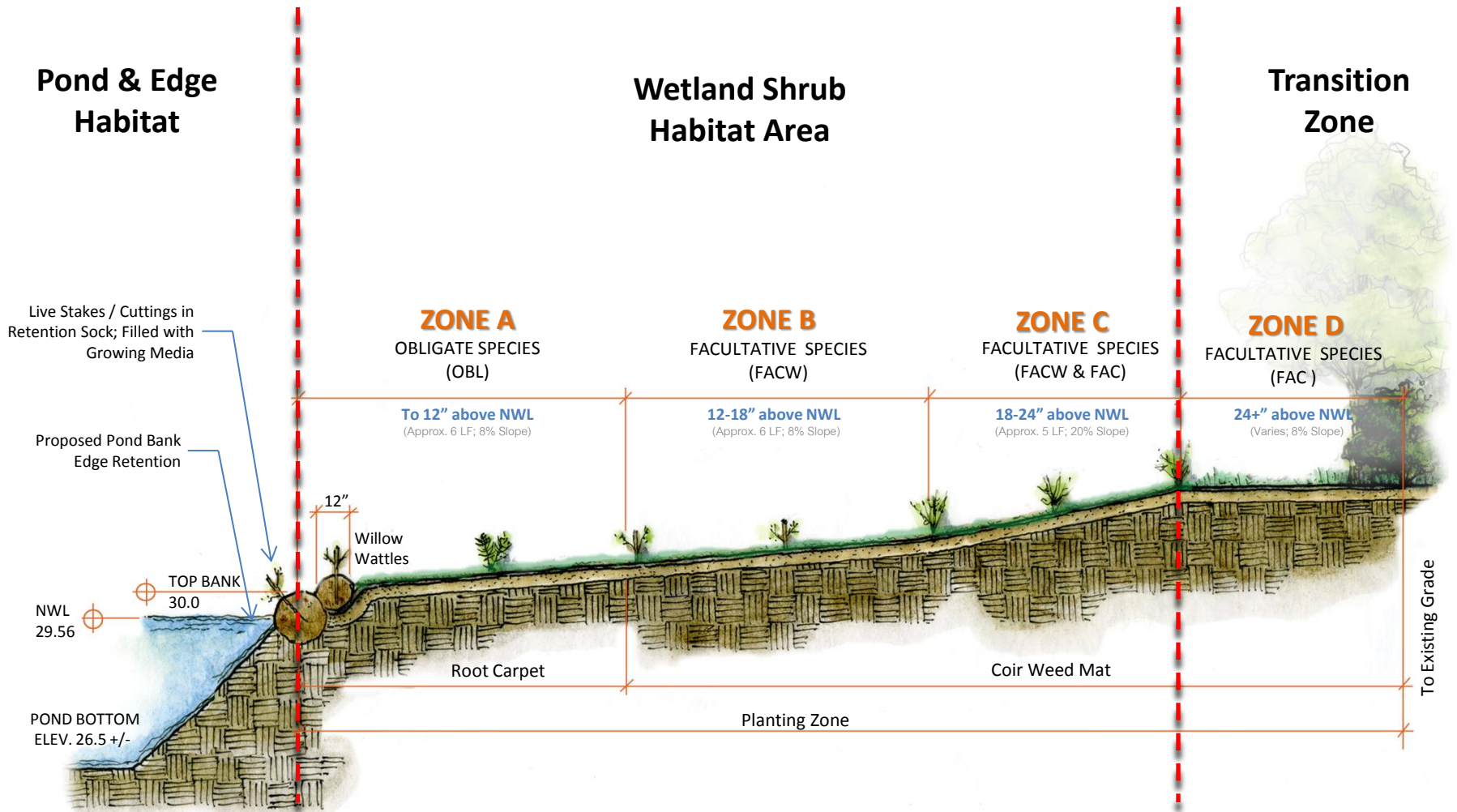

# CAPISIC POND

## PLAN ILLUSTRATION

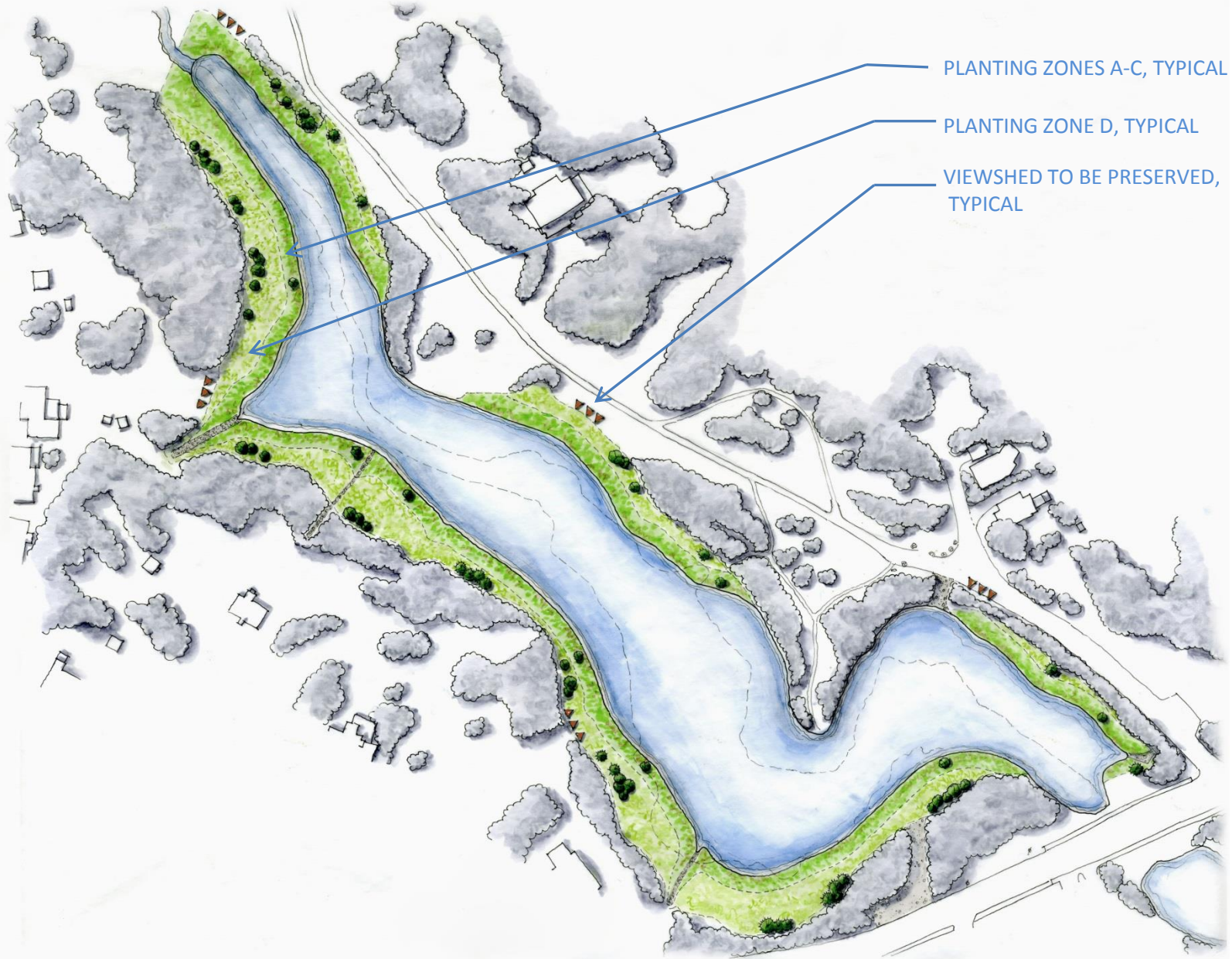

# PLANT PALETTE ZONE A



Buttonbush

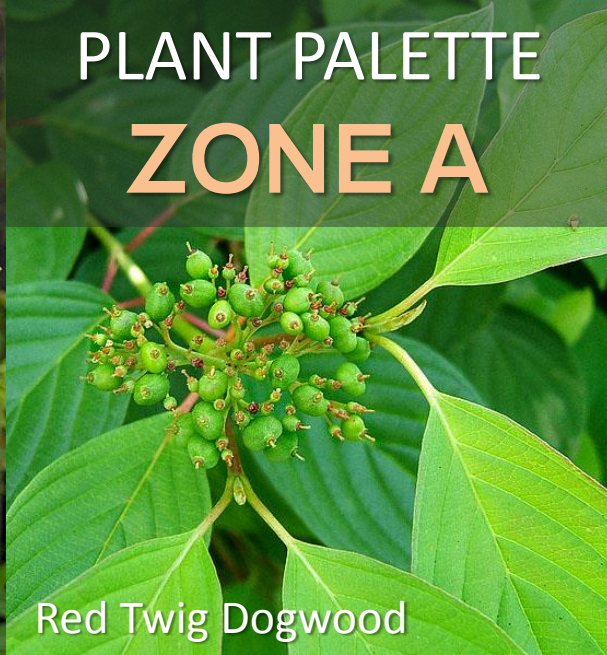

Red Twig Dogwood

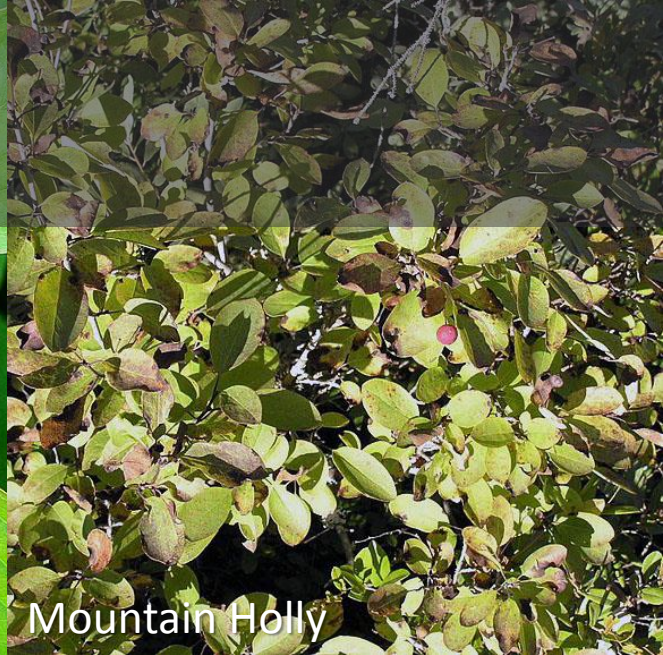

Mountain Holly

Image credits. Above, left to right: Gabriel Hurley, Wildfeuer, Richtid (commons.wikimedia.org) Image credits. Below, left and right (large images): J.S. Peterson, R.W. Lutz (USDA Plant Database)



Swamp Azalea



Slender Willow



Fox Sedge  
Green Bulrush  
Woolgrass

Image credits. Clockwise, from top left: Robert Mohlenbrock, Jennifer Anderson, Kunth (USDA Plant Database),

# PLANT PALETTE ZONE B



Speckled Alder



Red Twig Dogwood



Winterberry



Pussy Willow



Elderberry

Image credits. Clockwise, from top left: Vassil, Wildefeur, James Steakley, M. Sebastian, Avicennasis (commons.wikimedia.org).

# PLANT PALETTE

## ZONES C & D



Red Chokeberry

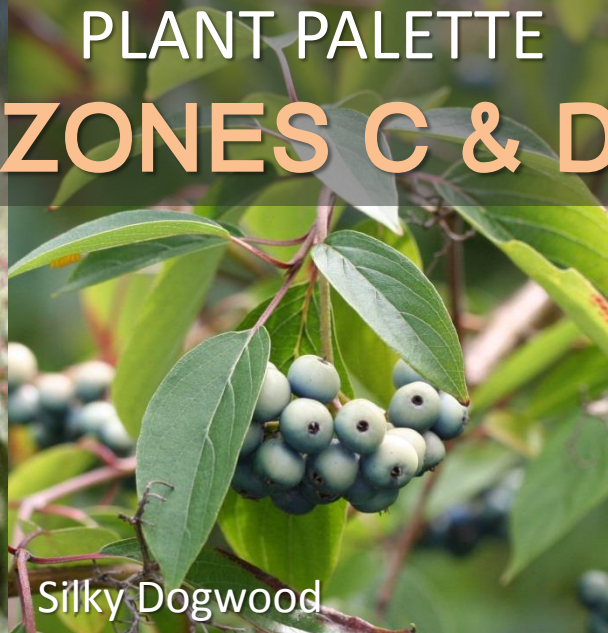

Silky Dogwood



Red Twig Dogwood

Image credits. Clockwise, from top left: Daderot, Michael Wolf, Wildefleur (commons.wikimedia.org).



Winterberry



Pussy Willow



American  
Elderberry



Arrowwood  
Viburnum

Image credits. From above left: James Steakley, M. Sebastian, (commons.wikimedia.org), James H. Miller USDA Forest Service.

# PLANT PALETTE ZONE D



Balsam Fir

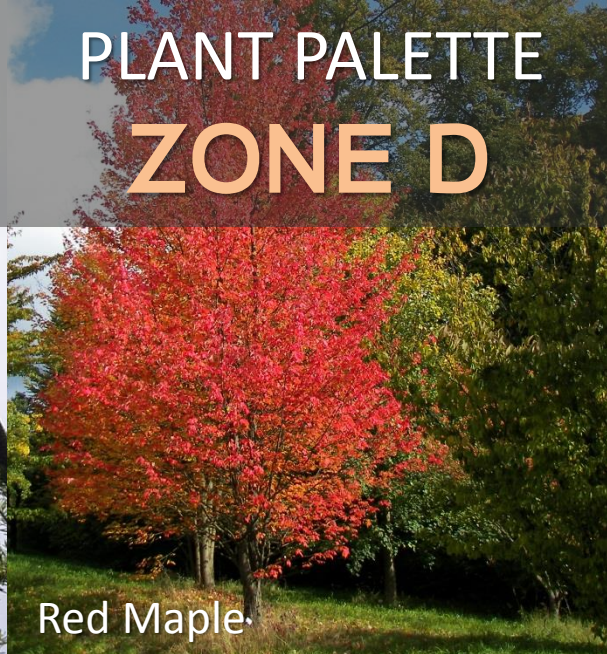

Red Maple

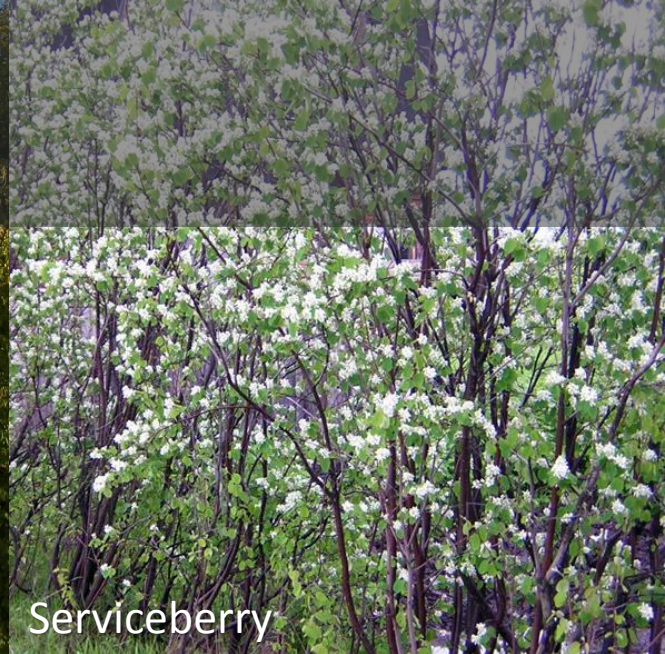

Serviceberry

Image credits. Clockwise, from top left: US Fish and Wildlife Service, Willow, Borealis55, Bitsy, Kyle Woods, MPF US Forest Service, (commons.wikimedia.org).



American Larch

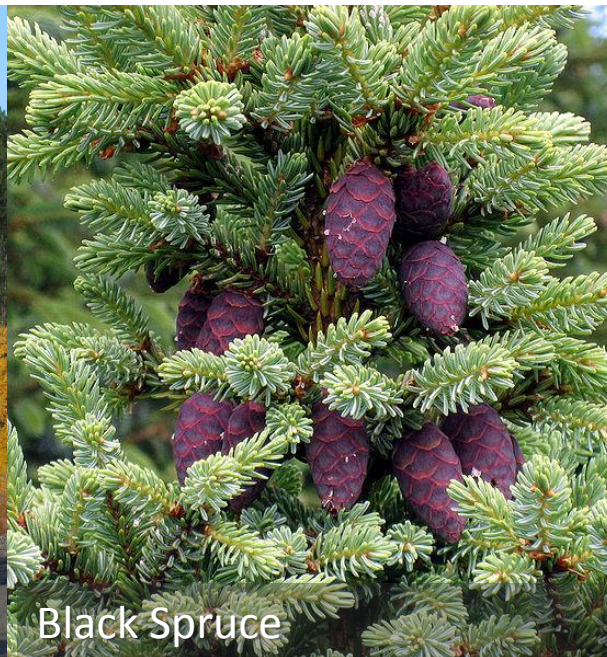

Black Spruce



White Spruce

# BEFORE / AFTER ILLUSTRATION

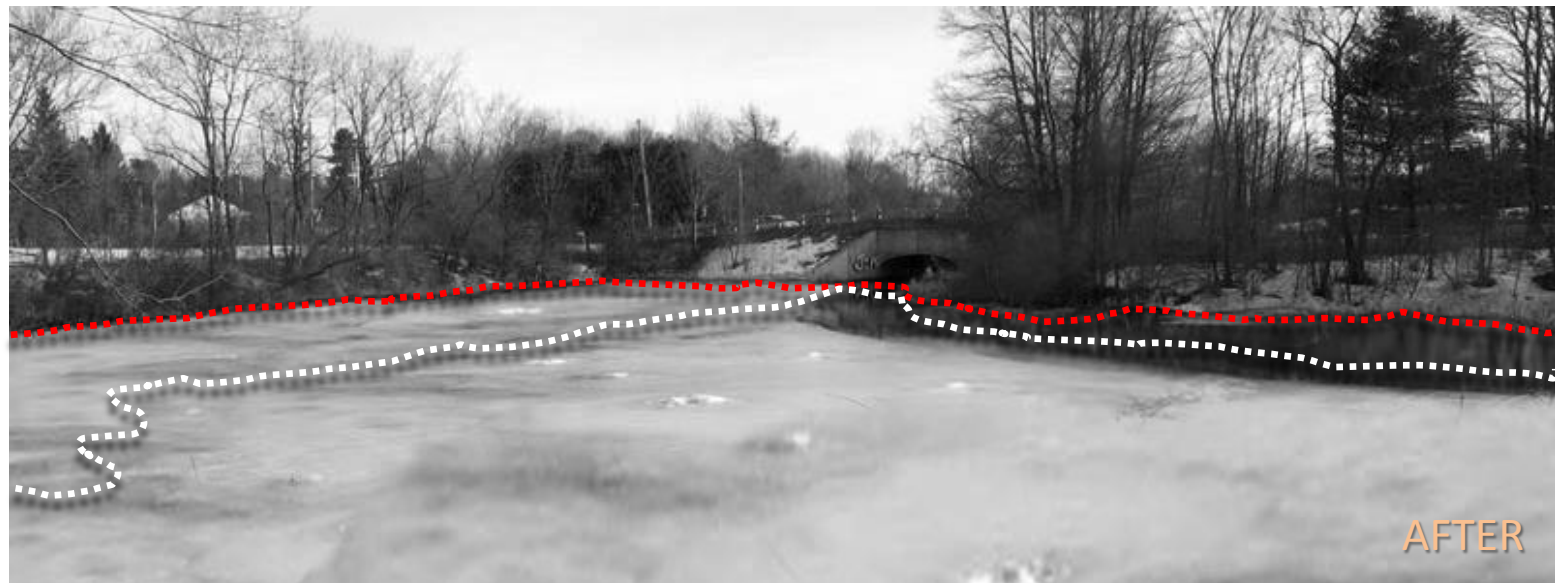



# ROCKLAND AVENUE OUTFALL PLAN ILLUSTRATION

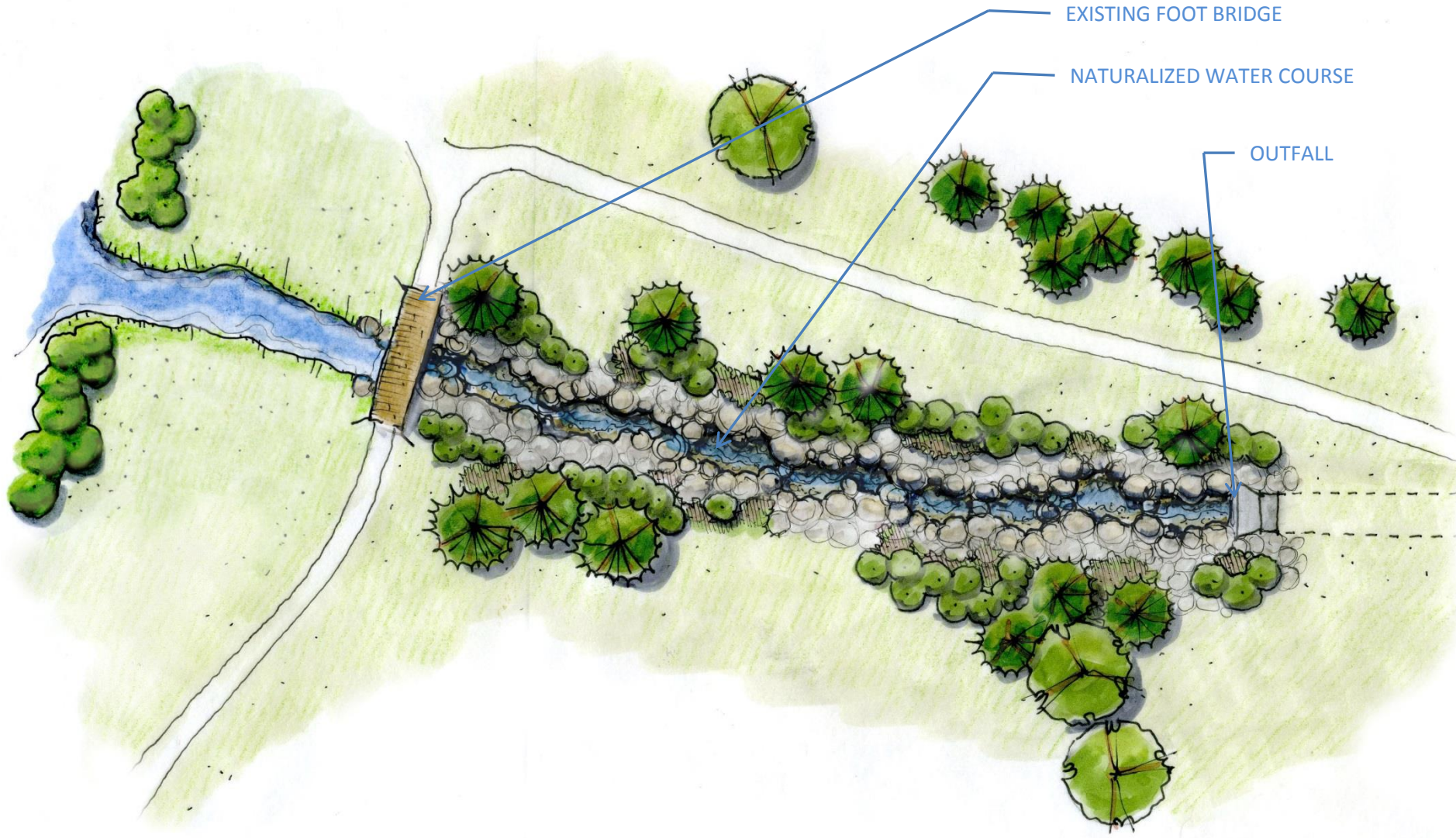

# PLANT PALETTE

## ROCKLAND AVENUE OUTFALL

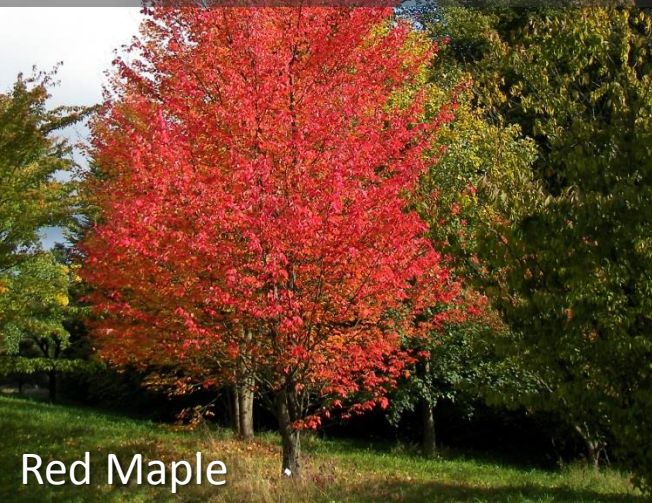

Red Maple

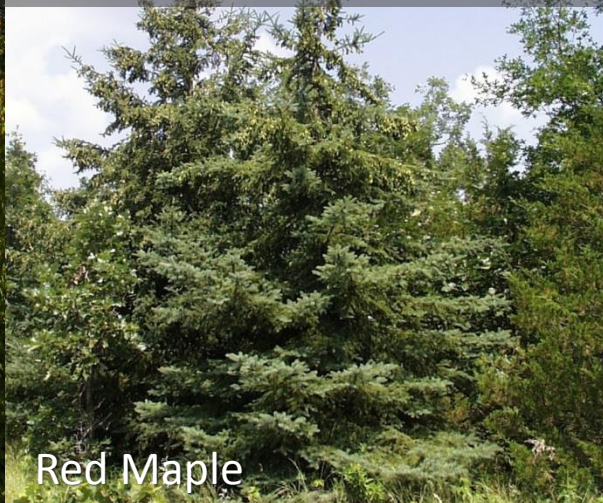

Red Maple



Winterberry

Image credits. Clockwise, from top left: Willow, MPF US Forest Service, M. Sebastian(commons.wikimedia.org).; Below, left and right (large images); R.W. Lutz (USDA Plant Database), Avicennasis (commons.wikimedia.org).

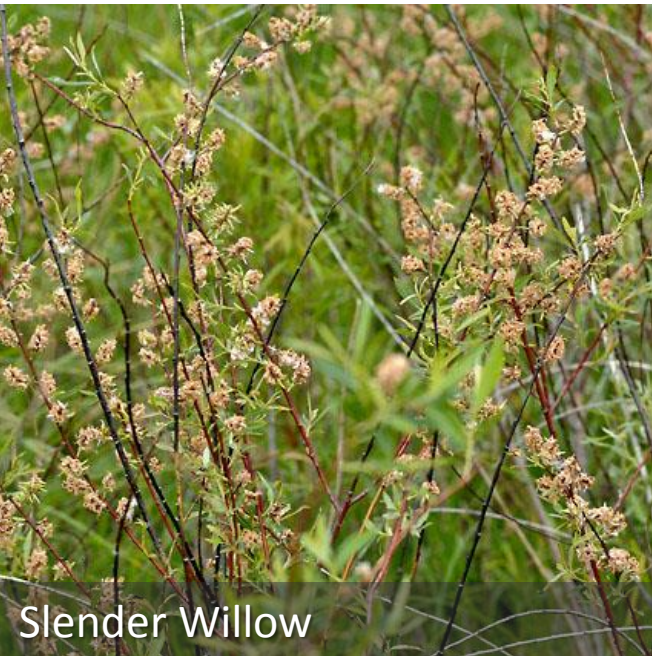

Slender Willow



Elderberry



Turtlehead  
Soft Rush  
Cardinal Flower

Image credits. Above, clockwise, from top left: H. Zell, Jan Bakker, Stan Stebs (commons.wikimedia.org).

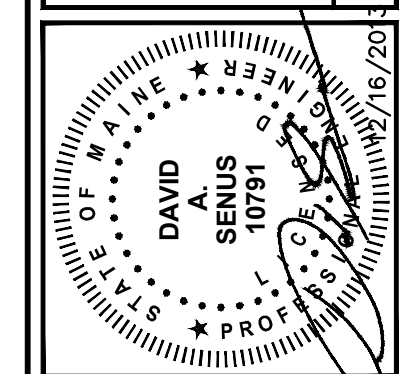

DESIGNED BY: DAS	CHECKED BY: DAS
DATE: 12/16/2013	
DRAWN BY: EGM	

**POND CROSS SECTIONS - 1**

CITY OF PORTLAND, MAINE  
CAPSIC POND ENHANCEMENTS

JOB NO: 225672.15  
DATE: DECEMBER, 2013  
SCALE: AS NOTED  
SHEET: 4 OF 9  
**C-102**

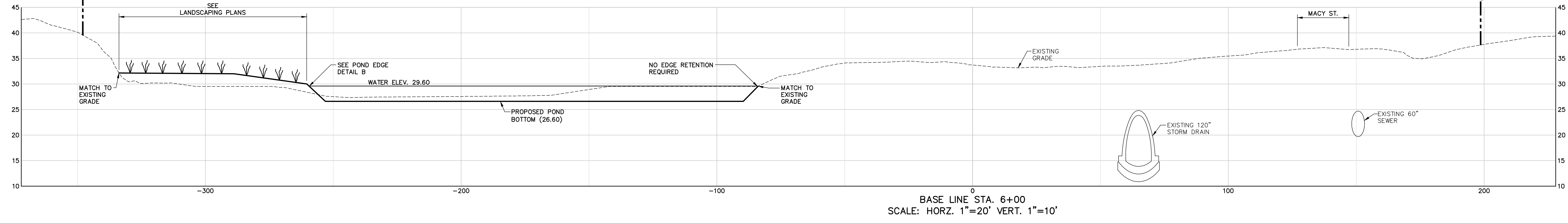
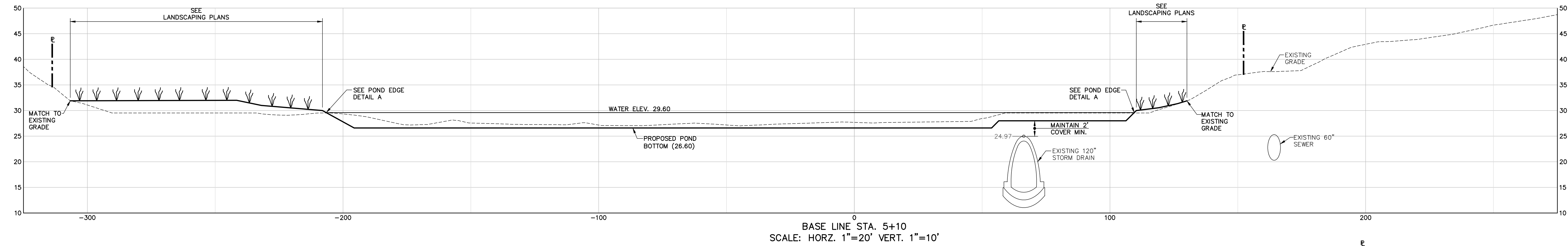
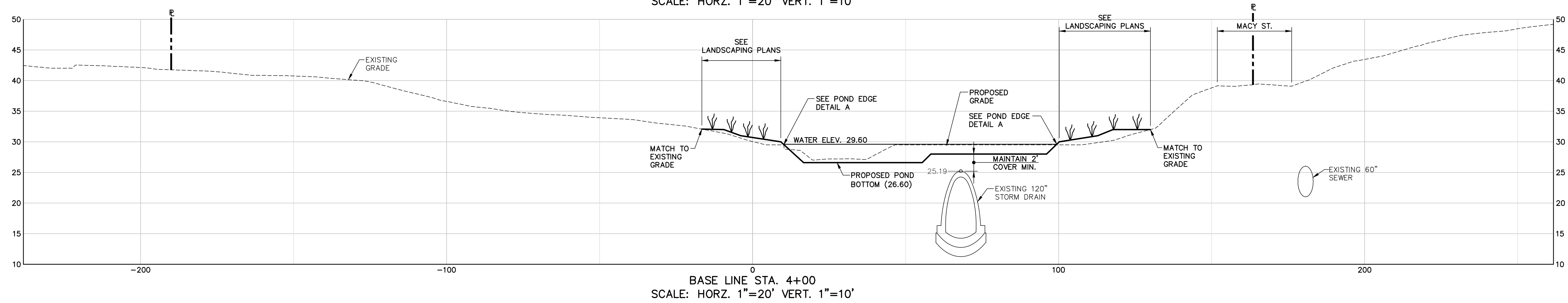
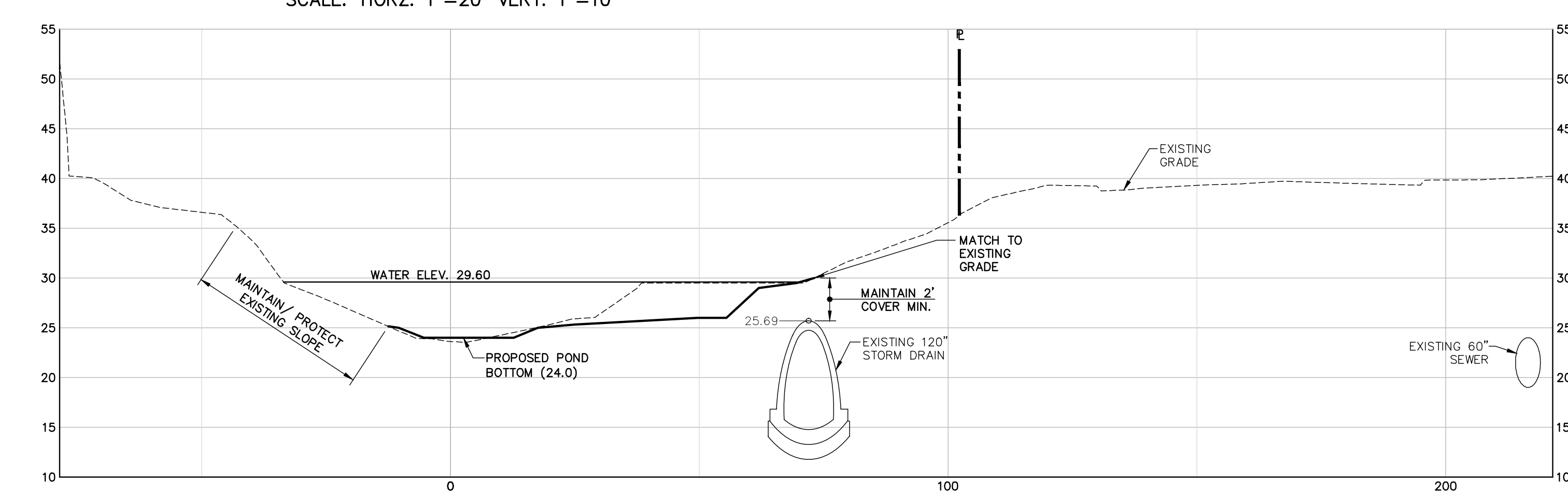
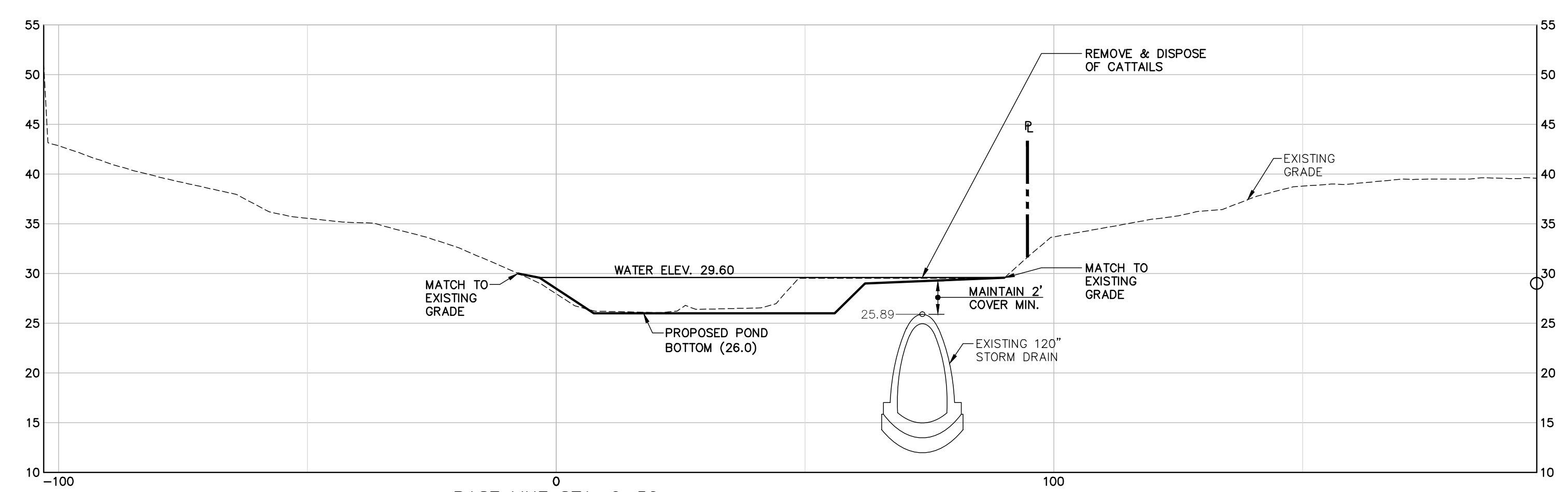

Z:\225672\portland-gae\03\sect\sh\17\capasic\_pond.ph\Drawings\Design\_Download\225672\1\_C102.dwg Dec 11, 2013 - 10:05am

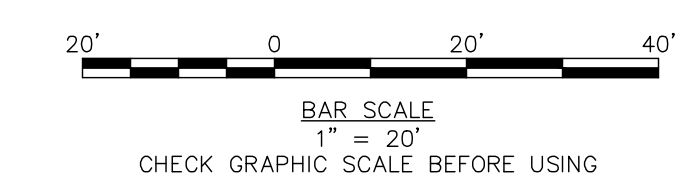

1 2 3 4 5 6 7

A  
B  
C  
D  
E  
F  
G

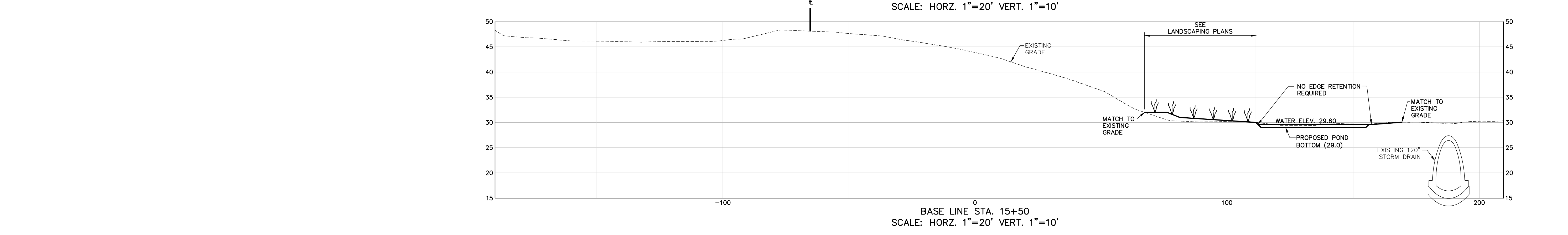
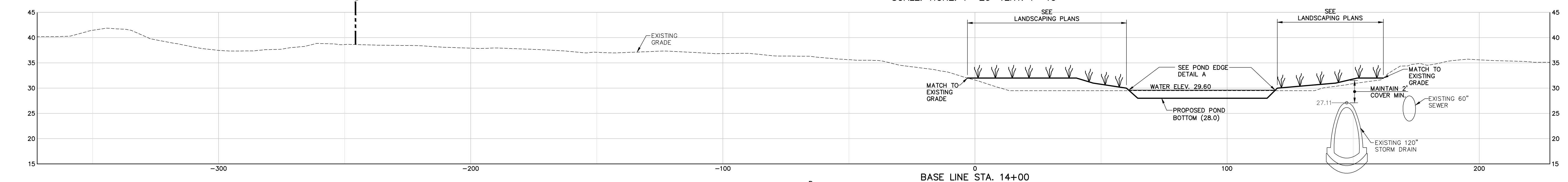
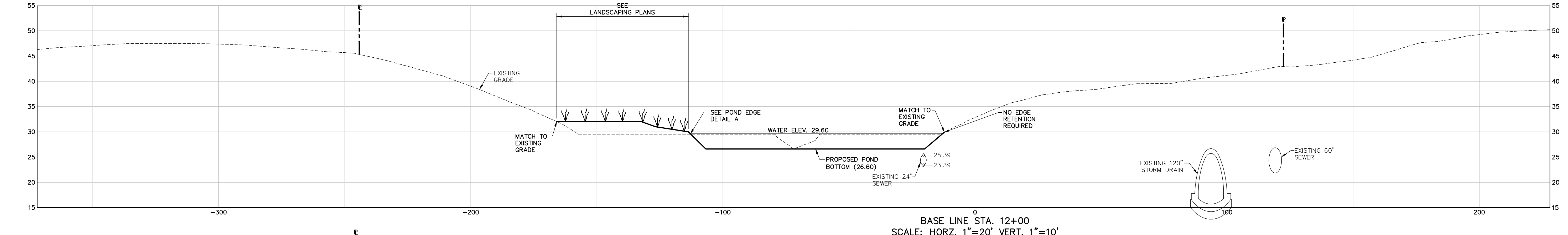
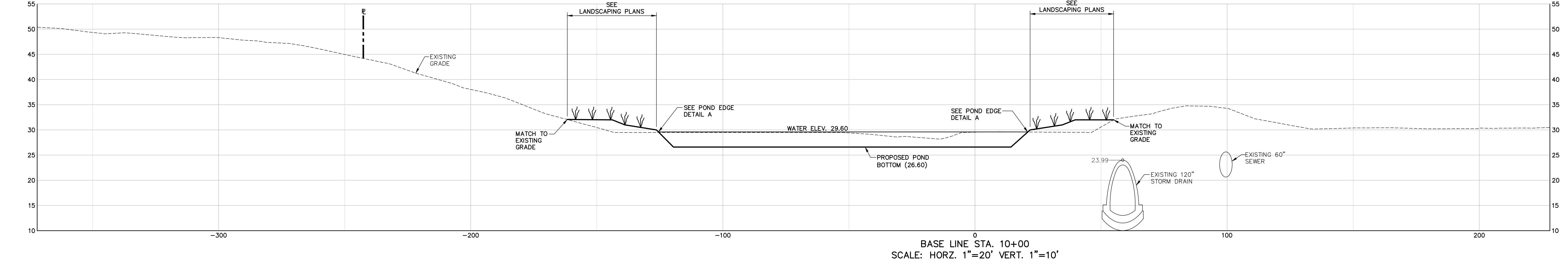
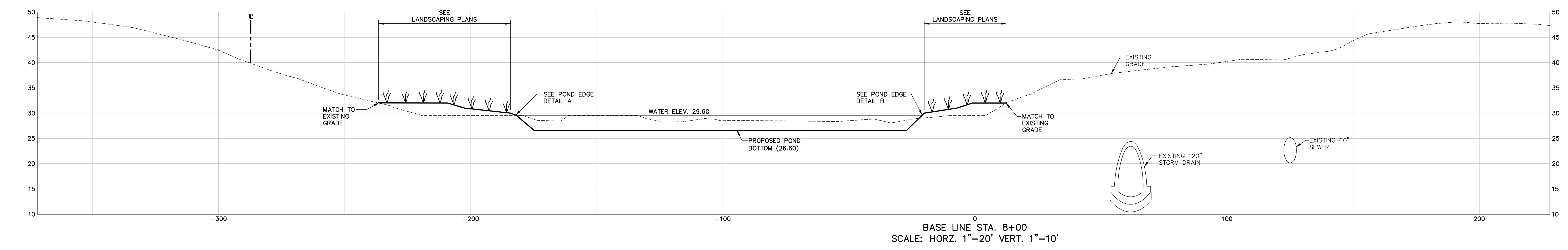

41 Hutchins Drive  
Portland, Maine 04102  
800.428.4232 | www.woodardcurran.com

**WOODARD & CURRAN**  
COMMITMENT & INTEGRITY DRIVE RESULTS

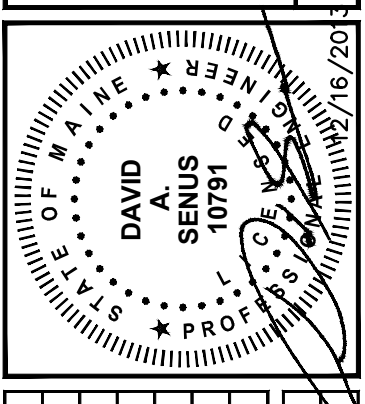

REV	DESCRIPTION	DATE	CHECKED BY/DAS	DRAWN BY/ECM

NO.	DESCRIPTION	DATE

**POND CROSS SECTIONS - 2**

CITY OF PORTLAND, MAINE  
CAPSIC POND ENHANCEMENTS

JOB NO: 225672.15  
DATE: DECEMBER, 2013  
SCALE: AS NOTED  
SHEET: 5 OF 9

**C-103**

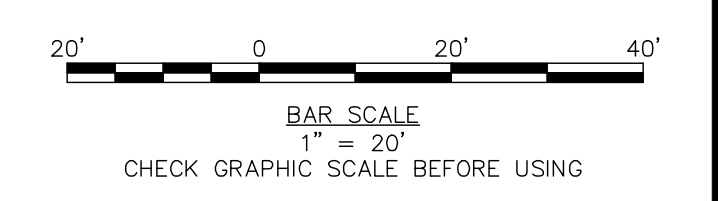

PERMIT REVIEW SET - NOT FOR CONSTRUCTION

1 2 3 4 5 6 7

Z:\225672\portland-gae\03\sect\14\17\_capsic\_pond.ph\Drawings\Design\_Drawings\225672.dwg, Dec 11, 2013 - 10:05am