

REV.	DESCRIPTION	DATE	CHECKED BY/DAS	DRAWN BY/ECM

POND CROSS SECTIONS - 2

CITY OF PORTLAND, MAINE  
CAPSIC POND ENHANCEMENTS

JOB NO: 225672.77  
DATE: JANUARY 8, 2016  
SCALE: AS NOTED  
SHEET: 5 OF 9

C-103

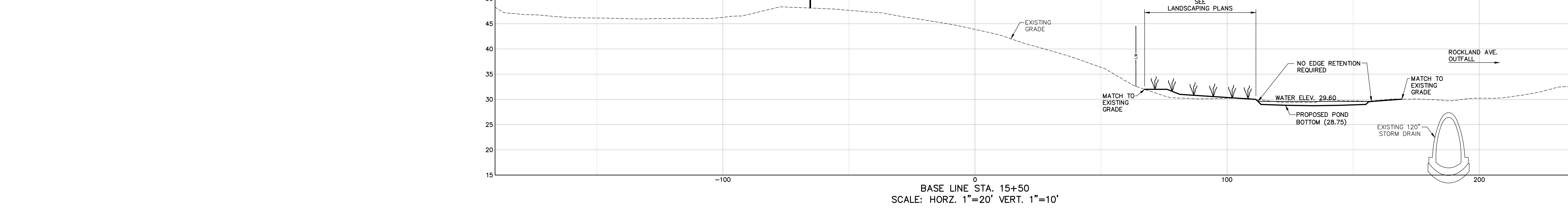
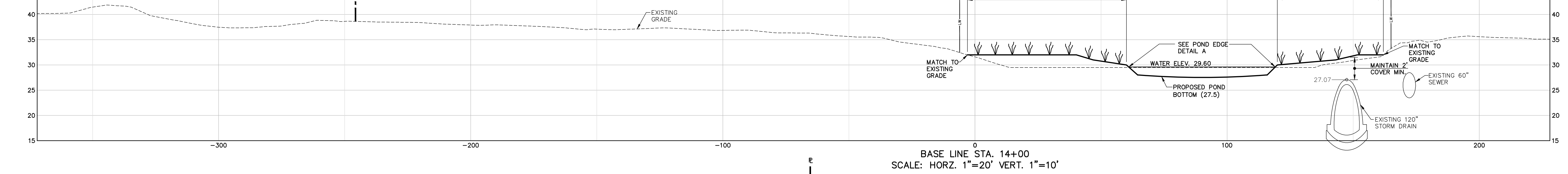
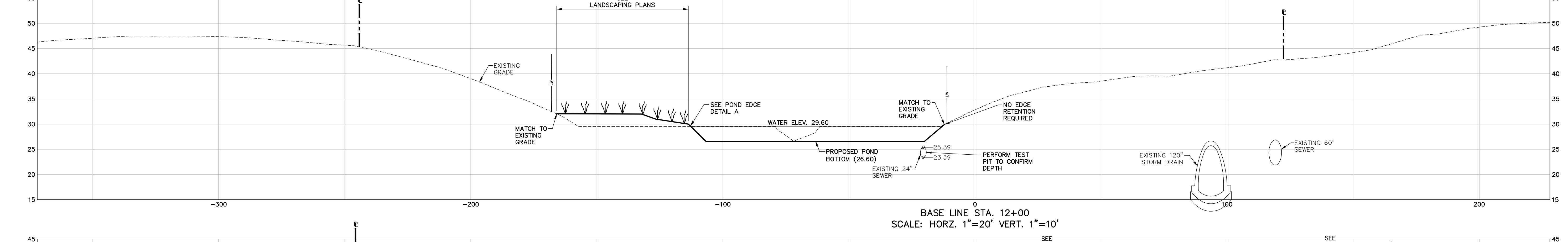
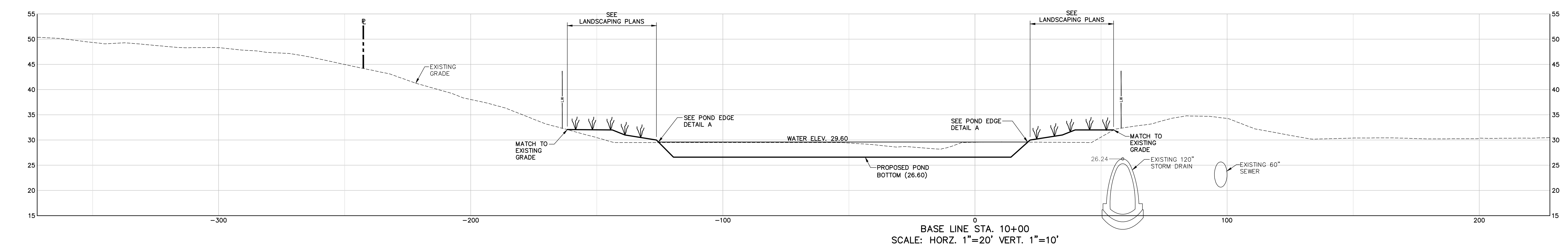
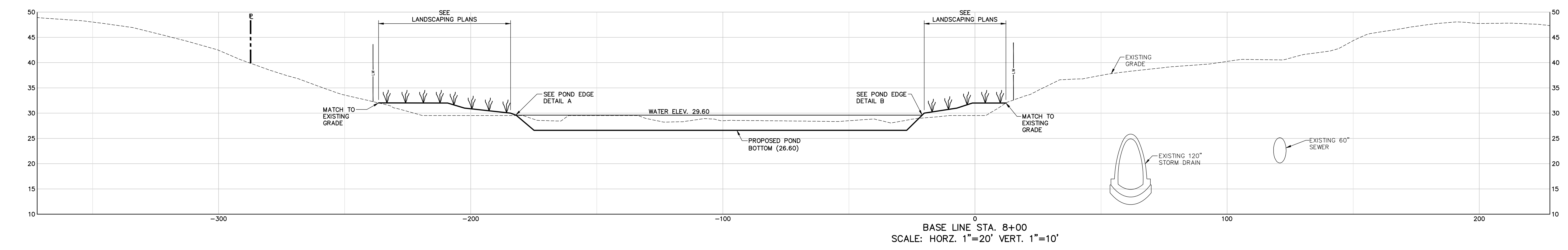

NOTE:  
1. EXISTING BURIED UTILITY LOCATIONS AND DEPTH ARE APPROXIMATE. CONTRACTOR SHALL FIELD VERIFY LOCATIONS TO ENSURE NO DAMAGE TO BURIED PIPING WITHIN LIMIT OF WORK DUE TO CONSTRUCTION ACTIVITIES. IF UTILITY LOCATIONS DIFFER FROM WHAT IS SHOWN ON PLANS, CONTRACTOR SHALL NOTIFY ENGINEER.

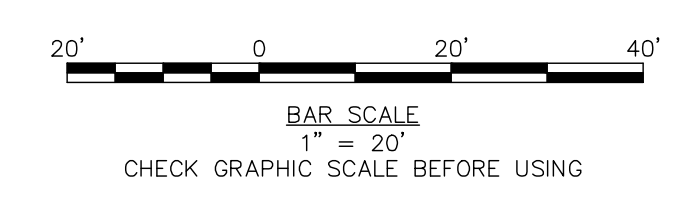

\\s:\shared\projects\225672\Portland-Cap Pond-Cross Sections.dwg (Drawing) 2/25/2016 10:53am