

**PERMIT ISSUED**

**City of Portland, Maine - Building or Use Permit Application**

389 Congress Street, 04101 Tel: (207) 874-8703, Fax: (207) 874-8716

Permit No: 03-1192	Issue Date: <b>SEP 30 2003</b>	CBL: 191 B049001
-----------------------	-----------------------------------	---------------------

Location of Construction: 57 Mitton St	Owner Name: Turgeon Eric M &	Owner Address: 57 Mitton St <b>CITY OF PORTLAND</b>	Phone: 772-3433
Business Name:	Contractor Name: self	Contractor Address: Portland	Phone:
Lessee/Buyer's Name	Phone:	Permit Type: Sheds	Zone: <b>R5</b>

Past Use: Two Family	Proposed Use: Two Family w/shed	Permit Fee:	Cost of Work: \$0.00	CEO District: 3
-------------------------	------------------------------------	-------------	-------------------------	--------------------

FIRE DEPT: <input type="checkbox"/> Approved <input type="checkbox"/> Denied	INSPECTION: Use Group: <b>R3</b> Type: <b>accessory SB</b> <b>BOCA 1999</b> Signature: <b>JMB 9/30/03</b>
--	---

Proposed Project Description:  
Build an 8x12 wood frame shed

PEDESTRIAN ACTIVITIES DISTRICT (P.A.D.)		
Action: <input type="checkbox"/> Approved	<input type="checkbox"/> Approved w/Conditions	<input type="checkbox"/> Denied
Signature:	Date:	

Permit Taken By: jmb	Date Applied For: 09/30/2003
-------------------------	---------------------------------

**Zoning Approval**

<ol style="list-style-type: none"> <li>This permit application does not preclude the Applicant(s) from meeting applicable State and Federal Rules.</li> <li>Building permits do not include plumbing, septic or electrical work.</li> <li>Building permits are void if work is not started within six (6) months of the date of issuance. False information may invalidate a building permit and stop all work..</li> </ol>	<b>Special Zone or Reviews</b> <input type="checkbox"/> Shoreland <input type="checkbox"/> Wetland <input type="checkbox"/> Flood Zone <input type="checkbox"/> Subdivision <input type="checkbox"/> Site Plan  Maj <input type="checkbox"/> Minor <input type="checkbox"/> MM <input type="checkbox"/> Date: <b>JMB 9/30/03</b>	<b>Zoning Appeal</b> <input type="checkbox"/> Variance <input type="checkbox"/> Miscellaneous <input checked="" type="checkbox"/> Conditional Use <input type="checkbox"/> Interpretation <input type="checkbox"/> Approved <input type="checkbox"/> Denied Date:	<b>Historic Preservation</b> <input type="checkbox"/> Not in District or Landmark <input type="checkbox"/> Does Not Require Review <input type="checkbox"/> Requires Review <input type="checkbox"/> Approved <input type="checkbox"/> Approved w/Conditions <input type="checkbox"/> Denied Date: <b>JMB</b>
	<p><i>approved legal 2-unit permit #97-01270</i></p>		

**CERTIFICATION**

I hereby certify that I am the owner of record of the named property, or that the proposed work is authorized by the owner of record and that I have been authorized by the owner to make this application as his authorized agent and I agree to conform to all applicable laws of this jurisdiction. In addition, if a permit for work described in the application is issued, I certify that the code official's authorized representative shall have the authority to enter all areas covered by such permit at any reasonable hour to enforce the provision of the code(s) applicable to such permit.

SIGNATURE OF APPLICANT	ADDRESS	DATE	PHONE
RESPONSIBLE PERSON IN CHARGE OF WORK, TITLE		DATE	PHONE



# Residential Building Permit Application

If you or the property owner owes real estate or personal property taxes or user charges on any property within the City, payment arrangements must be made before permits of any kind are accepted.

Location/Address of Construction: <b>59 MITTON ST.</b>		
Total Square Footage of Proposed Structure <b>96ft<sup>2</sup></b>	Square Footage of Lot <b>6,827ft<sup>2</sup></b>	
Tax Assessor's Chart, Block & Lot Chart# <b>191</b> Block# <b>B</b> Lot# <b>49</b>	Owner: <b>ERIC M. TURGEON</b> <b>STEPHANIE H. SMITH</b>	Telephone: <b>772-3433</b>
Lessee/Buyer's Name (If Applicable)	Applicant name, address & telephone: <b>ERIC M. TURGEON</b> <b>59 MITTON ST.</b> <b>772-3433</b>	Cost Of Work: \$ <b>900</b> Fee: \$ <b>30.00</b>
Current Specific use: <u><b>STORAGE SHED</b></u> <u><b>TWO Family</b></u>		
Proposed Specific use: <u><b>STORAGE SHED</b></u>		
Project description: <b>8x12 GABLE ROOF WOOD STORAGE SHED</b> <b>WOOD FLOOR RAISED ON CONCRETE BLOCKS</b>		
Contractor's name, address & telephone: <u><b>Self</b></u>		
Who should we contact when the permit is ready: <u><b>ERIC TURGEON</b></u>		
Mailing address: <b>59 MITTON ST.</b> <b>PORTLAND, ME 04102</b>		Phone: (H) <b>772-3433</b> (W) <b>442-2680</b>

Please submit all of the information outlined in the Residential Application Checklist. Failure to do so will result in the automatic denial of your permit.

At the discretion of the Planning and Development Department, additional information may be required prior to permit approval. For further information stop by the Building Inspections office, room 315 City Hall or call 874-8703.

I hereby certify that I am the Owner of record of the named property, or that the owner of record authorizes the proposed work and that I have been authorized by the owner to make this application as his/her authorized agent. I agree to conform to all applicable laws of this jurisdiction. In addition, if a permit for work described in this application is issued, I certify that the Code Official's authorized representative shall have the authority to enter all areas covered by this permit at any reasonable hour to enforce the provisions of the codes applicable to this permit.

Signature of applicant: <u><b>Eric Turgeon</b></u>	Date: <u><b>9/30/03</b></u>
--	-----------------------------

Permit Fee: \$30.00 for the first \$1000.00 Construction Cost, \$9.00 per additional \$1000.00 cost

**This is not a Permit; you may not commence any work until the Permit is issued.**

This page contains a detailed description of the Parcel ID you selected. Press the **New Search** button at the bottom of the screen to submit a new query.

**Current Owner Information**

Card Number 1 of 1  
 Parcel ID 191 B049001  
 Location 57 MITTON ST  
 Land Use TWO FAMILY

Owner Address TURGEON ERIC M & STEPHANIE H SMITH JTS  
 57 MITTON ST  
 PORTLAND ME 04102

Book/Page 17585/120  
 Legal 191-B-49  
 MITTON ST 57-67  
 6827 SF

*3PM  
 Eric  
 #1192  
 R-5 Zone*

**Valuation Information**

Land \$31,400 Building \$94,920 Total \$126,320

**Property Information**

<b>Year Built</b> 1978	<b>Style</b> Duplex	<b>Story Height</b> 2	<b>Sq. Ft.</b> 1862	<b>Total Acres</b> 0.157		
<b>Bedrooms</b> 4	<b>Full Baths</b> 2	<b>Half Baths</b>	<b>Total Rooms</b> 8	<b>Attic</b> None	<b>Basement</b> Pier/slab	

**Outbuildings**

<b>Type</b>	<b>Quantity</b>	<b>Year Built</b>	<b>Size</b>	<b>Grade</b>	<b>Condition</b>
-------------	-----------------	-------------------	-------------	--------------	------------------

**Sales Information**

<b>Date</b> 04/01/2002	<b>Type</b> LAND + BLDING	<b>Price</b> \$210,000	<b>Book/Page</b> 17585-120
---------------------------	------------------------------	---------------------------	-------------------------------

**Picture and Sketch**

Picture Sketch

[Click here](#) to view Tax Roll Information.

Any information concerning tax payments should be directed to the Treasury office at 874-8490 or e-mailed.



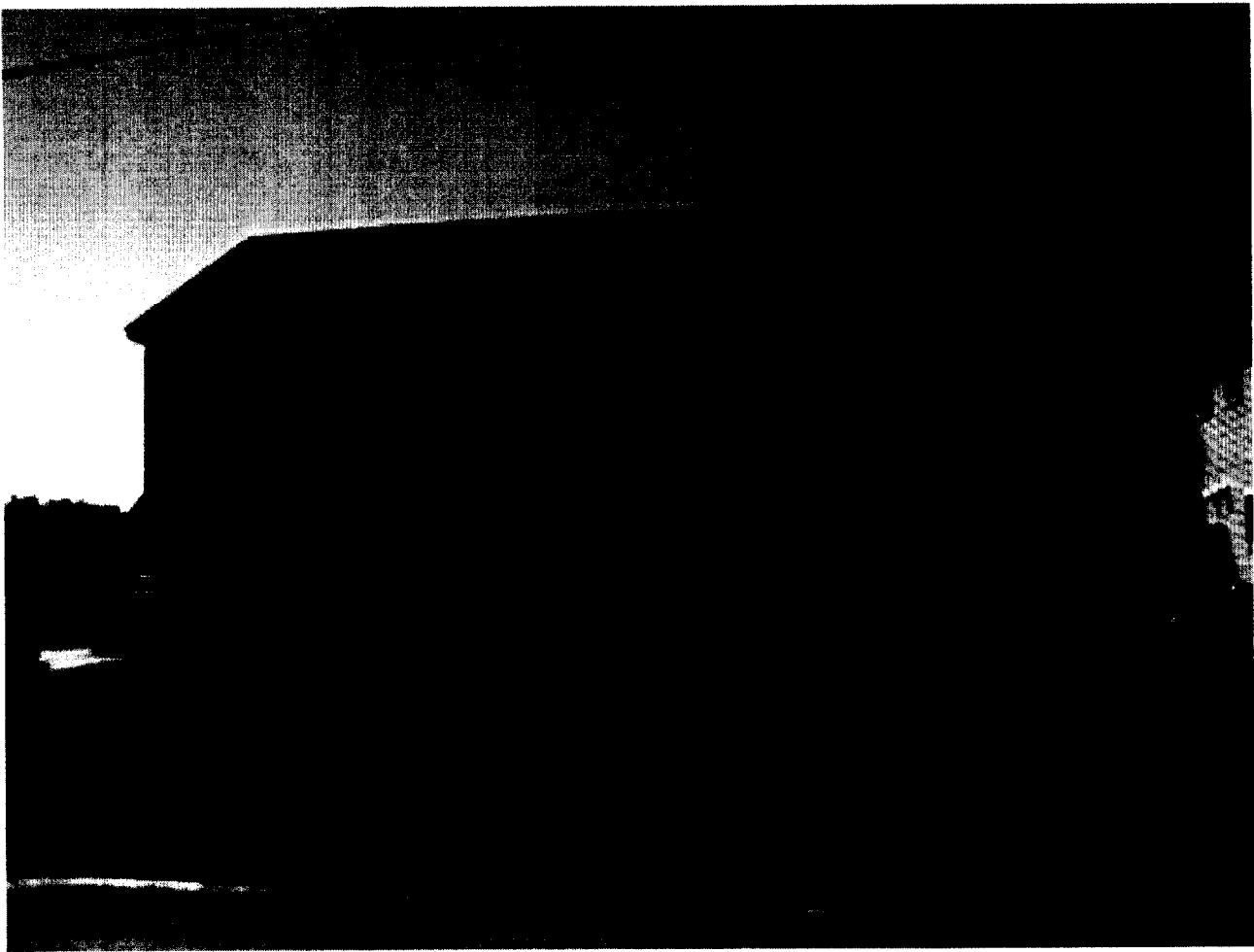

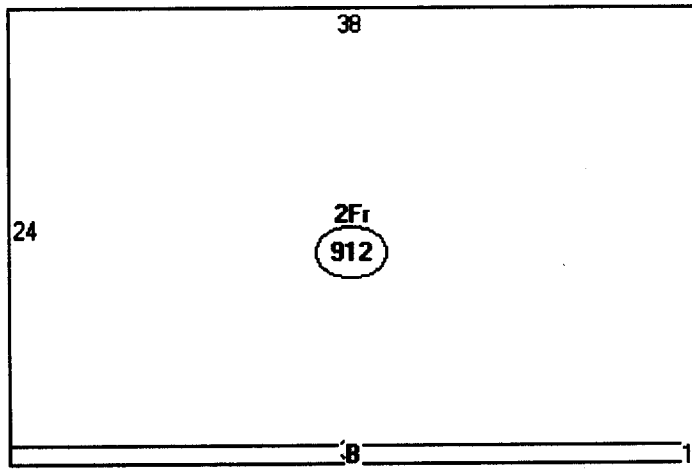

Descriptor/Area

A: 2Fr  
912 sqft

B: FOH  
38 sqft

# Site / Subdivision Plan

11/03/97 Revised,  
Owen Haskell  
"THE WILLOW"

F. 02/03

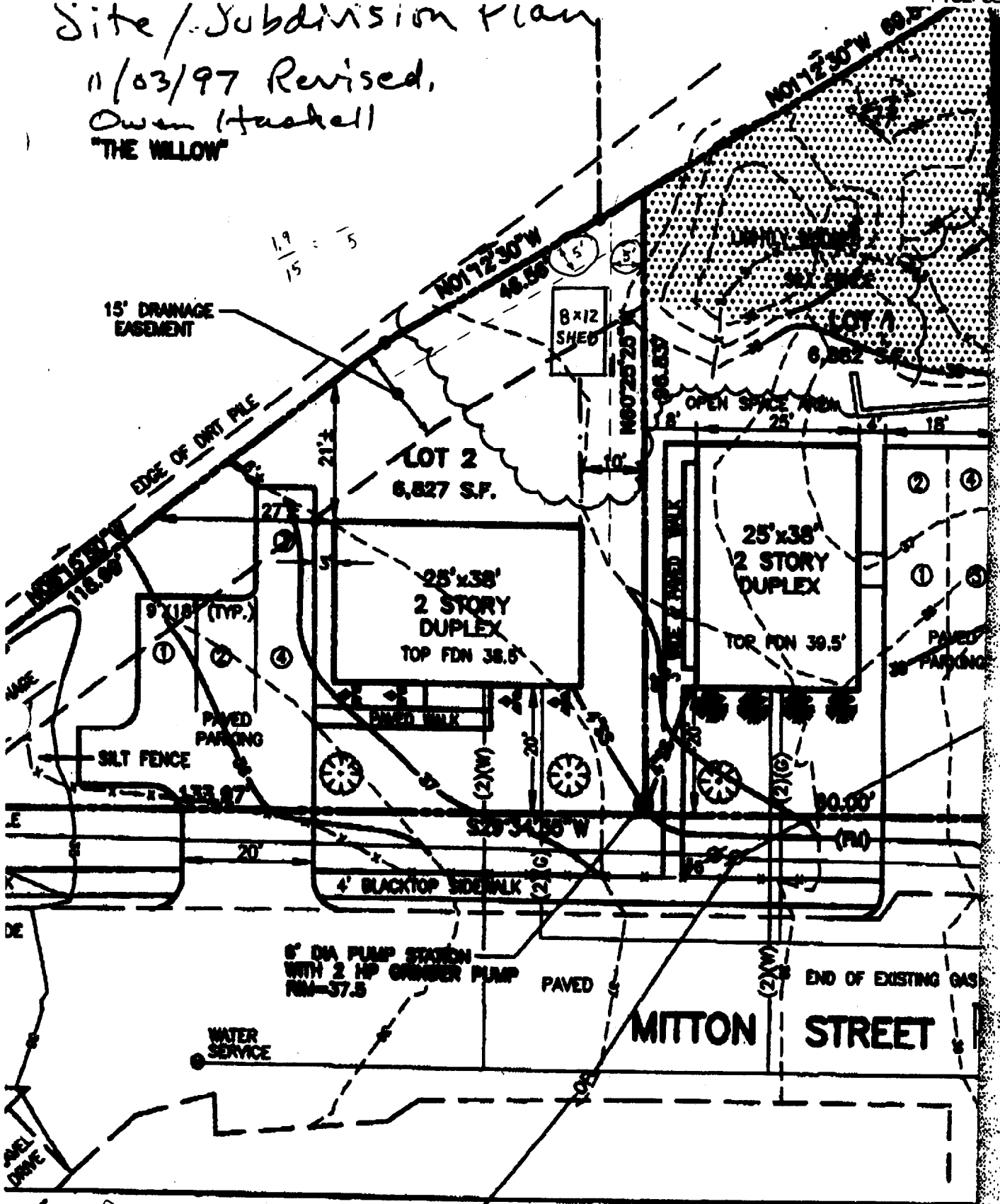

A5 Zone  
accessory shed under  
100 SF can be a min.  
of 5' from property lines

NOTE: REFER TO CITY OF PORTLAND PUBLIC  
FOR ALL DETAILS THAT RELATE TO SANITARY

NOTE: SEE ATTACHMENT "A" FOR EROSION

# 8' x 12' GABLE END STORAGE SHED

ITEM	QUANT	MATERIAL DESCRIPTION	COST EA.	COST TOTAL
1	4	4" x 4" Pressure Treated, (2) 8'-0" Long, (2) 12'-0" Long		
2	5	2" x 4" Pressure Treated, 8'-0" Long		
3	3	3/4" Thick CDX Plywood, 4' x 8' Sheet (for floor) ✓		
4	49 *	2" x 4" Stud Grade (or better) Doug-Fir, 8'-0" Long		
5	6	2" x 4" No. 2 or better, Doug-Fir, 12'-0" Long		
6	1	2" x 8" No. 2 or better, Doug-Fir, 12'-0" Long		
7	4	2" x 4" Soffit Vents - 22-1/2" Long, or Full Aluminum Soffit Vent		
8	10	Hurricane Ties for 2x4 Rafters - Rafter to Wall (Simpson Model H1 or equal)		
9	2	2x8 Face Mount Beam Hanger (Simpson Model LUS28 or equal)		
10	10	2x4 Face Mount Beam Hanger (Simpson Model LUS24 or equal)		
11	11	4' x 8' Sheet of Siding (T-111, CDX, Wafer, etc.)		
12	5	7/16" Thick (or greater) Wafer Board, 4' x 8' Sheet (for roof)		
13	9	1" x 4" Cedar Trim Board (or equal), 8'-0" Long		
14	10	1" x 4" Cedar Trim Board (or equal), 10'-0" Long		
15	1	36" Wide by 6'-8" Tall Entry Door with Frame		
16	1	Door Hardware (Lockable Opener and Deadbolt if desired)		
17	0-2	2'-0" x 2'-0" Window (Actual dimensions 23.5" x 23.5") (Optional)		
18	150 ft <sup>2</sup>	Asphalt Shingles		
19	150 ft <sup>2</sup>	15# Tar Paper		
20	~1,250	8d 2-1/2" Common Nails, Galvanized (for framing and sheeting)		
21	~300	1" Long Roofing Nails, Galvanized (for roofing)		
22	20	10d 3" Finishing Nails, Galvanized (for door installation)		
23	~200	6d 2" Common Nails, Galvanized (for trim work)		
24	2	Package of cedar shims for door installation		
25	-	Exterior Paint as Desired		
26	1	Exterior silicone based caulking, Paintable		

**MATERIALS LIST NOTE:**

This Materials List assumes a purchased pre-hung door is to be installed. If you will be making your own door (either 36" or double 30"), the following additional materials will be needed.

Homemade 36" door: (1) 4'x8' sheet of 1/2" CDX plywood  
(5) 1"x3" Cedar Trim Board (or equal) 8' long  
(3) Hinges, (1) Door Latch as desired

Homemade 30" doors: (2) 4'x8' sheet of 1/2" CDX plywood  
(10) 1"x3" Cedar Trim Board (or equal) 8' long  
(6) Hinges, (1) Door Latch, (1) Slave Latch, as desired.

We are working on a customer "do-it-yourself" photo album web page which will feature photographs of our customers projects. If you would like to participate, take a picture of your project and either mail the photograph to us or scan it and e-mail it to us at:

mail to: L & R Designs, LLC  
356 Holcomb Rd.  
Kelso, WA 98626

e-mail to: doityourself@choosefreedom.com

L & R Designs, LLC is not responsible or liable for the safety of any person building or using the items based on our plans.

There are no stated, assumed, or implied guarantees of the structural integrity of this shed. If there is concern about abnormal environmental conditions, contact your local building official.

A building permit may be required for construction of this shed. These plans should help acquire a permit, but may not be a complete package as required by your building official.

These plans are copyright protected. No unauthorized reproduction of these plans is allowed.

\* (49) 2x4-8" WITH 0 WINDOWS  
(54) 2x4-8" WITH 1 WINDOW  
(61) 2x4-8" WITH 2 WINDOWS

**TOTAL COST OF MATERIALS**

COMPARE TO COST TO PURCHASE!!

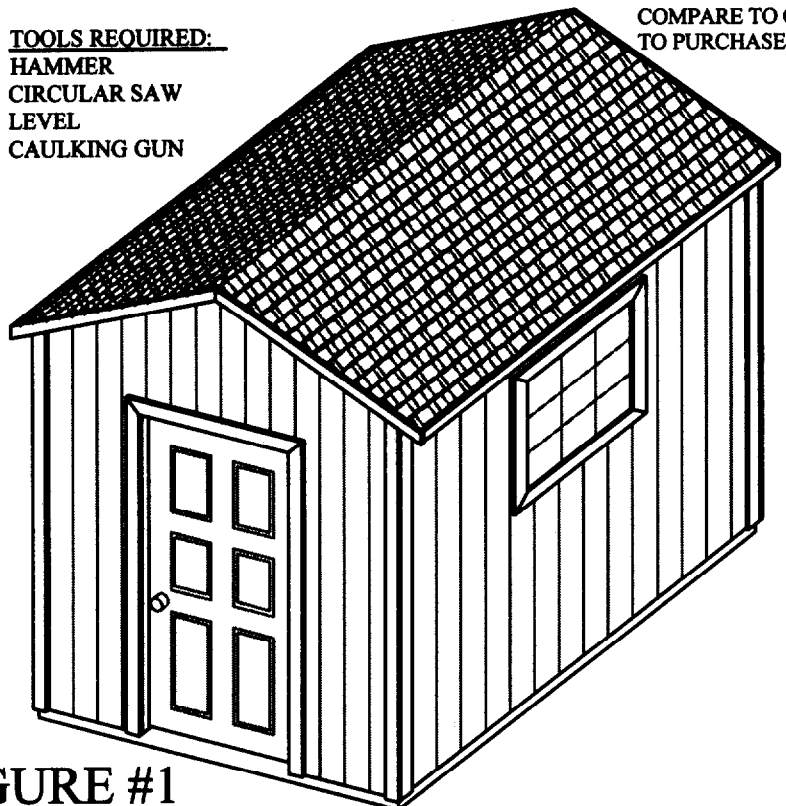

**FIGURE #1**

FINISHED SHED



# 8' x 12' GABLE END STORAGE SHED

ITEM	QUANT	MATERIAL DESCRIPTION	COST EA.	COST TOTAL
1	4	4" x 4" Pressure Treated, (2) 8'-0" Long, (2) 12'-0" Long		
2	5	2" x 4" Pressure Treated, 8'-0" Long		
3	3	3/4" Thick CDX Plywood, 4' x 8' Sheet (for floor)		
4	49 *	2" x 4" Stud Grade (or better) Doug-Fir, 8'-0" Long		
5	6	2" x 4" No. 2 or better, Doug-Fir, 12'-0" Long		
6	1	2" x 8" No. 2 or better, Doug-Fir, 12'-0" Long		
7	4	2" x 4" Soffit Vents - 22-1/2" Long, or Full Aluminum Soffit Vent		
8	10	Hurricane Ties for 2x4 Rafters - Rafter to Wall (Simpson Model H1 or equal)		
9	2	2x8 Face Mount Beam Hanger (Simpson Model LUS28 or equal)		
10	10	2x4 Face Mount Beam Hanger (Simpson Model LUS24 or equal)		
11	11	4' x 8' Sheet of Siding (T-111, CDX, Wafer, etc.)		
12	5	7/16" Thick (or greater) Wafer Board, 4' x 8' Sheet (for roof)		
13	9	1" x 4" Cedar Trim Board (or equal), 8'-0" Long		
14	10	1" x 4" Cedar Trim Board (or equal), 10'-0" Long		
15	1	36" Wide by 6'-8" Tall Entry Door with Frame		
16	1	Door Hardware (Lockable Opener and Deadbolt if desired)		
17	0-2	2'-0" x 2'-0" Window (Actual dimensions 23.5" x 23.5") (Optional)		
18	150 ft <sup>2</sup>	Asphalt Shingles		
19	150 ft <sup>2</sup>	15# Tar Paper		
20	~1,250	8d 2-1/2" Common Nails, Galvanized (for framing and sheeting)		
21	~300	1" Long Roofing Nails, Galvanized (for roofing)		
22	20	10d 3" Finishing Nails, Galvanized (for door installation)		
23	~200	6d 2" Common Nails, Galvanized (for trim work)		
24	2	Package of cedar shims for door installation		
25	-	Exterior Paint as Desired		
26	1	Exterior silicone based caulking, Paintable		

**MATERIALS LIST NOTE:**

This Materials List assumes a purchased pre-hung door is to be installed. If you will be making your own door (either 36" or double 30"), the following additional materials will be needed.

Homemade 36" door: (1) 4'x8' sheet of 1/2" CDX plywood  
 (5) 1"x3" Cedar Trim Board (or equal) 8' long  
 (3) Hinges, (1) Door Latch as desired

Homemade 30" doors: (2) 4'x8' sheet of 1/2" CDX plywood  
 (10) 1"x3" Cedar Trim Board (or equal) 8' long  
 (6) Hinges, (1) Door Latch, (1) Slave Latch, as desired.

We are working on a customer "do-it-yourself" photo album web page which will feature photographs of our customers projects. If you would like to participate, take a picture of your project and either mail the photograph to us or scan it and e-mail it to us at:

mail to: L & R Designs, LLC  
 356 Holcomb Rd.  
 Kelso, WA 98626

e-mail to: doityourself@choosefreedom.com

L & R Designs, LLC is not responsible or liable for the safety of any person building or using the items based on our plans.

There are no stated, assumed, or implied guarantees of the structural integrity of this shed. If there is concern about abnormal environmental conditions, contact your local building official.

A building permit may be required for construction of this shed. These plans should help acquire a permit, but may not be a complete package as required by your building official.

These plans are copyright protected. No unauthorized reproduction of these plans is allowed.

\* (49) 2x4-8' WITH 0 WINDOWS  
 (54) 2x4-8' WITH 1 WINDOW  
 (61) 2x4-8' WITH 2 WINDOWS

**TOTAL COST OF MATERIALS**

COMPARE TO COST TO PURCHASE!!

**TOOLS REQUIRED:**  
 HAMMER  
 CIRCULAR SAW  
 LEVEL  
 CAULKING GUN

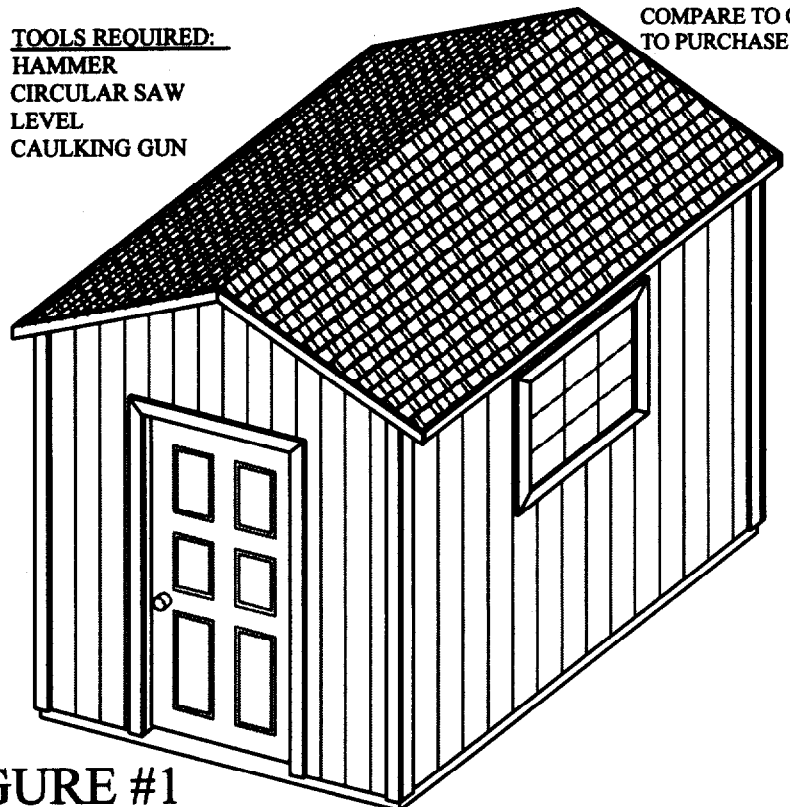

**FIGURE #1**

FINISHED SHED



NAIL THROUGH BOTTOM BOTTOM  
CORD OF TRUSS INTO TOP PLATE  
OF WALL PANEL, NAIL @ 6" O.C.  
STAGGERED, BOTH TRUSSES

**STEP #8**

INSTALL FRAMED AND SHEATHED END  
GABLES AS SHOWN IN FIGURE #13. PLACE  
SHEATHED TRUSS ON TOP PLATE OF FRONT  
AND BACK WALL PANELS. ENSURE GABLES  
ARE CENTERED ON WALLS AND NAIL  
THROUGH BOTTOM CORD OF TRUSSES INTO  
TOP PLATE OF FRONT AND BACK WALLS.  
NAIL WITH 8d COMMON NAILS @ 6" O.C.  
STAGGERED. THE GABLED ENDS SHOULD BE  
STABLE WITHOUT ADDITIONAL BRACING.

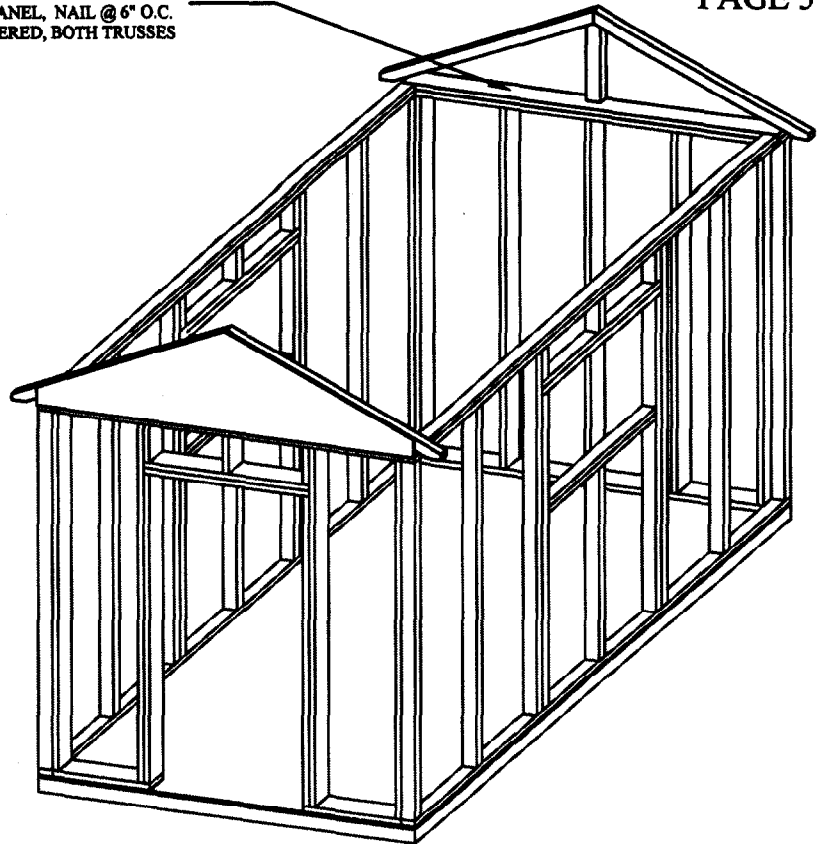

**FIGURE #13**  
GABLE END INSTALLATION

USE FACE MOUNT HANGER  
FOR ALL RIDGE TO BEAM  
CONNECTIONS, "SIMPSON" #LUS24  
TYP. (10) PLACES

SECURE RAFTERS TO  
SIDE WALLS WITH  
HURRICANE CLIPS,  
TYP. (10) PLACES

FACE MOUNT  
HANGER  
"SIMPSON" LUS28

2x8 RIDGE BEAM

FACE MOUNT HANGER  
"SIMPSON" LUS28

(10) ROOF  
RAFTERS

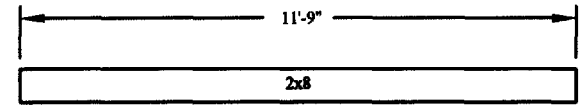
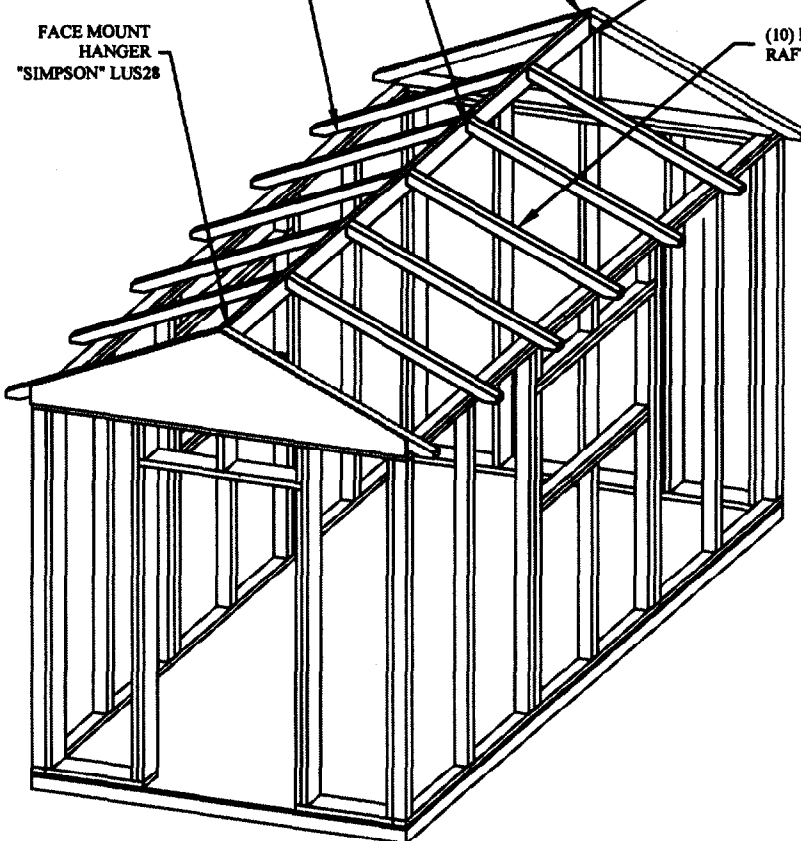

**RIDGE BEAM**  
MAKE: (1) ONE

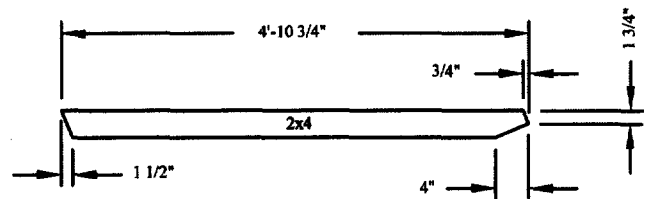

**RAFTERS**  
MAKE: (10) TEN

**STEP #9**

MAKE (1) RIDGE BEAM AND (10) RAFTERS PER  
DETAILED PART SKETCHES ABOVE. INSTALL  
RIDGE BEAM BETWEEN GABLED ENDS AS  
SHOWN IN FIGURE #14 USING FACE MOUNT  
STEEL HANGERS (OR EQUAL). INSTALL (10)  
RAFTERS, EQUALLY SPACED, USING FACE  
MOUNT STEEL HANGER (OR EQUAL) FOR  
CONNECTION TO RIDGE BEAM AND HURRICANE  
CLIPS FOR CONNECTION TO THE SIDE WALLS.

**FIGURE #14**

ROOF RAFTER INSTALLATION

**STEP #10**

INSTALL SHEETING ON ALL STUD WALLS AS SHOWN IN FIGURE #15. ALL SHEETS SHOULD BE FULL 4x8 SHEETS. MEASURE LOCATIONS OF DOOR AND WINDOWS (IF PRESENT) AND CUT OUT BEFORE PLACING SHEETS ON WALLS. NAIL WITH 8d NAILS @ 6" O.C. AROUND PERIMETER OF ALL SHEETS AND 12" O.C. ON INTERIOR OF ALL SHEETS WHERE SHEETS ARE OVER STUDS.

MEASURE GAP BETWEEN RAFTERS AND CUT SOFFIT CAPS OR SOFFIT VENTS TO FIT AS SHOWN IN FIGURE #15. SOFFIT CAPS TO BE MADE FROM REGULAR 2x4's. SOFFIT VENTS CAN BE PURCHASED FROM LUMBER YARD OR MADE WITH SCREEN MATERIAL.

START WITH FULL 4x8 SHEETS OF PLYWOOD, MEASURE CUT-OUT FOR WINDOWS AND DOORS IF REQUIRED

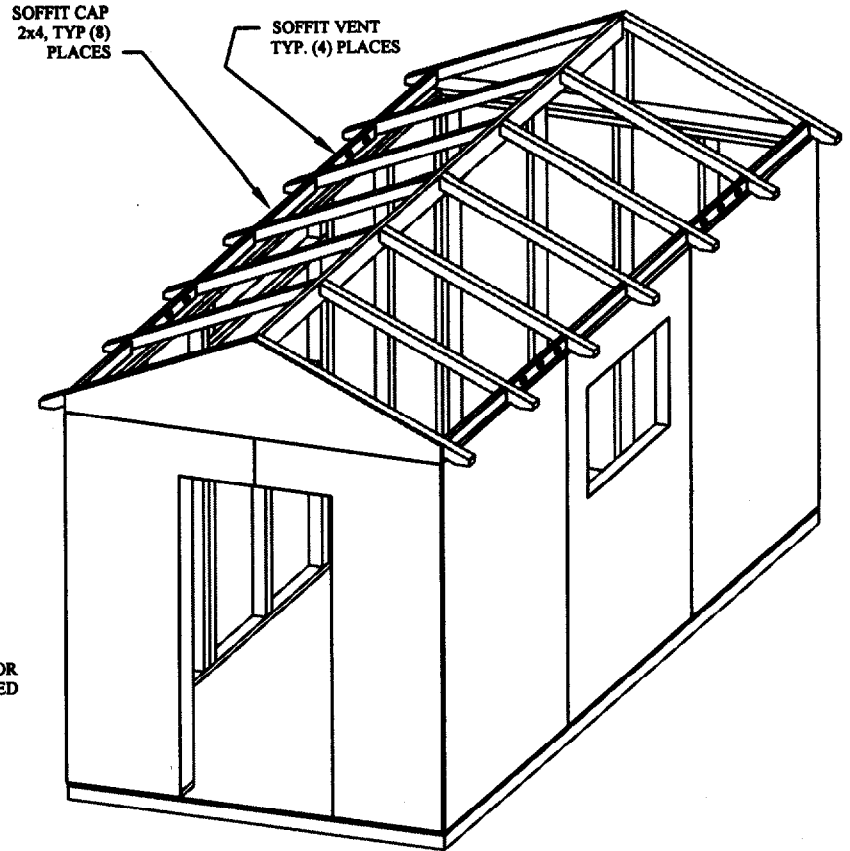

**FIGURE #15**

SIDING INSTALLATION

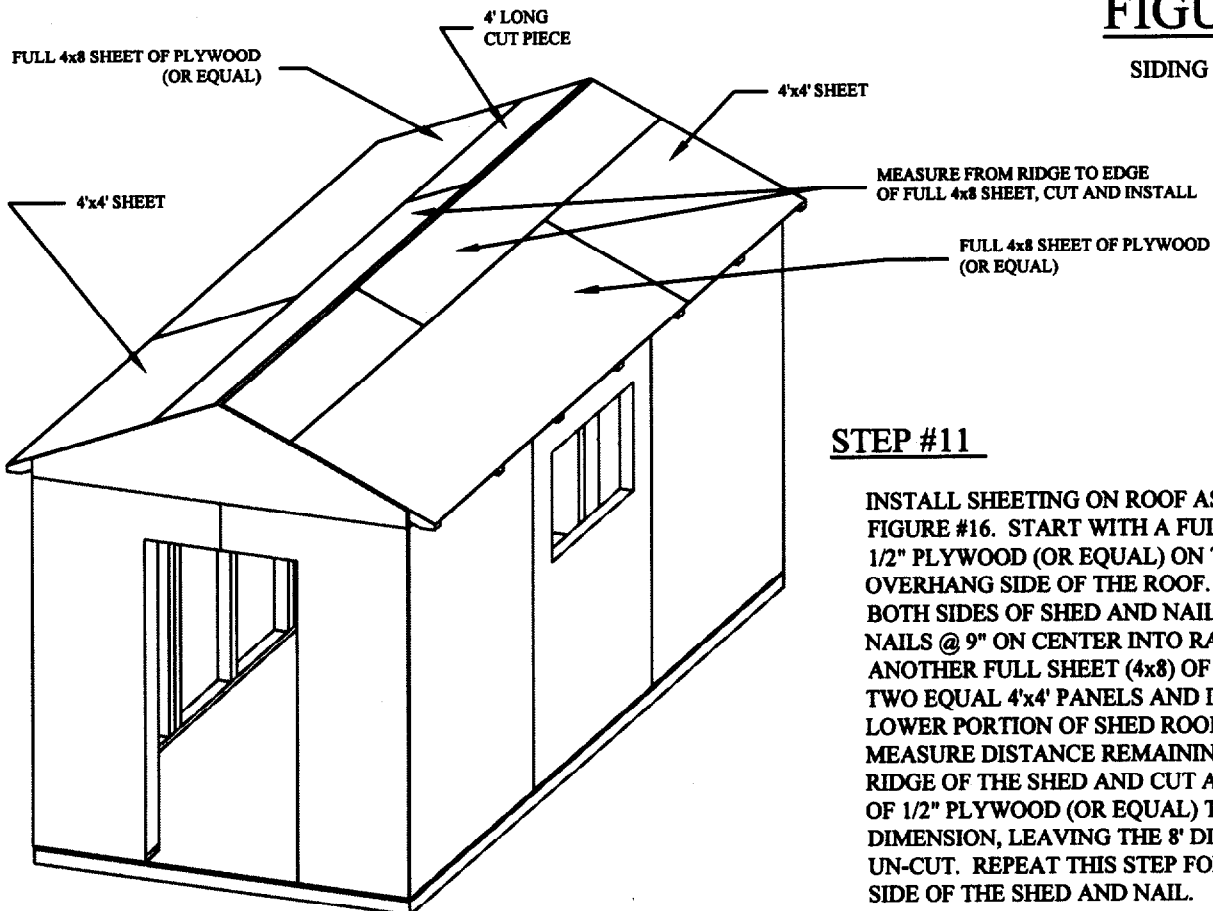

**STEP #11**

INSTALL SHEETING ON ROOF AS SHOWN IN FIGURE #16. START WITH A FULL SHEET OF 1/2" PLYWOOD (OR EQUAL) ON THE OVERHANG SIDE OF THE ROOF. INSTALL ON BOTH SIDES OF SHED AND NAIL WITH 8d NAILS @ 9" ON CENTER INTO RAFTERS. CUT ANOTHER FULL SHEET (4x8) OF PLYWOOD IN TWO EQUAL 4'x4' PANELS AND INSTALL ON LOWER PORTION OF SHED ROOF. NOW MEASURE DISTANCE REMAINING TO THE RIDGE OF THE SHED AND CUT A 4x8 SHEET OF 1/2" PLYWOOD (OR EQUAL) TO THIS DIMENSION, LEAVING THE 8' DIMENSION UN-CUT. REPEAT THIS STEP FOR THE OTHER SIDE OF THE SHED AND NAIL.

**FIGURE #16**

ROOF SHEATHING INSTALLATION

INSTALL TRIM AROUND ROOF AS SHOWN IN FIGURE #17. START WITH THE SIDE WALL FACIA TRIM. MEASURE THE DISTANCE FROM THE OUTSIDE OF SHEATHING ON THE FRONT OF THE SHED TO THE OUTSIDE OF THE SHEATHING ON THE BACK OF THE SHED AND CUT A 1x4 TRIM BOARD TO THIS DIMENSION (MAY HAVE TO INSTALL THIS TRIM IN (2) PIECES). INSTALL AND NAIL WITH (2) 6d NAILS INTO THE END OF EACH ROOF RAFTER.

NOW MEASURE DISTANCE FROM THE PEAK OF THE RIDGE ALONG THE TOP OF THE ROOF LINE TO THE OUTSIDE OF THE FACIA TRIM BOARD JUST INSTALLED ON THE SIDE. SUBSTITUTE THIS LENGTH FOR DIMENSION "A" IN FIGURE #17a BELOW AND CUT GABLE FACIA BOARD PER FIGURE #17a BELOW AND THE MEASUREMENT TAKEN. INSTALL GABLE FACIA BOARD, NAIL WITH 6d COMMON NAILS @ 12" O.C., STAGGERED. REPEAT THIS FOR ALL (4) GABLE FACIA BOARDS.

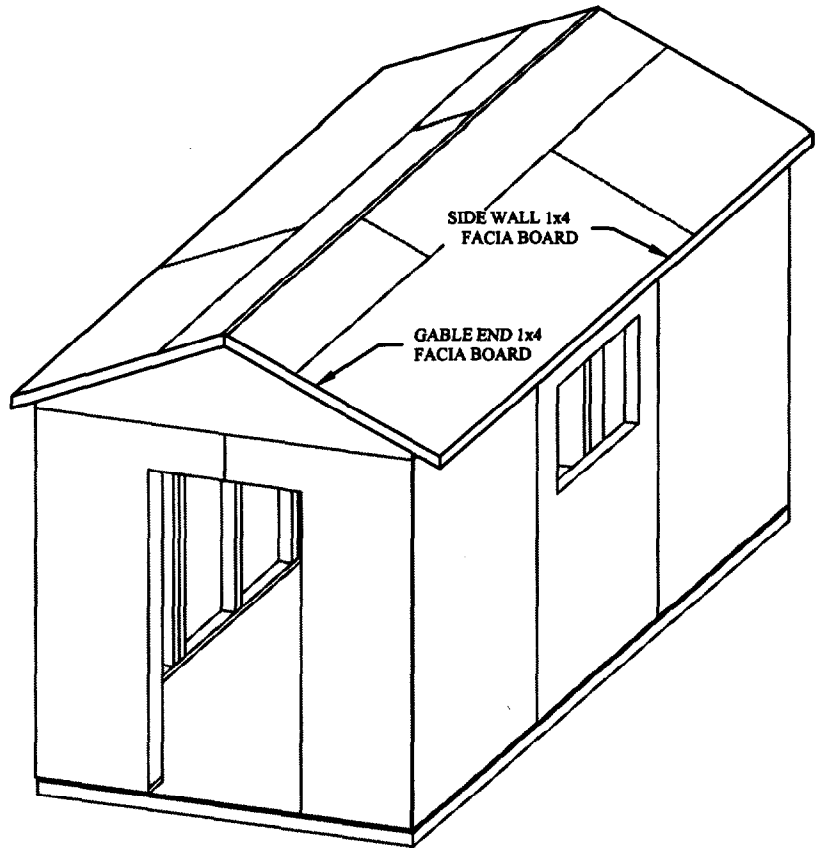

**FIGURE #17**

ROOF TRIM INSTALLATION

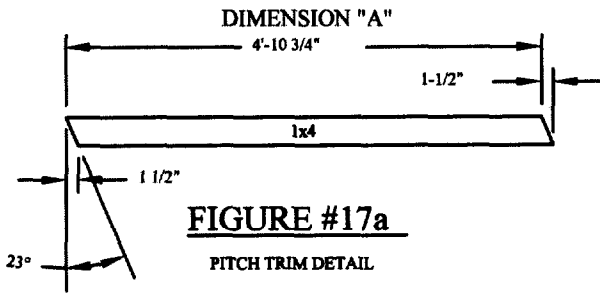

**FIGURE #17a**

PITCH TRIM DETAIL

**STEP #3**

INSTALL SHIMS ON TOP OF DOOR FRAME. ENSURE DOOR CLOSSES SMOOTHLY AND TOP OF DOOR FRAME IS LEVEL, THEN NAIL (WITH LARGE FINISH NAILS) THROUGH SHIMS.

**STEP #2**

INSTALL SHIMS AT SAME ELEVATIONS AS HINGES OF DOOR FRAME. ENSURE DOOR CLOSSES SMOOTHLY AND HANDLE SIDE IS LEVEL, THEN NAIL (WITH LARGE FINISH NAILS) THROUGH SHIMS.

FOLLOW MANUFACTURERS INSTRUCTION FOR INSTALLATION OF DOOR HANDLE HARDWARE

**NOTE:**

IF YOU CHOSE TO MAKE YOUR OWN DOOR, SEE THE FINAL PAGE FOR INSTRUCTIONS. ALSO, IF YOU CHOSE TO UTILIZE THE DOUBLE DOOR OPTION, YOU MUST MODIFY THE TRIM DIMENSIONS SHOWN ON THE FOLLOWING PAGE FOR THE WIDER DOOR.

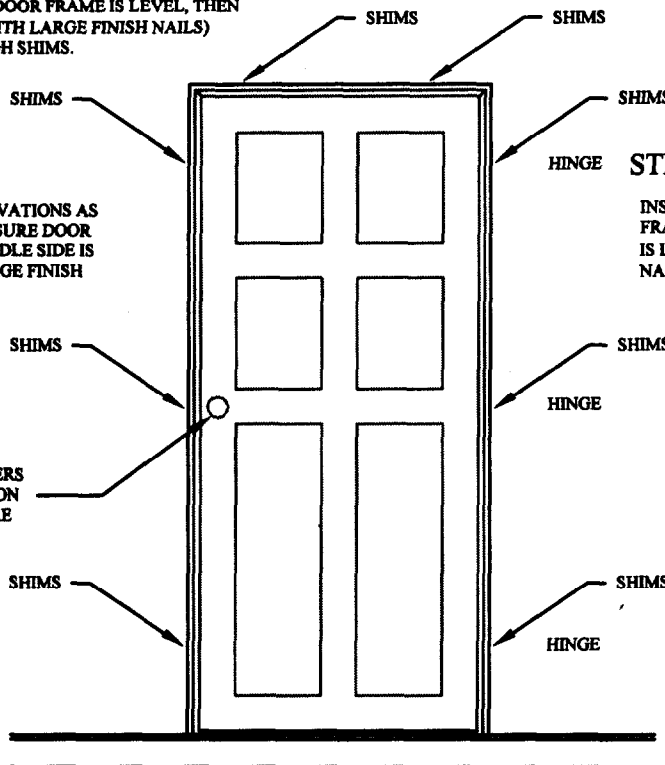

**STEP #1**

INSTALL SHIMS BEHIND HINGES OF DOOR FRAME. ENSURE HINGE SIDE OF DOOR IS LEVEL, THEN NAIL (WITH LARGE FINISH NAILS) THROUGH SHIMS.

**STEP #13**

INSTALL DOOR IN FRONT WALL PER STEPS SHOWN IN FIGURE #18.

**FIGURE #18**

DOOR INSTALLATION

## STEP #14

INSTALL TRIM AROUND DOOR, WINDOWS (IF INSTALLED), AND CORNERS OF SHED AS SHOWN IN FIGURE #19.

FOR DOOR VERTICAL TRIM BOARD, MEASURE DISTANCE FROM THE BOTTOM OF THE SIDING TO THE BOTTOM OF THE DOOR FRAME AND SUBSTITUTE THIS LENGTH FOR DIMENSION "A" IN FIGURE #20.

FOR THE TOP TRIM BOARD ON THE DOOR AND THE TRIM BOARDS AROUND THE WINDOWS, MEASURE THE INSIDE DIMENSION OF THE OPENING AND SUBSTITUTE THESE LENGTHS FOR DIMENSIONS "B" IN FIGURE #20 AND FIGURE #21.

FOR THE GABLE SIDE CORNER TRIM BOARDS, MEASURE THE DISTANCE FROM THE BOTTOM OF THE SIDING ALONG THE CORNER OF THE SHED TO THE GABLE TRIM BOARD PREVIOUSLY INSTALLED. SUBSTITUTE THIS LENGTH FOR DIMENSION "C" IN FIGURE #20.

FOR THE SIDE WALL CORNER TRIM BOARDS, MEASURE THE DISTANCE FROM THE BOTTOM OF THE SIDING TO THE UNDER SIDE OF THE ROOF RAFTER AND SUBSTITUTE THIS LENGTH FOR DIMENSION "D" IN FIGURE #21.

INSTALL TRIM WITH 6d GALV. NAILS AT 9" O.C., STAGGERED.

APPLY EXTERIOR CAULKING AROUND ALL 1x4 TRIM BOARDS.

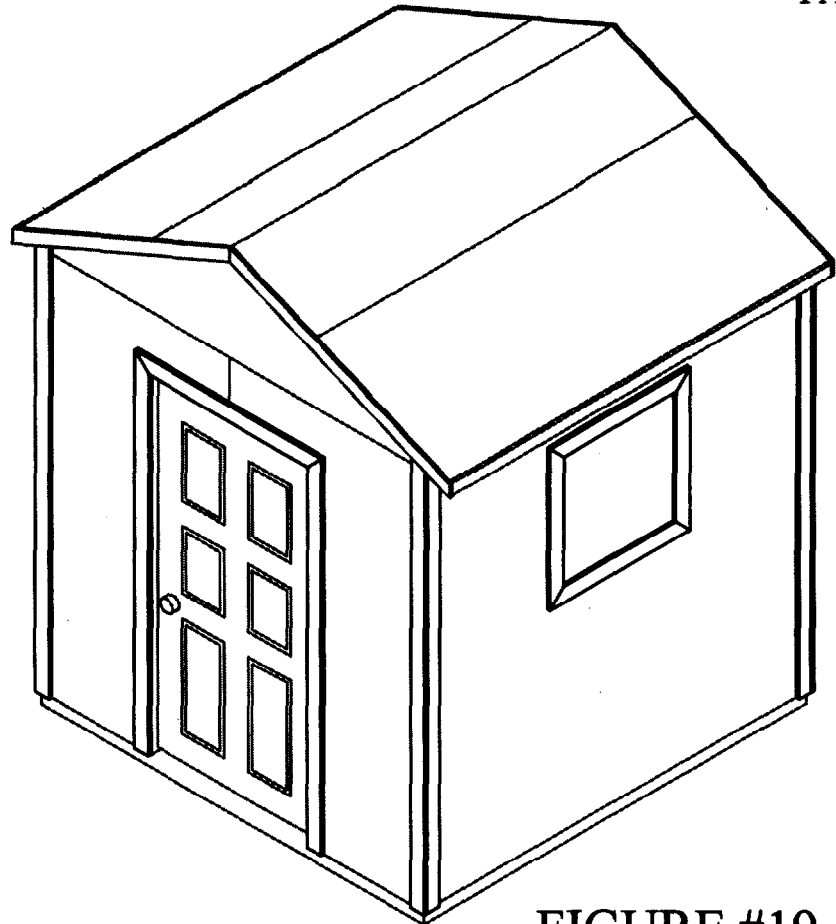

**FIGURE #19**

WALL TRIM INSTALLATION

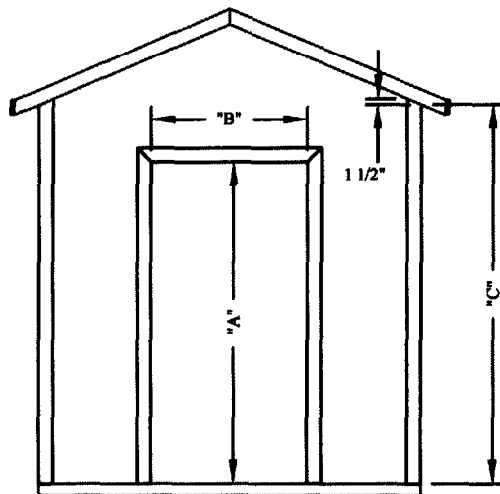

FRONT OR BACK

**FIGURE #20**

GABLE END DETAIL

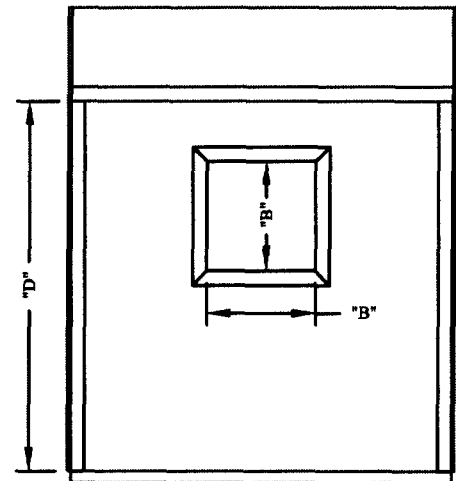

SIDES

**FIGURE #21**

SIDE DETAIL

## STEP #15

INSTALL 15# TAR PAPER ON ROOF SHEETING. INSTALL ASPHALT ROOFING. PAINT SHED AS DESIRED.

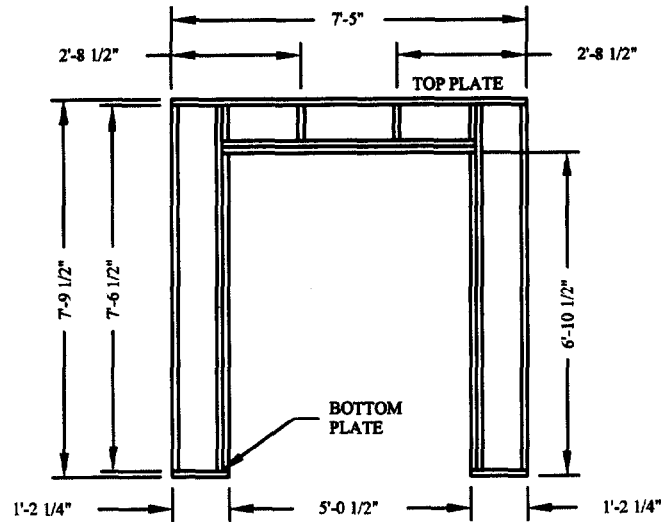

**ALTERNATE FIGURE #8A**

FRONT WALL INSTALLATION WITH DOUBLE DOOR

**STEP #14**

IF YOU CHOOSE TO MAKE YOUR OWN DOOR (LOOKS MORE LIKE A BARN DOOR), MAKE THE DOOR AS SHOWN IN FIGURE TO RIGHT IF YOU CHOSE A SINGLE 36" DOOR. THE BEST WAY TO GET ALL THE ANGLE CUTS JUST RIGHT IS TO LAY THE BOARD OVER THE DOOR AND MARK THE ANGLES.

MAKE THE DOUBLE DOORS AS SHOWN IN FIGURE TO RIGHT IF YOU CHOSE DOUBLE 30" DOORS. INSTALL A 1x2 STRIP ON ONE DOOR, OVER HANG THIS STRIP 3/4" OVER ONE LONG END OF ONE DOOR. INSTALL DOORS WITH PURCHASED HINGES AND HARDWARE ACCORDING TO MANUFACTURERS INSTRUCTIONS.

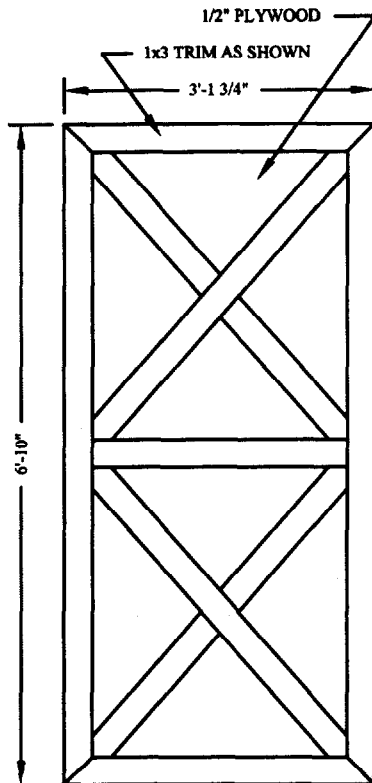

**SINGLE DOOR**

SINGLE 36" HOMEMADE DOOR

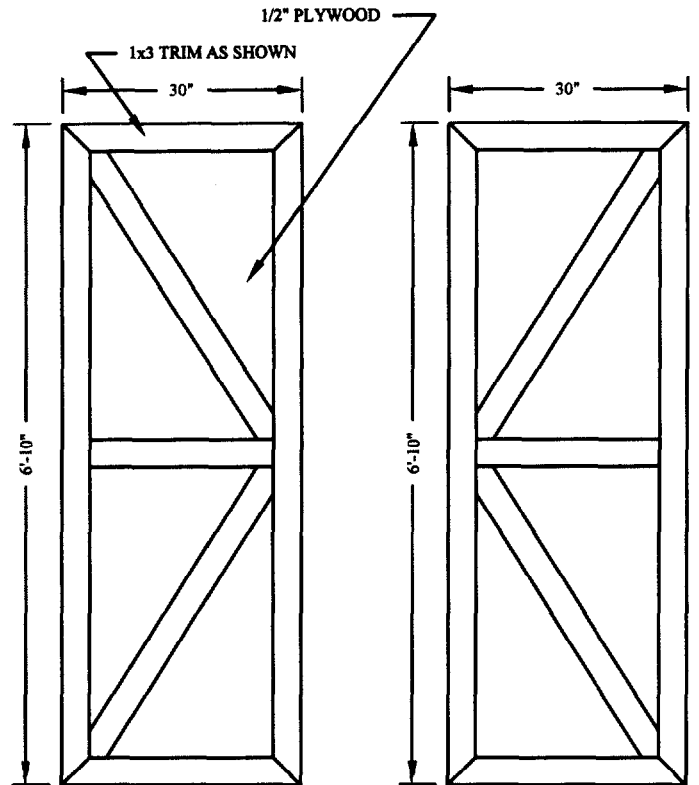

**DOUBLE DOOR**

DOUBLE 30" HOMEMADE DOORS

## STEP #1

PREPARE LOCATION FOR STORAGE SHED. THIS SHED MEASURES 8' BY 12'. ENSURE FINAL LOCATION IS LEVEL BEFORE BEGINNING. FRAME THE FLOOR SYSTEM ON THE CHOSEN FINAL LOCATION OF THE SHED WITH PRESSURE TREATED LUMBER AS SHOWN IN FIGURE #2 TO THE RIGHT. TOE-NAIL ALL CONNECTIONS, THE SHEETING WILL AID IN HOLDING THE FLOOR TOGETHER.

## STEP #2

INSTALL SHEETING ON FRAMED FLOOR AS SHOWN IN THE ISOMETRIC SKETCH IN FIGURE #3 BELOW. USE 3/4" THICK MINIMUM PLYWOOD (OR EQUAL) FOR FLOOR SHEETING. NAIL WITH 8d COMMON NAILS AT 6" O.C. AROUND PERIMETER OF EACH SHEET AND 12" O.C. AT INTERIOR OF EACH SHEET. CAREFUL TO MATCH SHEET ORIENTATION SHOWN IN FIGURE #3. HIDDEN LINES IN SKETCH DEPICT FRAMING BENEATH PLYWOOD SHEETING.

## STEP #3

FRAME LEFT AND RIGHT WALL PANELS AS SHOWN IN FIGURES #4 AND #5 BELOW. FIGURE #4 SHOWS THE OPTIONAL 2'x2' WINDOW IF DESIRED. IF NO WINDOW IS DESIRED, USE FIGURE #5. FRAME WALLS ON FLAT SURFACE (PREFERABLY PAVEMENT OR CONCRETE). NAIL THROUGH TOP AND BOTTOM PLATES INTO END OF STUDS, TWO NAILS PER EACH END OF EACH STUD. ALL FULL WALL STUDS FOR THIS SHED WILL BE 7'-6 1/2" TO ENSURE FULL 4x8 SHEETS OF PLYWOOD CAN BE USED FOR SIDING.

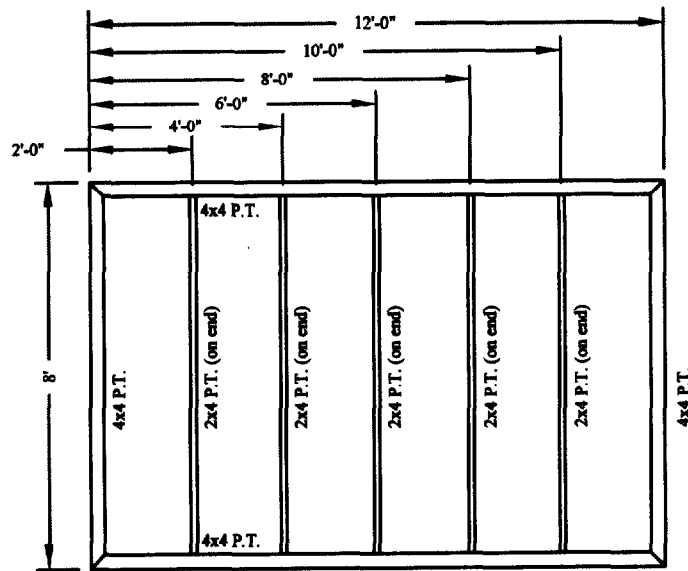

**FIGURE #2**

FLOOR FRAMING

PAGE 2

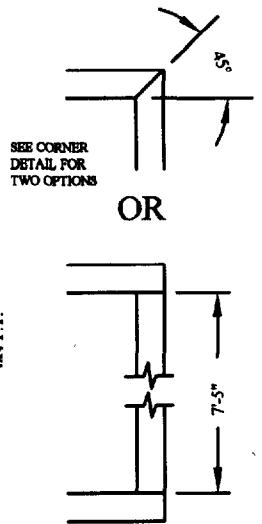

CORNER OPTIONS

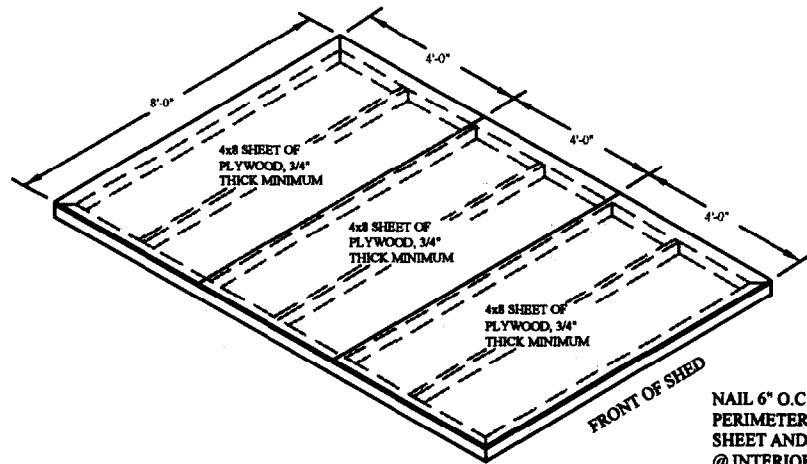
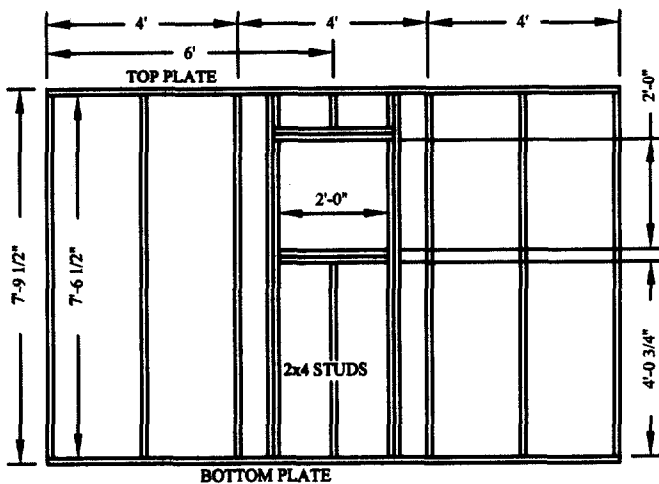

**FIGURE #3**

FLOOR SHEETING - ISO.

NAIL 6" O.C. AROUND PERIMETER OF EACH SHEET AND 12" O.C. @ INTERIOR OF SHEETS

WINDOW NOTE: CHECK ROUGH OPENING REQUIREMENT FOR THE WINDOW PURCHASED, SOME MANUFACTURERS MAY VARY.



**FIGURE #4**

LEFT/RIGHT WALL FRAMING  
WITH 2' x 2' WINDOW OPTION

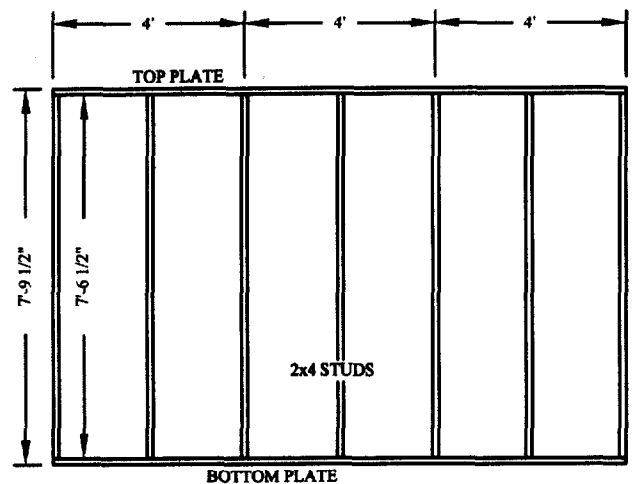
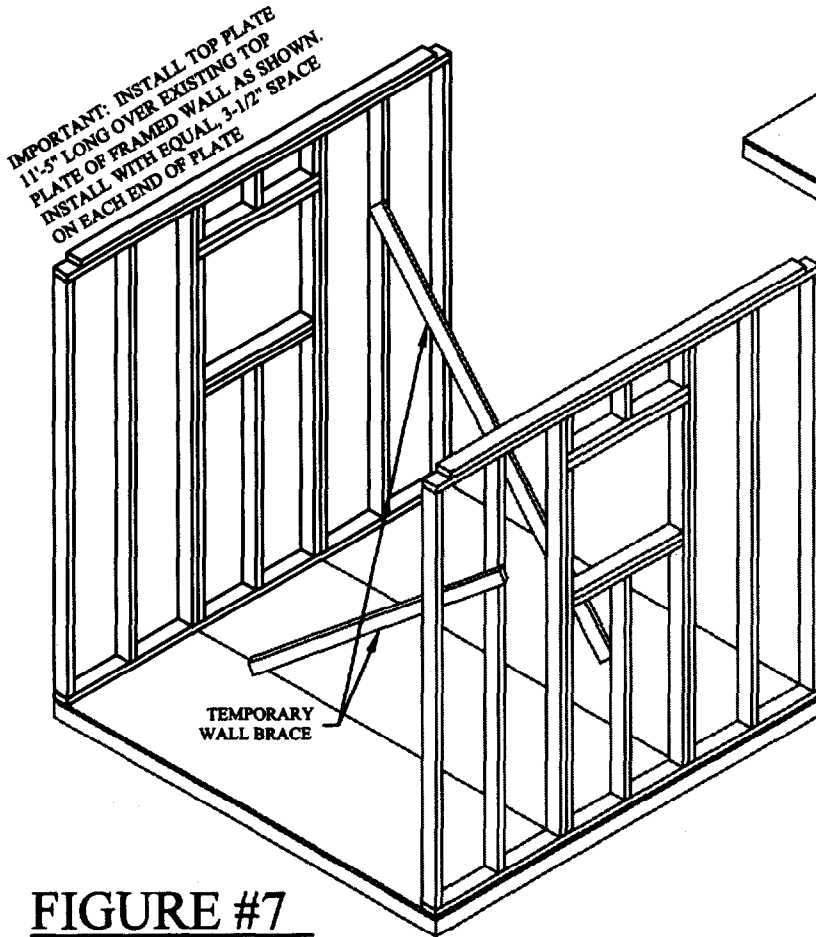

**FIGURE #5**

LEFT/RIGHT WALL FRAMING  
WITHOUT WINDOW OPTION

TO FRAME THE DOOR ON A SIDE WALL SEE PAGE 10, "ALTERNATE FIGURE 4A" FRAMING DETAILS.

BEFORE INSTALLING FRAMED LEFT AND RIGHT WALLS, INSTALL SECOND TOP PLATES ON TOP OF FRAMED SIDE WALLS AS NOTED IN FIGURES #6 AND #7 WITH EQUAL (3-1/2") SPACES ON EACH END. INSTALL FRAMED LEFT AND RIGHT WALL PANELS (UN-SHEETED) AS SHOWN IN FIGURES #6 AND #7. STAND WALLS UP SUCH THAT BOTH ENDS ARE FLUSH WITH FLOOR PANEL AND OUTSIDE IS ALSO FLUSH WITH FLOOR PANEL. NAIL THROUGH BOTTOM PLATES INTO FLOOR PANEL WITH 8d COMMON NAILS, 6" ON CENTER, STAGGERED. USE LEVEL TO ENSURE WALLS ARE PLUMB. USE A SPARE 2x4 NAILED TO A STUD AND NAILED TO THE SHED FLOOR TO BRACE WALL UNTIL FRONT AND BACK WALLS ARE INSTALLED.



**FIGURE #7**

LEFT WALL INSTALLATION

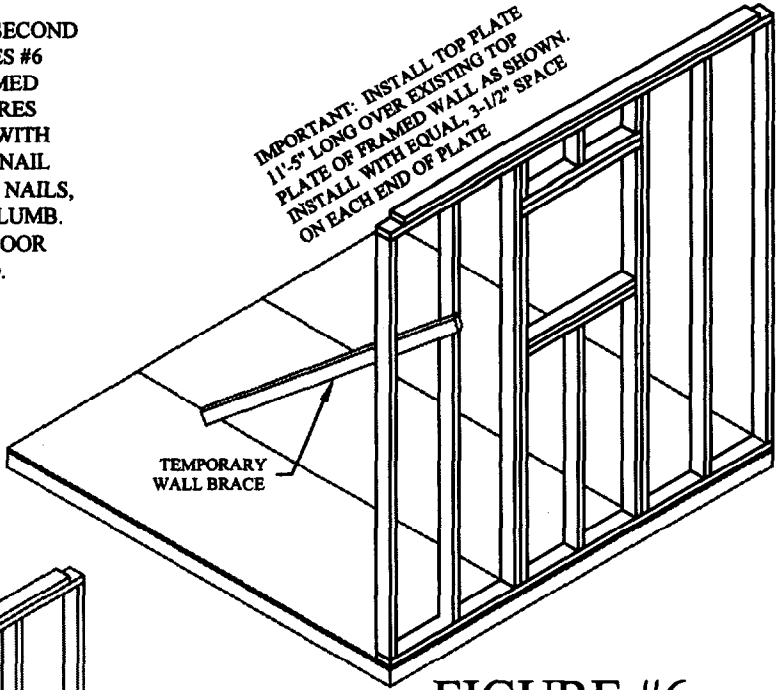

**FIGURE #6**

RIGHT WALL INSTALLATION

**STEP #5**

FRAME FRONT AND BACK WALL PANELS AS SHOWN IN FIGURES #8 AND #9 BELOW. FRAME WALLS ON FLAT SURFACE (PREFERABLY PAVEMENT OR CONCRETE). NAIL THROUGH TOP AND BOTTOM PLATES INTO END OF STUDS, TWO NAILS (8d) PER EACH END OF EACH STUD. ALL FULL WALL STUDS FOR THIS SHED WILL BE 7'-6 1/2" TO ENSURE FULL 4x8 SHEETS OF PLYWOOD CAN BE USED FOR SIDING.

**NOTE:**

IF YOU WILL BE INSTALLING A DOUBLE HOME MADE DOOR, SEE FINAL PAGE FOR ALTERNATE FIGURE #8A FOR FRONT WALL PANEL FABRICATION WITH LARGER DOOR OPENING.

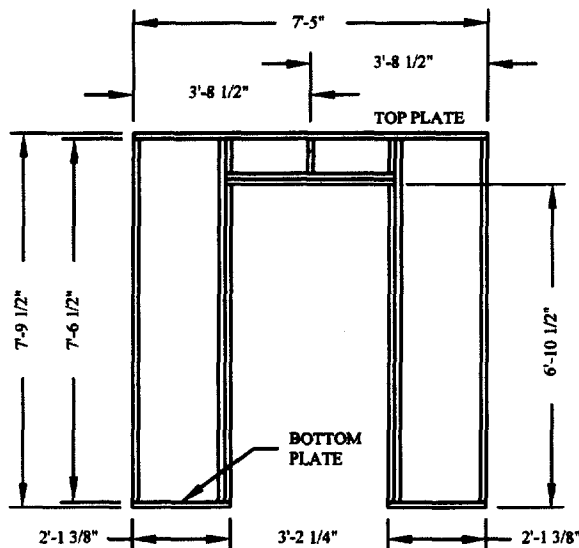

**FIGURE #8**

FRONT WALL INSTALLATION

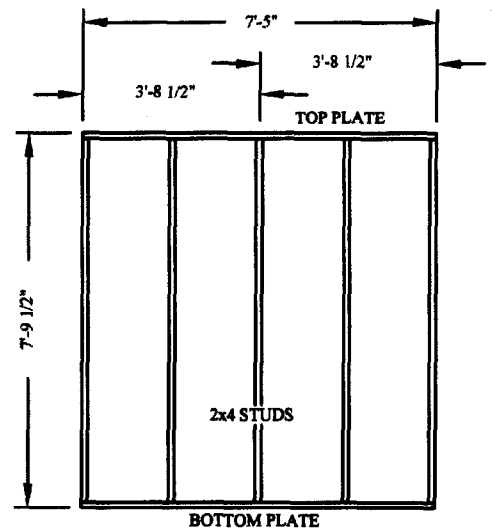
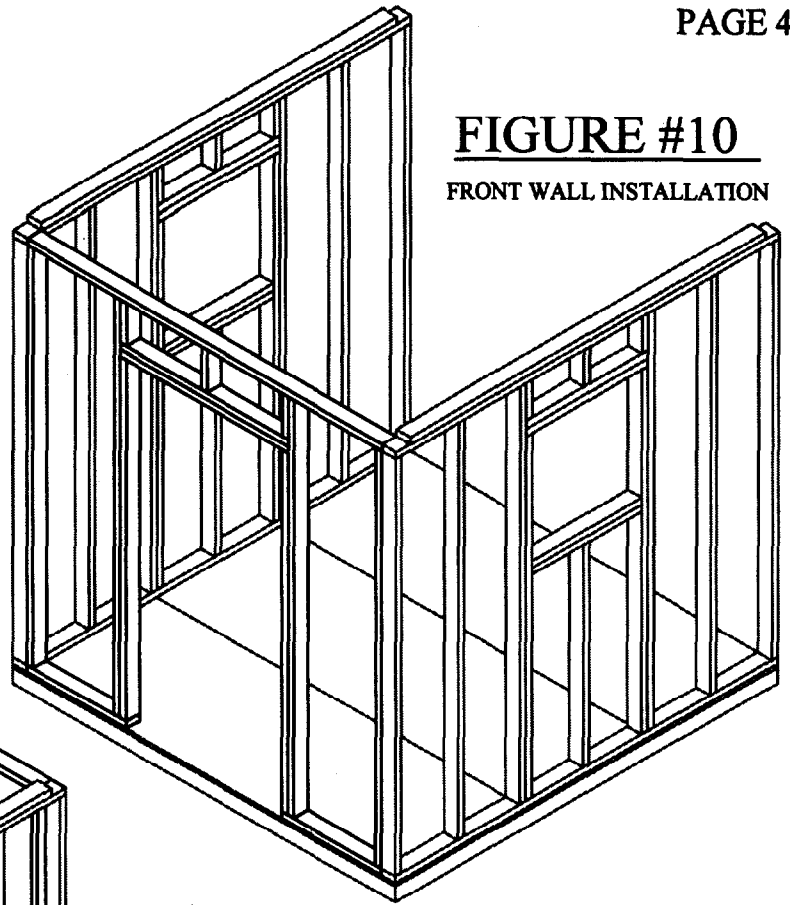

**FIGURE #9**

BACK WALL INSTALLATION

**STEP #6**

INSTALL FRAMED FRONT AND BACK WALL PANELS (UN-SHEETED) AS SHOWN IN FIGURES #10 AND #11. STAND WALLS UP SUCH THAT OUTSIDE IS FLUSH WITH FLOOR PANEL. NAIL THROUGH BOTTOM PLATE INTO FLOOR PANEL WITH 8d COMMON NAILS, 6" ON CENTER, STAGGERED. USE LEVEL TO ENSURE WALLS ARE PLUMB. NAIL THROUGH OUTSIDE STUDS ON FRONT AND BACK WALL PANELS INTO OUTSIDE STUDS OF LEFT AND RIGHT WALL PANELS @ 6" ON CENTER. TEMPORARY BRACES FOR LEFT AND RIGHT WALL PANELS CAN NOW BE REMOVED.



**FIGURE #10**  
FRONT WALL INSTALLATION

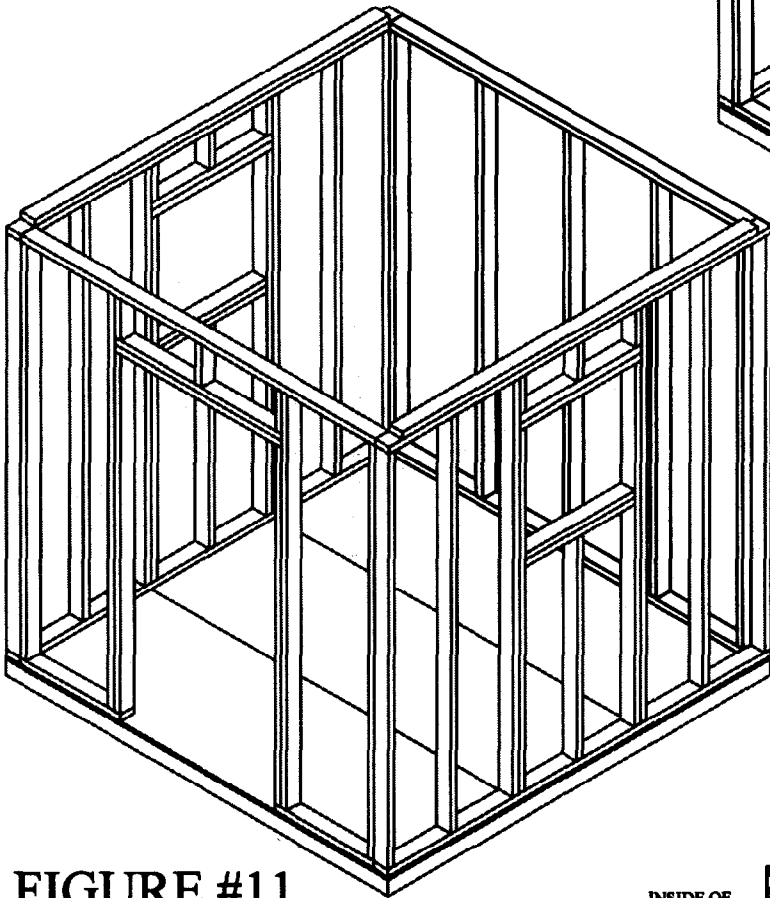

**FIGURE #11**  
BACK WALL INSTALLATION

**STEP #7**

FRAME TWO END TRUSSES AS SHOWN IN FIGURE #12. CUT TOP CORD ACCORDING TO FIGURE #12a. BOTTOM CORD OF TRUSS TO BE 8'-0" LONG AND SITTING ON EDGE AS SHOWN IN SECTION VIEW. MIDDLE VERTICAL MEMBER TO BE 19-7/16" LONG. ASSEMBLE TRUSS ON FLAT SURFACE, TOE-NAILING JOINTS FOR TEMPORARY SUPPORT. CUT SIDING (THIS WILL BE THE FINAL EXTERIOR SIDING ABOVE THE DOOR AND ON BACK OF THE SHED) AS SHOWN IN FIGURE #12b, TWO TRUSSES REQUIRED. TURN TRUSSES OVER AND INSTALL SIDING ON FLAT SURFACE OF TRUSSES. NAIL WITH 6d COMMON NAILS AT 12" ON CENTER.

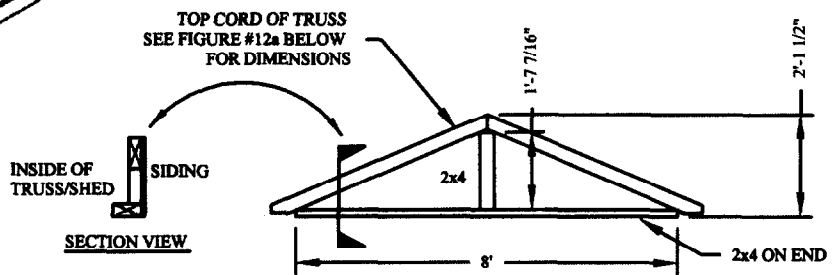

**FIGURE #12**

OUTSIDE TRUSS FRAMING - (2) REQUIRED

USE THE ASSEMBLED TRUSS IN FIGURE #12 AS A GUIDE FOR CUTTING SIDING SHOWN BELOW. THE DIMENSIONS SHOWN BELOW SHOULD BE VERIFIED.

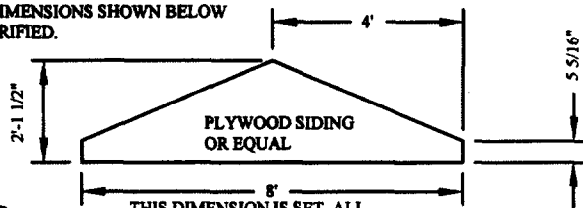

**FIGURE #12b**  
TRUSS SHEETING CUT DETAIL

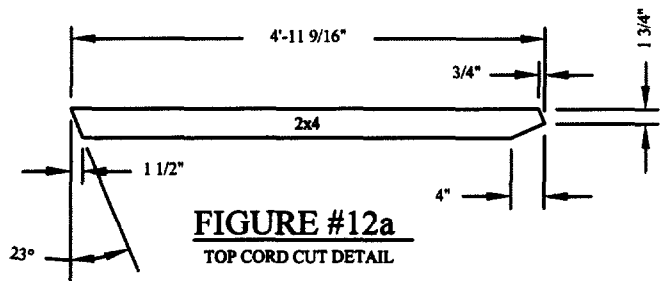

**FIGURE #12a**  
TOP CORD CUT DETAIL

NOTE: IF GROOVED SIDING (T-111 or equal) IS USED, THIS PIECE MUST BE INSTALLED IN (2) PIECES SUCH THAT THE GROOVES WILL MATCH WALLS



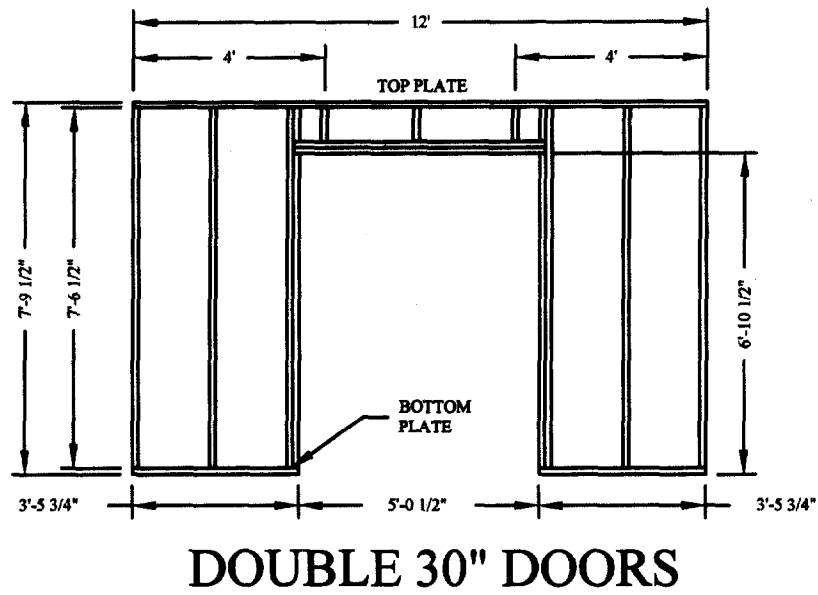
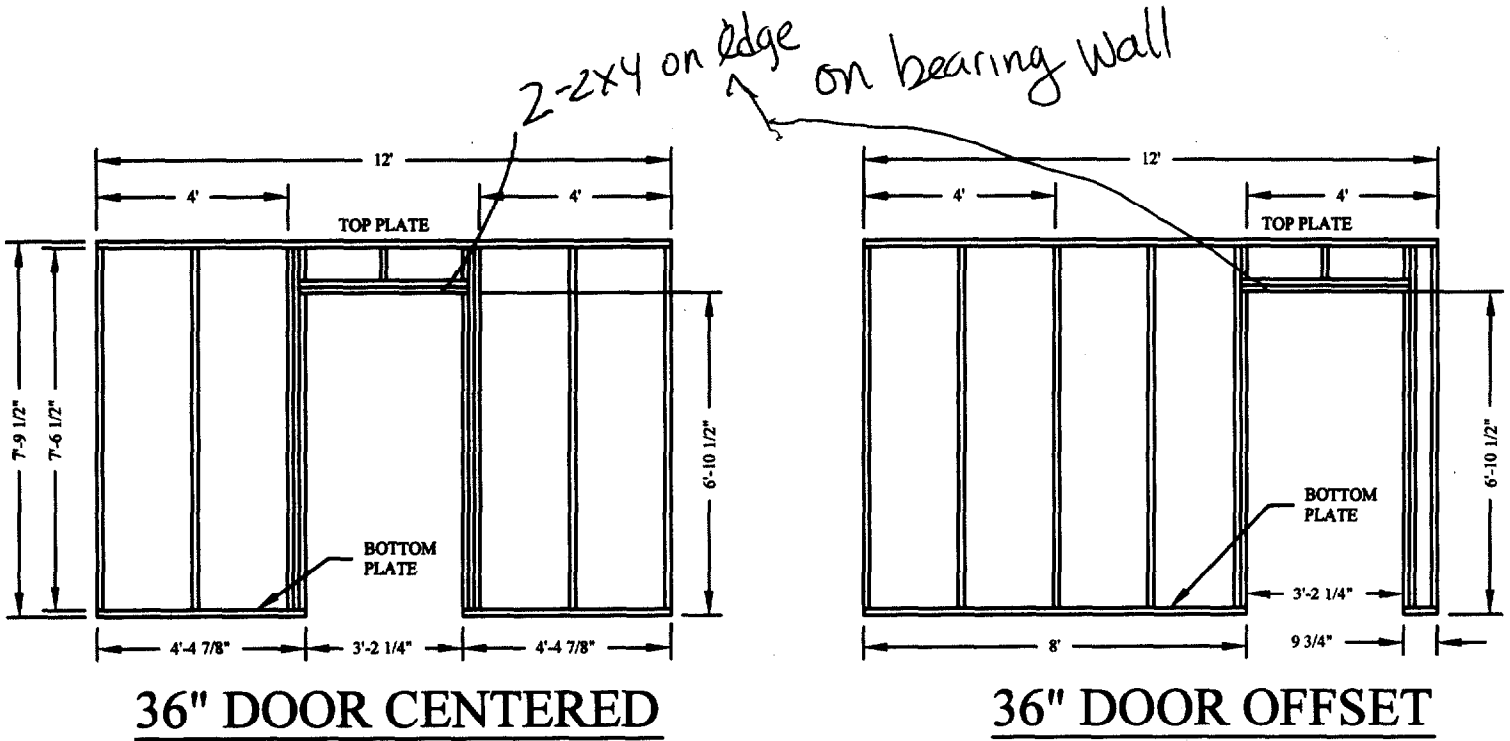

ALTERNATE FIGURE #4A

SIDE WALL DOOR FRAMING DETAILS



# Certificate of Occupancy

LOCATION 57-59 Mitton St

Issued to Ward Graffam

Date of Issue October 5, 1998

This is to certify that the building, premises, or part thereof, at the above location, built — altered — changed as to use under Building Permit No. 9701276 has had final inspection, has been found to conform substantially to requirements of Zoning Ordinance and Building Code of the City, and is hereby approved for occupancy or use, limited or otherwise, as indicated below.

PORION OF BUILDING OR PREMISES

APPROVED OCCUPANCY

Entire

Duplex

Limiting Conditions:

None

This certificate supersedes certificate issued

Approved:

10/6/98 *Mark Seay*  
.....  
(Date) Inspector

*G. Samuel [Signature]*  
.....  
Inspector of Buildings

Notice: This certificate identifies lawful use of building or premises, and ought to be transferred from owner to owner when property changes hands. Copy will be furnished to owner or lessee for one dollar.

DISPLAY THIS CARD ON PRINCIPAL FRONTAGE OF WORK

# CITY OF PORTLAND

## BUILDING INSPECTION

PERMIT ISSUED

Permit Number: 031192

SEP 30 2003

# PERMIT

Please Read Application And Notes, if Any, Attached

This is to certify that Turgeon Eric M & /self  
has permission to Build an 8x12 wood frame s  
AT 57 Mitton St 191 B049001

CITY OF PORTLAND

provided that the person or persons, firm or corporation accepting this permit shall comply with all of the provisions of the Statutes of Maine and of the Ordinances of the City of Portland regulating the construction, maintenance and use of buildings and structures, and of the application on file in this department.

Apply to Public Works for street line and grade if nature of work requires such information.

Notification of inspection must be given and written permission procured before this building or part thereof is occupied or otherwise used-in. HOUR NOTICES REQUIRED.

A certificate of occupancy must be procured by owner before this building or part thereof is occupied.

### OTHER REQUIRED APPROVALS

Fire Dept. \_\_\_\_\_  
Health Dept. \_\_\_\_\_  
Appeal Board \_\_\_\_\_  
Other \_\_\_\_\_  
Department Name

*Jarvis Bonke* 9/30/03  
Director - Building & Inspection Services

**PENALTY FOR REMOVING THIS CARD**

# BUILDING PERMIT INSPECTION PROCEDURES

Please call 874-8703 or ~~874-8693~~ to schedule your inspections as agreed upon

Permits expire in 6 months, if the project is not started or ceases for 6 months.

The Owner or their designee is required to notify the inspections office for the following inspections and provide adequate notice. Notice must be called in 48-72 hours in advance in order to schedule an inspection:

By initialzing at each inspection time, you are agreeing that you understand the inspection procedure and additional fees from a "Stop Work Order" and "Stop Work Order Release" will be incurred if the procedure is not followed as stated below.

DB ~~Pre-construction Meeting: Must be scheduled with your inspection team upon receipt of this permit. Jay Reynolds, Development Review Coordinator at 874-8693 must also be contacted at this time, before any site work begins on any project other than single family additions or alterations.~~

<input type="checkbox"/>	Footing/Building Location Inspection:	Prior to pouring concrete
<input type="checkbox"/>	Re-Bar Schedule Inspection:	Prior to pouring concrete
<input type="checkbox"/>	Foundation Inspection:	Prior to placing ANY backfill
<input type="checkbox"/>	Framing/Rough Plumbing/Electrical:	Prior to any insulating or drywalling
<input checked="" type="checkbox"/>	Final/Certificate of Occupancy:	Prior to any occupancy of the structure or use. NOTE: <del>There is a \$75.00 fee per inspection at this point.</del>

setbacks

Certificate of Occupancy is not required for certain projects. Your inspector can advise you if your project requires a Certificate of Occupancy. All projects DO require a final inspection

If any of the inspections do not occur, the project cannot go on to the next phase, REGARDLESS OF THE NOTICE OR CIRCUMSTANCES.

NA **CERIFICATE OF OCCUPANICES MUST BE ISSUED AND PAID FOR, BEFORE THE SPACE MAY BE OCCUPIED**

[Signature]  
Signature of applicant/designee

Date

[Signature]  
Signature of Inspections Official

Date

CBL: 191-B-49

Building Permit #:

03-1192