

GRADING AND DRAINAGE NOTES:

1. COMPACTION REQUIREMENTS
BELOW PAVED OR CONCRETE AREAS 95%
TRENCH BEDDING MATERIAL AND SAND BLANKET BACKFILL 95%
BELOW LOAM AND SEED AREAS 90%
*ALL PERCENTAGES OF COMPACTION SHALL BE OF THE MAXIMUM DRY DENSITY AT THE OPTIMUM MOISTURE CONTENT AS DETERMINED AND CONTROLLED IN ACCORDANCE WITH ASTM D-1557; METHOD C FIELD DENSITY TESTS SHALL BE MADE IN ACCORDANCE WITH ASTM D-1556 OR ASTM-2922.
2. ALL STORM DRAINAGE PIPES SHALL BE HIGH DENSITY POLYETHYLENE (HANCOR HI-Q, ADS N-12 OR APPROVED EQUAL) UNLESS OTHERWISE SPECIFIED.
3. SEE UTILITIES PLAN FOR ALL SITE UTILITY INFORMATION.
4. ADJUST ALL MANHOLES, CATCHBASINS, CURB BOXES, ETC. WITHIN LIMITS OF WORK TO FINISH GRADE.
5. COORDINATE WORK ADJACENT TO PROPOSED BUILDINGS WITH BUILDING CONTRACTOR.
6. ALL DRAIN PIPES WITH LESS THAN 4' OF COVER SHALL BE INSULATED.
7. CONTRACTOR SHALL PROVIDE A FINISH PAVEMENT SURFACE AND LAWN AREAS FREE OF LOW SPOTS AND PONDING AREAS. CRITICAL AREAS INCLUDE BUILDING ENTRANCES, EXITS, RAMPS AND LOADING DOCK AREAS ADJACENT TO THE BUILDING.
8. CONTRACTOR SHALL THOROUGHLY CLEAN ALL CATCHBASINS AND DRAIN LINES, WITHIN THE LIMIT OF WORK, OF SEDIMENT IMMEDIATELY UPON COMPLETION OF CONSTRUCTION.
9. ALL MATERIALS AND CONSTRUCTION SHALL CONFORM WITH APPLICABLE FEDERAL, STATE AND LOCAL CODES.
10. ALL DISTURBED AREAS NOT TO BE PAVED OR OTHERWISE TREATED SHALL RECEIVE 4" LOAM, SEED FERTILIZER AND MULCH.
11. ALL STORM DRAIN CONSTRUCTION SHALL BE IN ACCORDANCE WITH THE MEDOT. STANDARD SPECIFICATIONS FOR HIGHWAYS AND BRIDGES, LATEST EDITION.
12. ALL PROPOSED CATCHBASINS SHALL BE EQUIPPED WITH OIL/GAS SEPARATOR HOODS AND 4" SUMPS.
13. ALL MATERIALS AND CONSTRUCTION SHALL CONFORM WITH APPLICABLE FEDERAL, STATE AND CITY OF PORTLAND DEPARTMENT OF PUBLIC WORKS AND CONSTRUCTION SPECIFICATIONS, LATEST REVISIONS.
14. CONTRACTOR TO SUBMIT AS-BUILT PLANS ON REPRODUCIBLE MYLARS AND IN DIGITAL FORMAT (.DWG FILE) ON DISK TO THE OWNER AND ARCHITECT UPON COMPLETION OF THE PROJECT. AS-BUILTS SHALL BE PREPARED AND CERTIFIED BY A LICENSED LAND SURVEYOR OR PROFESSIONAL ENGINEER.
15. SEE EXISTING CONDITIONS PLAN FOR BENCH MARK INFORMATION.
16. CDS UNIT MODEL NUMBER TO BE VERIFIED WITH MANUFACTURER.

DRAINAGE TABLE		PROPOSED DRAINAGE TABLE	
CB #5046 RIM ELEV.=45.6' (1) IN 12" R.C.P.=39.4' (2) OUT 10" R.C.P.=39.4'	CB #6165 RIM ELEV.=44.6' (1) OUT 12" C.P.P.=41.9'	PCB4 RIM=45.8 INV.IN=41.2 INV.OUT=41.2	PCB5 RIM=45.5 INV.IN=42.85 INV.OUT=42.65
CB #5067 RIM ELEV.=45.2' (1) OUT 12" R.C.P.=39.2' (2) IN 12" R.C.P.=39.3'	CB #5227 RIM ELEV.=44.7' (1) IN 10" P.V.C.=41.1' (2) IN 12" P.V.C.=41'	PDMH1 RIM=45.9 INV.IN=41.2 INV.OUT=41.2	PCB6 RIM=46.75 INV.IN=43.3 INV.OUT=43.3
CB #5126 RIM ELEV.=46.8' (1) OUT 12" R.C.P.=41.9'	DMH #6303 RIM ELEV.=43.4' (1) IN 5" D.I.P.=41.3' (3) OUT 12" A.B.S.=40.8'	PDMH2 RIM=45.7 INV.IN=41.3 INV.OUT=41.3	PCB7 RIM=45.7 INV.IN=43.05 INV.OUT=43.05
CB #5201 RIM ELEV.=46.1' (1) IN 12" R.C.P.=40' INV.IN=40.0 (2) OUT 12" R.C.P.=40'	DMH "A" RIM ELEV.=43.8' (1) IN 12" A.B.S.=39.9' (2) IN 12" D.I.P.=39.8' (3) OUT 12" R.C.P.=39.6'	PDMH3 RIM=44.8 INV.IN=40.4 (1) IN 6" C.M.P.=40.4 (2) OUT 12")=40.2	PCB8 RIM=46.3 INV.IN=42.65 INV.OUT=42.65
CB #5214 RIM ELEV.=44.4' (1) IN 12" R.C.P.=39' (2) OUT 12" R.C.P.=38.8'	DMH "A" RIM ELEV.=43.8' (1) IN 12" A.B.S.=39.9' (2) IN 12" D.I.P.=39.8' (3) OUT 12" R.C.P.=39.6'	PDMH4 RIM=44.7 INV.IN=40.4 INV.OUT=40.4	PCB9 RIM=46.3 INV.IN=42.95 INV.OUT=42.95
CB #5269 RIM ELEV.=43.6' (1) IN 12" R.C.P.=38.4' (2) IN 12" R.C.P.=39.1' (3) IN 15" R.C.P.=38.5' (4) IN 6" C.M.P.=38.4' INV.IN=40.0 (5) OUT 15" R.C.P.=38.2'	DMH "A" RIM ELEV.=43.8' (1) IN 12" A.B.S.=39.9' (2) IN 12" D.I.P.=39.8' (3) OUT 12" R.C.P.=39.6'	PDMH5 RIM=44.7 INV.IN=40.4 INV.OUT=40.4	PCB10 RIM=46.9 INV.IN=42.55 INV.OUT=42.55
CB #5305 RIM ELEV.=45.8' (1) OUT 12" R.C.P.=39.6'	DMH "A" RIM ELEV.=43.8' (1) IN 12" A.B.S.=39.9' (2) IN 12" D.I.P.=39.8' (3) OUT 12" R.C.P.=39.6'	PDMH6 RIM=44.7 INV.IN=40.4 INV.OUT=40.4	PCB11 RIM=46.2 INV.IN=42.05 INV.OUT=42.05
CB #5432 RIM ELEV.=43.1' (1) OUT 12" R.C.P.=39.8' (2) IN 10" C.P.P.=40' INV.IN=40.0 (3) IN 12" P.V.C.=39.8'	DMH "A" RIM ELEV.=43.8' (1) IN 12" A.B.S.=39.9' (2) IN 12" D.I.P.=39.8' (3) OUT 12" R.C.P.=39.6'	PDMH7 RIM=44.7 INV.IN=40.4 INV.OUT=40.4	PCB12 RIM=46.2 INV.IN=42.25 INV.OUT=42.25
CB #5433 RIM ELEV.=42.9' (1) IN 12" R.C.P.=39.4' (2) IN 6" C.M.P.=39.2' (3) OUT 15" R.C.P.=39.3'	DMH "A" RIM ELEV.=43.8' (1) IN 12" A.B.S.=39.9' (2) IN 12" D.I.P.=39.8' (3) OUT 12" R.C.P.=39.6'	PDMH8 RIM=44.7 INV.IN=40.4 INV.OUT=40.4	PCB13 RIM=45.3 INV.IN=40.1 INV.OUT=40.1
	DMH "A" RIM ELEV.=43.8' (1) IN 12" A.B.S.=39.9' (2) IN 12" D.I.P.=39.8' (3) OUT 12" R.C.P.=39.6'	PDMH9 RIM=44.7 INV.IN=40.4 INV.OUT=40.4	PCB14 RIM=46.2 INV.IN=40.5 INV.OUT=40.5
	DMH "A" RIM ELEV.=43.8' (1) IN 12" A.B.S.=39.9' (2) IN 12" D.I.P.=39.8' (3) OUT 12" R.C.P.=39.6'	PDMH10 RIM=44.7 INV.IN=40.4 INV.OUT=40.4	PCB15 RIM=44.3 INV.IN=42.75 INV.OUT=42.75
	DMH "A" RIM ELEV.=43.8' (1) IN 12" A.B.S.=39.9' (2) IN 12" D.I.P.=39.8' (3) OUT 12" R.C.P.=39.6'	PDMH11 RIM=44.7 INV.IN=40.4 INV.OUT=40.4	PCB16 RIM=44.3 INV.IN=42.75 INV.OUT=42.75

EROSION CONTROL NOTES:

1. INSTALL EROSION CONTROL BARRIERS AS SHOWN AS FIRST ORDER OF WORK.
2. SEE GENERAL EROSION CONTROL NOTES ON DETAIL SHEETS.
3. PROVIDE INLET PROTECTION AROUND ALL EXISTING AND PROPOSED CATCHBASIN INLETS WITHIN THE WORK LIMITS. MAINTAIN FOR THE DURATION OF THE PROJECT UNTIL PAVEMENT HAS BEEN INSTALLED.
4. INSTALL STABILIZED CONSTRUCTION ENTRANCES.
5. INSPECT INLET PROTECTION AND SILT FENCES AFTER EACH RAIN STORM OF 0.5 INCH OR GREATER. REPAIR/MODIFY PROTECTION AS NECESSARY TO MAXIMIZE EFFICIENCY OF FILTER. REPLACE ALL FILTERS WHEN SEDIMENT IS 1/3 THE FILTER HEIGHT.
6. ALL DISTURBED AREAS NOT TO BE PAVED OR OTHERWISE TREATED SHALL RECEIVE 4" LOAM, SEED, FERTILIZER AND MULCH.
7. CONSTRUCT EXCELSIOR MAT ON ALL SLOPES STEEPER THAN 3:1.
8. PRIOR TO ANY WORK OR SOIL DISTURBANCE COMMENCING ON THE SUBJECT PROPERTY, INCLUDING MOVING OF EARTH, THE APPLICANT SHALL INSTALL ALL EROSION AND SILTATION MITIGATION AND CONTROL MEASURES AS REQUIRED BY STATE AND LOCAL PERMITS AND APPROVALS.
9. CONTRACTOR SHALL BE RESPONSIBLE TO CONTROL DUST AND WIND EROSION THROUGHOUT THE CONSTRUCTION PERIOD. DUST CONTROL MEASURES SHALL INCLUDE, BUT NOT LIMITED TO, SPRINKLING WATER ON UNSTABLE SOILS SUBJECT TO ARID CONDITIONS.
10. THE CONTRACTOR SHALL REMOVE AND PROPERLY DISPOSE OF ALL TEMPORARY EROSION CONTROL DEVICES UPON COMPLETION OF CONSTRUCTION.
11. ALL CATCHBASIN SUMPS AND PIPING SHALL BE THOROUGHLY CLEANED TO REMOVE ALL SEDIMENT AND DEBRIS AFTER THE PROJECT HAS BEEN PAVED.
12. TEMPORARY SOIL STOCKPILE SHALL BE SURROUNDED BY SILT FENCE AND SHALL BE STABILIZED BY TEMPORARY EROSION CONTROL SEEDING. STOCKPILE AREAS TO BE LOCATED AS FAR AS POSSIBLE FROM THE DELINEATED EDGE OF WETLAND.

LEGEND

	PROPERTY LINE
	EDGE OF WETLAND
	EXISTING TREE LINE
	PROPOSED TREE LINE
	EXISTING FENCE
	PROPOSED FENCE
	EXISTING CONTOUR
	EXISTING 10' CONTOUR
	FINISHED GRADE
	EXISTING DRAINAGE
	PROPOSED DRAINAGE
	EXISTING CONCRETE/BITUMINOUS SIDEWALK
	PROPOSED CONCRETE SIDEWALK
	PROPOSED CONCRETE PAD
	PROPOSED BOLLARD
	PROPOSED INLET PROTECTION
	PROPOSED SILTFENCE
	STABILIZED CONSTRUCTION ENTRANCE
	FLARED END SECTION
	EDGE OF WETLAND

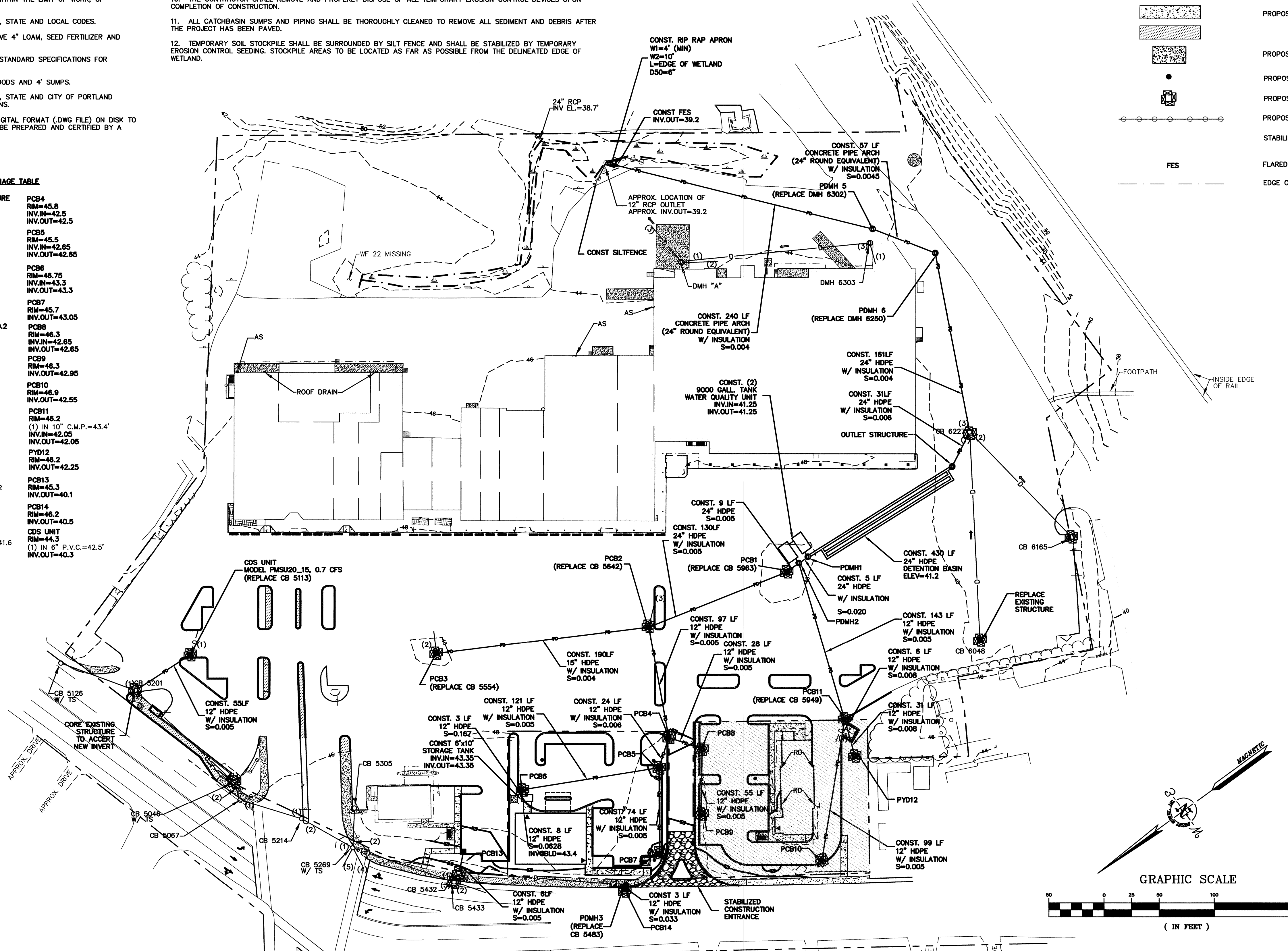

REV	Description	Date
1	ISSUED FOR APPROVAL	7/8/08
2	REVISED PER STAFF COMMENTS	5/15/08
3	REVISED PER STAFF COMMENTS	4/30/08
4	REVISED PER STAFF COMMENTS	4/28/08
5	REVISED PER PRELIMINARY COMMENTS	4/17/08

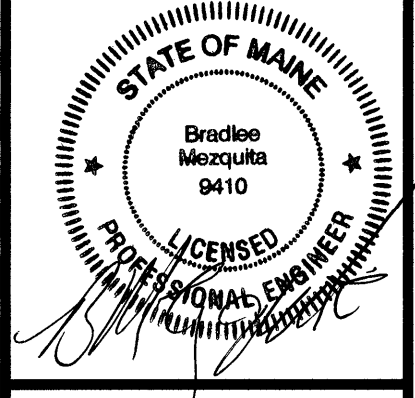

DATE: MARCH 3, 2008
 SCALE: AS SHOWN
 DESIGNED BY: GY/BLM
 DRAWN BY: SAM
 APPROVED BY: BLM
 PROJECT NO.: 2256
 FILE NO.: 2256-SITE.dwg

**WESTGATE PLAZA
 CONGRESS STREET
 PORTLAND, MAINE**

Appledore Engineering Inc.
 Pease International Tradeport
 15 Rye Street, Suite 305
 Portsmouth, New Hampshire 03801
 (603) 433-8818
 ae@appledoreeng.com

OVERALL GRADING, DRAINAGE & EROSION CONTROL PLAN