

DRAINAGE TABLE

CB #5046
 RIM ELEV.=45.6'
 (1) IN 12" R.C.P.=39.4'
 (2) OUT 10" R.C.P.=39.4'

CB #5067
 RIM ELEV.=45.2'
 (1) OUT 12" R.C.P.=39.2'
 (2) IN 12" R.C.P.=39.3'

CB #5126
 RIM ELEV.=46.8'
 (1) OUT 12" R.C.P.=41.9'

CB #5201
 RIM ELEV.=46.1'
 (1) IN 12" R.C.P.=40'
 INV.IN.=40.0
 (2) OUT 12" R.C.P.=40'

CB #5214
 RIM ELEV.=44.4'
 (1) IN 12" R.C.P.=39'
 (2) OUT 12" R.C.P.=38.8'

CB #5269
 RIM ELEV.=43.6'
 (1) IN 12" R.C.P.=38.4'
 (2) IN 12" R.C.P.=39.1'
 (3) IN 15" R.C.P.=38.5'
 (4) IN 6" C.M.P.=38.4'
 INV.IN.=40.0
 (5) OUT 15" R.C.P.=38.2'

CB #5305
 RIM ELEV.=45.8'
 (1) OUT 12" R.C.P.=39.6'

CB #5432
 RIM ELEV.=43.1'
 (1) OUT 12" R.C.P.=39.8'
 (2) IN 10" C.P.P.=40'
 INV.IN.=40.0
 (3) IN 12" P.V.C.=39.8'

CB #5433
 RIM ELEV.=42.9'
 (1) IN 12" R.C.P.=39.4'
 (2) IN 8" C.M.P.=39.2'
 (3) OUT 15" R.C.P.=39.3'

PROPOSED DRAINAGE TABLE

CB #6048
 RIM ELEV.=45.6'
 (1) OUT 10" C.P.P.=42.5'

CB #6165
 RIM ELEV.=44.6'
 (1) OUT 12" C.P.P.=41.9'

CB #6227
 RIM ELEV.=44.7'
 (1) IN 10" P.V.C.=41.1'
 (2) IN 12" P.V.C.=41'
 INV.OUT.=41.0

DMH #6303
 RIM ELEV.=43.4'
 (1) IN 6" D.I.P.=41.3'
 (3) OUT 12" A.B.S.=40.8'

DMH "A"
 RIM ELEV.=43.8'
 (1) IN 12" A.B.S.=39.9'
 (2) IN 12" D.I.P.=39.8'
 (3) OUT 12" R.C.P.=39.6'

PCB4
 RIM=45.8
 INV.IN=41.2
 INV.OUT=42.5

PCB5
 RIM=45.5
 INV.IN=42.65
 INV.OUT=42.65

PCB6
 RIM=46.75
 INV.IN=43.3
 INV.OUT=43.05

PCB7
 RIM=45.7
 INV.OUT=43.05

PCB8
 RIM=46.3
 INV.IN=42.65
 INV.OUT=42.65

PCB9
 RIM=46.3
 INV.OUT=42.95

PCB10
 RIM=46.9
 INV.OUT=42.55

PCB11
 RIM=46.2
 (1) IN 10" C.M.P.=43.4'
 INV.IN=42.05
 INV.OUT=42.05

PCB12
 RIM=46.2
 INV.OUT=42.25

PCB13
 RIM=45.3
 INV.OUT=40.1

PCB14
 RIM=46.2
 INV.OUT=40.5

CDS UNIT
 RIM=44.3
 (1) IN 6" P.V.C.=42.5'
 INV.OUT=40.3

PCB1
 RIM=45.5
 INV.IN=41.35
 INV.OUT=41.35

PCB2
 RIM=46.2
 (3) INV.IN(6")=42
 INV.IN=42.0
 INV.OUT=42.0

PCB3
 RIM=45.6
 INV.IN=42.75
 (2) INV.IN(6")=41.6
 INV.OUT=42.75

PCB15
 RIM=45.9
 INV.IN=41.2
 INV.OUT=41.2

PCB16
 RIM=45.7
 INV.IN=41.3
 INV.OUT=41.3

PCB17
 RIM=44.8
 (1) IN (6)=40.4
 INV.IN=40.4
 (2) OUT (12")=40.2

DMH4
 RIM=45.3
 INV.IN=42.5
 INV.OUT=42.5

PCB18
 RIM=43.6
 INV.IN=40.15
 INV.OUT=40.15

PCB19
 RIM=44.7
 INV.IN=40.4
 INV.OUT=40.4

PCB20
 RIM=45.5
 INV.IN=41.35
 INV.OUT=41.35

PCB21
 RIM=46.2
 (3) INV.IN(6")=42
 INV.IN=42.0
 INV.OUT=42.0

LEGEND

- PROPERTY LINE
- - - - - EXISTING TREE LINE
- - - - - PROPOSED TREE LINE
- - - - - EXISTING FENCE
- - - - - PROPOSED FENCE
- - - - - EXISTING CONTOUR
- - - - - EXISTING 10' CONTOUR
- - - - - FINISHED GRADE
- - - - - EXISTING DRAINAGE
- - - - - PROPOSED DRAINAGE
- ▭ EXISTING CONCRETE/BITUMINOUS SIDEWALK
- ▭ PROPOSED CONCRETE SIDEWALK
- ▭ PROPOSED BITUMINOUS SIDEWALK
- ▭ PROPOSED CONCRETE PAD
- PROPOSED BOLLARD
- 44.7X PROPOSED SPOT GRADE
- 44.7X EXISTING SPOT GRADE
- ▭ STABILIZED CONSTRUCTION ENTRANCE
- ▭ FINISHED FLOOR

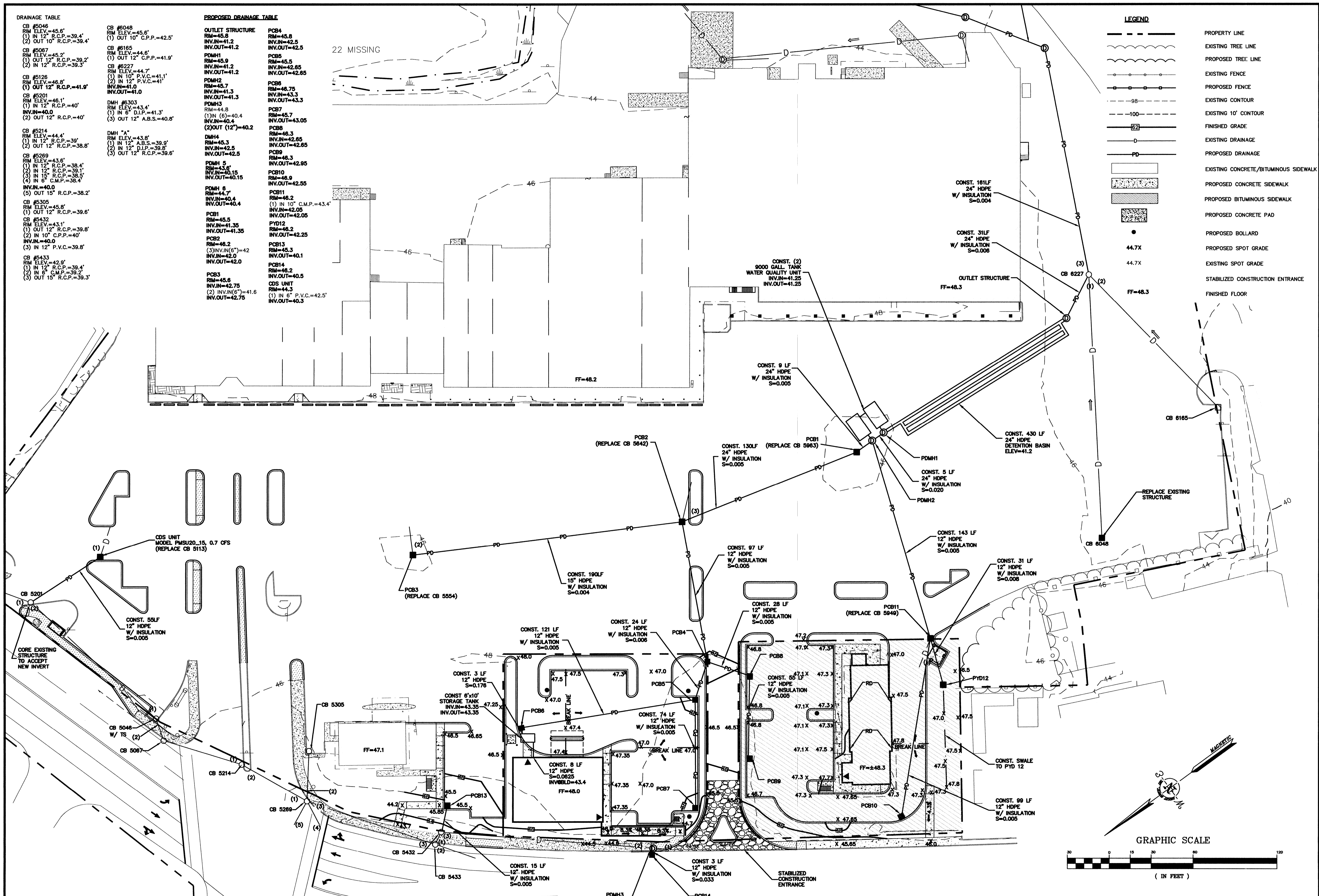

BLM	7/8/08	5/15/08	4/30/08	4/28/08	4/17/08
5	ISSUED FOR APPROVAL				
4	REVISED PER STAFF COMMENTS				
3	REVISED PER STAFF COMMENTS				
2	REVISED PER STAFF COMMENTS				
1	REVISED PER PRELIMINARY COMMENTS				

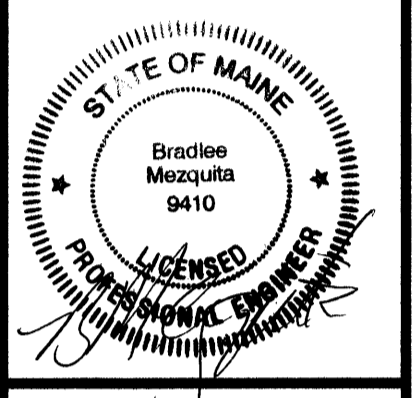

DATE: MARCH 3, 2008
 SCALE: AS SHOWN
 DESIGNED BY: CY/BLM
 DRAWN BY: SAM
 APPROVED BY: BLM
 PROJECT NO.: 2256
 FILE NO.: 2256-SITE.dwg

**WESTGATE PLAZA
 CONGRESS STREET
 PORTLAND, MAINE**

Appledore Engineering Inc.
 Professional Tradeport
 15 Rye Street, Suite 305
 Portsmouth, New Hampshire 03801
 (603) 433-8818
 ae@appledoreeng.com

GRADING, DRAINAGE & EROSION CONTROL PLAN

C-4A