

- LEGEND**
- PROPERTY LINE
 - - - ABUTTER LOT LINE
 - - - EXISTING TREE LINE
 - - - PROPOSED TREE LINE
 - - - PROPOSED FENCE
 - - - EXISTING CONTOUR
 - - - EXISTING 10' CONTOUR
 - - - FINISHED GRADE
 - - - EXISTING DRAINAGE
 - - - PROPOSED INSULATED DRAINAGE
 - - - PROPOSED UNDERDRAIN
 - - - PROPOSED CATCH BASIN
 - - - PROPOSED DRAIN MANHOLE
 - - - STABILIZED CONSTRUCTION ENTRANCE
 - - - EXISTING SPOT GRADE
 - - - PROPOSED SPOT GRADE
 - - - TOP OF WALL/BOTTOM OF WALL ELEVATION
 - - - TOP OF CURB/BOTTOM OF CURB ELEVATION
 - - - TOP STEP/BOTTOM STEP ELEVATION
 - - - PROPOSED SILT SOCK
 - - - PROPOSED NILET PROTECTION

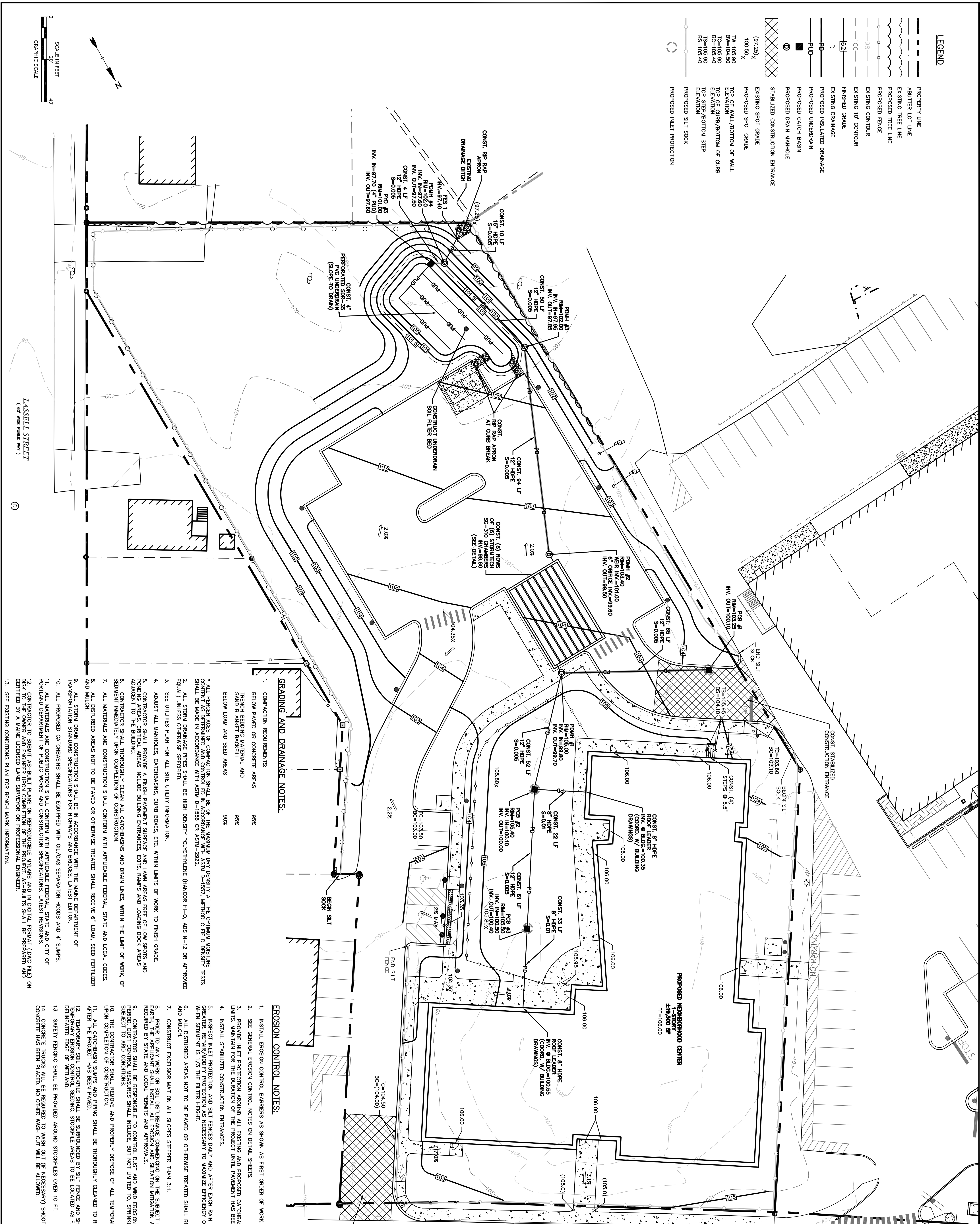

GRADING AND DRAINAGE NOTES:

1. COMPACTION REQUIREMENTS:
BELOW PAVED OR CONCRETE AREAS 95%
TRIPLY BEDDED MATERIAL AND SAND BLANKET BASKET 95%
BELOW LOAM AND SEED AREAS 90%
- * ALL PERCENTAGES OF COMPACTION SHALL BE OF THE MAXIMUM DRY DENSITY AT THE OPTIMUM MOISTURE SHALL BE MADE IN ACCORDANCE WITH ASTM D-1558 OR ASTM D-2922 METHOD C FIELD DENSITY TESTS SHALL BE MADE IN ACCORDANCE WITH ASTM D-1558 OR ASTM D-2922
2. ALL STORM DRAINAGE PIPES SHALL BE HIGH DENSITY POLYETHYLENE (HANCOR H-Q, ADS N-12 OR APPROVED EQUAL) UNLESS OTHERWISE SPECIFIED.
3. SEE UTILITIES PLAN FOR ALL SITE UTILITY INFORMATION.
4. ADJUST ALL MANHOLES, CATCHBASINS, CURB BOXES, ETC. WITHIN LIMITS OF WORK TO FINISH GRADE.
5. CONTRACTOR SHALL PROVIDE A FINISH PAVEMENT SURFACE AND LAWN AREAS FREE OF LOW SPOTS AND ADJACENT TO THE BUILDING.
6. CONTRACTOR SHALL THOROUGHLY CLEAN ALL CATCHBASINS AND DRAIN LINES, WITHIN THE LIMIT OF WORK, OF SEDIMENT IMMEDIATELY UPON COMPLETION OF CONSTRUCTION.
7. ALL MATERIALS AND CONSTRUCTION SHALL CONFORM WITH APPLICABLE FEDERAL, STATE AND LOCAL CODES.
8. ALL DISTURBED AREAS NOT TO BE PAVED OR OTHERWISE TREATED SHALL RECEIVE 6" LOAM, SEED, FERTILIZER AND MULCH.
9. ALL STORM DRAIN CONSTRUCTION SHALL BE IN ACCORDANCE WITH THE MAINE DEPARTMENT OF TRANSPORTATION STANDARD SPECIFICATIONS FOR HIGHWAYS AND BRIDGES, LATEST EDITION.
10. ALL PROPOSED CATCHBASINS SHALL BE EQUIPPED WITH OIL/GAS SEPARATOR HOODS AND 4 SWUMPS.
11. ALL MATERIALS AND CONSTRUCTION SHALL CONFORM WITH APPLICABLE FEDERAL, STATE AND CITY OF PORTLAND DEPARTMENT OF PUBLIC WORKS AND CONSTRUCTION SPECIFICATIONS, LATEST REVISIONS.
12. CONTRACTOR TO SUBMIT AS-BUILT PLANS ON REPRODUCIBLE MATERIALS AND IN DIGITAL FORMAT (DWG FILE) ON DISK TO THE OWNER UPON COMPLETION OF THE PROJECT. AS-BUILTS SHALL BE PREPARED AND CERTIFIED BY A MAINE LICENSED LAND SURVEYOR OR PROFESSIONAL ENGINEER.
13. SEE EXISTING CONDITIONS PLAN FOR BENCH MARK INFORMATION.

EROSION CONTROL NOTES:

1. INSTALL EROSION CONTROL BARRIERS AS SHOWN AS FIRST ORDER OF WORK.
2. SEE GENERAL EROSION CONTROL NOTES ON DETAIL SHEETS.
3. PROVIDE NILET PROTECTION AROUND ALL EXISTING AND PROPOSED CATCHBASIN NIETS WITHIN THE WORK LIMITS. MAINTAIN FOR THE DURATION OF THE PROJECT UNTIL PAVEMENT HAS BEEN INSTALLED.
4. INSTALL STABILIZED CONSTRUCTION ENTRANCES.
5. INSPECT NILET PROTECTION AND SILT FENCES DAILY AND AFTER EACH RAIN STORM OF 0.25 INCH OR FEATHERS BEING FROM PROTECTION IS NECESSARY TO MAINTAIN EFFICIENCY OF FILTER. REPLACE ALL FILTERS WHEN SEDIMENT IS 1/3 THE FILTER HEIGHT.
6. ALL DISTURBED AREAS NOT TO BE PAVED OR OTHERWISE TREATED SHALL RECEIVE 6" LOAM, SEED, FERTILIZER AND MULCH.
7. CONSTRUCT EXCISOR MAT ON ALL SLOPES STEEPER THAN 3:1.
8. PRIOR TO ANY WORK OR SOIL DISTURBANCE COMMENCING ON THE SUBJECT PROPERTY, INCLUDING MOVING OF EARTH, THE APPLICANT SHALL INSTALL ALL EROSION AND SITUATION MITIGATION AND CONTROL MEASURES AS REQUIRED BY STATE AND LOCAL PERMITS AND APPROVALS.
9. CONTRACTOR SHALL BE RESPONSIBLE TO CONTROL DUST AND WIND EROSION THROUGHOUT THE CONSTRUCTION PERIOD. DUST CONTROL MEASURES SHALL INCLUDE, BUT NOT LIMITED TO, SPRINKLING WATER ON UNSTABLE SOILS SUBJECT TO AWD CONDITIONS.
10. THE CONTRACTOR SHALL REMOVE AND PROPERLY DISPOSE OF ALL TEMPORARY EROSION CONTROL DEVICES UPON COMPLETION OF CONSTRUCTION.
11. ALL CATCHBASIN SWUMPS AND PIPING SHALL BE THOROUGHLY CLEANED TO REMOVE ALL SEDIMENT AND DEBRIS AFTER THE PROJECT HAS BEEN PAVED.
12. TEMPORARY SOIL STOCKPILE SHALL BE SURROUNDED BY SILT FENCE AND SHALL BE STABILIZED BY TEMPORARY EROSION CONTROL, SEEDING, STOCKPILE AREAS TO BE LOCATED AS FAR AS POSSIBLE FROM THE DISTURBED EDGE OF WETLAND.
13. SAFETY FENCING SHALL BE PROVIDED AROUND STOCKPILES OVER 10 FT.
14. CONCRETE TRUCKS WILL BE REQUIRED TO WASH OUT IF NECESSARY SHOOTS ONLY WITHIN AREAS WHERE CONCRETE HAS BEEN PLACED. NO OTHER WASH OUT WILL BE ALLOWED.

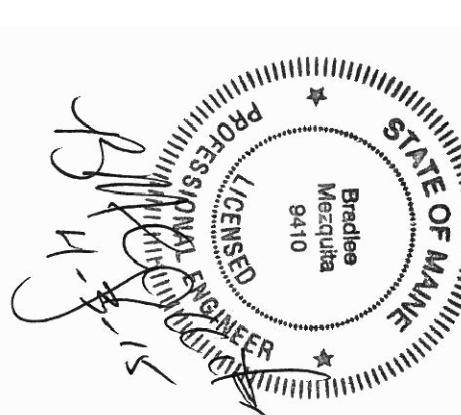

Jewish Community Alliance of Southern Maine
Proposed Neighborhood Center
Portland, Maine

April 03, 2015

Mark	Date	Description
	J-0096	
FILE:	J0094-SITE.dwg	
DRAWN BY:	GWH	
CHECKED:	BLM	
APPROVED BY:	BLM	

GRAVING, DRAINAGE AND EROSION CONTROL PLAN
SCALE: AS SHOWN
C-3