

### VIPER S SERIES

SMALL VIPER LUMINAIRE

**INTENDED USE:** The Beacon Viper luminaire is available in two sizes with a wide choice of different LED Wattage configurations and different LED distributions designed to replace HID lighting up to 1000W MH or HPS. Luminaires are suitable for wet locations.

**CONSTRUCTION:**

- One-piece optical carriage system consisting of an LED engine, LED lenses, optics, gasket and stainless steel base.
- Cartridge is held together with internal brass screws attached to the base so that it can be field replaced as a one-piece optical system.
- Two-piece silicone and micro-carbon polymers form gasket ensure a weather-proof seal around each individual LED.

**LED Options:**

- LED driver accepts 100V through 277V, 50 Hz to 60 Hz (80V), or a driver that accepts 347V or 480V AC.
- Power factor is 92 at full load.
- All electrical components are rated at 50,000 hours at full load and 25°C ambient conditions, per MIL-217F Notice 2.
- Dimming drivers are standard with dimming drivers available upon request.
- Component to component wiring within the luminaire may carry no more than 80% of rated load and is listed by UL for use at 600VAC at 50°C or higher.
- Plug disconnects are listed by UL for use at 600 VAC, 15A or higher, 15A rating specific to primary AC side only.

**Electrical:**

- Fixture electrical component shall contain all LED driver components and shall be provided with a switchboard terminal block for AC power connections.
- Optional 7 pin ANSI C136-41 2013 twist-lock photo control receptacle available. Compatible with ANSI C136-41 external wireless control devices.
- Single position - 20KVA shutoff at end of life.
- UL9890-1 Circuit - protects luminaire from excessive temperature by tripping with the 0-10V dimmable drivers to reduce drive current as necessary. The factory-programmed temperature limits are designed to ensure maximum hours of operation to assure L70 rated lumen maintenance. The device shall operate at a specific, maximum temperature, and progressively reduce power over a finite temperature range. A luminaire equipped with the device may be reliably operated in any ambient temperature up to 25°C (77°F). The thermal circuit will allow higher maximum Wattages than would be otherwise possible.

**CERTIFICATIONS/LISTINGS:**

Beacon Products • 2041 58th Avenue Circle East, Brentwood, TN 37020 • Phone: 800-345-4828  
 Due to our continued efforts to improve our products, product specifications are subject to change without notice.  
 © 2014 BEACON PRODUCTS. All Rights Reserved • For more information visit our website www.beaconproducts.com • Printed in USA. VHS-SPC-218

### TEMPE SERIES

**INTENDED USE:**

- Tempe series ballasts are designed to illuminate walkways and courtyards.

**CONSTRUCTION:**

- Extruded aluminum square or round housing, with tamper resistant hardware. Single screw access for top retaining decorative Softwhite series cap top with single access screw for maintenance.
- Sealed one-piece, clear acrylic lens. Sprocket, anodized aluminum optical system: dual reflector, tube optics, or internal lenses (HPS or CFL).
- Coated, galvanized steel anchor base. Four 1/2" x 1/2" anchor bolts.
- Durable, Labcoated™ TIGC treated, polyester powder coat paint finish assures long life and maintenance free service.

**ELECTRICAL:**

**HID:**

- HPS ballast, starting rated at 20" (40" for HPS); Pulse Start Metal Halide is CWA or Super CWA type HPS in CWA, HR, or Reactor type.
- Medium porcelain socket, pulsed, with spring-loaded, nickel plated center contact and reinforced lamp grip screw shell.

**FLUORESCENT:**

- Programmed Start electronic ballast with end of life protection and universal voltage; 26/32/42w T8 Lamp - CFTR0242 - Triple Tube 4-Pin LED.
- Universal voltage (120-277V) drivers with +/- 10% tolerance, starting temperature rated at -20°F.
- Optional continuous dimming to 10% (0-100).
- Rotatable LED assembly adjusted for ideal placement and aiming of asymmetric light pattern.
- 24 high brightness LEDs at 500 mA deliver asymmetric distribution at 31w.
- 12 high brightness LEDs at 700 mA deliver asymmetric distribution at 31w.
- Available in two color correlated temperatures (3000K and 5000K).
- Rated for 50,000 hour L70 rated at 25°C.

**LISTINGS:**

- Listed to UL 1598 for use in wet locations.
- 5 year limited warranty on LED system.

**CERTIFICATIONS/LISTINGS:**

**ORDERING INFORMATION**  
 ORDERING EXAMPLE: TMS-P50-DD-Q-DL-L, TMS-12LU-SK-U-D

SERIES	SOURCE/WATTAGE/LED	OPTICS	VOLTAGE	COLOR	OPTIONS
TMR	Tempe Round	PULSE START METAL HALIDE	D0' Dual reflector with cone (standard)	Q' Quad-Tag® 120/200/300/277V	DB Dark Bronze
TMS	Tempe Square	P50 30w (E0-17) P70 70w (E0-17) P110 110w (E0-17)	T0' Tube optics H' Internal horizontal L' Internal lower	T14 14 Tag® 120/277/347V (ESA) U' Universal 120-277V, 50/60 Hz S' 120V 5' 480V	BL Black WB White GR Gray PS Platinum Silver RD Red (premium color) FG Forest Green (premium color) CC Custom color (consult factory)
	HIGH PRESSURE SODIUM	SS5' 50w (E0-17) SS9 90w (E0-17) S70 70w (E0-17) S10 100w (E0-17)			FP0' Fastig 480V FP3' Fastig 347V FPX Photo button (premium color) FP7 Photo button - 347V 24 24' luminaire height 36 36' luminaire height
	FLUORESCENT	F26 26w CFL (E24 Base) F32 32w CFL (E24 Base) F42 42w CFL (E24 Base)			HS0' Internal shield - 90° (HPS Only) HS30' Internal shield - 90° (HPS Only) L' Lamp CD' Continuous dimming
	12LU-SK 12 LEDs, 31w, asymmetric distribution, 3000K, 120-277V, 50/60 Hz				1 Factory wired for highest voltage unless specified, H0 only 2 120V only 3 Upper reflector with to lower one 4 120V or LED system only 5 Not available with CFL 6 Not available with LED only 7 LED only
	24LU-SK 24 LEDs, 40w, asymmetric distribution, 3000K, 120-277V, 50/60 Hz				
	24LU-SK 24 LEDs, 40w, asymmetric distribution, 5000K, 120-277V, 50/60 Hz				

Spurling Lighting • 701 Millennium Boulevard • Greenville, SC 29607 • Phone: 864-678-1000  
 Due to our continued efforts to improve our products, product specifications are subject to change without notice.  
 © 2014 SPURLING LIGHTING. All Rights Reserved • For more information visit our website www.spurlinglighting.com • Printed in USA. TMS-SPC-181

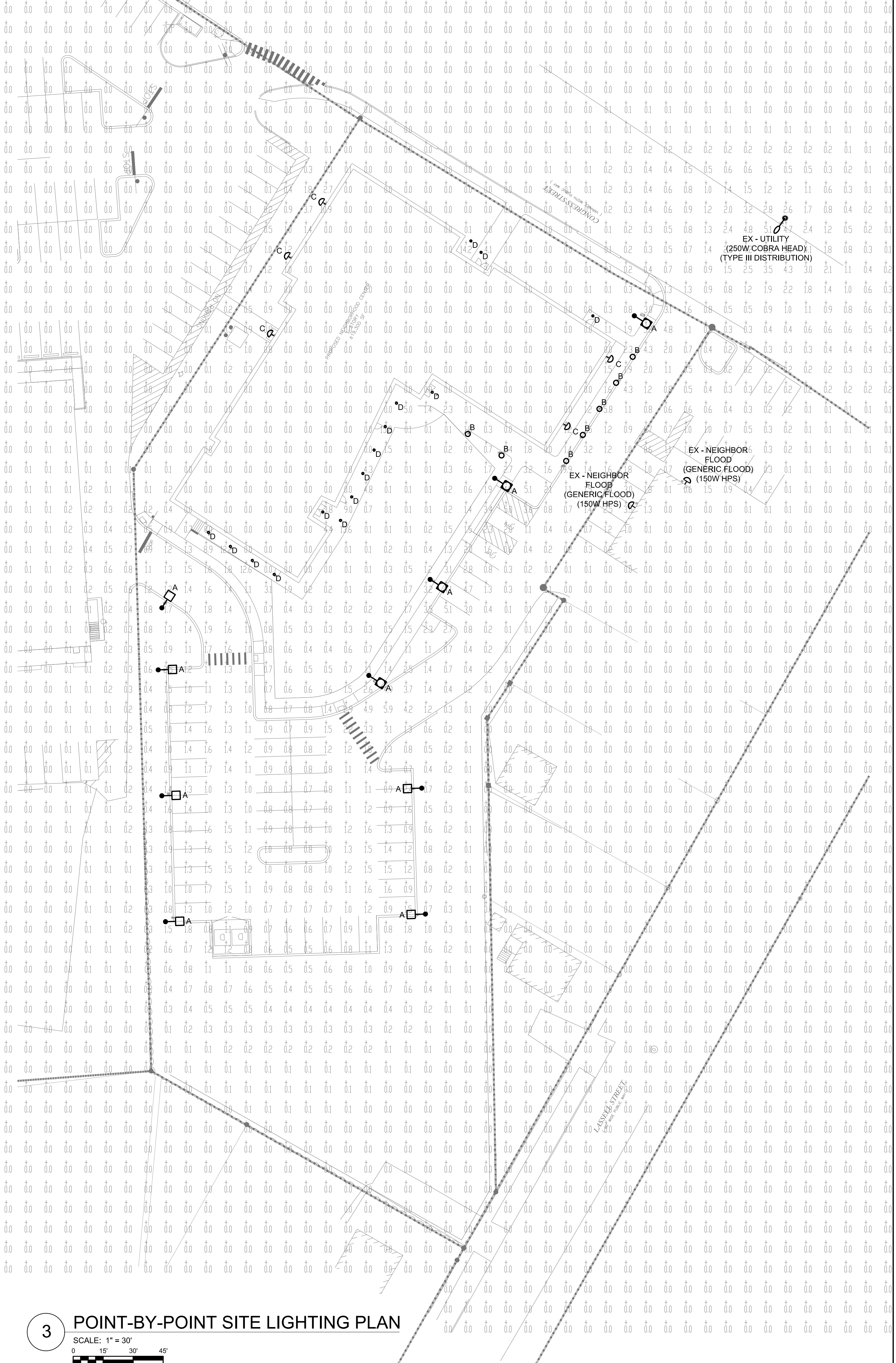

## POLE MOUNTED LIGHTS (TYPE A) WITH HOUSE SIDE SHIELD

SCALE: NO SCALE

### LNC SERIES

**INTENDED USE:** The compact LNC is designed for entry-level illumination for safety, security and identity. Typical mounting height is up to 12 feet with 40ft house spacing without acrylic diffuser installed. Photocell option is available to provide dusk-to-dawn control for additional energy savings.

**CONSTRUCTION:** Durable die-cast aluminum housing and clear rugged design protects internal components and provides excellent thermal management for long life. 60-100,000 hour minimum LED life at full power per IESNA TM-21-11. Powder paint finishes provide lasting appearance in outdoor environments.

**OPTICAL/ELECTRICAL:** Drivers are 120-277V, 50/60Hz. Type I, II and Type IV lenses provide wide lateral spread for 0-10V dimming 120-277V only.

**LED:** 7 LEDs, Type I, II or IV available, see page 2 for electrical details.

**Lenses:** Full cut-off distribution. Ambient diffuser included, optional for applications near entrances or ceilings where reduced brightness is desired.

**INSTALLATION:** Quick mount adapter provides quick installation, designed for recessed box 4" square junction box.

**LISTINGS:** Listed and tabulated to UL 1598 for wet locations, 25°C ambient environments. Some models meet Design Lights Consortium (DLC) qualifications, contact DLC website for more details: <http://www.designlights.org/2012>

**WARRANTY:** Five year limited warranty (for more information visit: <http://www.hubbelloutdoor.com/resources/warranty>)

**CERTIFICATIONS/LISTINGS:**

Hubbell Outdoor Lighting • 701 Millennium Boulevard • Greenville, SC 29607 • Phone: 864-678-1000  
 Due to our continued efforts to improve our products, product specifications are subject to change without notice.  
 © 2014 HUBBELL OUTDOOR LIGHTING. All Rights Reserved • For more information visit our website www.hubbelloutdoor.com • Printed in USA. HUB-SPC-216

## BOLLARD LIGHT (TYPE B)

SCALE: NO SCALE

### C6L1520DL(M)

Calculte LED 6", Downlight, Medium Beam

Page 1 of 2

Project: \_\_\_\_\_ Catalog No: \_\_\_\_\_ Mfg: \_\_\_\_\_  
 Location: \_\_\_\_\_ Fixture Type: \_\_\_\_\_ Qty: \_\_\_\_\_

**Complete product = light engine + frame-in-kits**

**Ordering guide: Light engine** example: C6L1520DL36KCCVHVM

Light engine	CCT	Beam spread	Reflector finish	Flange	Options	CRB
C6L1520DL	Calculte LED 4", 1500/2000 Lumen, Downlight	27K 2700K 30K 3000K 35K 3500K 49K 4900K	M Medium beam, 0.8 x 0.8	CCL Clear CCD Comfort clear diffuser CCC Champagne bronze WH Painted white	P Painted white F Polished FT Flush-mount/flangeless	EM Integral emergency see switch VA 3000K - 4900K (79)

**Ordering guide: Frame-in-kits** example: C6L1520DLHVM

Frame-in-kits series	Installation options	Input voltage	Driver	Options
C6L15	Calculte LED 4", 1500 lumen	N New construction	Z19V 0-10V dimming	EM Emergency (new construction w/1000 lumen only)
C6L2	Calculte LED 4", 2000 lumen	2 277V	LED Lutron driver® (1000 lumen only)	

1. Accessory CAPRM required for gasket applications. Reflector flange is 1/4" New construction frame-in-kits only.  
 2. See LED life for details and restrictions.  
 3. For use with HLE and Ecopower controls.

**Features:** Aperture: 6" (152 mm) I.D. 7 1/4" (184 mm) O.D. Remote Technology: Remote photometry technology provides increased efficiency and color consistency. Phosphor lens assembly positioned in front of LED array covers blue light-to-white. Color shift will not exceed +/- 100K over life.

**Options:** Dimming capability: 0-10V. See LED-EM spec sheet. Emergency capability (integrated) Add "EM" suffix. See LED-EM spec sheet. Emergency capability (overwire) See LED-LPM spec sheet.

**Labels:** UL, suitable for wet locations, cUL, UL, ENEC, 3 year warranty.

**Technology:** LED board: Array of high brightness royal blue LEDs. Emergency Technology: Remote photometry technology provides increased efficiency and color consistency. Phosphor lens assembly positioned in front of LED array covers blue light-to-white. Color shift will not exceed +/- 100K over life.

**Optical Mixing Chamber:** Light-specific mixing chamber redirects back-reflected light through aperture resulting in 20% increase in efficiency. Thermal Management: Heat sink and thermal design along with clean room assembly ensures specified performance.

**Rated Life:** Based on IESNA LM-79-0208 1500 Lumen - 48,000 hours @ 70% lumen maintenance. 2000 Lumen - 52,000 hours @ 70% lumen maintenance. Photometric Performance: Tested in accordance to IESNA LM-79-2008.

### 1 EXTERIOR BUILDING MOUNTED (TYPE C)

SCALE: NO SCALE

**ORDERING INFORMATION**  
 ORDERING EXAMPLE: LNC-9LU-SK-3-1-PC1

SERIES	NUMBER OF LED/SOURCE/WATTAGE	CCT	IES DISTRIBUTION	FINISH	OPTIONS
LNC	LNC zero split	SLP 5 LEDs, Universal voltage 120-277V	JK 3000K nominal, 70 CR	2 Type I	1 Finish PCX' Bottom photocell, replace X with voltage, specify 1-120V, 2-200V, 3-240V, 4-277V
	SLP 7 LEDs, Universal voltage 120-277V	4K 4000K nominal, 70 CR	3 Type II	2 Gray 3 Black 4 White 5 Platinum	
	SLP 9 LEDs, Universal voltage 120-277V	SK' 5000K nominal, 70 CR	4 Type IV		

1 When PC is ordered, hood must match PC voltage  
 2 Amber LEDs only available on 7LU and 8LU configurations, 200 mA only  
 3 DeepLight Consortium DLC qualified 5/7/9 models SK only. LNC-9LU-SK-4, LNC-9LU-SK-5, LNC-7LU-SK-4, LNC-7LU-SK-5

Hubbell Outdoor Lighting • 701 Millennium Boulevard • Greenville, SC 29607 • Phone: 864-678-1000  
 Due to our continued efforts to improve our products, product specifications are subject to change without notice.  
 © 2014 HUBBELL OUTDOOR LIGHTING. All Rights Reserved • For more information visit our website www.hubbelloutdoor.com • Printed in USA. LNC-SPC-216

### 2 EXTERIOR CANOPY MOUNTED (TYPE D)

SCALE: NO SCALE

**ORDERING INFORMATION**  
 ORDERING EXAMPLE: LNC-9LU-SK-3-1-PC1

SERIES	NUMBER OF LED/SOURCE/WATTAGE	CCT	IES DISTRIBUTION	FINISH	OPTIONS
LNC	LNC zero split	SLP 5 LEDs, Universal voltage 120-277V	JK 3000K nominal, 70 CR	2 Type I	1 Finish PCX' Bottom photocell, replace X with voltage, specify 1-120V, 2-200V, 3-240V, 4-277V
	SLP 7 LEDs, Universal voltage 120-277V	4K 4000K nominal, 70 CR	3 Type II	2 Gray 3 Black 4 White 5 Platinum	
	SLP 9 LEDs, Universal voltage 120-277V	SK' 5000K nominal, 70 CR	4 Type IV		

1 When PC is ordered, hood must match PC voltage  
 2 Amber LEDs only available on 7LU and 8LU configurations, 200 mA only  
 3 DeepLight Consortium DLC qualified 5/7/9 models SK only. LNC-9LU-SK-4, LNC-9LU-SK-5, LNC-7LU-SK-4, LNC-7LU-SK-5

Hubbell Outdoor Lighting • 701 Millennium Boulevard • Greenville, SC 29607 • Phone: 864-678-1000  
 Due to our continued efforts to improve our products, product specifications are subject to change without notice.  
 © 2014 HUBBELL OUTDOOR LIGHTING. All Rights Reserved • For more information visit our website www.hubbelloutdoor.com • Printed in USA. LNC-SPC-216

### 3 POINT-BY-POINT SITE LIGHTING PLAN

SCALE: 1" = 30'

0 15' 30' 45'

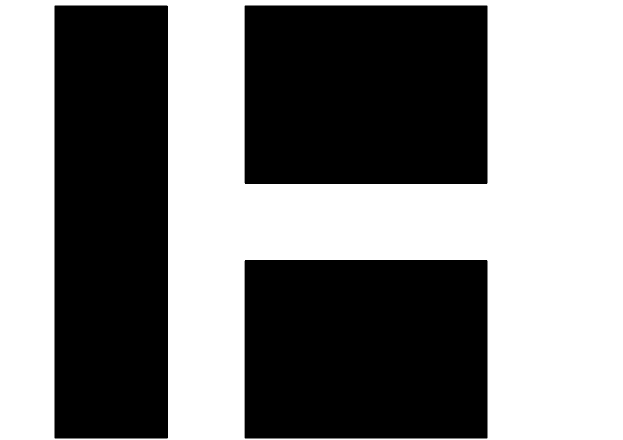

HARRIMAN

AUBURN PORTLAND MANCHESTER

JEWISH COMMUNITY ALLIANCE OF SOUTHERN MAINE

Portland, Maine

Harriman Project No.	15309
Key Plan	Proj North

NOTE: NEIGHBOR AND UTILITY LIGHTS ARE BEST GUESS, WATTAGE AND DISTRIBUTION ARE NOT KNOWN.

Issues and Revisions

Mark	Date	Description
--	06-24-15	PLANNING BOARD SUBMISSION
--	07-13-15	PROGRESS UPDATE
--	09-04-15	DESIGN DEVELOPMENT REVIEW
--	07-11-16	REVISED FOR PB SUBMISSION

PRELIMINARY NOT FOR CONSTRUCTION

Drawing Scales

PA / PE: JWT © 2016  
 Drawn By: JMB Harriman Associates

SITE LIGHTING PLAN

E80.1