

24-26 MITTON STREET

SHAW-WALKER

First cut #920R - First cut #9202R - Third cut #9203R - Fifth cut #9205R



APPLICATION FOR PERMIT
 DEPARTMENT OF BUILDING INSPECTIONS SERVICES
 ELECTRICAL INSTALLATIONS

Date Oct. 4, 19 76
 Receipt and Permit number A7954

To the CHIEF ELECTRICAL INSPECTOR, Portland, Maine:

The undersigned hereby applies for a permit to make electrical installations in accordance with the laws of Maine, the Portland Electrical Ordinance, the National Electrical Code and the following specifications:

LOCATION OF WORK: 24 Mitton St.
 OWNER'S NAME: Timothy Leavitt ADDRESS: same

OUTLETS: (number of)
 Lights 31-60
 Receptacles _____
 Switches _____
 Plugmold _____ (number of feet)
 TOTAL _____ **FEE** 5.00

FIXTURES: (number of)
 Incandescent _____
 Fluorescent _____ (Do not include strip fluorescent)
 TOTAL _____
 Strip Fluorescent, in feet _____

SERVICES:
 Permanent, total amperes _____
 Temporary _____

METERS: (number of) _____

MOTORS: (number of)
 Fractional _____
 1 HP or over _____

RESIDENTIAL HEATING:
 Oil or Gas (number of units) _____
 Electric (number of rooms) _____

COMMERCIAL OR INDUSTRIAL HEATING:
 Oil or Gas (by a main boiler) _____
 Oil or Gas (by separate units) _____
 Electric (total number of kws) _____

APPLIANCES: (number of)
 Ranges _____ Water Heaters _____
 Cook Tops _____ Disposals _____
 Wall Ovens _____ Dishwashers _____
 Dryers _____ Compactors _____
 Fans _____ Others (denote) _____
 TOTAL _____

MISCELLANEOUS: (number of)
 Branch Panels 1 **FEE** 1.00
 Transformers _____
 Air Conditioners _____
 Signs _____
 Fire/Burglar Alarms _____
 Circus, Fairs, etc. _____
 Alterations to wires _____
 Repairs after fire _____
 Heavy Duty, 220v outlets _____
 Emergency Lights, battery _____
 Emergency Generators _____

INSTALLATION FEE DUE: _____
 FOR ADDITIONAL WORK NOT ON ORIGINAL PERMIT DOUBLE FEE DUE: _____
 FOR REMOVAL OF A "STOP ORDER" (304-16.b) _____
 FOR PERFORMING WORK WITHOUT A PERMIT (304-9) _____
 TOTAL AMOUNT DUE: 6.00

INSPECTION:
 Will be ready on _____, 19____; or Will Call

CONTRACTOR'S NAME: L & M Electric Co.
 ADDRESS: 12 Clifton St.
 TEL.: 774-4137

MASTER LICENSE NO.: 1613 SIGNATURE OF CONTRACTOR: L.W. McMahon
 LIMITED LICENSE NO.: _____

INSPECTOR'S COPY

ELECTRICAL INSTALLATIONS —

Permit Number 7954

Location 24 Milton St.

Owner 1. Wally Smith

Date of Permit 10-4-76

Final Inspection 10-5-76

By Inspector P. Kelly

Permit Application Register Page No. 74

INSPECTIONS: Service _____ by _____

Service called in _____

Closing-in _____ by _____

PROGRESS INSPECTIONS: 10-5-76 /

_____/

_____/

_____/

_____/

_____/

CODE
COMPLIANCE
COMPLETED
DATE 10-5-76

DATE:

REMARKS:

OK

CITY OF PORTLAND, MAINE
Application for Permit to Install Wires

Permit No. 55152
 Issued 7-27-71
 July 27, 1971
 Portland, Maine

To the City Electrician, Portland, Maine:

The undersigned hereby applies for a permit to install wires for the purpose of conducting electric current, in accordance with the laws of Maine, the Electrical Ordinance of the City of Portland, and the following specifications:

(This form must be completely filled out — Minimum Fee, \$1.00)

Owner's Name and Address John Mauro 24 Milton St. Tel. _____
 Contractor's Name and Address Marino's Elect. Co. 687 1/2 St. Tel. 774-3129
 Location 24 Milton St. Use of Building _____
 Number of Families _____ Apartments _____ Stores _____ Number of Stories _____
 Description of Wiring: New Work _____ Additions _____ Alterations _____
 Pipe _____ Cable _____ Metal Molding _____ BX Cable _____ Plug Molding (No. of feet) _____
 No. Light Outlets _____ Plugs 6 Light Circuits _____ Plug Circuits _____
 FIXTURES: No. _____ Light Switches _____ Fluor. or Strip Lighting (No. feet) _____
 SERVICE: Pipe _____ Cable Underground _____ No. of Wires 3 Size 2-3/8
 METERS: Relocated _____ Added _____ Total No. Meters _____
 MOTORS: Number _____ Phase _____ H. P. _____ Amps _____ Volts _____ Starter _____
 HEATING UNITS: Domestic (Oil) _____ No. Motors _____ Phase _____ H.P. _____
 Commercial (Oil) _____ No. Motors _____ Phase _____ H.P. _____
 Electric Heat (No. of Rooms) _____
 APPLIANCES: No. Ranges 1 Watts _____ Brand Feeds (Size and No.) _____
 Elec. Heaters _____ Watts _____
Dryer Miscellaneous 1 Watts _____ Extra Cabinets or Panels _____
 Transformers _____ Air Conditioners (No. Units) _____ Signs (No. Units) _____
 Will commence _____ 19 _____ Ready to cover in _____ 19 _____ Inspection 7/27/1971
 Amount of Fee \$ 7.00
 Signed J. Marino

*7/27/71
 7.00
 J. Marino*

DO NOT WRITE BELOW THIS LINE

SERVICE _____ METER _____ GROUND _____
 VISITS: 1 _____ 2 _____ 3 _____ 4 _____ 5 _____ 6 _____
 7 _____ 8 _____ 9 _____ 10 _____ 11 _____ 12 _____

REMARKS:

INSPECTED BY J. H. [Signature]
 (OVER)

LOCATION *Mitten ST 24*
 INSPECTION DATE *7/27/71*
 WORK COMPLETED *7/27/71*
 TOTAL NO. INSPECTIONS *1*
 REMARKS:

FEEES FOR WIRING PERMITS EFFECTIVE JULY 31, 1968

WIRING

1 to 30 Outlets (including switches) \$ 2.00
 31 to 60 Outlets (including switches) 3.00
 Over 60 Outlets, each Outlet (including switches)05
 (Each twelve feet or fraction thereof of fluorescent lighting or
 any type of plug molding will be classed as one outlet).

SERVICES

Single Phase 2.00
 Three Phase 4.00

MOTORS

Not exceeding 50 H.P. 3.00
 Over 50 H.P. 4.00

HEATING UNITS

Domestic (Oil) 2.00
 Commercial (Oil) 4.00
 Electric Heat (Each Room)75

APPLIANCES

Ranges, Cooking Tops, Ovens, Water Heaters, Disposals, Dish-
 washers, etc. - Each Unit 1.50

TEMPORARY WORK (Limited to 6 months from date of permit)

Service, Single Phase 1.00
 Service, Three Phase 2.00
 Wiring, 1-50 Outlets 1.00
 Wiring, each additional outlet over 5002
 Circuses, Carnivals, Fairs, etc. 10.00

PERMIT TO INSTALL PLUMBING

13512
PERMIT NUMBER

Date Issued 12-2-63
 Address 24 Mitton Street
 Installation For: Ralph MacDonald
 Owner of Bldg. Ralph MacDonald
 Owner's Address: 24 Mitton Street

By J. P. Welch Plumber: Richard P. Waltz Date: 12-2-63

APPROVED FIRST INSPECTION	NEW	REPL	PROPOSED INSTALLATIONS	NUMBER	FEE
			SINKS		
			LAVATORIES		
			TOILETS		
			BATH TUBS		
			SHOWERS		
Date <u>Dec. 3, 1963</u>			DRAINS	1	\$ 2.00
By <u>JOSEPH P. WELCH</u>			HOT WATER TANKS		
APPROVED FINAL INSPECTION			TANKLESS WATER HEATERS		
Date <u>Dec. 3, 1963</u>			GARBAGE GRINDERS		
By <u>JOSEPH P. WELCH</u>			SEPTIC TANKS		
<input type="checkbox"/> COMMERCIAL			HOUSE SEWERS		
<input type="checkbox"/> RESIDENTIAL			ROOF LEADERS (Conn. to house drain)		
<input type="checkbox"/> SINGLE					
<input type="checkbox"/> MULTI FAMILY					
<input type="checkbox"/> NEW CONSTRUCTION					
<input type="checkbox"/> REMODELING					

PORTLAND HEALTH DEPT. PLUMBING INSPECTION TOTAL $\$ 2.00$

REMODELING PORTLAND HEALTH DEPT. PLUMBING INSPECTION TOTAL $\$ 2.00$

PERMIT TO INSTALL PLUMBING

13511

PERMIT NUMBER

Date Issued 12-2-63
 PORTLAND PLUMBING INSPECTOR

Address 24 Mitton Street
 Installation For: Ralph MacDonald
 Owner of Bldg. Ralph MacDonald
 Owner's Address: 24 Mitton Street

By J. P. Welch

Plumber: Richard P. Walks Date: 12-2-63

APPROVED FIRST INSPECTION

Date Dec 2, 1963

By [Signature]
 APPROVED FINAL INSPECTION

Date _____

By JOSEPH P. WELCH

- TYPE OF BUILDING
 COMMERCIAL
 RESIDENTIAL
 SINGLE
 MULTI FAMILY
 NEW CONSTRUCTION
 REMODELING

NEW	REPL	PROPOSED INSTALLATIONS	QUANTITY	FEE
		SINKS		
		LAVATORIES		
		TOILETS		
		BATH TUBS		
		SHOWERS		
		DRAINS		
		HOT WATER TANKS		
		TANKLESS WATER HEATERS		
		GARBAGE GRINDERS		
		SEPTIC TANKS		
	1	HOUSE SEWERS	1	\$ 2.00
		ROOF LEADERS (Conn. to house drain)		

PORTLAND HEALTH DEPT. PLUMBING INSPECTION

TOTAL ▶ \$ 2.00

3



FILE IN AND SIGN WITH INK

APPLICATION FOR PERMIT FOR HEATING, COOKING OR POWER EQUIPMENT

0301-1
NOV 15 1947

Portland, Maine, Nov. 14, 1947

To the INSPECTOR OF BUILDINGS, PORTLAND, MAINE

The undersigned hereby applies for a permit to install the following heating, cooking or power equipment in accordance with the Laws of Maine, the Building Code of the City of Portland, and the following specifications:

Location 24 Mitton St. Use of Building Dwelling No. Stories 2 1/2 ~~New~~ Building Existing "
Name and address of owner of appliance J. E. Yonohan, 24 Mitton Street
Installer's name and address Marshall Eng. Co., 350 Commercial St. Telephone 3-1524

General Description of Work

To install Oil burning equipment in connection with existing steam heat.

IF HEATER, OR POWER BOILER

Location of appliance or source of heat _____ Type of floor beneath appliance _____
If wood, how protected? _____ Kind of fuel _____
Minimum distance to wood or combustible material, from top of appliance or casing top of furnace _____
From top of smoke pipe _____ From front of appliance _____ From sides or back of appliance _____
Size of chimney flue _____ Other connections to same flue _____
If gas fired, how vented? _____ Rated maximum demand per hour _____

IF OIL BURNER

Name and type of burner Delco Labeled by underwriter's laboratories? Yes
Will operator be always in attendance? _____ Does oil supply line feed from top or bottom of tank? Bottom
Type of floor beneath burner Concrete
Location of oil storage Cellar Number and capacity of tanks 1-210 Gal.
If two 275-gallon tanks, will three-way valve be provided? _____
Will all tanks be more than five feet from any flame? Yes How many tanks fire proofed? _____
Total capacity of any existing storage tanks for furnace burners None

IF COOKING APPLIANCE

Location of appliance _____ Kind of fuel _____ Type of floor beneath appliance _____
If wood, how protected? _____
Minimum distance to wood or combustible material from top of appliance _____
From front of appliance _____ From sides and back _____ From top of smokepipe _____
Size of chimney flue _____ Other connections to same flue _____
Is hood to be provided? _____ If so, how vented? _____
If gas fired, how vented? _____ Rated maximum demand per hour _____

MISCELLANEOUS EQUIPMENT OR SPECIAL INFORMATION

Amount of fee enclosed? 1.00 (\$1.00 for one heater, etc., 50 cents additional for each additional heater, etc., in same building at same time.)

APPROVED:

11/14/47 R.M.W.

Will there be in charge of the above work a person competent to see that the State and City requirements pertaining thereto are observed? Yes

Marshall Engineering Co.

INSPECTION COPY

Signature of Installer By: R.M.W.

Permit No. 47/3091

Location 24 Mutton St.

Owner J. E. Monahan

Date of permit 11/15/47

Approved NOT COMPLETED

NOTES 4-6-49, 11/11/47

- 1. Fill Pipe -----
- 2. Vent Pipe -----
- 3. Kind of Heat -----
- 4. Burner Regulator & Supports -----
- 5. Name & Model -----
- 6. Size & Control -----
- 7. Fuel Liquid Control -----
- 8. Return Control -----
- 9. Piping Support & Protection -----
- 10. Valves & Supply Lines -----
- 11. Capacity of Tank -----
- 12. Tank Brackets & Supports -----
- 13. Leak Distance -----
- 14. Oil Gauge -----
- 15. Instruction Card -----
- 16. -----

6-8-48 This at home.

4-6-49 for added time
for added time
15 min

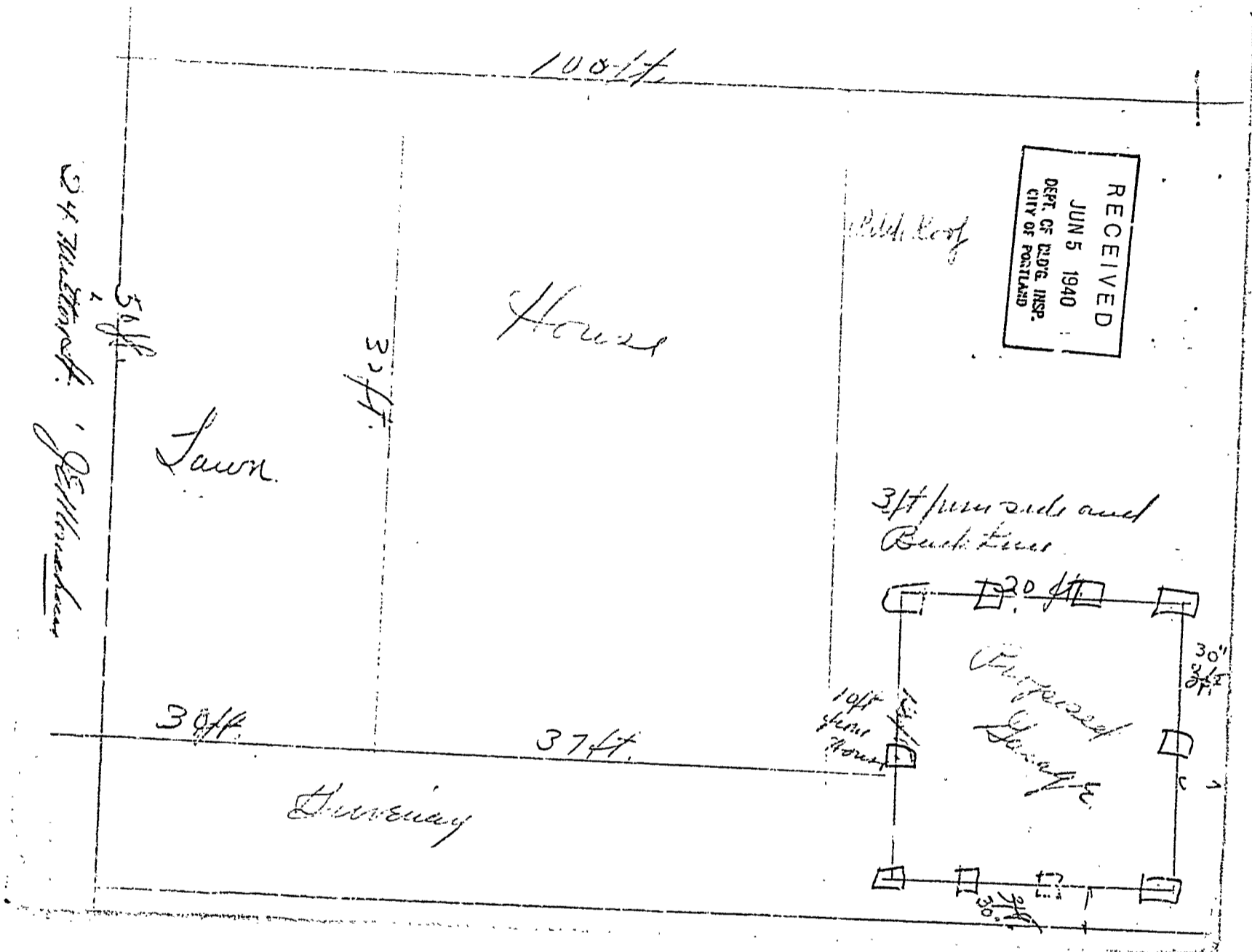

24 West 1st St. J. J. McNamee

5 ft.

Lawn

30 ft.

House

Piled Roof

RECEIVED
JUN 5 1940
DEPT. OF BLDG. INSP.
CITY OF PORTLAND

3 ft per side and Back Lane

20 ft.

Proposed Garage

30 ft.

10 ft front porch

37 ft.

Driveway

30 ft.

30 ft.

Driveway

30 ft.



Original Permit No. 10/221
Amendment No. 1

AMENDMENT TO APPLICATION FOR PERMIT 1940

To the INSPECTOR OF BUILDINGS, PORTLAND, ME. Portland, Maine, June 1, 1940

The undersigned hereby applies for an amendment to Permit No. 10/221 pertaining to the building or structure contained in the original application in accordance with the Laws of the State of Maine, the Building Code of the City of Portland, plans and specifications, if any, submitted herewith, and the following specifications:

Location 14 Mitton Street Within Fire Limits? NO Dist. No. _____
 Owner's or Lessee's name and address James E. Monahan, 24 Mitton Street 32572
 Contractor's name and address OWNER
 Plans filed as part of this Amendment yes No. of Sheets 1
 Is any plumbing work involved in this work? _____ Is any electrical work involved in this work? _____
 Increased cost of work _____ Additional fee 25
 Framing Lumber: Kind? _____ Dressed or Full Size? _____

Description of Proposed Work
To locate garage as shown on plan submitted with this amendment
Size of building to be 12' x 20'

Approved Wm. D. Paulson
Chief of Fire Department.

Signature of Owner James E. Monahan

INSPECTION COPY Commissioner of Public Works.

Approved W. C. ...
Inspector of Buildings

Congress St

RECEIVED
MAY 1 1940
DEPT. OF OLD G. INSP.
CITY OF PORTLAND

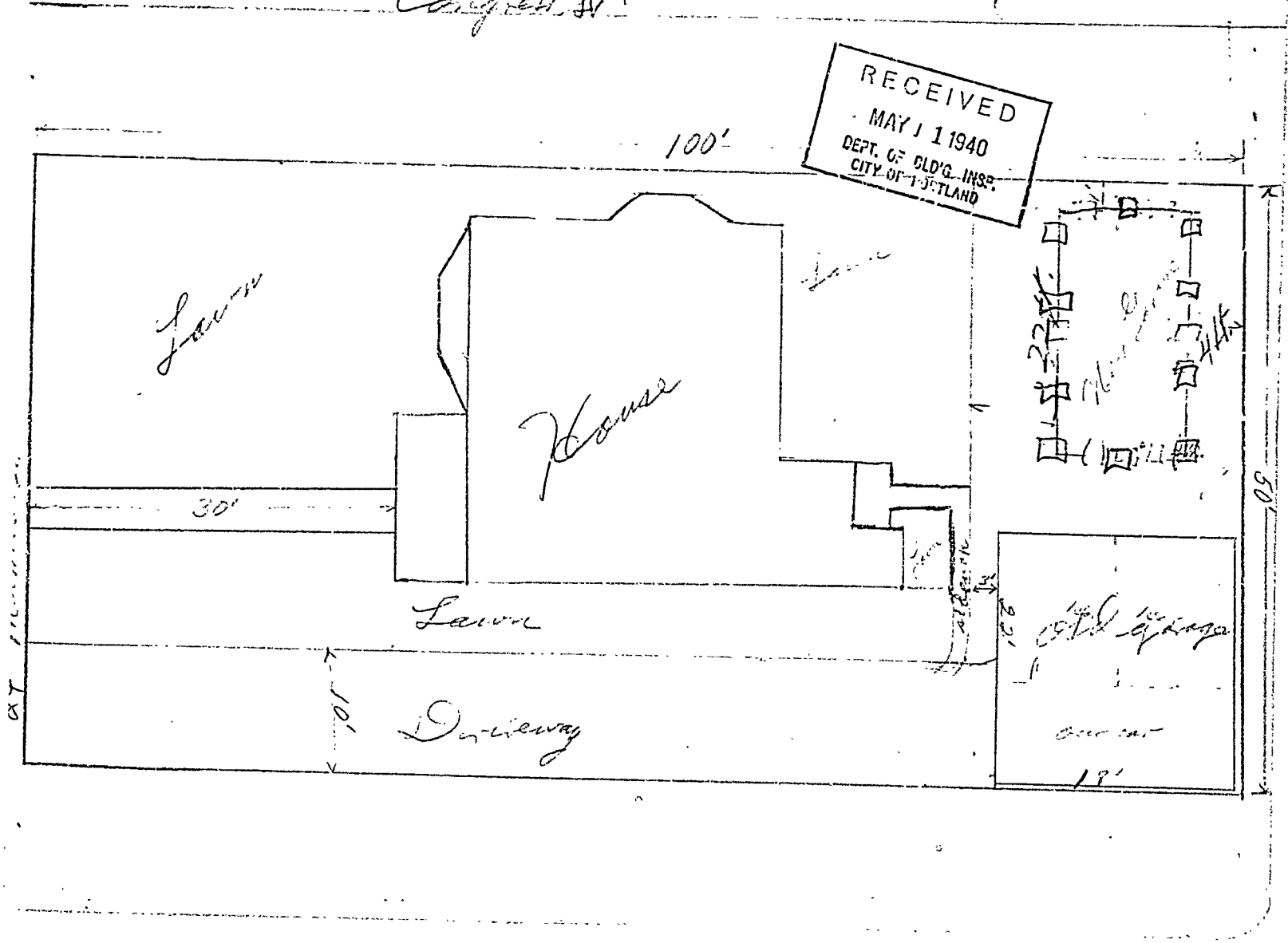

STATEMENT ACCOMPANYING APPLICATION FOR BUILDING PERMIT

for rebuild garage

at 24-Mitton Street

Date 5/10/40

1. In whose name in the title of the property now recorded? James Eastman J. Morahan
2. Are the boundaries of the property in the vicinity of the proposed work shown clearly on the ground, and how? min. posts
3. Is the outline of the proposed work now staked out upon the ground? No. If not, will you notify the Inspection Office when the work is staked out and before any of the work is commenced? Ready any time Monday
4. What is to be maximum projection or overhang of eaves or drip? 6"
5. Do you assume full responsibility for the correctness of the location plan or statement of location filed with this application, and does it show the complete outline of the proposed work on the ground, including bay windows, porches, and other projections? yes
6. Do you assume full responsibility for the correctness of all statements in the application concerning the sizes, design and use of the proposed building? yes
7. Do you understand that in case changes are proposed in the location of the work or in any of the details specified in the application that a revised plan and application must be submitted to this office before the changes are made? yes

J. E. Morahan



(R) GENERAL RESIDENCE ZONE PERMIT ISSUED
APPLICATION FOR PERMIT Permit No. 0585

Class of Building or Type of Structure Third Class MAY 13 1940

Portland, Maine, May 11, 1940

To the INSPECTOR OF BUILDINGS, PORTLAND, ME.

The undersigned hereby applies for a permit to erect alter install the following building structure-equipment in accordance with the Laws of the State of Maine, the Building Code of the City of Portland, plans and specifications, if any, submitted herewith and the following specifications:

Location 24 Mitton Street Within Fire Limits? no Dist. No. _____
Owner's or Lessee's name and address James E. Monahan, 24 Mitton Street Telephone 3-2572
Contractor's name and address Owner (Jos. Harrington) Telephone _____
Architect _____ Plans filed yes No. of sheets 1
Proposed use of building 1 car garage No. families _____
Other buildings on same lot dwelling house
Estimated cost \$ 200. Fee \$.75

Description of Present Building to be Altered

Material wood No. stories 1 & 2 Heat _____ Style of roof _____ Roofing _____
Last use 2 car garage No. families _____

General Description of New Work

To demolish existing garage 18' x 22' and
To build new one car garage 12' x 22' as shown on plan

NOTIFICATION BEFORE LATENT
OR CLOSING IN IS WAIVED
CERTIFICATE OF OCCUPANCY
REQUIREMENT IS WAIVED

It is understood that this permit does not include installation of heating apparatus which is to be taken out separately by and in the name of the heating contractor.

Details of New Work

Is any plumbing work involved in this work? _____
Is any electrical work involved in this work? _____ Height average grade to top of plate 8'
Size, front _____ depth _____ No. stories 1 Height average grade to highest point of roof 12'
To be erected on solid or filled land? solid earth or rock? earth
Material of foundation concrete piers Thickness, top _____ bottom _____ cellar _____
Material of underpinning _____ Height _____ Thickness _____
Kind of Roof pitch Rise per foot 7" Roof covering Asphalt roofing Class C Und. Lab.
No. of chimneys no Material of chimneys _____ of lining _____
Kind of heat no Type of fuel _____ Is gas fitting involved? _____
Framing Lumber—Kind second hand Dressed or Full Size? _____
Corner posts 4x4 Sills 6x6 Girt or ledger board? _____ Size _____
Material columns under girders _____ Size _____ Max. on centers _____
Studs (outside walls and carrying partitions) 2x4-16" O. C. Girders 6x8 or larger. Bridging in every floor and flat roof span over 8 feet. Sills and corner posts all one piece in cross section.
Joists and rafters: 1st floor cinder, 2nd _____, 3rd _____, roof 2x4
On centers: 1st floor _____, 2nd _____, 3rd _____, roof 1x2-2"
Maximum span: 1st floor _____, 2nd _____, 3rd _____, roof _____
If one story building with masonry walls, thickness of walls? _____ height? _____

If a Garage

No. cars now accommodated on same lot 2, to be accommodated 1
Total number commercial cars to be accommodated none
Will automobile repairing be done other than minor repairs to cars habitually stored in the proposed building? no

Miscellaneous

Will above work require removal or disturbing of any shade tree on a public street? no
Will there be in charge of the above work a person competent to see that the State and City requirements pertaining thereto are observed? yes

INSTRUCTION COPY James E. Monahan
Signature of owner James E. Monahan

CHIEF OF FIRE DEPT.

Permit No. 40/535

Location 24 Sutton St.

Owner James E. Mahan

Date of permit 5/13/40

Notif. closing-in

Inspn. closing-in

Final Notif.

Final Inspn. 7/5/40

Cert. of Occupancy issued None.

NOTES

5/13/40 - Staking out
OK - A.G.S.

5/20/40 - 6' x 2' foundation
dismantled - OK

5/24/40 - No change - OK

6/3/40 - Same - OK

6/12/40 - No work started
OK

6/17/40 - No framing
OK

6/24/40 - No framing
OK

6/28/40 - Wall of masonry
OK

7/5/40 - Roof on - OK

24 Mitton Street

190-J-14



September 24, 1979

Mr. & Mrs. Timothy W. Leavitt
24 Mitton Street
Portland, Maine 04102

Re: 24 Mitton Street 190-J-14
NCP-Libbytown

Dear Mr. & Mrs. Leavitt:

The Housing Inspections Division of the Department of Neighborhood Conservation has recently completed an exterior inspection of your property in conjunction with the above referred program.

Congratulations are extended to you for the general condition of your property which was found to meet the standards established by the City's Housing Code.

Good maintenance is the best way to protect the value of your property and neighborhood.

Please feel free to call on us if we can be of assistance to you.

Sincerely yours,
Joseph E. Gray, Jr., Director
Neighborhood Conservation

By Lyle H. Noyes
Lyle H. Noyes,
Chief of Housing Inspections

Inspector Merle Leary
M. Leary

dld

City of Portland

NEIGHBORHOOD CONSERVATION
Check Off Sheet
STRUCTURE INSPECTION SCHEDULE

Housing Inspection Division

Insp. Name M Leary

Standard Exterior

2) Insp. Date	3) Insp. Type	4) Proj. Code	5) Assr's: Chart	6) Bl.	7) Lot	8) Census: Tract	9) Blk.	10) Insp.	11) Form No.
9-19-79	Libbystown	Libbystown	190	J	14			12	
12) Hous. No.	13) Sec. H. No.	14) Sdff.	15) Direct	16) Street Name		17) St. Design.			
24				Milton		Street			
18) Owner or Agent:			Mr & Mrs Timothy W & Carol A Leary			19) Status		20) Bldg's Rat.	
						00		1	
21) Address:							24 Milton Street		Zip Code
							04102		
22) City and State: <u>Portland, Maine</u>									
23) D. Units	24) Occ. D. U. 's	25) Rm Units	26) Occ. R. U. 's	27) No. Occupants	28) Com'l U.	29) Bldg. Type	30) Stories	31) Const. Mat.	32) O. B's
						DE	2 1/2	Wood	NL
33) C. H.	34) Ph6.	35) Zoned For	36) Actual Land Use	37) D. D.	38) Lks. Ad. Bth. Fac.	39) Disp.	40) Closing Date		
					Yes No				

EXTERIOR - Structure		Cd. Viol.	INTERIOR - Structure		Cd. Viol.
Foundation	EX/FO	3a	Light	LI	8
Walls	EX/WA	3a	Elec Wiring	EW	8e
Roof	RO	3a	Floors	FL	3b
Porch	PO	3d	Walls	IN/WA	3b
Stairs	EX/SR	3d	Ceilings	CE	3c
Steps	SP	3c	Windows	IN/WI	3c
Doors	DO	3c	Airshafts	AS	3a
Windows	EX/WI	3a	Roof Rafters	ROR	4e
Eaves	EA	3a	Sanitation	SAN	3d
Trim	TR	3e	Stairways	IN/SRW	3d
Chimney	EX/CH	3a	Stair Tread	SRT	6d
Gutters	GU	3a	Wastelines	WSL	6c
Roof Drains	RD	3d	Supply Lines	SUL	3e
Bulkhead	BU	4e	Stacks	ST	3e
Outbuildings	GR - SH	4e	Flues	FU	3e
Yard	YA	4d	Vents	VE	3e
Garbage	GA	4d	Chimney	IN/Ch	9c
Rubbish	RU	4d	Heating Equip. Furnace - FU	Spaceheater - SPH	4b
Containers	CO	3a	Bsmt. Sanitation Litter - LI	Debris - DE	3a
Drainage	DR	4e	Dampness - DM		8c
Infestation	IN-CR-FL	4e	Lighting	BS/LI	8e
Rats	RA	4e	Elec. Panel	EL/PA	3d
Other		10	Stairs	BS/SR	3a
Fire Escape	FE	10	Foundation	IN/FO	3a
Dual Egress	DE		Floor Joists	FL/JO	3a
Driveways	DW		Carving Timbers	CA/TI	3a
Walks	WA		Sills	SI	5f
Fences	FN		Bsmt. D. U. Conforms	BDU	

Remarks on reverse side

