

THIS IS NOT A BOUNDARY SURVEY

This copyrighted document expires 03-05-18. Reproduction and/or dissemination after this date is unauthorized.

MORTGAGE INSPECTION OF: DEED BOOK 34009 PAGE 112 COUNTY Cumberland
PLAN BOOK 9 PAGE 121 LOT 78

ADDRESS: 76 Powsland Street, Portland, Maine

Job Number: 957-32

Inspection Date: 12-05-17

Scale: 1" = 20'

Client File #: Encore Powsland

Buyer: Encore Properties, LLC

Seller: E&B Ventures LLC

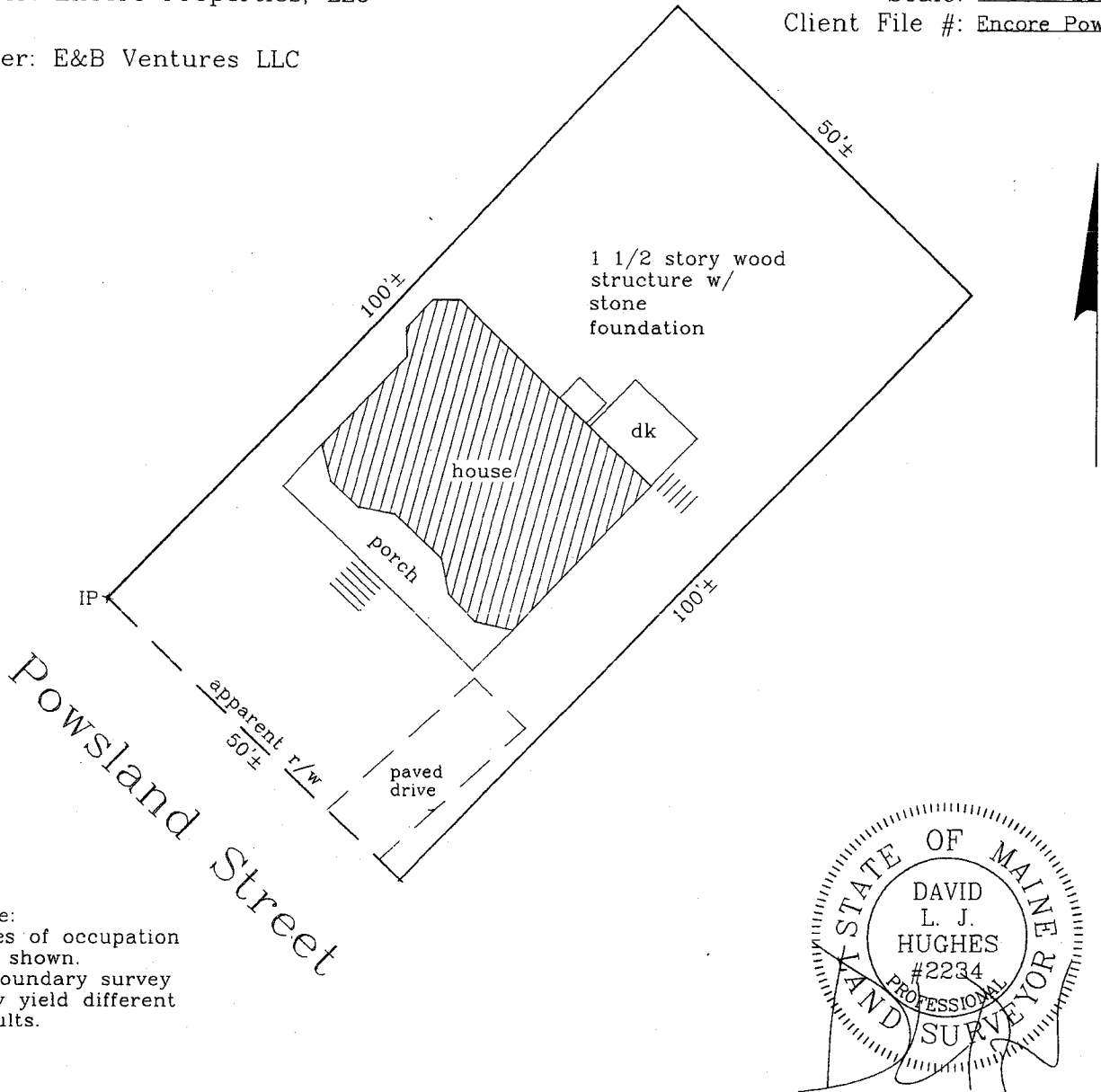

Note:
Lines of occupation
are shown.
A boundary survey
may yield different
results.

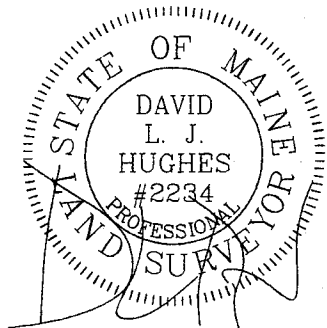

APPARENT EASEMENTS AND RIGHTS OF WAY ARE SHOWN. OTHER ENCUMBRANCES, RECORDED OR NOT, MAY EXIST. THIS SKETCH WILL NOT REVEAL ABUTTING DEED CONFLICTS, IF ANY.

I HEREBY CERTIFY TO: Paul W. Cadigan, Esq.; the Lender
and First American Title Insurance Co.

- Monuments found did not conflict with the deed description.
- The dwelling setbacks do not violate town zoning requirements.
- As delineated on the Federal Emergency Management Agency Community Panel 230051-0013 B :
- The structure does not fall within the special flood hazard zone.
- The land does not fall within the special flood hazard zone.
- A wetlands study has not been performed.

Livingston-Hughes
Professional Land Surveyors
88 Guinea Road
Kennebunkport, Maine 04046
207-967-9761 phone 207-967-4831 fax
www.livingstonhughes.com

THIS SKETCH IS FOR MORTGAGE PURPOSES ONLY