

City of Portland, Maine - Building or Use Permit Application
 389 Congress Street, 04101 Tel: (207) 874-8703, Fax: (207) 874-8716

PERMIT ISSUED

Permit No: 01-1360	Issue Date: 1 9 2001	CBL: 190 G002001
-----------------------	-------------------------	---------------------

Location of Construction: 1266 Congress St	Owner Name: Degrinney John P	Owner Address: 1266 Congress St CITY OF PORTLAND	Phone: 207-756-8557
Business Name: n/a	Contractor Name: Sign Solutions	Contractor Address: 75 Bishop St. Portland	Phone: 2078788000
Lessee/Buyer's Name n/a	Phone: n/a	Permit Type: Signs - Permanent	Zone: R-P

Past Use: Commercial / Office	Proposed Use: Commercial / Office; 29.6 sq. ft. sign	Permit Fee:	Cost of Work: \$0.00	CEO District: 3
Proposed Project Description: Install one 29.6 sq. ft. sign		FIRE DEPT: <input type="checkbox"/> Approved <input type="checkbox"/> Denied <i>N/A</i>	INSPECTION: Use Group: BOCA 1999 Type: Signature: T Munson	
		PEDESTRIAN ACTIVITIES DISTRICT (P.A.D.) Action: <input type="checkbox"/> Approved <input type="checkbox"/> Approved w/Conditions <input type="checkbox"/> Denied Signature: <i>N/A</i> Date:		

Permit Taken By: gg	Date Applied For: 11/01/2001	Zoning Approval		
------------------------	---------------------------------	------------------------	--	--

- This permit application does not preclude the Applicant(s) from meeting applicable State and Federal Rules.
- Building permits do not include plumbing, septic or electrical work.
- Building permits are void if work is not started within six (6) months of the date of issuance. False information may invalidate a building permit and stop all work..

Special Zone or Reviews <input type="checkbox"/> Shoreland <input type="checkbox"/> Wetland <input type="checkbox"/> Flood Zone <input type="checkbox"/> Subdivision <input type="checkbox"/> Site Plan Maj <input type="checkbox"/> Minor <input checked="" type="checkbox"/> MM <input type="checkbox"/> Date: <i>11/15/01</i>	Zoning Appeal <input type="checkbox"/> Variance <input type="checkbox"/> Miscellaneous <input type="checkbox"/> Conditional Use <input type="checkbox"/> Interpretation <input type="checkbox"/> Approved <input type="checkbox"/> Denied Date:	Historic Preservation <input checked="" type="checkbox"/> Not in District or Landmark <input type="checkbox"/> Does Not Require Review <input type="checkbox"/> Requires Review <input type="checkbox"/> Approved <input type="checkbox"/> Approved w/Conditions <input type="checkbox"/> Denied Date:
--	---	--

CERTIFICATION

I hereby certify that I am the owner of record of the named property, or that the proposed work is authorized by the owner of record and that I have been authorized by the owner to make this application as his authorized agent and I agree to conform to all applicable laws of this jurisdiction. In addition, if a permit for work described in the application is issued, I certify that the code official's authorized representative shall have the authority to enter all areas covered by such permit at any reasonable hour to enforce the provision of the code(s) applicable to such permit.

SIGNATURE OF APPLICANT _____ ADDRESS _____ DATE _____ PHONE _____

RESPONSIBLE PERSON IN CHARGE OF WORK, TITLE _____ DATE _____ PHONE _____

27726

THIS IS NOT A PERMIT/CONSTRUCTION MAY NOT COMMENCE UNTIL THE PERMIT IS ISSUED

SIGNAGE APPLICATION

THIS IS NOT A PERMIT
CONSTRUCTION CANNOT NOT COMMENCE UNTIL THE PERMIT IS ISSUED

In the interest of processing your application in the quickest possible manner, please complete the Information below for a Building or Use Permit.

If you or the property owner owes real estate or personal property taxes or user charges on any property within the City, payment arrangements must be made before permits of any kind are accepted.

Location/Address of Construction: 1266 CONGRESS ST., PORTLAND, ME 04102

Total Square Footage of Proposed Structure 29.6 <input checked="" type="checkbox"/>	Square Footage of Lot 8580.0 <input checked="" type="checkbox"/>
--	---

Tax Assessor's Chart, Block & Lot Number Chart# 190 Block# 6 Lot# 000	Owner: ATTY JOHN P. DEGRINNEY 1266 CONGRESS ST. PORTLAND, ME 04102	Telephone #: 756-8557
--	---	--------------------------

Lessee/Buyer's Name (If Applicable)	Owner's/Purchaser/Lessee Address:	Total s.f of signs 29.6 x .20 \$ 5.92, plus \$30.00 TOTAL \$ 35.92
-------------------------------------	-----------------------------------	---

Current use: BUSINESS/OFFICE Proposed use: BUSINESS/OFFICE

Project description:
INSTALL ONE (1) BUSINESS IDENTIFICATION SIGN

Applicants Name, Address & Telephone: ATTY. JOHN PAUL DEGRINNEY
1266 CONGRESS ST., PORTLAND, ME 04102
207-756-8557

Contractor's Name, Address & Telephone: SIGN SOLUTIONS
75 BISHOP ST., PORTLAND, ME 04103
207-878-8000

Who shall we contact when the permit is ready: EVERETT H. BROWN
Telephone: 878-8000 EXT 256

If you would like it mailed, what mailing address should we use:
I WILL PICK IT UP,

DEPT OF
NOV - 1 2001
Rec'd By: *[Signature]*

THIS IS NOT A PERMIT/CONSTRUCTION MAY NOT COMMENCE UNTIL THE PERMIT IS ISSUED

If the property is located in a HISTORIC DISTRICT, a separate sketch is required indicating the design, dimensions, construction materials and source of illumination if any. A photograph of the building façade should be submitted, showing where each sign is to be installed.

Certification

I hereby certify that I am the Owner of record of the named property, or that the owner of record authorizes the proposed work and that I have been authorized by the owner to make this application as his/her authorized agent. I agree to conform to all applicable laws of this jurisdiction. In addition, if a permit for work described in this application is issued, I certify that the Code Official's authorized representative shall have the authority to enter all areas covered by this permit at any reasonable hour to enforce the provisions of the codes applicable to this permit.

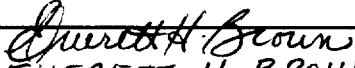
Signature of applicant:  EVERETT H. BROWN	Date: 1 NOV 2001
---	------------------

Sign Permit Fee: \$30.00 plus \$0.20 per square foot.

A building permit is also required for any awning based on cost of work-\$30.00 for the first \$1,000.00 and \$6.00 for each additional \$1,000.00

BY FILLING OUT THIS APPLICATION IS DOES NOT MEET THAT YOU WILL BE APPROVED FOR THE AMOUNT OF SIGNAGE YOU ARE APPLYING FOR

IT IS SUGGESTED THAT YOU DO NOT ORDER ANY SIGNAGE UNTIL YOU HAVE RECEIVED YOUR SIGN PERMIT THAT HAS BEEN SIGNED BY THE BUILDING, ZONING AND POSSIBLE HISTORICAL OFFICIALS OF THIS OFFICE

SIGNAGE PRE-APPLICATION

PLEASE ANSWER ALL QUESTIONS

ADDRESS: 1266 CONGRESS STREET ZONE: _____

OWNER: ATTY. JOHN PAUL DEGRINNEY

APPLICANT: SIGN SOLUTIONS

ASSESSOR NO. _____

PLEASE CIRCLE APPROPRIATE ANSWER

please see bottom

SINGLE TENANT LOT? YES NO MULTI-TENANT LOT? YES NO

FREESTANDING SIGN? (ex. Pole Sign) YES NO -- DIMENSIONS 54 1/2" x 66" HEIGHT 96"

MORE THAN ONE SIGN? YES NO DIMENSIONS _____ HEIGHT _____

SIGN ATTACHED TO BLDG.? YES NO DIMENSIONS _____

MORE THAN ONE SIGN? YES NO DIMENSIONS _____

AWNING: YES NO IS AWNING BACKLIT? YES NO HEIGHT OFF SIDEWALK _____

IS THERE ANY MESSAGE, TRADEMARK OR SYMBOL ON IT? _____

LIST ALL EXISTING SIGNAGE AND THEIR DIMENSIONS:

*** TENANT BLDG. FRONTAGE (IN FEET): 26'-3"

*** REQUIRED INFORMATION

AREA FOR COMPUTATION

(Allowed) ~~only free standing signs allowed~~
shown

max # 30 max - 29, 32 *shown*
 height 8' max 8' *shown*
 setback - owner lot provision -

two tenants, only one tenant has signage at this time

? 2 signs are shown

YOU SHALL PROVIDE:

A SITE SKETCH AND BUILDING SKETCH SHOWING EXACTLY WHERE EXISTING AND NEW SIGNAGE IS LOCATED MUST BE PROVIDED. SKETCHES AND/OR PICTURES OF PROPOSED ARE ALSO REQUIRED.

SIGNATURE OF APPLICANT: *John H. Brown*

DATE: 1 NOV 01

AMENDMENT TO PORTLAND CITY CODE
§§ 14-426 and 14-434 (LAND USE)
RE: FENCES AND CORNER CLEARANCE

*in effect
4/97*

BE IT ORDAINED BY THE CITY COUNCIL OF THE CITY OF PORTLAND, MAINE
IN CITY COUNCIL ASSEMBLED AS FOLLOWS:

That Sections 14-426 and 14-434 of the Portland City Code are
hereby amended to read as follows:

Sec. 14-426. Fences.

*curb line - definition
see*

In residence zones no wall or fence along a street line or
within twenty-five (25) feet of a street line shall be more than
four (4) feet in height unless said fence is located in the side or
rear yard and is reviewed by the public works authority and found
not to be a traffic or public safety hazard, subject to the
provisions of section 14-434.

Sec. 14-434. Corner clearance.

No obstruction higher than three and one-half (3½) feet above the lowest elevation at the
curbline shall be permitted on a corner lot within the area of a triangle formed by a line
intersecting the street lines of the intersecting streets at points twenty-five (25) feet from the
corner, unless said obstruction is located in the side or rear yard and is reviewed by the public
works authority and found not to be a traffic or public safety hazard. For the purpose of this
section, the word "obstruction" shall mean any shrub, wall, fence, temporary building, sign, a
pile of material, but shall not include permanent buildings or structures where permitted
elsewhere in this article.

(Code 1968, § 602.19.M; Ord. No. 247-97, 4-9-97)

1" = 30'

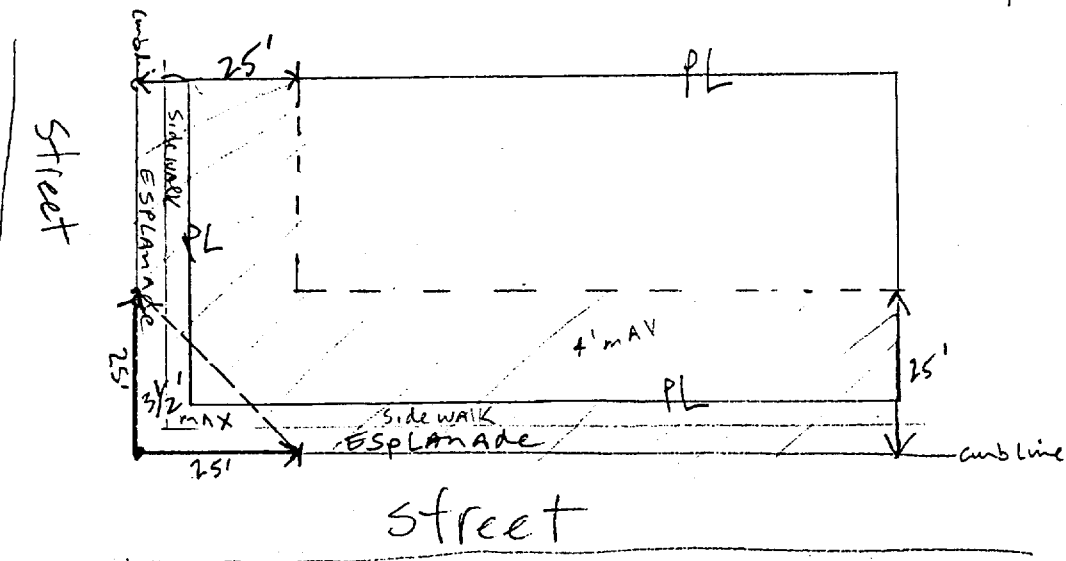

Application ID Number: 1-1360

Department: Zoning

Status: Approved with Conditions

Officer: Marge Schmuckal

Comments: 1266 Congress St.

Approval Date: 11/15/2001

Issue Date: 11/05/2001

OK to Issue Permit

Name: Marge Schmuckal

Date: 11/15/2001

Page: 1

Per my conversations with Everett on 11/15/01, it is understood that this sign will be place OUTSIDE of the corner 25 foot triangle provision of section 14-426. It is also my understanding that you have already spray painting the ground showing where this 25 foot triangle is located.

Create Date: 11/05/2001

By: gg

Update Date: 11/15/2001

By: mes

ACORD CERTIFICATE OF LIABILITY INSURANCE

DATE (MM/DD/YY)
10/31/2001

PRODUCER
C.P. Curtis Insurance Agency
P.O. Box 129
Bowdoinham, Maine 04008

INSURED
Printmail of Maine &
Sigo Solutions
75 Bishop Street
Portland, ME 04103

THIS CERTIFICATE IS ISSUED AS A MATTER OF INFORMATION ONLY AND CONFERS NO RIGHTS UPON THE CERTIFICATE HOLDER. THIS CERTIFICATE DOES NOT AMEND, EXTEND OR ALTER THE COVERAGE AFFORDED BY THE POLICIES BELOW.

INSURERS AFFORDING COVERAGE

INSURER A: The Hanover Insurance Company
INSURER B:
INSURER C:
INSURER D:
INSURER E:

COVERAGES

THE POLICIES OF INSURANCE LISTED BELOW HAVE BEEN ISSUED TO THE INSURED NAMED ABOVE FOR THE POLICY PERIOD INDICATED. NOTWITHSTANDING ANY REQUIREMENT, TERM OR CONDITION OF ANY CONTRACT OR OTHER DOCUMENT WITH RESPECT TO WHICH THIS CERTIFICATE MAY BE ISSUED OR MAY PERTAIN, THE INSURANCE AFFORDED BY THE POLICIES DESCRIBED HEREIN IS SUBJECT TO ALL THE TERMS, EXCLUSIONS AND CONDITIONS OF SUCH POLICIES. AGGREGATE LIMITS SHOWN MAY HAVE BEEN REDUCED BY PAID CLAIMS.

INSR LTR	TYPE OF INSURANCE	POLICY NUMBER	POLICY EFFECTIVE DATE (MM/DD/YY)	POLICY EXPIRATION DATE (MM/DD/YY)	LIMITS
A	GENERAL LIABILITY <input checked="" type="checkbox"/> COMMERCIAL GENERAL LIABILITY <input type="checkbox"/> CLAIMS MADE <input checked="" type="checkbox"/> OCCUR GEN'L AGGREGATE LIMIT APPLIES PER: <input type="checkbox"/> POLICY <input type="checkbox"/> PROJECT <input type="checkbox"/> LOC	OHP5130124	07/16/01	07/16/02	EACH OCCURRENCE \$1,000,000
					FIRE DAMAGE (Any one fire) \$ 300,000
					MED EXP (Any one person) \$ 15,000
					PERSONAL & ADV INJURY \$1,000,000
					GENERAL AGGREGATE \$2,000,000
					PRODUCTS - COMP/OP AGG \$2,000,000
A	AUTOMOBILE LIABILITY <input type="checkbox"/> ANY AUTO <input type="checkbox"/> ALL OWNED AUTOS <input checked="" type="checkbox"/> SCHEDULED AUTOS <input checked="" type="checkbox"/> HIRED AUTOS <input checked="" type="checkbox"/> NON-OWNED AUTOS	ABP5146029	06/29/01	06/29/02	COMBINED SINGLE LIMIT (EA accident) \$1,000,000
					BODILY INJURY (Per person) \$
					BODILY INJURY (Per accident) \$
					PROPERTY DAMAGE (Per accident) \$
	GARAGE LIABILITY <input type="checkbox"/> ANY AUTO				AUTO ONLY - EA ACCIDENT \$
					OTHER THAN AUTO ONLY: EA ACC \$
	EXCESS LIABILITY <input type="checkbox"/> OCCUR <input type="checkbox"/> CLAIMS MADE DEDUCTIBLE RETENTION \$				EACH OCCURRENCE \$
					AGGREGATE \$
					\$
					\$
					\$
A	WORKERS COMPENSATION AND EMPLOYERS' LIABILITY	WDP5146030	07/20/01	07/20/02	WC STATUTORY LIMITS OTH-ER
					E.L. EACH ACCIDENT \$ 500,000
					E.L. DISEASE - EA EMPLOYEE \$ 500,000
					E.L. DISEASE - POLICY LIMIT \$ 500,000
	OTHER				

DESCRIPTION OF OPERATIONS/LOCATIONS/VEHICLES/EXCLUSIONS ADDED BY ENDORSEMENT/SPECIAL PROVISIONS

Commercial Printing and Signage in the State of Maine
Adding the City of Portland as additional insured too.

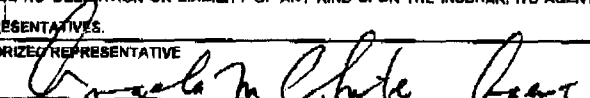
CERTIFICATE HOLDER	ADDITIONAL INSURED; INSURER LETTER:	CANCELLATION
DeGrinney Law Office 1266/68 Congress Street Portland, Maine 04101		SHOULD ANY OF THE ABOVE DESCRIBED POLICIES BE CANCELLED BEFORE THE EXPIRATION DATE THEREOF, THE ISSUING INSURER WILL ENDEAVOR TO MAIL 10 DAYS WRITTEN NOTICE TO THE CERTIFICATE HOLDER NAMED TO THE LEFT, BUT FAILURE TO DO SO SHALL IMPOSE NO OBLIGATION OR LIABILITY OF ANY KIND UPON THE INSURER, ITS AGENTS OR REPRESENTATIVES. AUTHORIZED REPRESENTATIVE 

Law Offices of
John Paul DeGrinney
Attorney at Law

1266 Congress Street
Portland, Maine 04102
(207) 756-8557

October 29, 2001

VIA FAX

Sign Solutions
C/o Everett Brown
75 Bishop Rd.
Portland, ME 04103

RE: Sign Permit

Dear Everett,

This letter is to inform you that Sign Solutions is permitted to build and put up signage at 1266 Congress Street, Portland, Maine.

Respectfully,

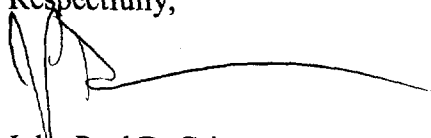
A handwritten signature in black ink, appearing to read 'John Paul DeGrinney', with a long horizontal flourish extending to the right.

John Paul DeGrinney
Attorney at Law

JPD/jjj



Underwriters Laboratories Inc.®

MFR'S PROC
1285 Walt Whitman Road
Melville, New York 11747-3081
(516) 271-6200
FAX No. (516) 271-8259/8260
MCI Mail No. 255-3315
Telex No. 6852015



File E167560

Vol 1

Issued 03/29/95
Revised

FOLLOW-UP SERVICE PROCEDURE
(TYPE L)

SIGNS
(UXYT)

Manufacturer: PRINTMAIL OF MAINE SIGN
(126429-001) 34 DIAMOND ST
PORTLAND ME 04101
Applicant: SAME AS MANUFACTURER
(126429-001)
Listee: SAME AS MANUFACTURER
(126429-001)

This Procedure authorizes the above Manufacturer to use the marking specified by Underwriters Laboratories Inc. only on products covered by this Procedure, in accordance with the applicable Follow-Up Service Agreement.

The prescribed Mark or Marking shall be used only at the above manufacturing location on such products which comply with this Procedure and any other applicable requirements.

The Procedure contains information for the use of the above named Manufacturer and representatives of Underwriters Laboratories Inc. and is not to be used for any other purpose. It is lent to the Manufacturer with the understanding that it is not to be copied, either wholly or in part, and that it will be returned to Underwriters Laboratories Inc. upon request.

This PROCEDURE, and any subsequent revisions, is the property of UNDERWRITERS LABORATORIES INC. and is not transferable.

UNDERWRITERS LABORATORIES INC.

le
vices

N

UL # BS 522940

BS

522940

