

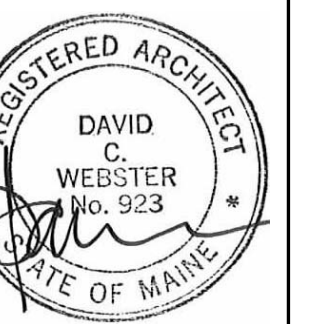

49 DARTMOUTH STREET
 PORTLAND, MAINE 04101
 207-775-1059
 www.pdtarchs.com

COPYRIGHT 2013
 PDT Architects
 Reuse or reproduction of the
 contents of this document is not
 permitted without written
 permission of PDT Architects.

E. M. G.-PHASE 2-ADDITION & RENOVATION
 53 Sewall Street, Portland, ME 04102



JOB NO.
12084

DRWN. CHK
AJK

SCALE:
1/4" = 1'-0"

ISSUE
July 11, 2013

TITLE
Demolition Plan A

SHEET
D100.A

| Demolition Keynote Legend | |
|---------------------------|------------------------------------------------------------------------------------------------------|
| Key Value | Keynote Text |
| 02.C1 | Ceiling To Be Removed, Including All Trim, Furring, Lathe, and Associated Items |
| 02.D2 | Door And Frame To Be Removed |
| 02.F1 | Flooring To Be Removed to Slab or Subfloor, Including All Trim, Base, Sleepers, and Associated Items |
| 02.M1 | Casework To Be Removed |
| 02.W1 | Wall To Be Removed, Including All Associated Finishes and Trim |
| 02.W3 | Window And Frame To Be Removed |

COORDINATE EXTENT OF DEMOLITION WITH ALL ADJACENT NEW CONSTRUCTION.

COORDINATE EXTENT OF DEMOLITION SHOWN ON THIS SHEET WITH DEMOLITION ELEVATIONS ON SHEET D101.

EXISTING EXTERIOR WALL DEMOLITION INCLUDES, BUT IS NOT LIMITED TO, GYPSUM WALL BOARD, VAPOR BARRIER, METAL STUDS, INSULATION, SHEATHING, BRICK VENEER, WINDOWS, DOORS, AND OTHER ASSOCIATED ITEMS

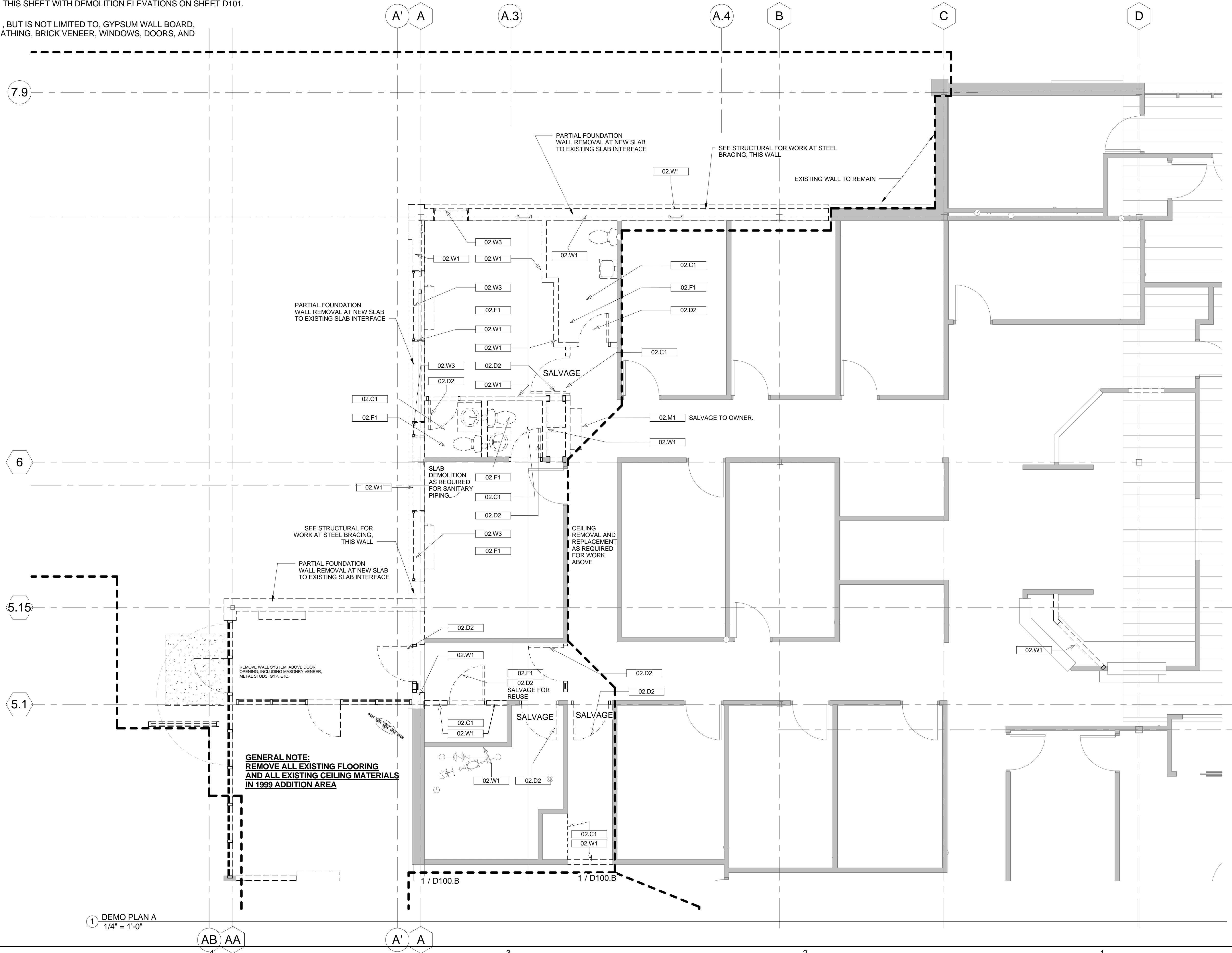

**GENERAL NOTE:
 REMOVE ALL EXISTING FLOORING
 AND ALL EXISTING CEILING MATERIALS
 IN 1999 ADDITION AREA**

1 DEMO PLAN A
 1/4" = 1'-0"