

ROOF GENERAL NOTES

1. Provide walkway protection strips 2 feet wide fully around all roof top mechanical unit(s).
2. Protect all openings cut in the existing roof. Provide temporary roofing if work is to be unfinished during adverse weather conditions.
3. Provide flashing at all roof penetrations, whether shown on the roof plan or not, unless noted otherwise. Refer to Structural, Mechanical and electrical plans for number, location, and size of penetrations. Not all items penetrating the roof are shown.

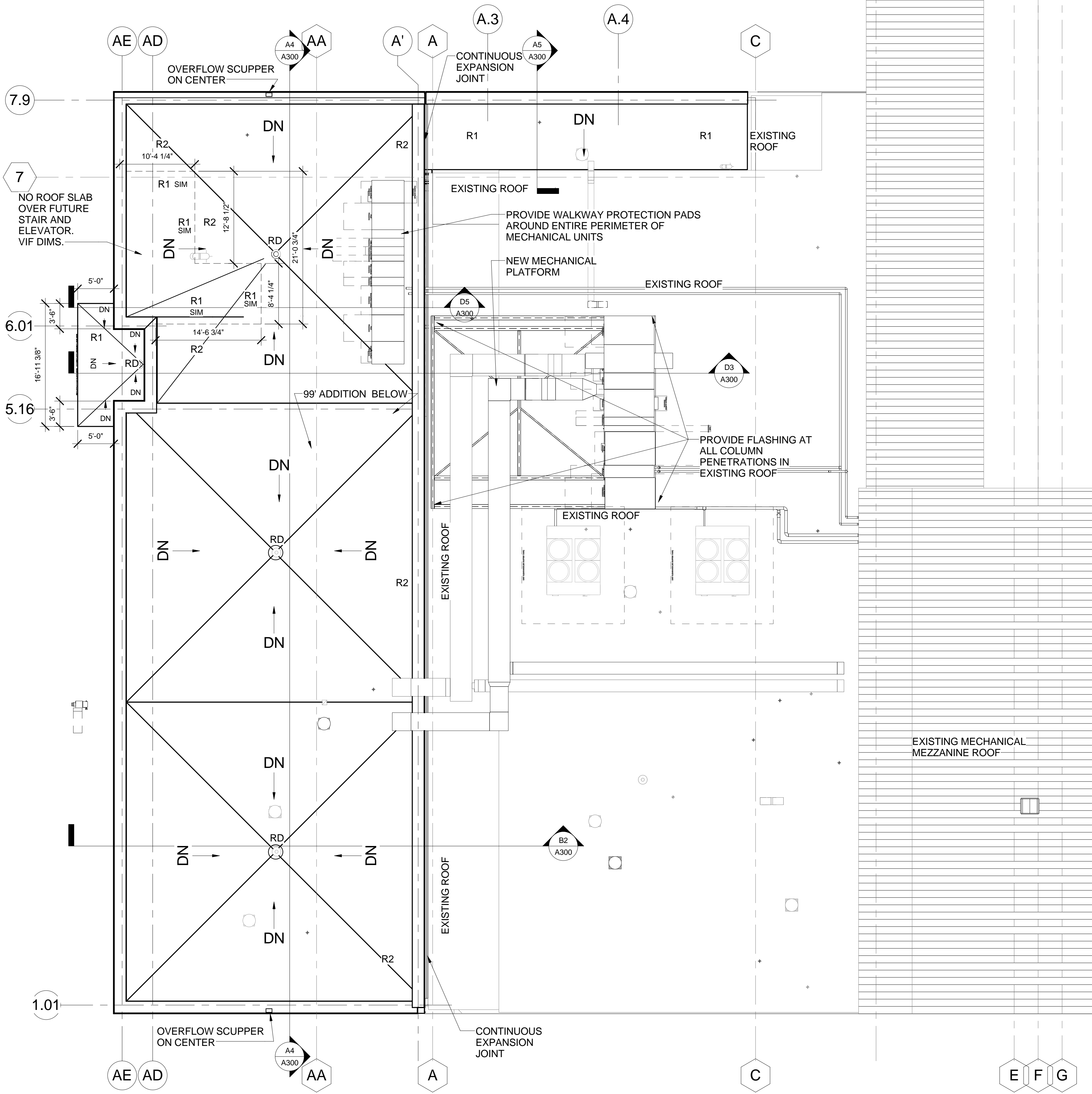

A2 Roof Plan
1/8" = 1'-0"



49 DARTMOUTH STREET
PORTLAND, MAINE 04101
207-775-1059
www.pdtarch.com

COPYRIGHT 2013
PDT Architects
Reuse or reproduction of the contents of this document is not permitted without written permission of PDT Architects.

E. M. G.-PHASE 2-ADDITION & RENOVATION
53 Sewall Street, Portland, ME 04102

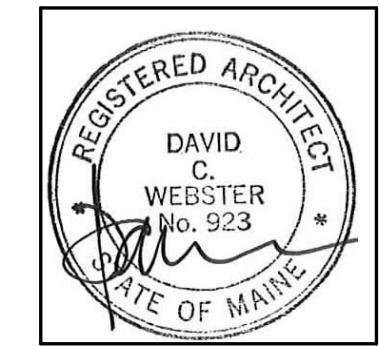

JOB NO.
12084

DRWN. CHK
AJK

SCALE:
1/8" = 1'-0"

ISSUE
July 11, 2013

TITLE
ROOF PLAN & DETAILS

SHEET
A102.A