

9 DTL. THROUGH RECEPTION OPENING - LOBBY 100
A-702 SCALE: 1 1/2" = 1'-0"

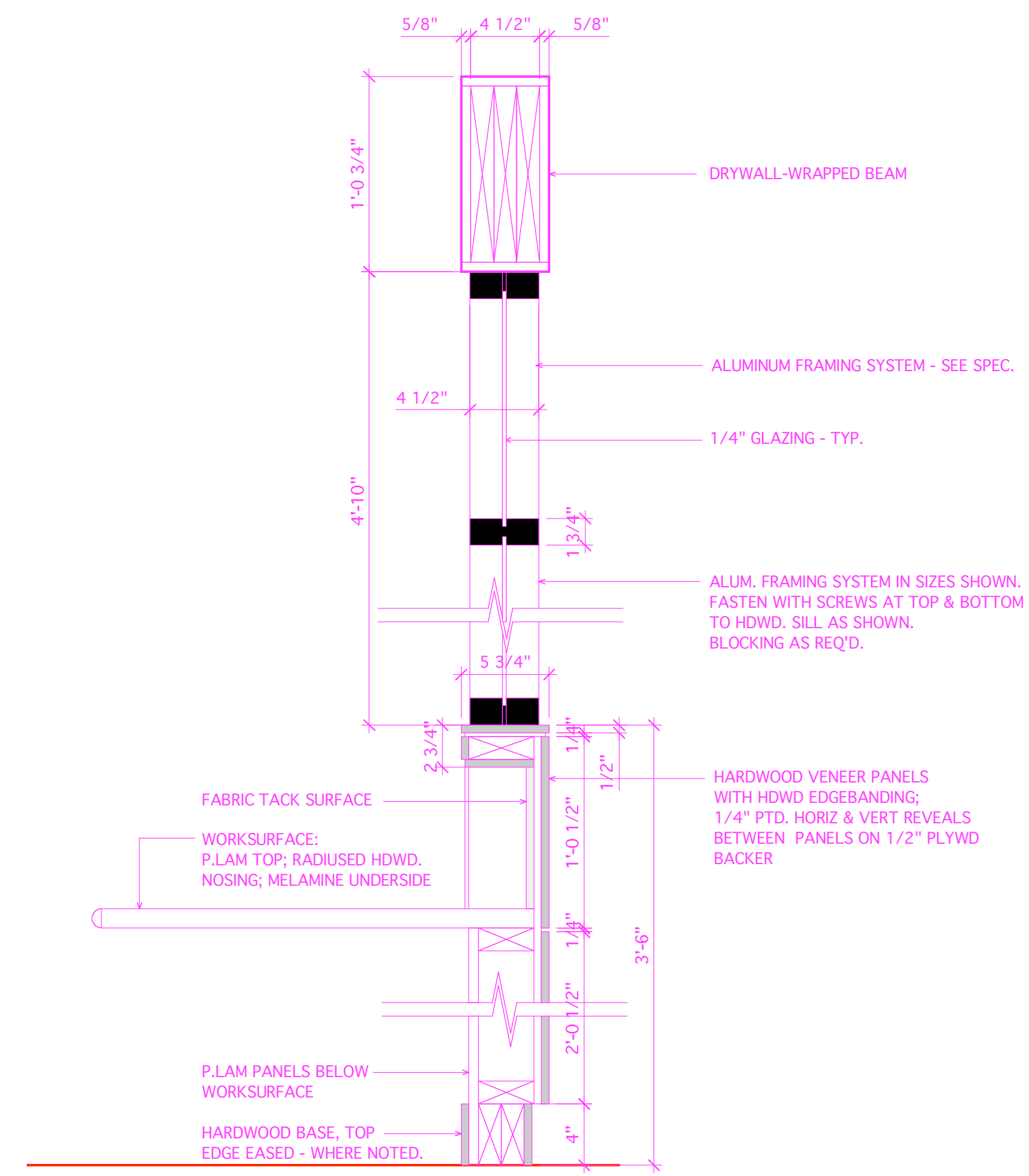

10 DTL. @ GWB-WRAPPED VERTICAL SUPPORT - LOBBY 100
A-702 SCALE: 1 1/2" = 1'-0"

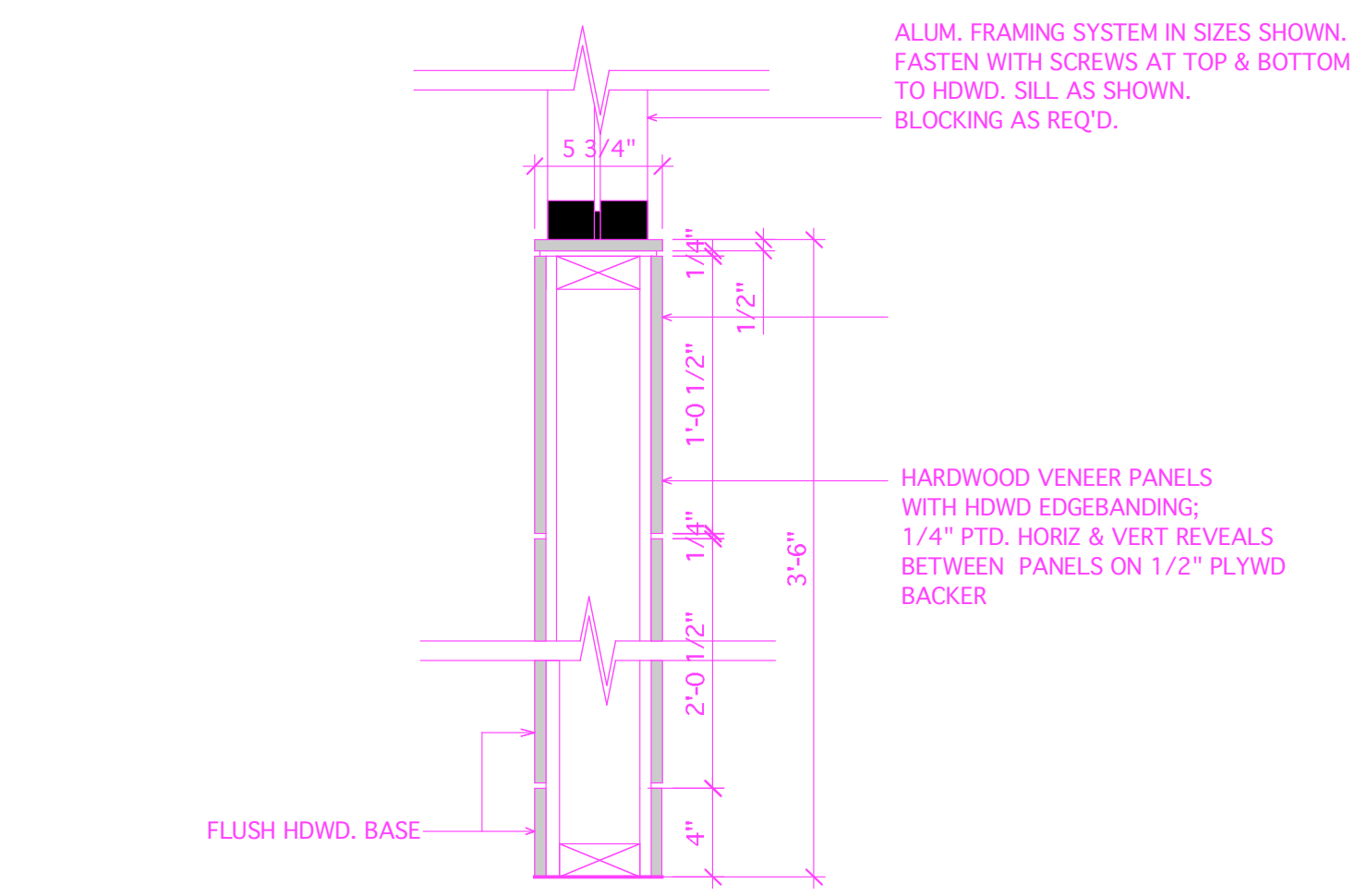

8 DTL. @ VENEER paneled WALL - LOBBY 100
A-702 SCALE: 1 1/2" = 1'-0"

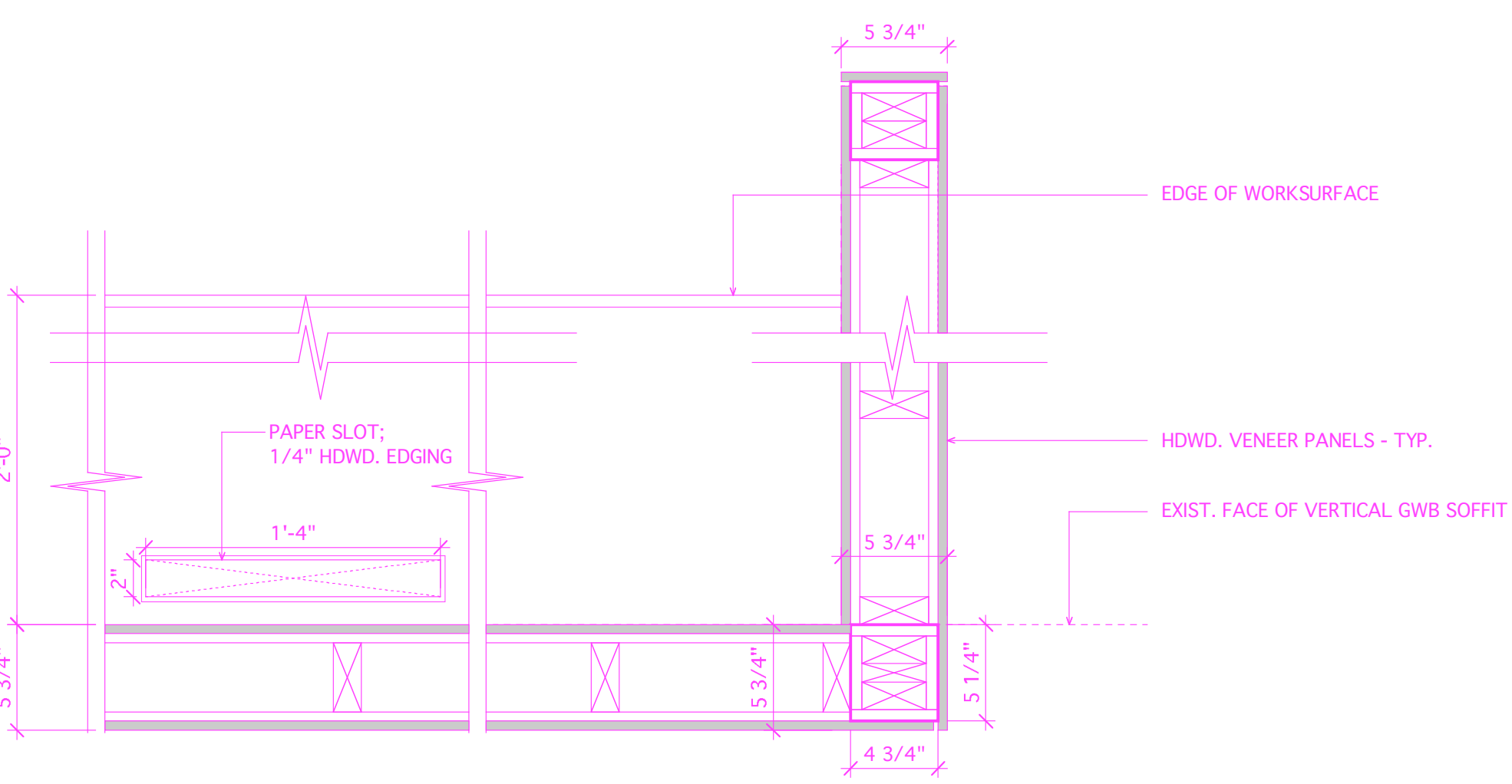

11 PLAN DTL. @ PANELING / COPIER COUNTER - LOBBY 100
A-702 SCALE: 1 1/2" = 1'-0"

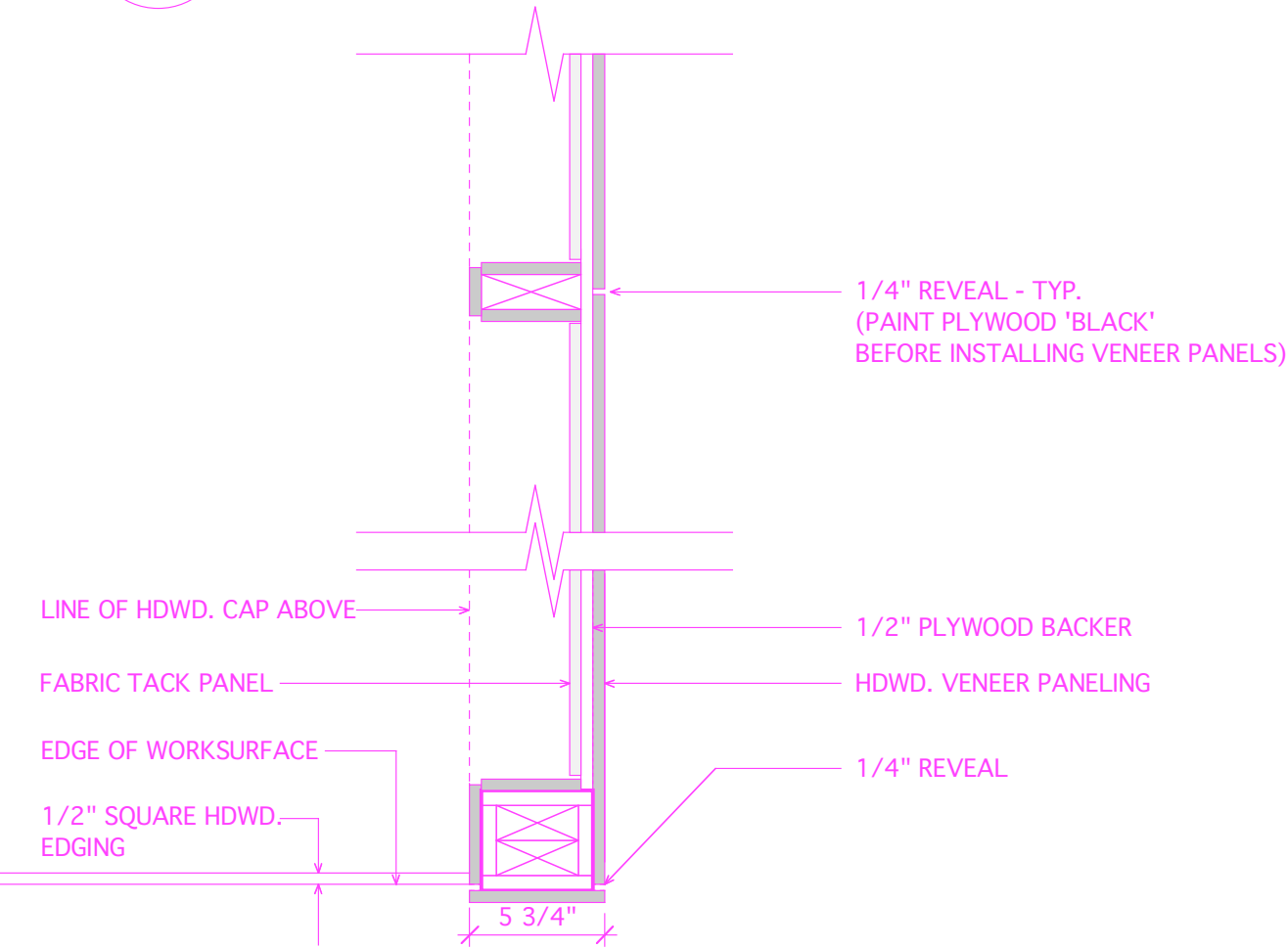

7 DTL. @ GWB-WRAPPED VERTICAL SUPPORT - LOBBY 100
A-702 SCALE: 1 1/2" = 1'-0"

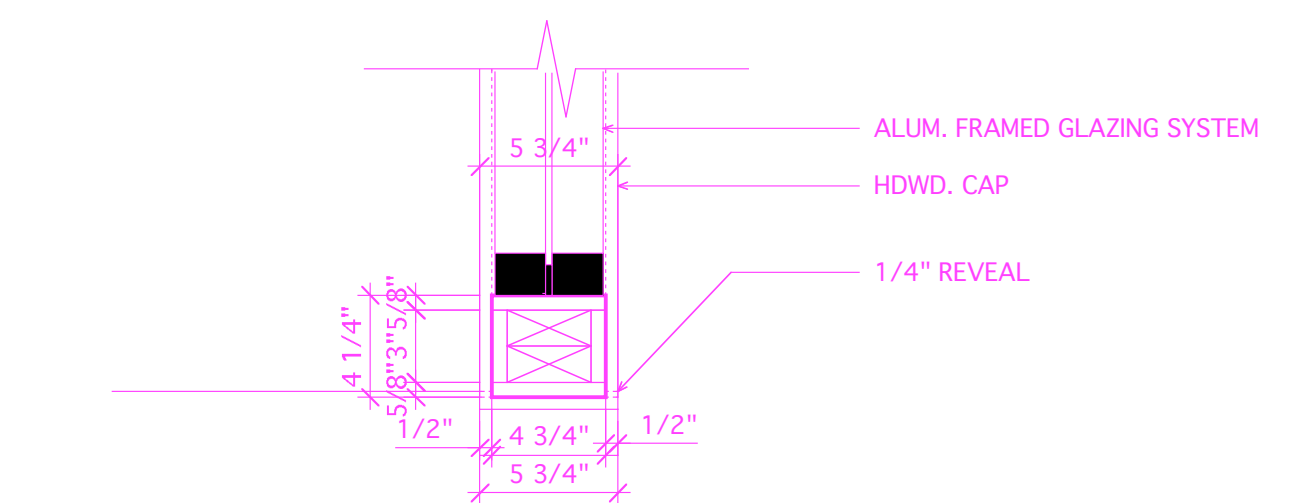

6 DTL. @ GWB-WRAPPED VERTICAL SUPPORT - LOBBY 100
A-702 SCALE: 1 1/2" = 1'-0"

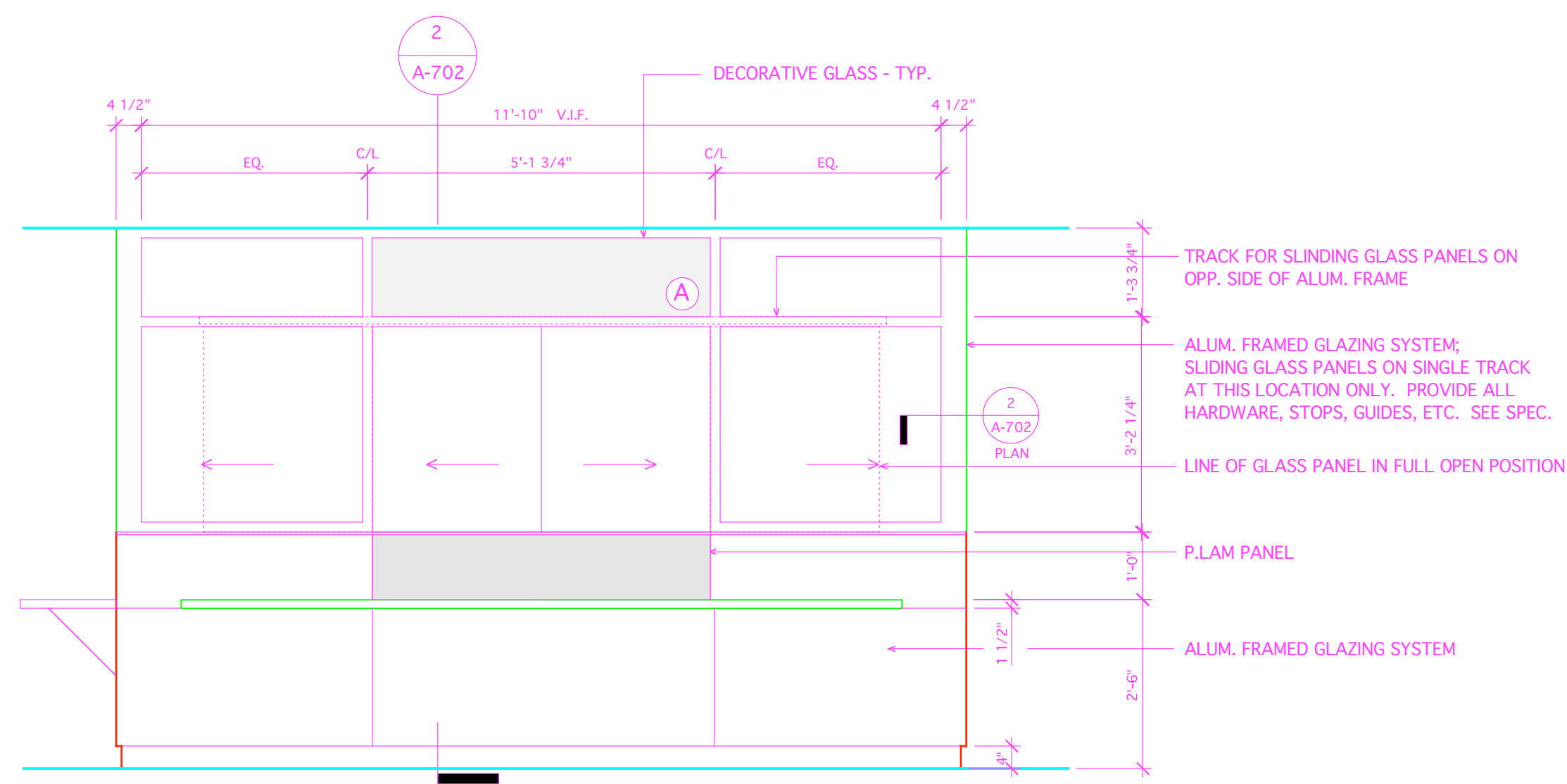

5 ELEVATION OF GLASS WALL/COUNTER @ P.T. RECEPTION 162
A-702 SCALE: 1/2" = 1'-0"

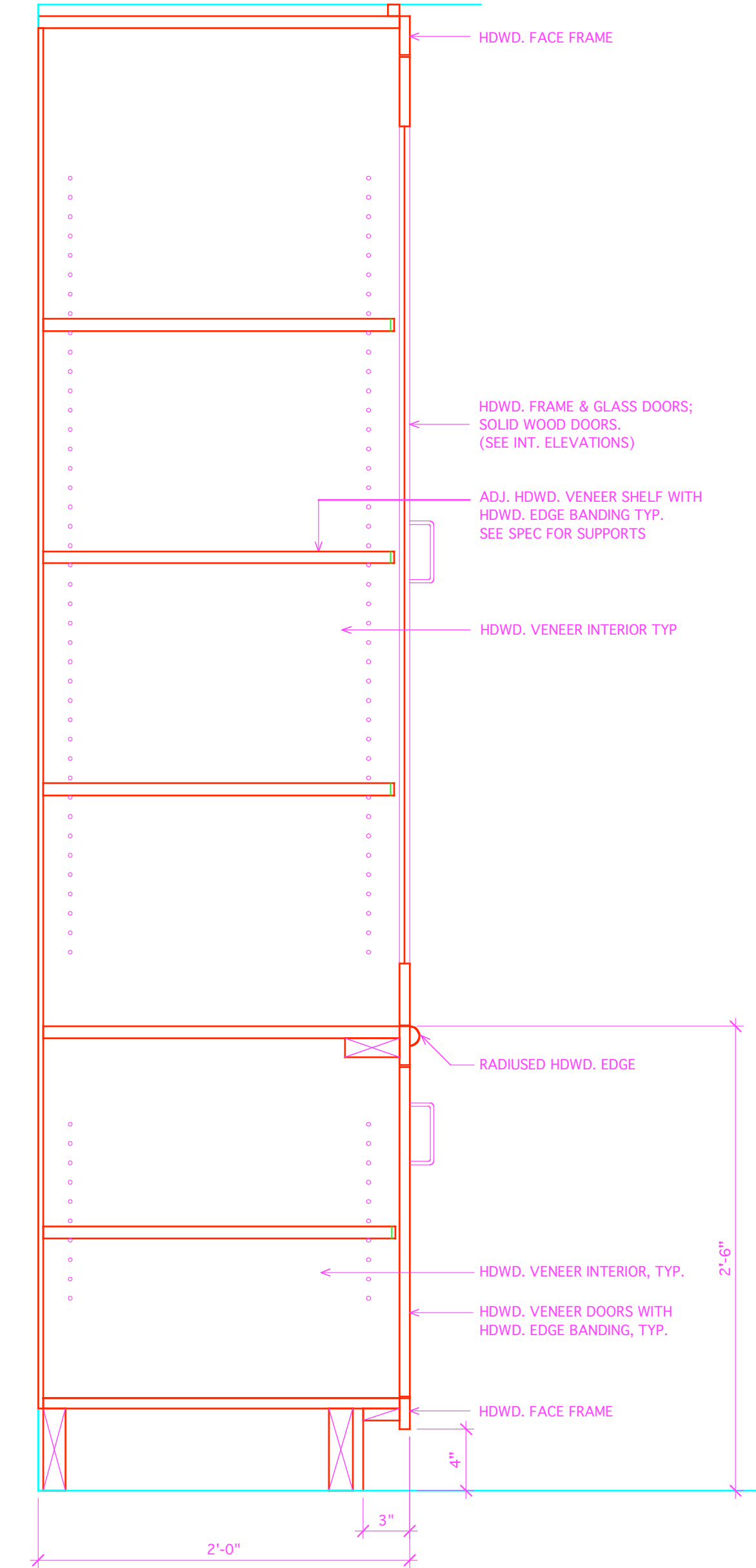

4 CABINET @ LIBRARY 225
A-702 SCALE: 1 1/2" = 1'-0"

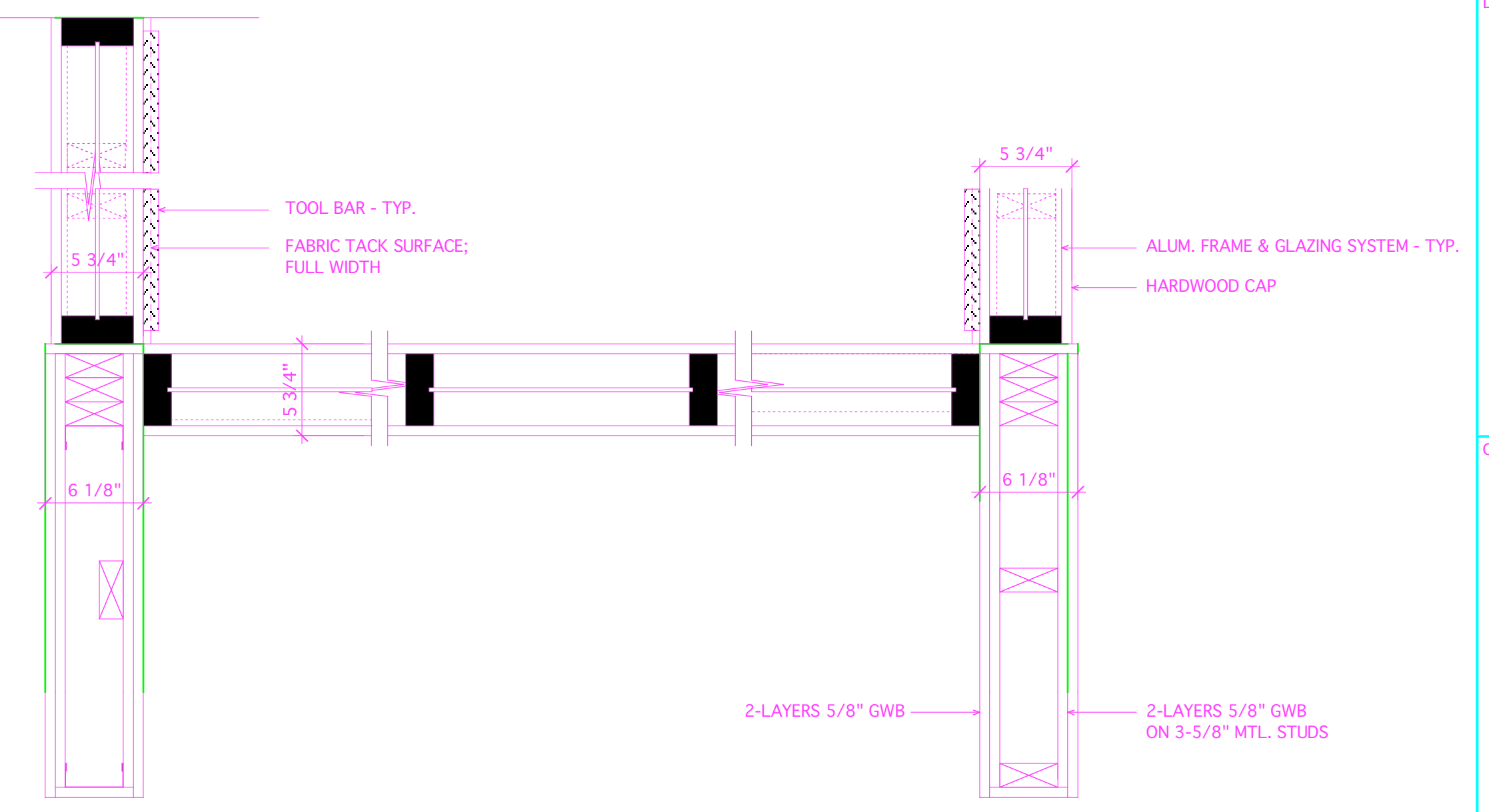

12 DTL. @ GWB-WRAPPED VERTICAL SUPPORT - LOBBY 100
A-702 SCALE: 1 1/2" = 1'-0"

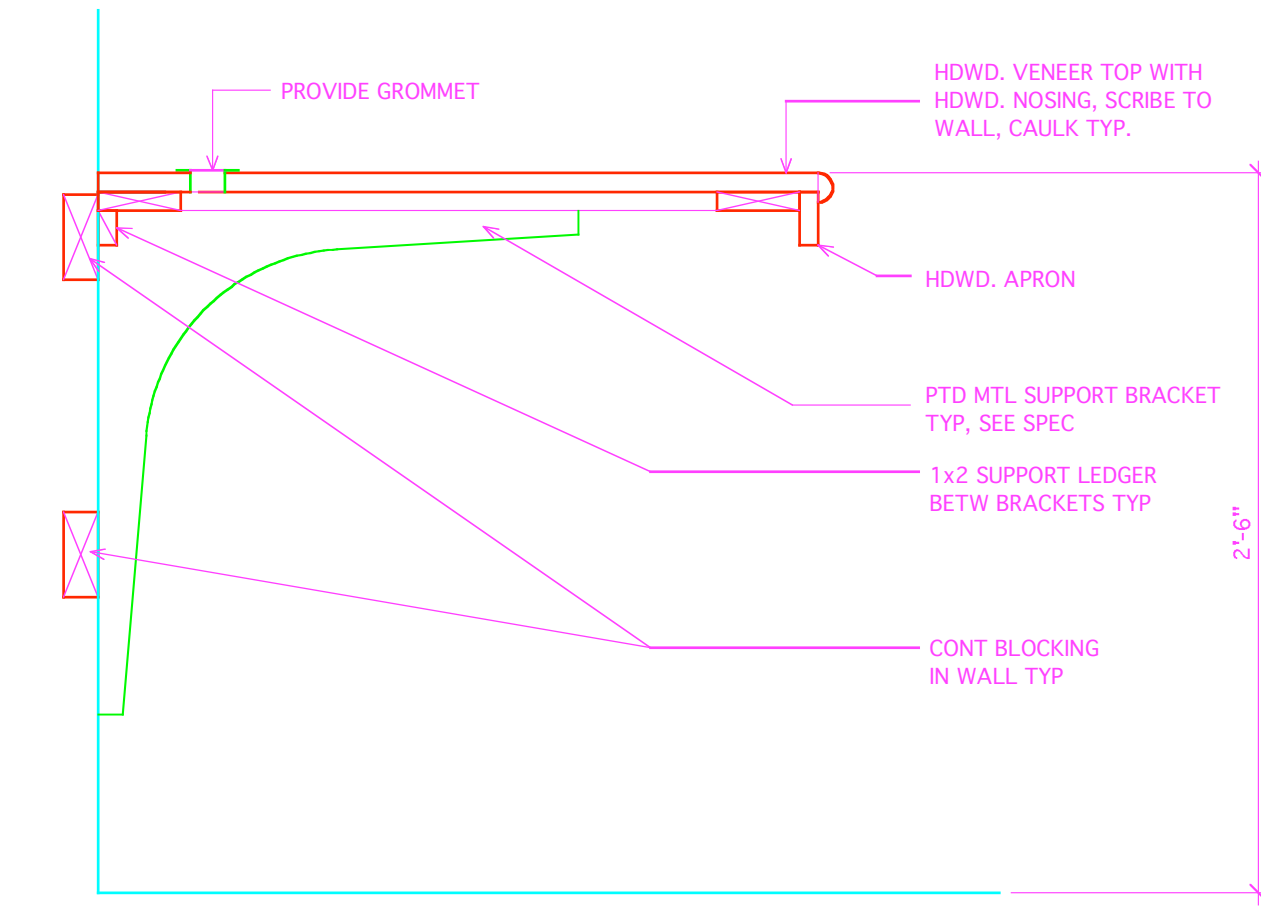

3 COMPUTER COUNTER @ LIBRARY 225
A-702 SCALE: 1 1/2" = 1'-0"

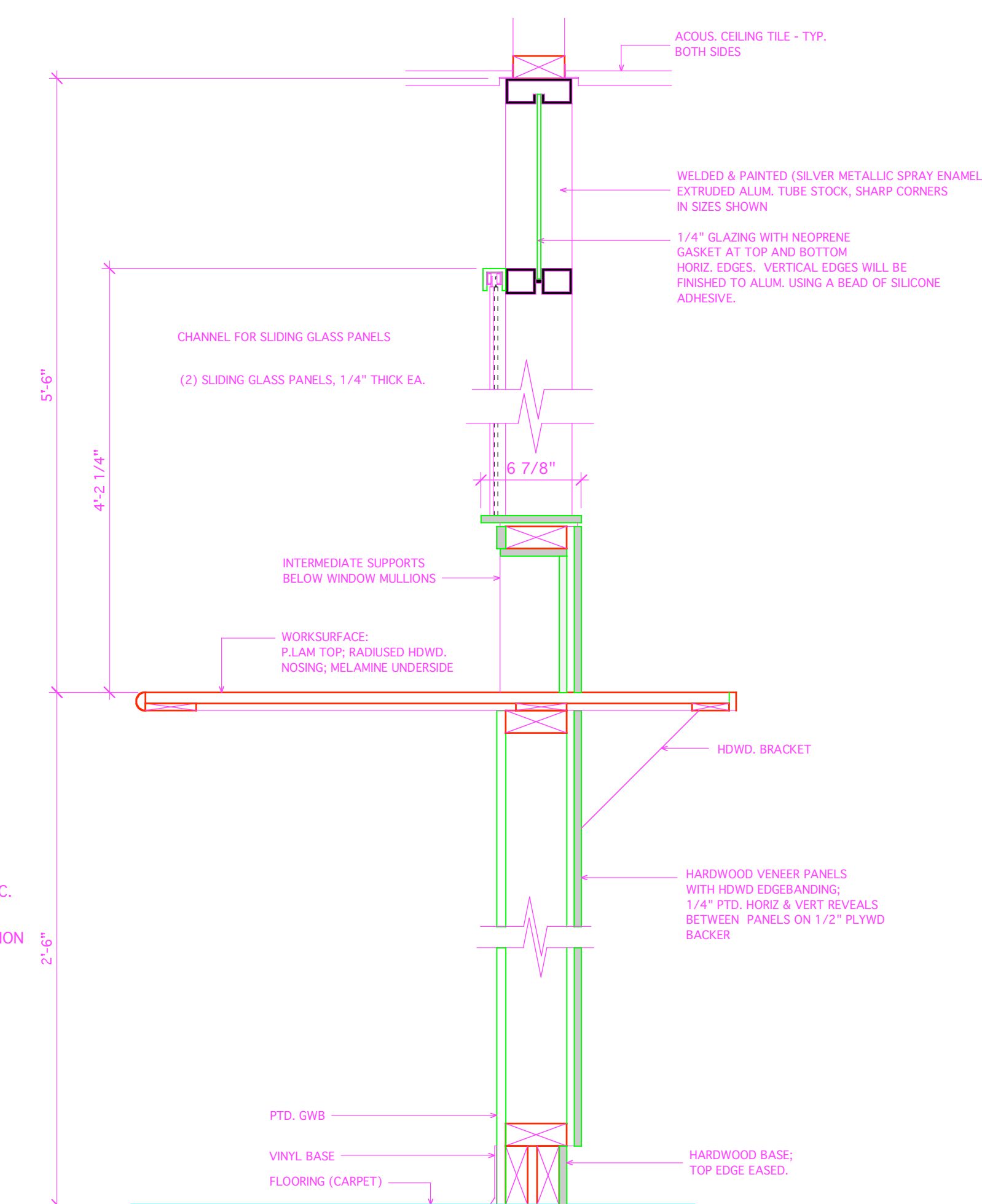

2 SECTION @ P.T. RECEPTION 162
A-702 SCALE: 1 1/2" = 1'-0"

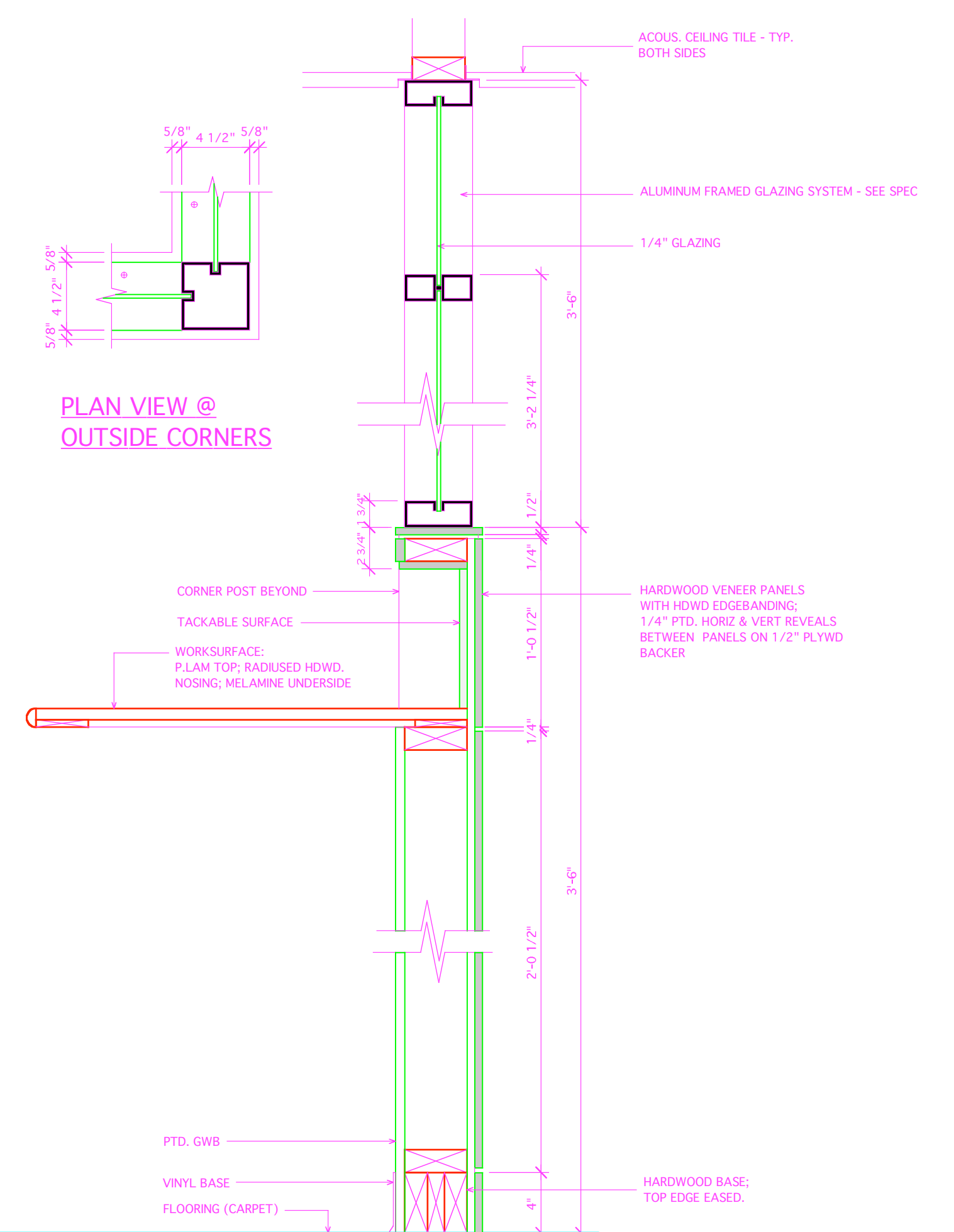

1 SECTION @ P.T. RECEPTION 162
A-702 SCALE: 1 1/2" = 1'-0"

Design Firm
HKTA architects, inc.
6 Mills Street
Portland, Maine 04101
HKTA / architects
Phone: 207.774.6866
Fax: 207.774.8128
e-mail: hkta@hkta.com

Consultant

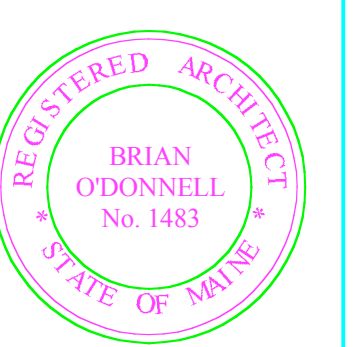

Project Title

ORTHOPAEDIC ASSOCIATES, PA
BUILDING EXPANSION
33 SEWALL STREET
PORTLAND, MAINE

Issue/Revision	Date	Description
Project ID	20040180A	
CAD File Name	2004014 OA.PHH	
Checked By	EJR	
Issue Date	2/25/05	
Pict Date	2/25/05	
Reviewed by		
Designed by		
Submitted By		
Drawing Code	Arch Detl	
Sheet Title	Millwork Details	

Drawing No.
A-702
of