

NEW CONSTRUCTION  
1 AND 2 STORY  
4,440 SF 2nd Floor

NEW CONSTRUCTION  
2ND STORY OVER  
EXISTING ROOF  
3,428 SF

PHASE II - NEW CONSTRUCTION

- GRAPHIC KEY**
- NEW CONSTRUCTION  
1 and 2 Story
  - NEW CONSTRUCTION  
Over existing roof
  - EXISTING BUILDING
  - INTERIOR CONSTRUCTION  
NEW AND RENOVATION
  - EXISTING INTERIOR CONSTRUCTION  
TO BE POWELED

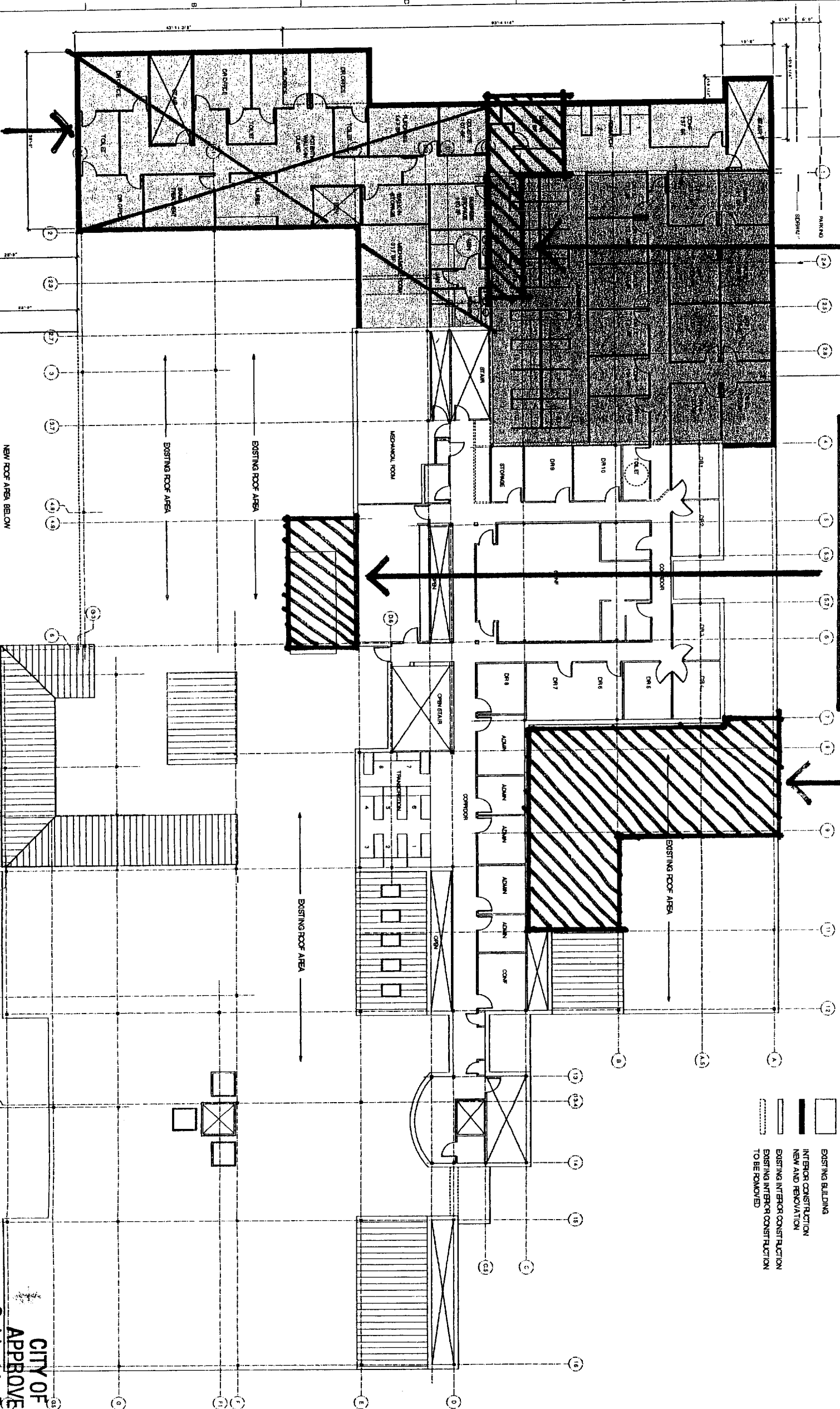

**COMPLETED**

1 SECOND FLOOR PLAN  
Scale: 1/8" = 1'-0"

**SECOND FLOOR PLAN** . 2/2/24

**CITY OF PORTLAND**  
**APPROVED SITE PLAN**  
 Subject to Departmental  
 Date of Approval: **2/2/24**

**ORTHOPAEDIC ASSOCIATES, PA**  
 BUILDING EXPANSION  
 33 SEWALL STREET  
 PORTLAND, MAINE



**HKTA/architects**  
 455 Congress Street, Suite 200  
 Portland, Maine 04101  
 Tel: 734-4814 Fax: 734-4128

**Amended**  
**2/5/05**

Drawing No. **A-102**  
 2nd Floor