

4 1/2" x 3/8" Ledger Locks  
 (2) every 16" OC

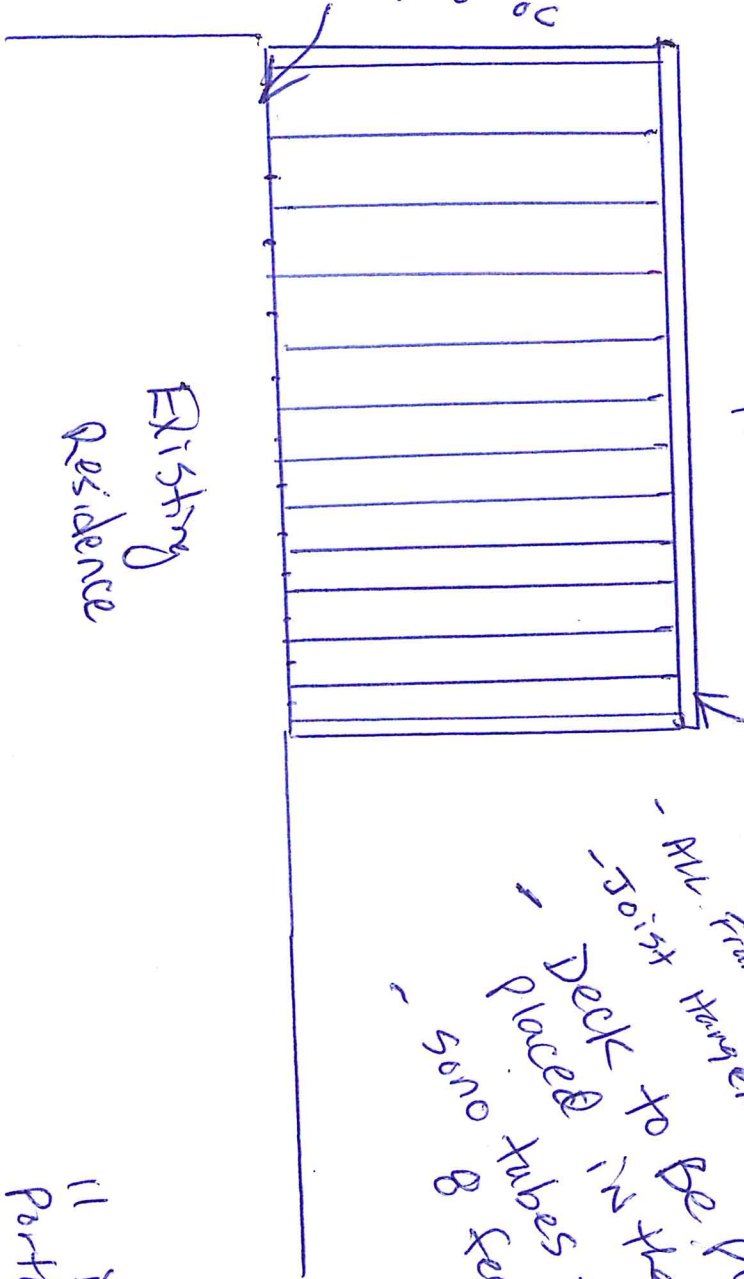

Existing  
 Residence

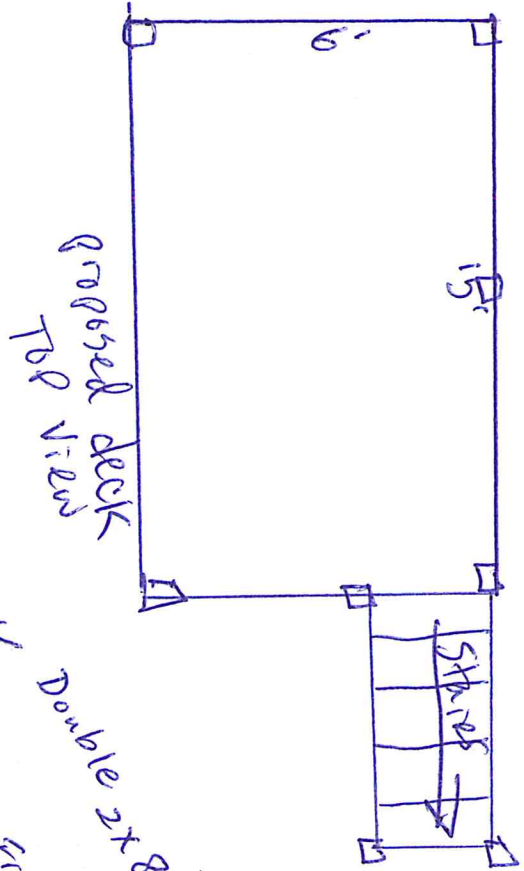

Double 2x8 PT at all perimeter

- All Framing to be 2x8 PT
- Joist Hangers @ building side and other end
- Deck to be placed on Somo-tubes
- Deck placed in the ground 48 inches.
- Somo tubes to be no more than 8 feet apart

11 Dirice ST  
 Portland, ME  
 Framing Plan