

City of Portland, Maine – Building or Use Permit Application 389 Congress Street, 04101, Tel: (207) 874-8703, FAX: 874-8716

Location of Construction: 24 Bandy St		Owner: Helen Scalia/William Bruce		Phone: 828-0932/838-7846		Permit No: 9 80966	
Owner Address: SAA 04102		Lessee/Buyer's Name:		Phone:		Business Name:	
Contractor Name: Storey Bros/Homeowner		Address:		Phone:		<div style="border: 2px solid black; padding: 5px; text-align: center;"> PERMIT ISSUED Permit Issued: AUG 31 1998 CITY OF PORTLAND </div>	
Past Use: 1-fam		Proposed Use:		COST OF WORK: \$ Less PERMIT FEE: \$ 25.00			
Proposed Project Description: Amend Permit #980620 Change Foundation From Frost Wall To Slab		FIRE DEPT. <input type="checkbox"/> Approved <input type="checkbox"/> Denied Signature:		INSPECTION: Use Group: Type: Signature:		Zone: CBL: 188-A-020 Zoning Approval:	
		PEDESTRIAN ACTIVITIES DISTRICT (P.A.D.) Action: <input type="checkbox"/> Approved <input type="checkbox"/> Approved with Conditions <input type="checkbox"/> Denied Signature: Date:		Special Zone or Reviews: <input type="checkbox"/> Shoreland <input type="checkbox"/> Wetland <input type="checkbox"/> Flood Zone <input type="checkbox"/> Subdivision <input type="checkbox"/> Site Plan maj <input type="checkbox"/> minor <input type="checkbox"/> mm <input type="checkbox"/>			
Permit Taken By: MC		Date Applied For: 24 August 1998				Zoning Appeal: <input type="checkbox"/> Variance <input type="checkbox"/> Miscellaneous <input type="checkbox"/> Conditional Use <input type="checkbox"/> Interpretation <input type="checkbox"/> Approved <input type="checkbox"/> Denied	

- This permit application does not preclude the Applicant(s) from meeting applicable State and Federal rules.
- Building permits do not include plumbing, septic or electrical work.
- Building permits are void if work is not started within six (6) months of the date of issuance. False information may invalidate a building permit and stop all work..

PERMIT ISSUED WITH REQUIREMENTS

CERTIFICATION

I hereby certify that I am the owner of record of the named property, or that the proposed work is authorized by the owner of record and that I have been authorized by the owner to make this application as his authorized agent and I agree to conform to all applicable laws of this jurisdiction. In addition, if a permit for work described in the application is issued, I certify that the code official's authorized representative shall have the authority to enter all areas covered by such permit at any reasonable hour to enforce the provisions of the code(s) applicable to such permit

26 August 1998

SIGNATURE OF APPLICANT ADDRESS: DATE: PHONE:

RESPONSIBLE PERSON IN CHARGE OF WORK, TITLE PHONE:

White-Permit Desk Green-Assessor's Canary-D.P.W. Pink-Public File Ivory Card-Inspector

CEO DISTRICT

3

mz/mw

COMMENTS

William Bruce is doing some of the work - a sub contractor. ~~He~~ He will call when he's ready to pour. Mung'

10/9/98 Checked side yard 15' feet Rear over 25' + Front over 25' + OK on slab. Mung' Set Bools OK Slab poured OK anchor bolts in place

03/03/00 - garage is finished - no framing or final inspection conducted at time of final - garage appears to meet dimensions called for on permit.

Close out

Inspection Record

Type	Date
Foundation: _____	_____
Framing: _____	_____
Plumbing: _____	_____
Final: _____	_____
Other: _____	_____

THIS IS NOT A PERMIT/CONSTRUCTION CANNOT COMMENCE UNTIL THE PERMIT IS ISSUED

**Building or Use Permit Pre-Application
Additions/Alterations/Accessory Structures
To Detached Single Family Dwelling**

In the interest of processing your application in the quickest possible manner, please complete the Information below for a Building or Use Permit.

NOTEIf you or the property owner owes real estate or personal property taxes or user charges on any property within the City, payment arrangements must be made before permits of any kind are accepted.**

Location/Address of Construction:	<i>24 Bradley St.</i>
-----------------------------------	-----------------------

Tax Assessor's Chart, Block & Lot Number Chart# <i>188</i> Block# <i>A</i> Lot# <i>20</i>	Owner: <i>Helen Scalia / William Bruce</i>	Telephone#: <i>838-7846</i> <i>828-0932</i>
Owner's Address: <i>24 Bradley St</i>	Lessee/Buyer's Name (If Applicable) _____	Cost Of Work/ESS Fee \$12000 \$25

Proposed Project Description: (Please be as specific as possible) *Amend Permit # 980628*
Amend Foundation Plan from frost wall to Slab construction

Contractor's Name, Address & Telephone <i>Storey Bros. / Homeowner</i>	Rec'd By: <i>MY MY</i>
---	---------------------------

Separate permits are required for Internal & External Plumbing, HVAC and Electrical installation.

- All construction must be conducted in compliance with the 1996 B.O.C.A. Building Code as amended by Section 6-Art II.
- All plumbing must be conducted in compliance with the State of Maine Plumbing Code.
- All Electrical Installation must comply with the 1996 National Electrical Code as amended by Section 6-Art III.
- HVAC (Heating, Ventilation and Air Conditioning) installation must comply with the 1993 B.O.C.A. Mechanical Code.

You must Include the following with you application:

- 1) A Copy of Your Deed or Purchase and Sale Agreement
- 2) A Copy of your Construction Contract, if available
- 3) A Plot Plan (Sample Attached)

If there is expansion to the structure, a complete plot plan (Site Plan) must include:

- The shape and dimension of the lot, all existing buildings (if any), the proposed structure and the distance from the actual property lines. Structures include decks porches, a bow windows cantilever sections and roof overhangs, as well as, sheds, pools, garages and any other accessory structures.
- Scale and required zoning district setbacks

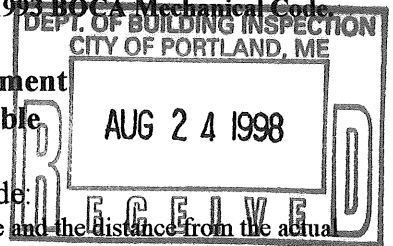

4) Building Plans (Sample Attached)

A complete set of construction drawings showing all of the following elements of construction:

- Cross Sections w/Framing details (including porches, decks w/ railings, and accessory structures)
- Floor Plans & Elevations
- Window and door schedules
- Foundation plans with required drainage and dampproofing
- Electrical and plumbing layout. Mechanical drawings for any specialized equipment such as furnaces, chimneys, gas equipment, HVAC equipment (air handling) or other types of work that may require special review must be included.

Certification

I hereby certify that I am the Owner of record of the named property, or that the proposed work is authorized by the owner of record and that I have been authorized by the owner to make this application as his/her authorized agent. I agree to conform to all applicable laws of this jurisdiction. In addition, if a permit for work described in this application is issued, I certify that the Code Official's authorized representative shall have the authority to enter all areas covered by this permit at any reasonable hour to enforce the provisions of the codes applicable to this permit.

Signature of applicant: <i>William Bruce</i>	Date: <i>8-24-98</i>
--	----------------------

Building Permit Fee: \$25.00 for the 1st \$1000.cost plus \$5.00 per \$1,000.00 construction cost thereafter.

BUILDING PERMIT REPORT

DATE: 28 AUG, 98 ADDRESS: 24 Bradley St. 188-A-620
REASON FOR PERMIT: Change Foundation Foot wall To Slab
BUILDING OWNER: Scalia/Williams
CONTRACTOR: Storey Bros-
PERMIT APPLICANT:
USE GROUP 4 BOCA 1996 CONSTRUCTION TYPE

CONDITION(S) OF APPROVAL

This Permit is being issued with the understanding that the following conditions are met:

Approved with the following conditions: *1, 2, 29

- 1. This permit does not excuse the applicant from meeting applicable State and Federal rules and laws.
2. Before concrete for foundation is placed, approval from the Development Review Coordinator and Inspection Services must be obtained.
2.5 Foundation drain shall be placed around the perimeter of a foundation that consists of gravel or crushed stone containing not more than 10 percent material that passes through a No. 4 sieve.
2.6 Foundations anchors shall be a minimum of 1 1/2" in diameter, 7" into the foundation wall, minimum of 12" from corners of foundation and a maximum 6'o.c. between bolts.
3. Precaution must be taken to protect concrete from freezing.
4. It is strongly recommended that a registered land surveyor check all foundation forms before concrete is placed.
5. Private garages located beneath habitable rooms in occupancies in Use Group R-1, R-2, R-3 or I-1 shall be separated from adjacent interior spaces by fire partitions and floor/ceiling assembly which are constructed with not less than 1-hour fire resisting rating.
6. All chimneys and vents shall be installed and maintained as per Chapter 12 of the City's Mechanical Code.
7. Sound transmission control in residential building shall be done in accordance with Chapter 12 section 1214.0 of the city's building code.
8. Guardrails & Handrails: A guardrail system is a system of building components located near the open sides of elevated walking surfaces for the purpose of minimizing the possibility of an accidental fall from the walking surface to the lower level.
9. Headroom in habitable space is a minimum of 7'6".
10. Stair construction in Use Group R-3 & R-4 is a minimum of 10" tread and 7 3/4" maximum rise.
11. The minimum headroom in all parts of a stairway shall not be less than 80 inches.
12. Every sleeping room below the fourth story in buildings of use Groups R and I-1 shall have at least one operable window or exterior door approved for emergency egress or rescue.

not more than 44 inches (1118mm) above the floor. All egress or rescue windows from sleeping rooms shall have a minimum net clear opening height dimension of 24 inches (610mm). The minimum net clear opening width dimension shall be 20 inches (508mm), and a minimum net clear opening of 5.7 sq. ft. (Section 1018.6)

- 13. Each apartment shall have access to two (2) separate, remote and approved means of egress. A single exit is acceptable when it exits directly from the apartment to the building exterior with no communications to other apartment units. Section 1010.1
- 14. All vertical openings shall be enclosed with construction having a fire rating of at least one (1)hour, including fire doors with self closer's. (Over 3 stories in height requirements for fire rating is two (2) hours.) Section 710.0
- 15. The boiler shall be protected by enclosing with (1) hour fire-rated construction including fire doors and ceiling, or by providing automatic extinguishment. Table 302.1.1
- 16. All single and multiple station smoke detectors shall be of an approved type and shall be installed in accordance with the provisions of the City's Building Code Chapter 9, Section 19, 920.3.2 (BOCA National Building Code/1996), and NFPA 101 Chapter 18 & 19. (Smoke detectors shall be installed and maintained at the following locations):
 - In the immediate vicinity of bedrooms
 - In all bedrooms
 - In each story within a dwelling unit, including basements

In addition to the required AC primary power source, required smoke detectors in occupancies in Use Groups R-2, R-3 and I-1 shall receive power from a battery when the AC primary power source is interrupted. (Interconnection is required) Section 920.3.2

- 17. A portable fire extinguisher shall be located as per NFPA #10. They shall bear the label of an approved agency and be of an approved type. Section 921.0
- 18. The Fire Alarm System shall be maintained to NFPA #72 Standard.
- 19. The Sprinkler System shall maintained to NFPA #13 Standard.
- 20. All exit signs, lights, and means of egress lighting shall be done in accordance with Chapter 10 Section & Subsections 1023. & 1024. Of the City's building code. (The BOCA National Building Code/1996)
- 21. Section 25-135 of the Municipal Code for the City of Portland states, "No person or utility shall be granted a permit to excavate or open any street or sidewalk from the time of November 15 of each year to April 15 of the following year".
- 22. The builder of a facility to which Section 594-C of the Maine State Human Rights Act Title 5 MRSA refers, shall obtain a certification from a design professional that the plans commencing construction of the facility, the builder shall submit the certification to the Division of Inspection Services.
- 23. Ventilation shall meet the requirements of Chapter 12 Sections 1210. Of the City's Building Code. (crawl spaces & attics)
- 24. All electrical, plumbing and HVAC permits must be obtained by a Master Licensed holders of their trade.
- 25. All requirements must be met before a final Certificate of Occupancy is issued.
- 26. All building elements shall meet the fastening schedule as per Table 2305.2 of the City's Building Code. (The BOCA National Building Code/1996).
- 27. Ventilation of spaces within a building shall be done in accordance with the City's Mechanical Code (The BOCA National Mechanical Code/1993). (Chapter M-16)
- 28. Please read and implement the attached Land Use-Zoning report requirements.

29. *Same conditions required as per original permit dated June 16, 1998 & 980620.*

30. _____

31. _____

32. _____

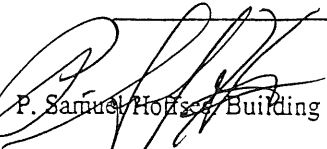
P. Samuel Hoff, Building Inspector

cc: Lt. McDougall, PFD
Marge Schmuckal, Zoning Administrator

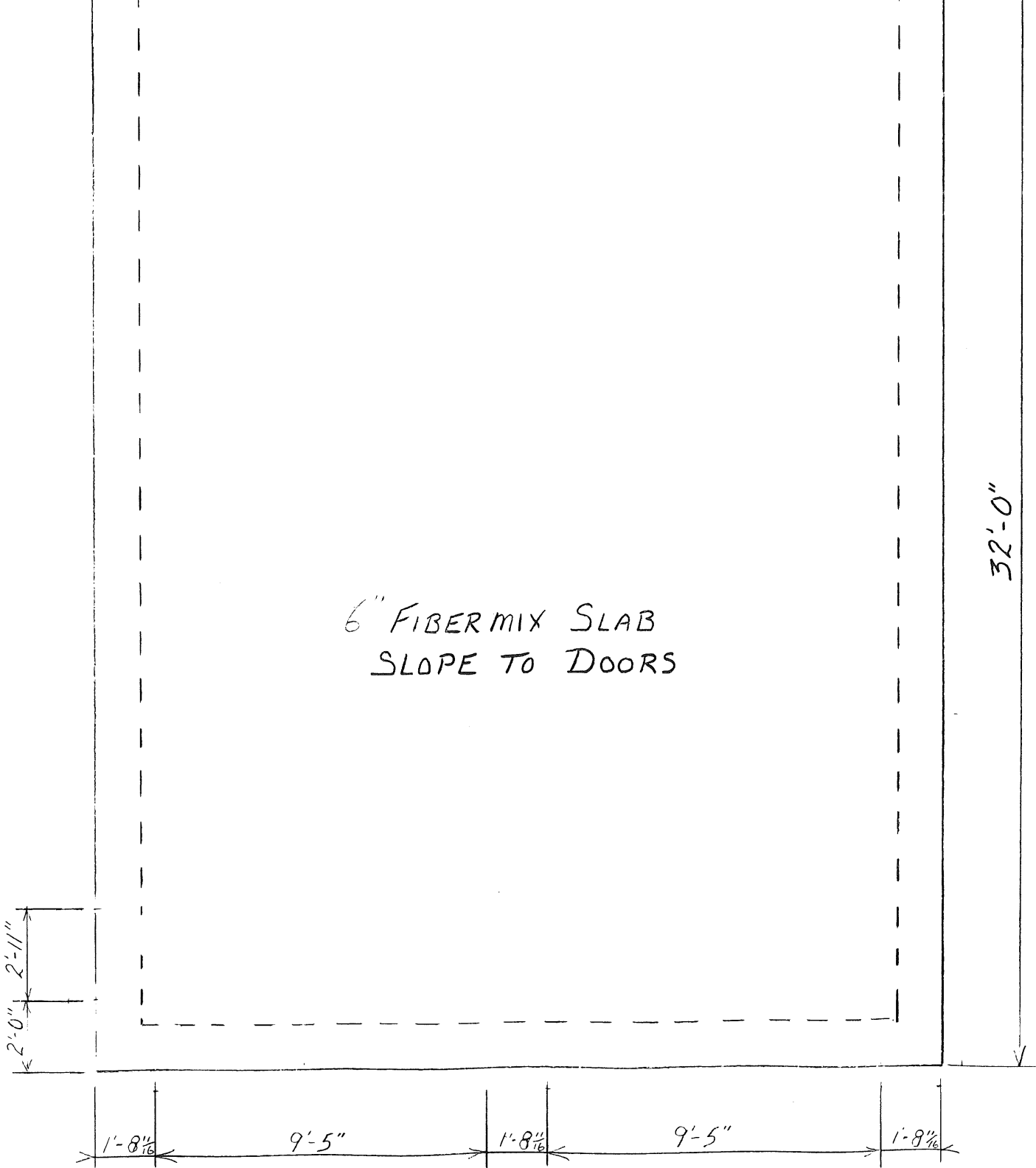

FOUNDATION PLAN

1/4" =

