

City of Portland, Maine - Building or Use Permit Application
 389 Congress Street, 04101 Tel: (207) 874-8703, Fax: (207) 874-8716

Permit No: 02-0660	Issue Date: JUL - 2 2002	CBL: 187 E020001
Location of Construction: 86 Frances St	Owner Name: Caufield Nancy A	Owner Address: 86 Frances St
Business Name:	Contractor Name: Twombly, Alan	Contractor Address: 16 Shady Lane Falmouth
Lessee/Buyer's Name	Phone:	Permit Type: Additions - Dwellings
		Zone:

Past Use: Single family	Proposed Use: Single family with new front porch
----------------------------	---

Permit Fee: \$51.00	Cost of Work: \$4,000.00	CEO District: 3
------------------------	-----------------------------	--------------------

FIRE DEPT: <input type="checkbox"/> Approved <input type="checkbox"/> Denied <i>N/A</i>	INSPECTION: Use Group: <i>R-3</i> Type: <i>SB</i> <i>BOCA 1079</i> Signature: <i>JH</i>
--	--

Proposed Project Description:
Replace existing front porch

PEDESTRIAN ACTIVITIES DISTRICT (P.A.D.)
 Action: Approved Approved w/Conditions Denied
 Signature: _____ Date: _____

Permit Taken By: jmy	Date Applied For: 06/17/2002	Zoning Approval
-------------------------	---------------------------------	------------------------

- This permit application does not preclude the Applicant(s) from meeting applicable State and Federal Rules.
- Building permits do not include plumbing, septic or electrical work.
- Building permits are void if work is not started within six (6) months of the date of issuance. False information may invalidate a building permit and stop all work..

Special Zone or Reviews <input type="checkbox"/> Shoreland <input type="checkbox"/> Wetland <input type="checkbox"/> Flood Zone <input type="checkbox"/> Subdivision <input type="checkbox"/> Site Plan Maj <input type="checkbox"/> Minor <input type="checkbox"/> MM <input type="checkbox"/> Date: <i>7/1/02</i>	Zoning Appeal <input type="checkbox"/> Variance <input type="checkbox"/> Miscellaneous <input type="checkbox"/> Conditional Use <input type="checkbox"/> Interpretation <input type="checkbox"/> Approved <input type="checkbox"/> Denied Date: _____	Historic Preservation <input checked="" type="checkbox"/> Not in District or Landmark <input type="checkbox"/> Does Not Require Review <input type="checkbox"/> Requires Review <input type="checkbox"/> Approved <input type="checkbox"/> Approved w/Conditions <input type="checkbox"/> Denied Date: <i>7/1/02</i>
---	---	--

CERTIFICATION

I hereby certify that I am the owner of record of the named property, or that the proposed work is authorized by the owner of record and that I have been authorized by the owner to make this application as his authorized agent and I agree to conform to all applicable laws of this jurisdiction. In addition, if a permit for work described in the application is issued, I certify that the code official's authorized representative shall have the authority to enter all areas covered by such permit at any reasonable hour to enforce the provision of the code(s) applicable to such permit.

SIGNATURE OF APPLICANT	ADDRESS	DATE	PHONE
RESPONSIBLE PERSON IN CHARGE OF WORK, TITLE		DATE	PHONE

DISPLAY THIS CARD ON PRINCIPAL FRONTAGE OF WORK
CITY OF PORTLAND

Please Read Application And Notes, If Any, Attached

BUILDING INSPECTION

PERMIT

Permit Number: 020660

This is to certify that Caufield Nancy A/Twombly, an
has permission to Replace existing front porch
AT 86 Frances St 187 E020001

provided that the person or persons, firm or corporation accepting this permit shall comply with all of the provisions of the Statutes of Maine and of the Ordinances of the City of Portland regulating the construction, maintenance and use of buildings and structures, and of the application on file in this department.

Apply to Public Works for street line and grade if nature of work requires such information.

Notification of inspection must be given and written permission procured before this building or part thereof is laid out or closed-in. **48 HOURS NOTICE IS REQUIRED.**

A certificate of occupancy must be procured by owner before this building or part thereof is occupied.

OTHER REQUIRED APPROVALS

Fire Dept. _____
Health Dept. _____
Appeal Board _____
Other _____
Department Name _____

Director - Building & Inspection Services

PENALTY FOR REMOVING THIS CARD

02-0660

All Purpose Building Permit Application

If you or the property owner owes real estate or personal property taxes or user charges on any property within the City, payment arrangements must be made before permits of any kind are accepted.

Location/Address of Construction: <u>86 FRANCES ST. PORTLAND, ME 04102</u>		
Total Square Footage of Proposed Structure	Square Footage of Lot	
Tax Assessor's Chart, Block & Lot Chart# <u>087</u> Block# <u>E</u> Lot# <u>020</u>	Owner: <u>NANCY CAUFIELD</u>	Telephone: <u>207-772-4786</u>
Lessee/Buyer's Name (If Applicable)	Applicant name, address & telephone:	Cost Of Work: \$ <u>4,000.00</u> Fee: \$ <u>51.00</u>
Current use: <u>Single Family</u>		
If the location is currently vacant, what was prior use: <u>NO</u>		
Approximately how long has it been vacant: _____		
Proposed use: _____		
Project description: <u>Replacement Front Porch</u>		
Contractor's name, address & telephone: <u>Alan Tomblay</u> <u>16 Shoreway Lane, Falmouth, Me</u>		
Who should we contact when the permit is ready: <u>NANCY CAUFIELD</u>		
Mailing address: <u>86 Frances St</u> <u>Portland, Me 04102</u> <u>XX</u>		
We will contact you by phone when the permit is ready. You must come in and pick up the permit and review the requirements before starting any work, with a Plan Reviewer. A stop work order will be issued and a \$100.00 fee if any work starts before the permit is picked up. PHONE: <u>772-4786</u> <u>XX Cal</u>		

IF THE REQUIRED INFORMATION IS NOT INCLUDED IN THE SUBMISSIONS THE PERMIT WILL BE AUTOMATICALLY DENIED AT THE DISCRETION OF THE BUILDING/PLANNING DEPARTMENT, WE MAY REQUIRE ADDITIONAL INFORMATION IN ORDER TO APPROVE THIS PERMIT.

I hereby certify that I am the Owner of record of the named property, or that the owner of record authorizes the proposed work and that I have been authorized by the owner to make this application as his/her authorized agent. I agree to conform to all applicable laws of this jurisdiction. In addition, if a permit for work described in this application is issued, I certify that the Code Official's authorized representative shall have the authority to enter all areas covered by this permit at any reasonable hour to enforce the provisions of the codes applicable to this permit.

Signature of applicant: <u>Nancy Caufield</u>	Date: <u>6-10-02</u>
---	----------------------

This is NOT a permit, you may not commence ANY work until the permit is issued. If you are in a Historic District you may be subject to additional permitting and fees with the Planning Department on the 4th floor of City Hall

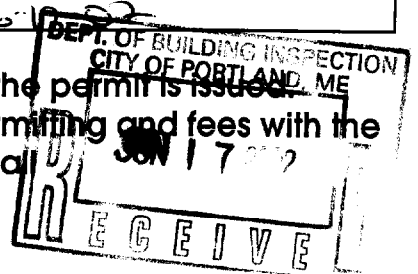

BUILDING PERMIT INSPECTION PROCEDURES

Please call 874-8703 or ~~874-8693~~ to schedule your inspections as agreed upon

Permits expire in 6 months, if the project is not started or ceases for 6 months.

The Owner or their designee is required to notify the inspections office for the following inspections and provide adequate notice. Notice must be called in 48-72 hours in advance in order to schedule an inspection:

By initializing at each inspection time, you are agreeing that you understand the inspection procedure and additional fees from a "Stop Work Order" and "Stop Work Order Release" will be incurred if the procedure is not followed as stated below.

W **Pre-construction Meeting:** Must be scheduled with your inspection team upon receipt of this permit. ~~Jay Reynolds, Development Review Coordinator at 874-8632~~ must also be contacted at this time, before any site work begins on any project other than single family additions or alterations.

~~W~~ **Footing/Building Location Inspection:** Prior to pouring concrete

N/A **Re-Bar Schedule Inspection:** Prior to pouring concrete

N/A **Foundation Inspection:** Prior to placing ANY backfill

W **Framing/Rough Plumbing/Electrical:** Prior to any insulating or drywalling

W **Final/~~Certificate of Occupancy:~~** Prior to any occupancy of the structure or use. NOTE: ~~There is a \$75.00 fee per inspection at this point.~~

Certificate of Occupancy is not required for certain projects. Your inspector can advise you if your project requires a Certificate of Occupancy. All projects DO require a final inspection

W If any of the inspections do not occur, the project cannot go on to the next phase, REGARDLESS OF THE NOTICE OR CIRCUMSTANCES.

CERTIFICATE OF OCCUPANCIES MUST BE ISSUED AND PAID FOR, BEFORE THE SPACE MAY BE OCCUPIED

[Signature]
Signature of applicant/designee

Date

[Signature]
Signature of Inspections Official

7/3/02
Date

CBL: 187-E-020 Building Permit #: 02-0660

86 FRANCIS ST
Portland, Maine

R-3
Front - 25' Reg.
Side - 8' Reg.

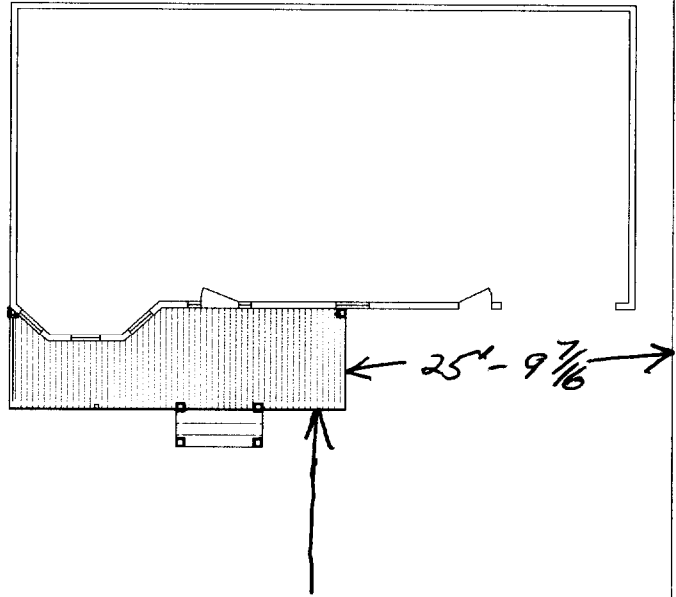

78'-4 ¹⁵/₁₆"

45-6/4

100'



2'-3 3/4"

✓
4'-0"

6'-6 3/4"

6'-7 1/2"

6'-1 3/4"

6'-6 3/4"

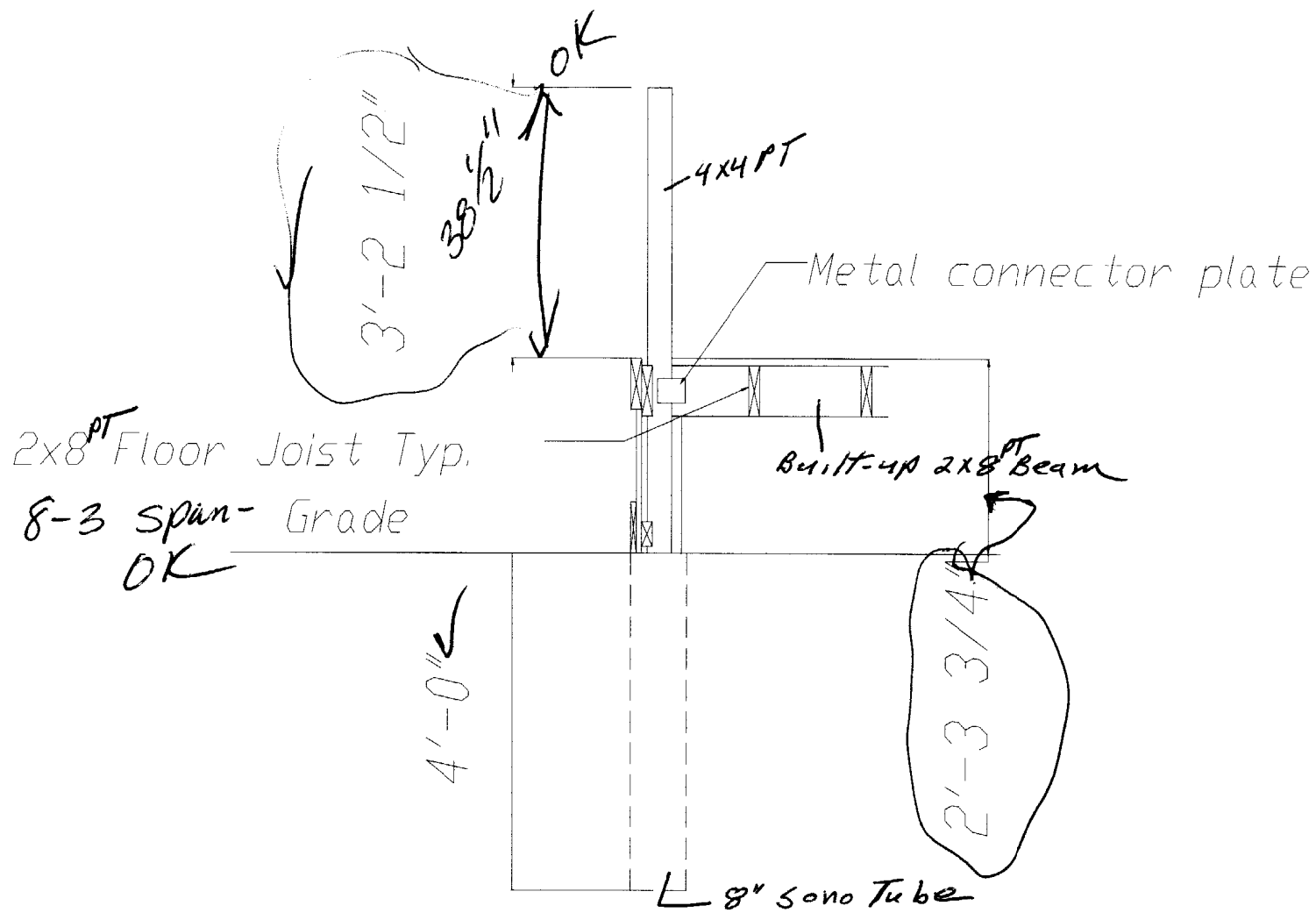

Section At Beam/Post Connection



20'-0 1/4"

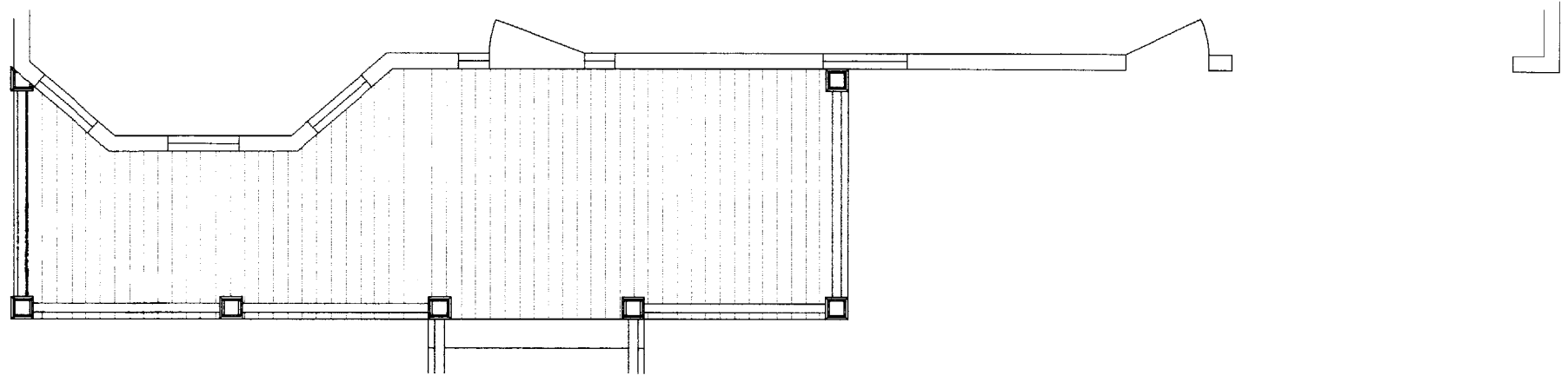

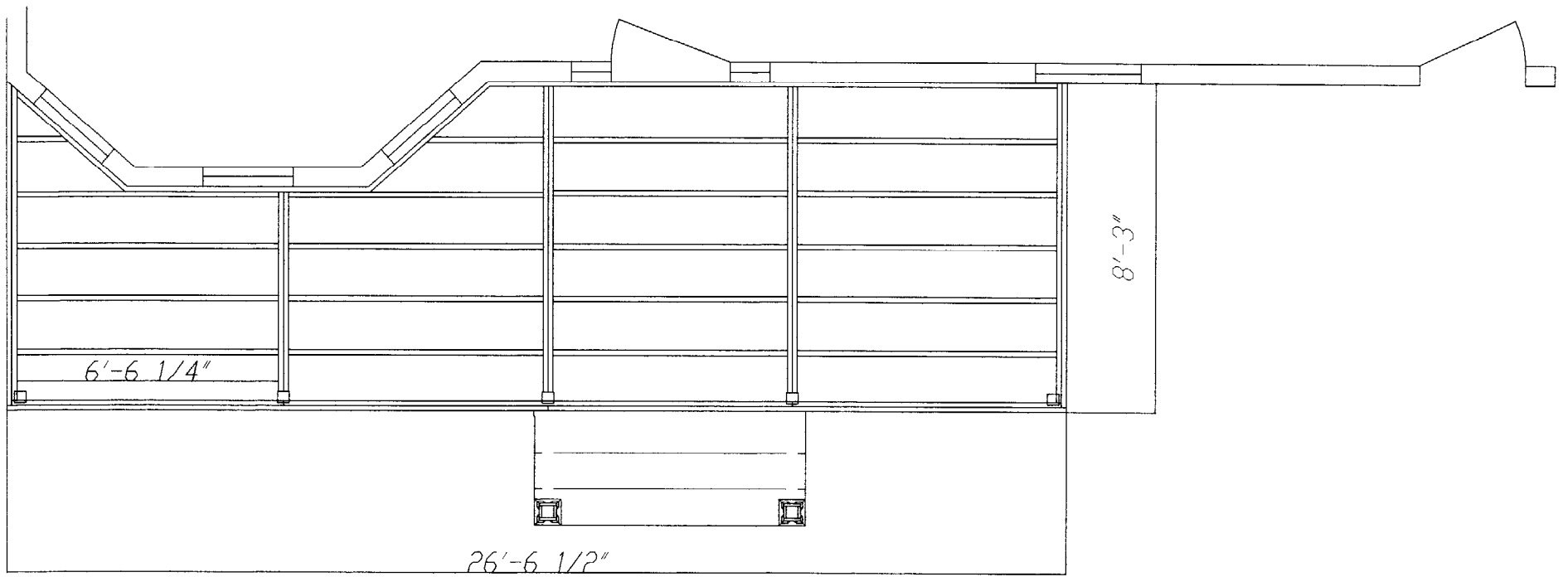

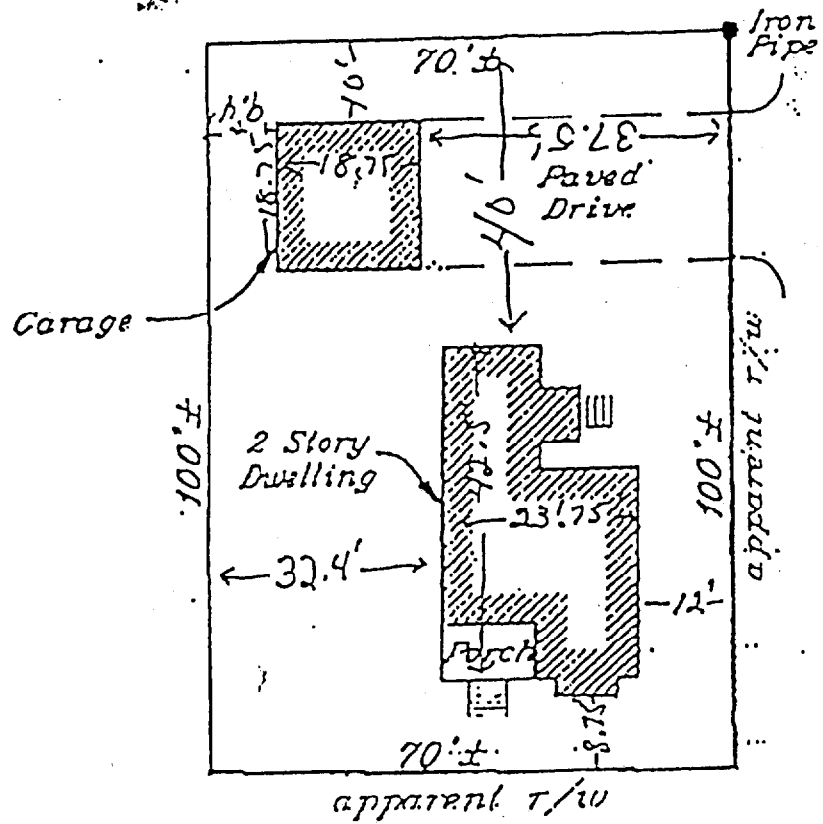

Lot-Front

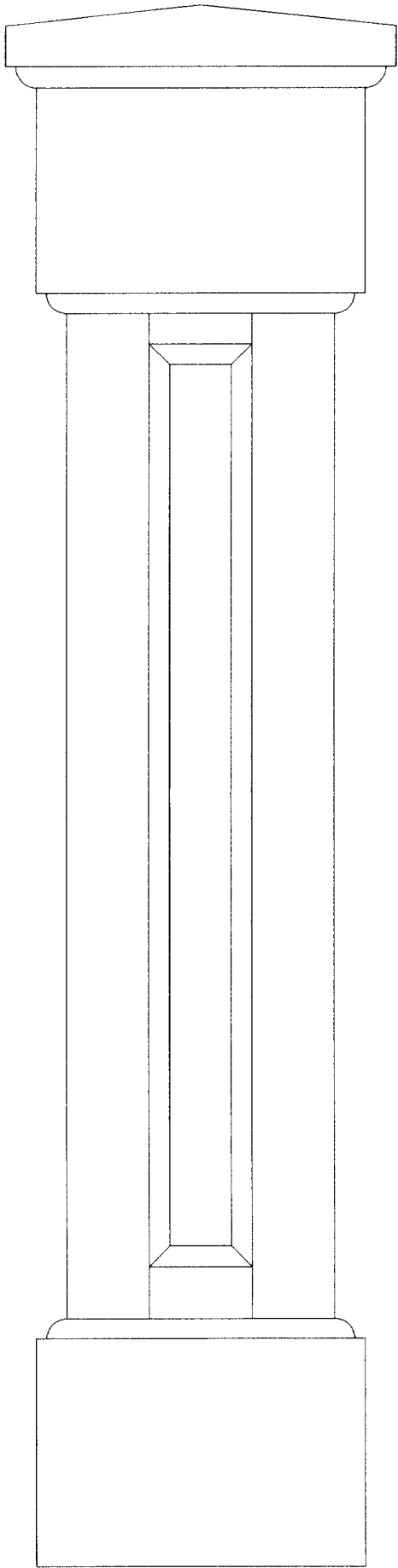

← 8'' →

