

# PERMIT ISSUED

**City of Portland, Maine - Building or Use Permit Application**  
 389 Congress Street, 04101 Tel: (207) 874-8703, Fax: (207) 874-8716

|                       |                                   |                     |
|-----------------------|-----------------------------------|---------------------|
| Permit No:<br>03-1063 | Issue Date:<br><b>SEP 03 2003</b> | CBL:<br>187 B018001 |
|-----------------------|-----------------------------------|---------------------|

|  |                                  |   |                    |
|--|----------------------------------|---|--------------------|
| Location of Construction:<br>44 Edwards St | Owner Name:<br>Westphal Rolf N & | Owner Address:<br>44 Edwards St <b>CITY OF PORTLAND</b> | Phone:<br>761-8169 |
| Business Name:                             | Contractor Name:<br>self         | Contractor Address:<br>Portland                         | Phone:             |
| Lessee/Buyer's Name:                       | Phone:                           | Permit Type:<br>Swimming Pools                          | Zone:<br><b>R3</b> |

|  |  |   |                             |   |
|--|--|---|-----------------------------|---|
| Past Use:<br>Single Family   | Proposed Use:<br>Single Family w/above ground pool | Permit Fee:<br>\$30.00  | Cost of Work:<br>\$1,000.00 | CEO District:<br>3  |
| Proposed Project Description:<br>Install a 15x24 above ground pool w/prefabricated deck attached |  | FIRE DEPT: <input type="checkbox"/> Approved <input type="checkbox"/> Denied  |                             | INSPECTION:<br>Use Group: <b>R3</b> Type: <b>accessory pool</b><br><b>BOCA 1999</b><br>Signature: <b>JMB 9/3/03</b> |
|  |  | PEDESTRIAN ACTIVITIES DISTRICT (P.A.D.)<br>Action: <input type="checkbox"/> Approved <input type="checkbox"/> Approved w/Conditions <input type="checkbox"/> Denied<br>Signature: _____ Date: _____ |                             |   |

|                         |                                 |                 |
|-------------------------|---------------------------------|-----------------|
| Permit Taken By:<br>jmb | Date Applied For:<br>09/03/2003 | Zoning Approval |
|-------------------------|---------------------------------|-----------------|

|  |   |   |   |
|--|---|---|---|
| 1. This permit application does not preclude the Applicant(s) from meeting applicable State and Federal Rules.<br><br>2. Building permits do not include plumbing, septic or electrical work.<br><br>3. Building permits are void if work is not started within six (6) months of the date of issuance. False information may invalidate a building permit and stop all work.. | <b>Special Zone or Reviews</b><br><input type="checkbox"/> Shoreland<br><input type="checkbox"/> Wetland <i>Approved</i><br><input type="checkbox"/> Flood Zone<br><input type="checkbox"/> Subdivision<br><input type="checkbox"/> Site Plan<br><br>Maj <input type="checkbox"/> Minor <input type="checkbox"/> MM <input type="checkbox"/><br>Date: <b>JMB 9/3/03</b> | <b>Zoning Appeal</b><br><input type="checkbox"/> Variance<br><input type="checkbox"/> Miscellaneous<br><input type="checkbox"/> Conditional Use<br><input type="checkbox"/> Interpretation<br><input type="checkbox"/> Approved<br><input type="checkbox"/> Denied<br><br>Date: _____ | <b>Historic Preservation</b><br><input checked="" type="checkbox"/> Not in District or Landmark<br><input type="checkbox"/> Does Not Require Review<br><input type="checkbox"/> Requires Review<br><input type="checkbox"/> Approved<br><input type="checkbox"/> Approved w/Conditions<br><input type="checkbox"/> Denied<br><br>Date: <b>JMB</b> |
|--|---|---|---|

### CERTIFICATION

I hereby certify that I am the owner of record of the named property, or that the proposed work is authorized by the owner of record and that I have been authorized by the owner to make this application as his authorized agent and I agree to conform to all applicable laws of this jurisdiction. In addition, if a permit for work described in the application is issued, I certify that the code official's authorized representative shall have the authority to enter all areas covered by such permit at any reasonable hour to enforce the provision of the code(s) applicable to such permit.

|   |         |      |       |
|---|---------|------|-------|
| SIGNATURE OF APPLICANT                      | ADDRESS | DATE | PHONE |
| RESPONSIBLE PERSON IN CHARGE OF WORK, TITLE |         | DATE | PHONE |

**City of Portland, Maine - Building or Use Permit**

389 Congress Street, 04101 Tel: (207) 874-8703, Fax: (207) 874-8716

|                              |  |                            |
|------------------------------|--|----------------------------|
| <b>Permit No:</b><br>03-1063 | <b>Date Applied For:</b><br>09/03/2003 | <b>CBL:</b><br>187 B018001 |
|------------------------------|--|----------------------------|

|   |   |  |                               |
|---|---|--|-------------------------------|
| <b>Location of Construction:</b><br>44 Edwards St | <b>Owner Name:</b><br>Westphal Rolf N & | <b>Owner Address:</b><br>44 Edwards St | <b>Phone:</b><br>( ) 761-8169 |
| <b>Business Name:</b>                             | <b>Contractor Name:</b><br>self         | <b>Contractor Address:</b><br>Portland | <b>Phone:</b>                 |
| <b>Lessee/Buyer's Name</b>                        | <b>Phone:</b>                           | <b>Permit Type:</b><br>Swimming Pools  |                               |

|   |   |
|---|---|
| <b>Proposed Use:</b><br>Single Family w/above ground pool | <b>Proposed Project Description:</b><br>Install a 15x24 above ground pool w/prefabricated deck attached |
|---|---|

|  |                         |                                 |   |
|--|-------------------------|---------------------------------|---|
| <b>Dept:</b> Zoning  | <b>Status:</b> Approved | <b>Reviewer:</b> Jeanine Bourke | <b>Approval Date:</b> 09/03/2003                        |
| <b>Note:</b>   |                         |                                 | <b>Ok to Issue:</b> <input checked="" type="checkbox"/> |
| <b>Dept:</b> Building  | <b>Status:</b> Approved | <b>Reviewer:</b> Jeanine Bourke | <b>Approval Date:</b> 09/03/2003                        |
| <b>Note:</b>   |                         |                                 | <b>Ok to Issue:</b> <input checked="" type="checkbox"/> |
| 1) Barriers shall meet requirements of Sec. 421 of BOCA 1999 |                         |                                 |   |

# Pool Installation/Construction Permit Application

If you or the property owner owes real estate or personal property taxes or user charges on any property within the City, payment arrangements must be made before permits of any kind are accepted.

|   |   |   |
|---|---|---|
| Location/Address of Construction: <u>44 EDWARDS ST PORTLAND, ME.</u>  |   |   |
| Total Square Footage of Proposed Structure<br><u>450</u>  | Square Footage of Lot<br><u>17,760</u>  |   |
| Tax Assessor's Chart, Block & Lot<br>Chart# <u>187</u> Block# <u>B</u> Lot# <u>18</u>   | Owner: <u>ROLF &amp; CINDY WESTPHAL</u>   | Telephone:<br><u>(207) 761-8169</u>                     |
| Lessee/Buyer's Name (If Applicable)   | Applicant name, address & telephone:<br><u>ROLF WESTPHAL</u><br><u>44 EDWARDS ST</u><br><u>PORTLAND, ME. 04102</u><br><u>761-8169</u> | Cost Of Work: <u>\$1,000.00</u><br>Fee: \$ <u>30.00</u> |
| Dimensions of pool: <u>15 x 24</u> Above or below ground: <u>ABOVE</u>  |   |   |
| Dimensions of decking and/or any platforms, sheds, or other structures: <u>SEE ATTACHED</u><br><u>Purchased used Pool</u>   |   |   |
| Contractor's name, address & telephone:   |   |   |
| Whom should we contact when the permit is ready: <u>ROLF WESTPHAL</u>   |   |   |
| Mailing address: <u>44 EDWARDS ST.</u><br><u>PORTLAND, ME. 04102</u>  |   |   |
| We will contact you by phone when the permit is ready. You must come in and pick up the permit and review the requirements before starting any work, with a Plan Reviewer. <b>A stop work order will be issued and a \$100.00 fee if any work starts before the permit is picked up.</b> PHONE: |   |   |

**IF THE REQUIRED INFORMATION IS NOT INCLUDED IN THE SUBMISSIONS THE PERMIT WILL BE AUTOMATICALLY DENIED AT THE DISCRETION OF THE BUILDING/PLANNING DEPARTMENT, WE MAY REQUIRE ADDITIONAL INFORMATION IN ORDER TO APPROVE THIS PERMIT.**

*I hereby certify that I am the Owner of record of the named property, or that the owner of record authorizes the proposed work and that I have been authorized by the owner to make this application as his/her authorized agent. I agree to conform to all applicable laws of this jurisdiction. In addition, if a permit for work described in this application is issued, I certify that the Code Official's authorized representative shall have the authority to enter all areas covered by this permit at any reasonable hour to enforce the provisions of the codes applicable to this permit.*

|  |                      |
|--|----------------------|
| Signature of applicant: <u>Rolf Westphal</u> | Date: <u>8/25/03</u> |
|--|----------------------|

**This is NOT a permit; you may not commence ANY work until the permit is issued.  
If you are in a Historic District you may be subject to additional permitting  
and fees with the Planning Department on the 4<sup>th</sup> floor of City Hall**

R 3 Zone

Required setbacks 10' min at Rear and side yards for Pool

Deck = 25' Req Rear - 35' shown

8' Req side 15' shown

WESTPHAL RESIDENCE  
44 EDWARDS ST  
PORTLAND, ME.

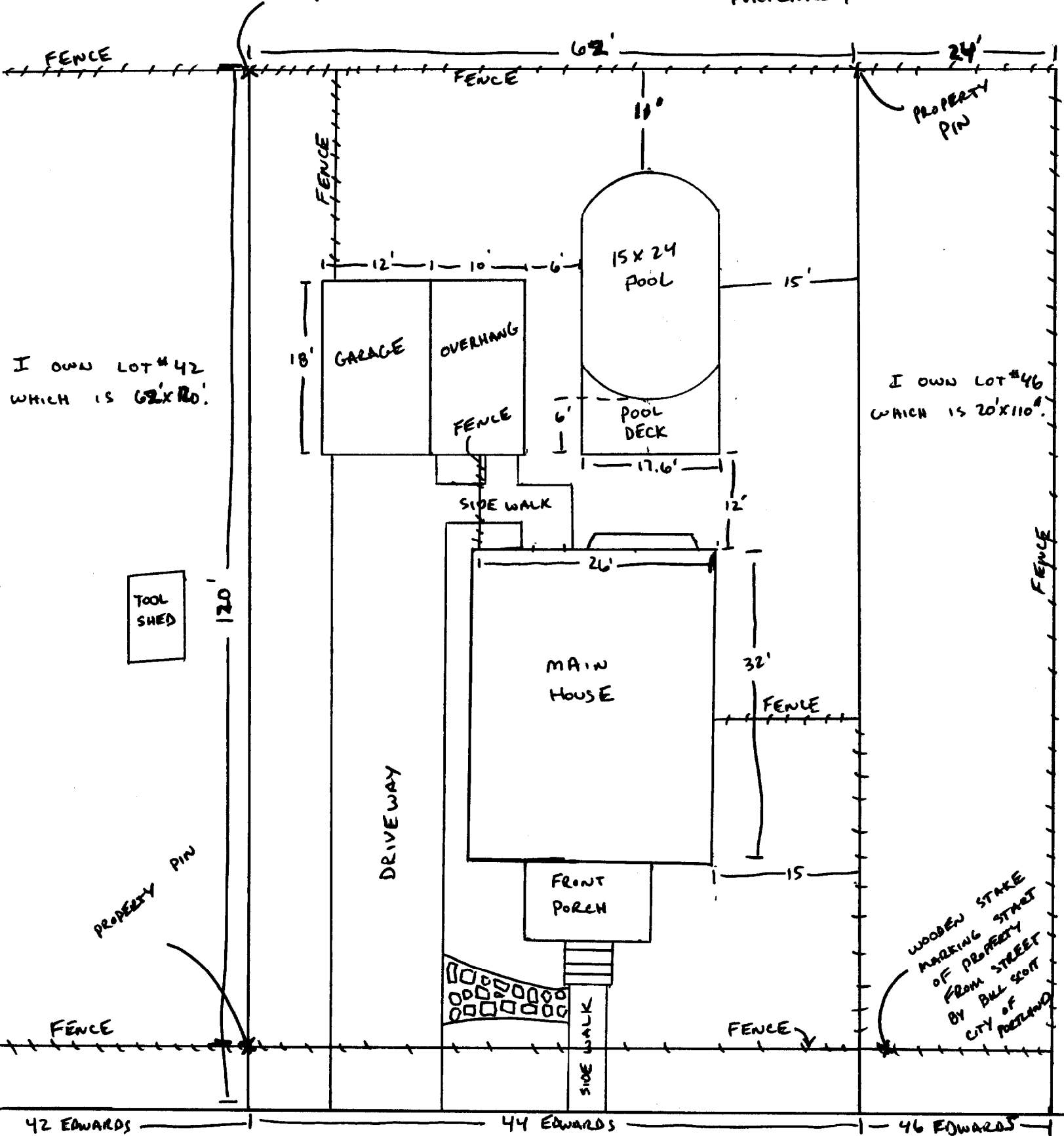

I own LOT #42  
WHICH IS 62'x120'

I own LOT #46  
WHICH IS 20'x110'

WOODEN STAKE  
MARKING START  
OF DRIVEWAY  
FROM STREET  
BY BILL SCOTT  
CITY OF PORTLAND

EDWARDS ST.

ACCESS GATE

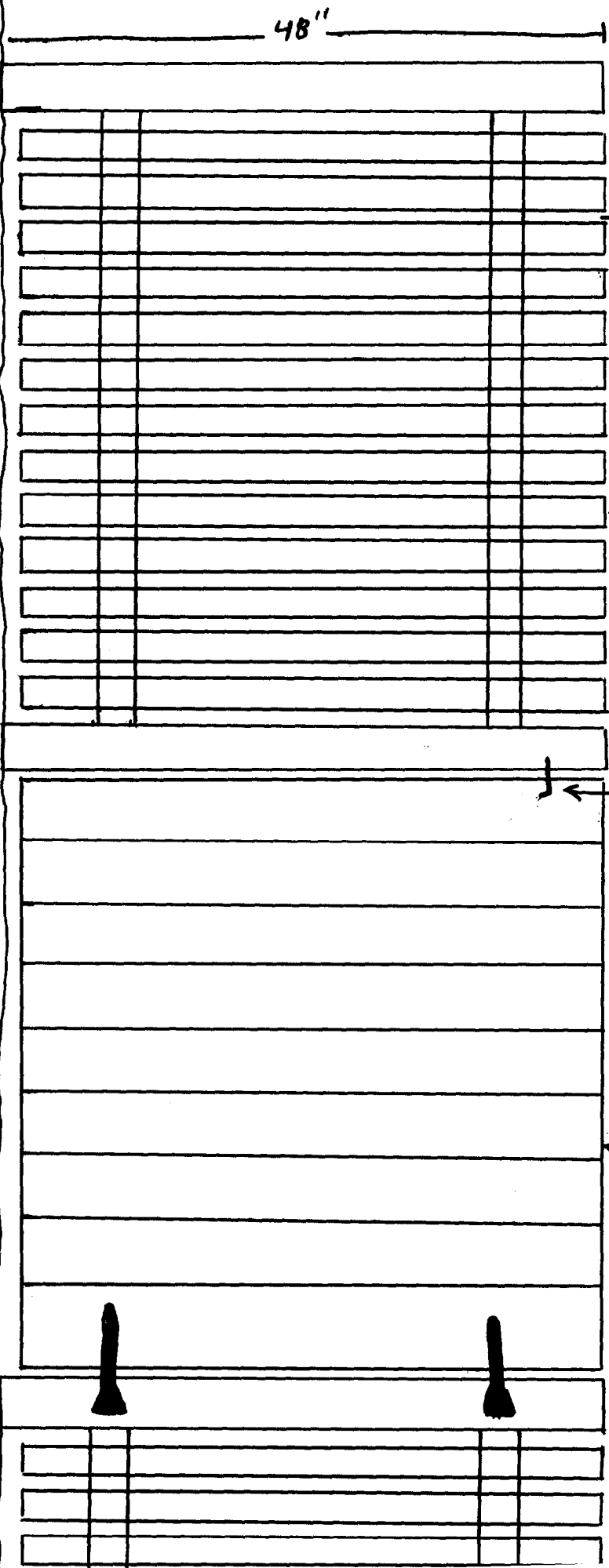

1/4" gap

PICKET FENCE

CATCH ON INSIDE 3" BELOW TOP

GATE SOLID PINE

Accomodate lock

SITE PLAN

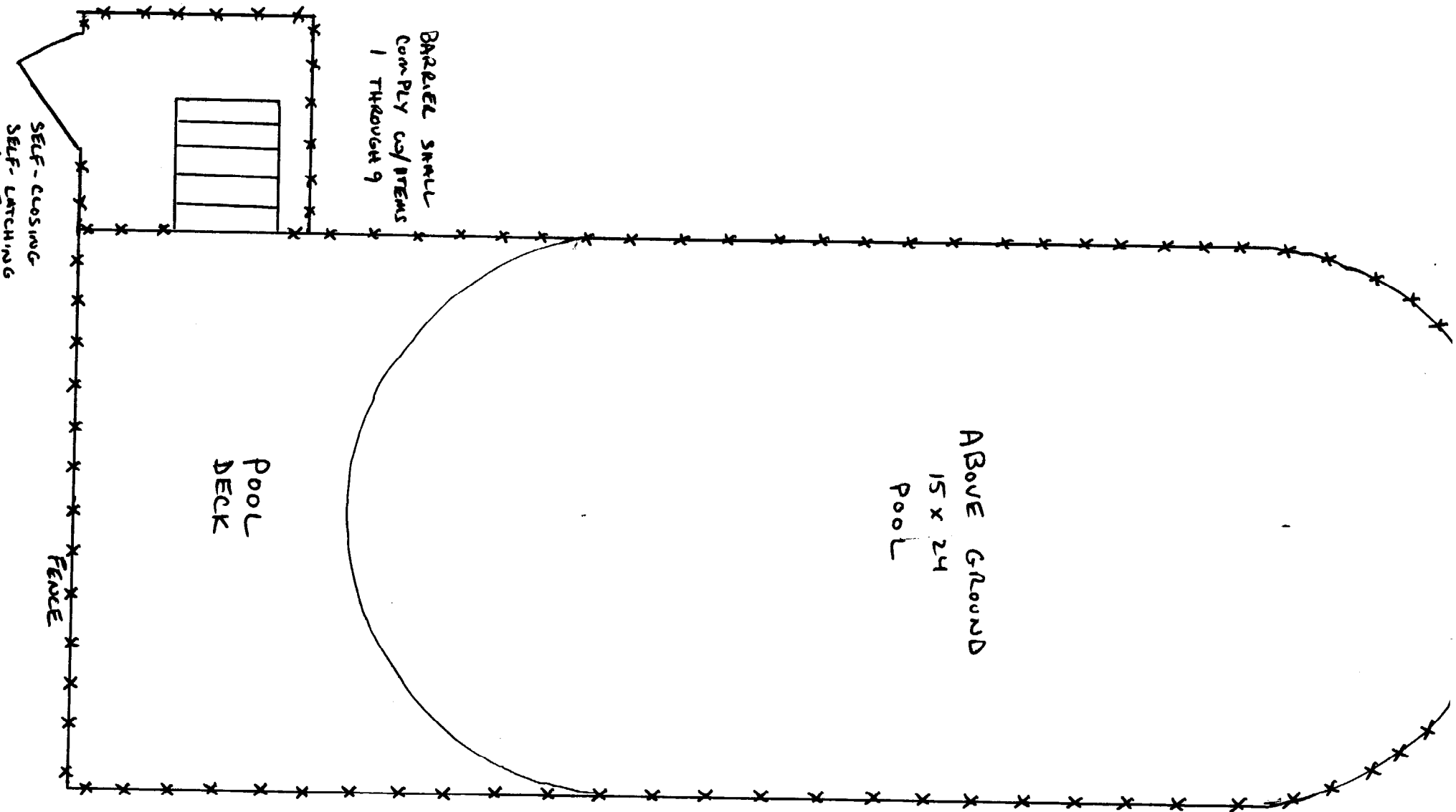

BARRIER SMALL  
COMPLY CO/ITEMS  
1 THROUGH 9

POOL  
DECK

ABOVE GROUND  
15 x 24  
POOL

FENCE

## OVAL POOL SIDE PATIO DECKS

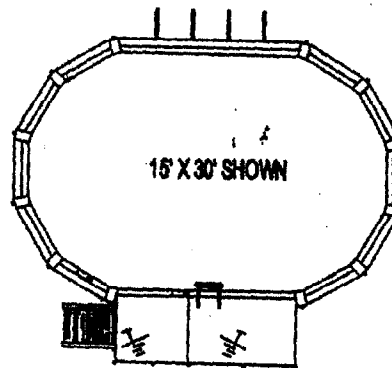
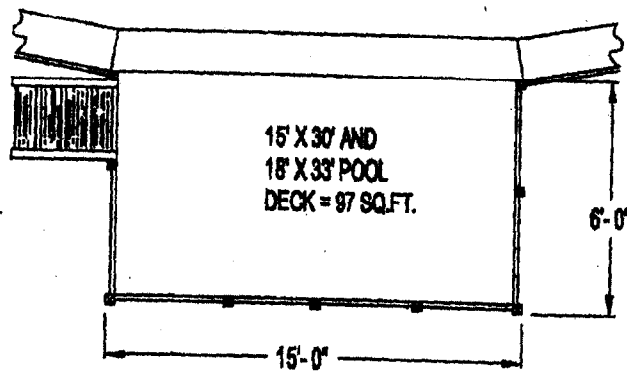

| POOL SIZE | WALKDECK SQ.FT. |
|-----------|-----------------|
| 15' X 30' | 84              |
| 18' X 33' | 97              |

## OVAL POOL END PATIO DECKS

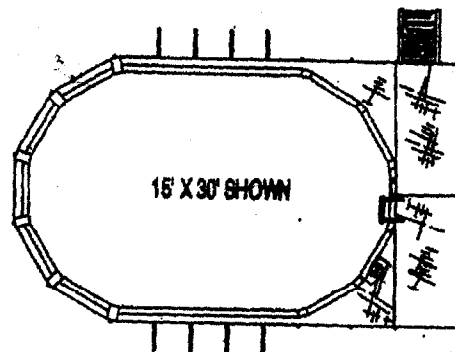
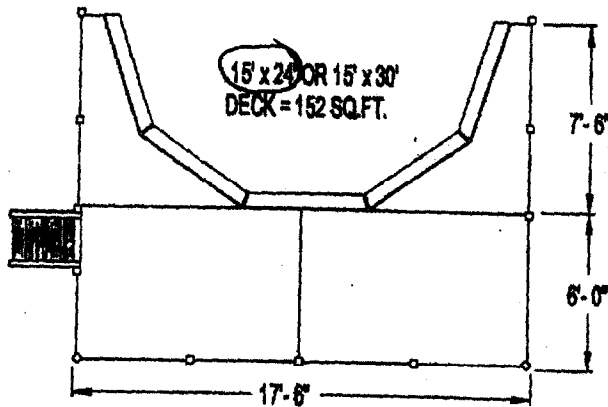

| POOL SIZE | WALKDECK SQ.FT. |
|-----------|-----------------|
| 15' X 24' | 57              |
| 15' X 30' | 73              |

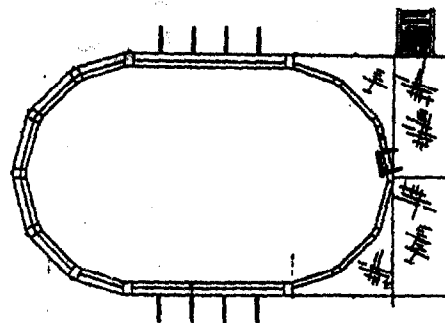
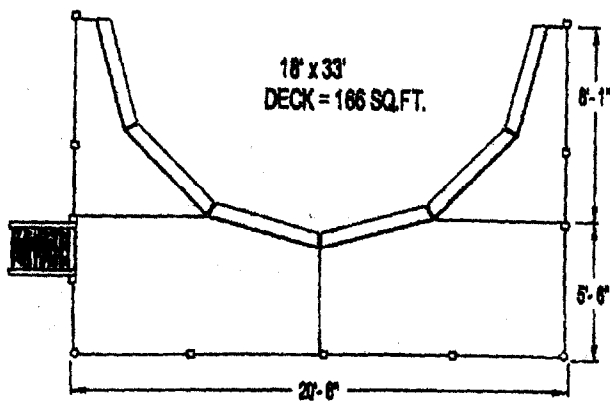

| POOL SIZE | WALKDECK SQ.FT. |
|-----------|-----------------|
| 18' X 33' | 79              |

**Johnny  
Weissmüller**

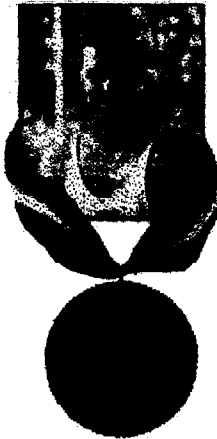

*Titan*



Titan  
Sun Master  
Ultima/LegendOval  
Legend Round  
Safari  
JW History

Accessories

Click picture to enlarge.



The Johnny Weissmüller Titan features the innovative Stealth Support System®. This compact support system allows the homeowner more pool in less space. The Titan's super strong construction, exacting design and patented extruded aluminum walls give you the best pool value on the market today. The patented interlocking extruded wall panels are thicker and stronger than ordinary wall construction. Stainless steel and aluminum hardware are used in the Titan's construction to ensure structural integrity. For additional safety and durability, the Titan features extruded aluminum coping with an electrostatically applied Duracron slip-resistant finish. Every extruded aluminum Titan pool comes standard with the Roman Flower 22 mil virgin vinyl beaded liner...a costly upgrade with other pools.

**Available Sizes:**

- 18 1/2' x 12 1/2' \* Dusty Rose Wall Only
- 21 1/2' x 12 1/2' \* Dusty Rose Wall Only
- 24' x 15'
- 30' x 15'
- 33' x 18'

Exclusive features that make the sides of the Titan straight and strong

- Extruded Aluminum Stealth Support System®
- Thick Heavy Duty Extruded Aluminum Tie Bars
- One Piece Extruded Aluminum Anchor Plate
- One Piece Extruded Aluminum Bottom Rail
- Extruded Aluminum Stiffener
- Special Extruded Aluminum Structural Uprights
- 60-year warranty



Titan options for your pool:

- Extruded Aluminum Fence...Solid chevron fence...meets or exceeds most building codes and standards- including NSPI, SBCC, BOCA and UBC.
- Promenade Walk...Full size 15" (including coping) slip-resistant extruded aluminum walkway.
- Sun Deck...Welded and carpeted at the factory for the side or end of your pool. Includes color coordinated carpet.
- Sun Deck Entrance Ladder...Made of prepainted extruded aluminum. Swings up and latches for security.
- Deluxe Stainless Steel Pool Ladder...In-pool ladder with cast aluminum anchor flanges.
- Underwater lighting...Built into wall panels. Provides attractive underwater illumination. Includes 12 volt transformer.
- Porthole-1/2 inch thick clear acrylic portholes allow underwater visibility.

**Johnny  
Weissmüller**

[Home](#) | [Delgard Fence](#) | [Swimming Pools](#) |  
[Pool Buyer's Guide](#) | [Who is Delair?](#) | [Q & A](#) |  
[Dealer Locator](#) | [Contact](#)

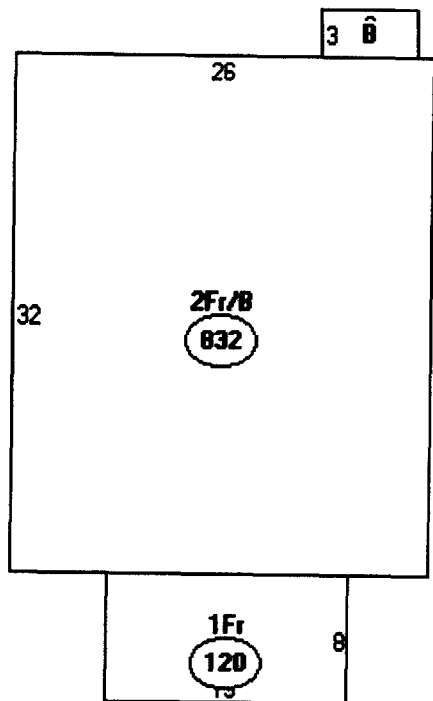

Descriptor/Area

A: 2Fr/B  
832 sqft

B: FBAY  
18 sqft

C: 1Fr  
120 sqft

970

216 garage

180 overhang

1366

152 Deck

1,518

Lot 10,320

x .25%

2,580

This page contains a detailed description of the Parcel ID you selected. Press the **New Search** button at the bottom of the screen to submit a new query.

*3 PM Rol f*

**Current Owner Information**

**Card Number** 1 of 1  
**Parcel ID** 187 8018001  
**Location** 44 EDWARDS ST  
**Land Use** SINGLE FAMILY  
  
**Owner Address** WESTPHAL ROLF N & CYNTHIA J JTS  
 44 EDWARDS ST  
 PORTLAND ME 04102  
  
**Book/Page** 13875/14  
**Legal** 187-B-18  
 EDWARDS ST 42-44  
 SCOTT ST  
 7440 SF

*# 1063*  
*R3*

**Valuation Information**

|             |                 |              |
|-------------|-----------------|--------------|
| <b>Land</b> | <b>Building</b> | <b>Total</b> |
| \$31,820    | \$91,030        | \$122,850    |

**Property Information**

|                           |                           |                          |                         |                             |                         |  |
|---------------------------|---------------------------|--------------------------|-------------------------|-----------------------------|-------------------------|--|
| <b>Year Built</b><br>1937 | <b>Style</b><br>Old Style | <b>Story Height</b><br>2 | <b>Sq. Ft.</b><br>1802  | <b>Total Acres</b><br>0.171 |                         |  |
| <b>Bedrooms</b><br>3      | <b>Full Baths</b><br>2    | <b>Half Baths</b>        | <b>Total Rooms</b><br>8 | <b>Attic</b><br>None        | <b>Basement</b><br>Full |  |

**Outbuildings**

|              |                 |                   |             |              |                  |
|--------------|-----------------|-------------------|-------------|--------------|------------------|
| <b>Type</b>  | <b>Quantity</b> | <b>Year Built</b> | <b>Size</b> | <b>Grade</b> | <b>Condition</b> |
| GARAGE-WD/CB | 1               | 1938              | 12X18       | C            | F                |
| SHEP-FRAME   | 1               | 1945              | 6X10        | C            | F                |

**Sales Information**

|             |             |              |                  |
|-------------|-------------|--------------|------------------|
| <b>Date</b> | <b>Type</b> | <b>Price</b> | <b>Book/Page</b> |
|-------------|-------------|--------------|------------------|

**Picture and Sketch**

Picture Sketch

[Click here to view Tax Roll Information.](#)

Any information concerning tax payments should be directed to the Treasury office at 874-8490 or e-mailed.



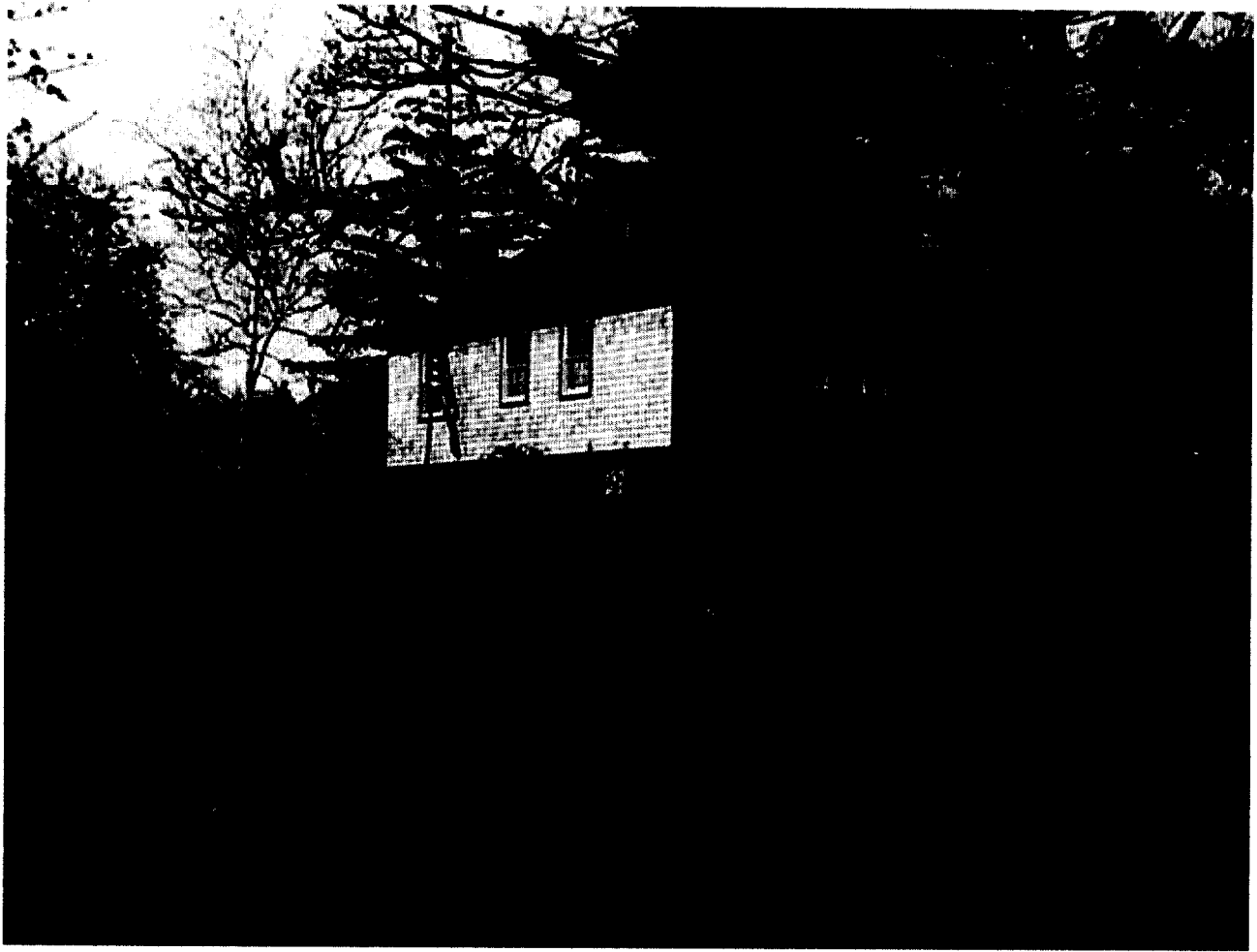

DISPLAY THIS CARD ON PRINCIPAL FRONTAGE OF WORK  
**CITY OF PORTLAND**

Please Read Application And Notes, If Any, Attached

**PERMIT**

**PERMIT ISSUED**

Permit Number: 031063  
**SEP 03 2003**

This is to certify that Westphal Rolf N &/self  
has permission to Install a 15x24 above ground pool w/pre fabricated deck attached  
AT 44 Edwards St 187 B018001

provided that the person or persons, firm or corporation accepting this permit shall comply with all of the provisions of the Statutes of Maine and of the ordinances of the City of Portland regulating the construction, maintenance and use of buildings and structures, and of the application on file in this department.

Apply to Public Works for street line and grade if nature of work requires such information.

Notification of inspection must be given and work on permit must be completed before this building or part thereof is occupied or closed-in.  
**HEAVY NOTICE IS REQUIRED.**

A certificate of occupancy must be procured by owner before this building or part thereof is occupied.

**OTHER REQUIRED APPROVALS**

Fire Dept. \_\_\_\_\_  
Health Dept. \_\_\_\_\_  
Appeal Board \_\_\_\_\_  
Other \_\_\_\_\_  
Department Name \_\_\_\_\_

*Janice Bank* 9/3/03  
Director - Building & Inspection Services

**PENALTY FOR REMOVING THIS CARD**

# BUILDING PERMIT INSPECTION PROCEDURES

Please call 874-8703 or ~~874-8693~~ to schedule your inspections as agreed upon

Permits expire in 6 months, if the project is not started or ceases for 6 months.

The Owner or their designee is required to notify the inspections office for the following inspections and provide adequate notice. Notice must be called in 48-72 hours in advance in order to schedule an inspection:

By initializing at each inspection time, you are agreeing that you understand the inspection procedure and additional fees from a "Stop Work Order" and "Stop Work Order Release" will be incurred if the procedure is not followed as stated below.

JB Pre-construction Meeting: Must be scheduled with your inspection team upon receipt of this permit. Jay Reynolds, Development Review Coordinator at ~~874-8632~~ must also be contacted at this time, before any site work begins on any project other than single family additions or alterations.

- 9/3/03 ✓ Footing/Building Location Inspection: Prior to pouring concrete
- NA Re-Bar Schedule Inspection: Prior to pouring concrete
- NA Foundation Inspection: Pump Prior to placing ANY backfill
- ✓ Framing/Rough Plumbing/Electrical: Prior to any insulating or drywalling
- ✓ Final/~~Certificate of Occupancy~~: Prior to any occupancy of the structure or use. NOTE: ~~There is a \$75.00 fee per~~ inspection at this point.

Certificate of Occupancy is not required for certain projects. Your inspector can advise you if your project requires a Certificate of Occupancy. All projects DO require a final inspection

✓ If any of the inspections do not occur, the project cannot go on to the next phase, REGARDLESS OF THE NOTICE OR CIRCUMSTANCES.

NA **CERTIFICATE OF OCCUPANICES MUST BE ISSUED AND PAID FOR, BEFORE THE SPACE MAY BE OCCUPIED**

x Kelly W...  
Signature of applicant/designee

9/3/03  
Date

Jamie Banke  
Signature of Inspections Official

9/3/03  
Date

CBL: 187-B-18 Building Permit #: 03-1063 \*