

FOR MORTGAGE LENDER USE ONLY

GENERAL NOTES: (1) DISTANCES SHOWN ARE TAKEN FROM PROVIDED TITLE REFERENCES SHOWN BELOW. (2) THIS INSPECTION EXAMINES DWELLING AND ACCESSORY STRUCTURE COMPLIANCE WITH RESPECT TO MUNICIPAL ZONING SETBACK REQUIREMENTS ONLY. (3) A STANDARD BOUNDARY SURVEY SHOULD BE PERFORMED TO RENDER A PROFESSIONAL OPINION AS TO ACTUAL PROPERTY LINE LOCATIONS. (4) THIS INSPECTION DEPICTS ALL VISIBLE STRUCTURAL ENCROACHMENTS WITH RESPECT TO APPARENT PROPERTY LINES AND RECOGNIZES (5) THOSE EASEMENTS & RIGHTS OF WAY'S STATED OR SHOWN IN BELOW PROVIDED TITLE REFERENCES AND DOES NOT REVEAL ANY DEFECTS WITH ABUTTING DEEDS. (6) FLOOD HAZARD DETERMINATION IS MADE BY SCALING DISTANCES ON BELOW REFERENCED FEMA MAP. (7) THIS INSPECTION IS TO BE USED ONLY BY BELOW LISTED LENDER, TITLE COMPANY &/OR ATTORNEY AND ITS TITLE INSURER

ADDRESS: 170 WHITNEY AVE
PORTLAND, ME

INSPECTION DATE: 5-28-99
SCALE: 1" = 20'

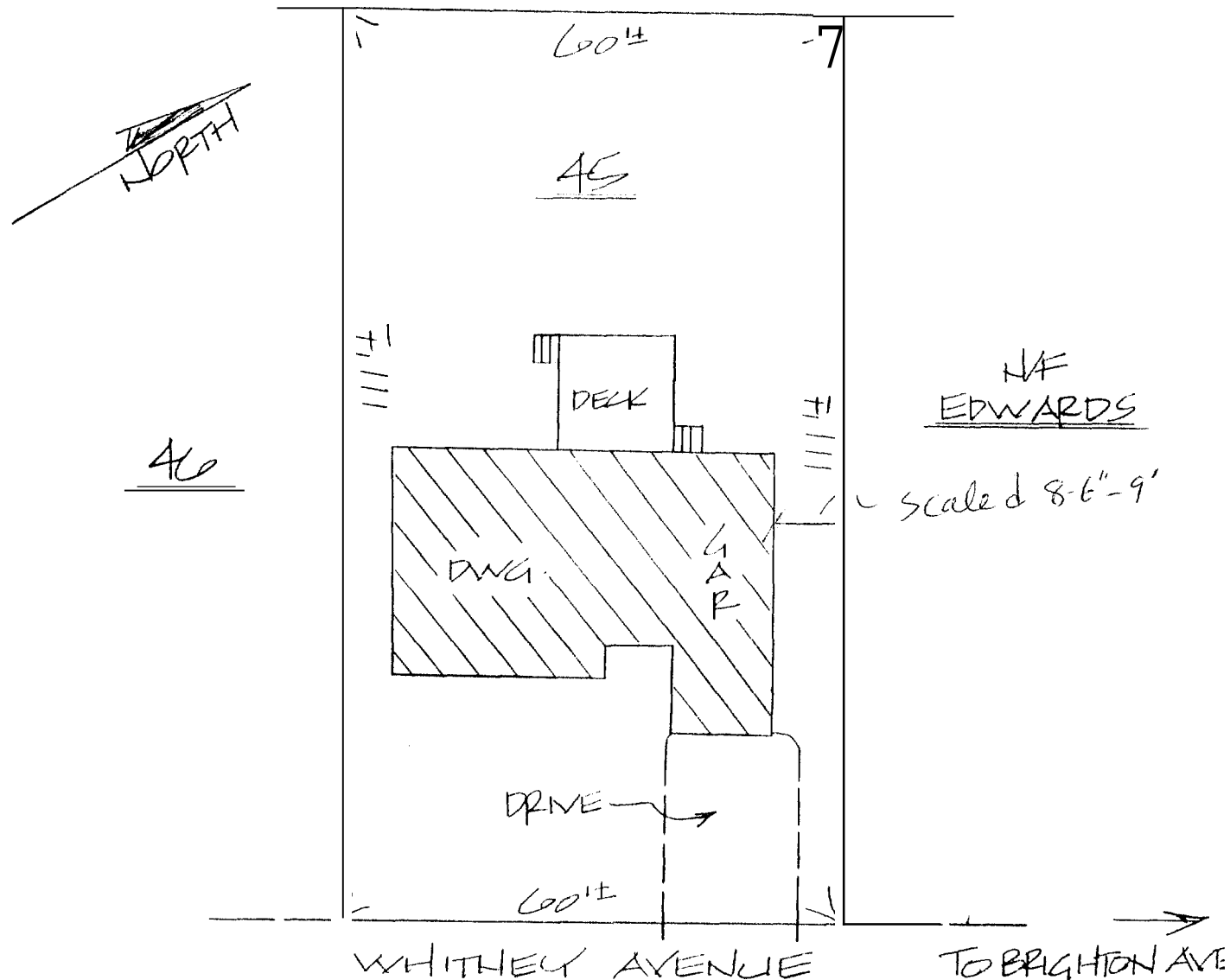

SEE PROVIDED TITLE REFERENCES FOR APPLICABLE APPURTENANCES, IF ANY.

APPLICANT: FEDER REQUESTING PARTY: FIDELITY TITLE CO
OWNER: SAME ATTORNEY: THOMAS POWERS
LENDER: INFINITY F.C.U. FILE No. 990305

TITLE REFERENCES:

DEED BOOK: PAGE:
PLAN BOOK: 10 PAGE: 113 LOT: 45
COUNTY: LUMBERLAND

MUNICIPAL REFERENCE:

MAP: 1800A BLOCK: B LOT: 15

THE DWELLING DOES NOT FALL WITHIN A SPECIAL FLOOD HAZARD ZONE PER FEMA COMMUNITY MAP No. 232051
PANEL 0013B ZONE: C DATE: 12-8-98

THE DWELLING WAS IN COMPLIANCE WITH MUNICIPAL ZONING SETBACK REQUIREMENTS AT THE TIME OF CONSTRUCTION.

COMMENTS:

YOUR FILE #: TE3542

NADEAU & LODGE, INC. PROFESSIONAL LAND SURVEYORS

844 STEVENS AVENUE
PORTLAND, ME 04103
(207) 878-7870

232 CLARKS WOODS ROAD
LYMAN, ME 04002
(207) 499-2358

James D. Fidelity

THIS IS NOT A BOUNDARY SURVEY - NOT FOR RECORDING