

72-74 MASSACHUSETTS AVENUE

 SHAW-WALKER  
#9203-1R



# APPLICATION FOR PERMIT

Class of Building or Type of Structure \_\_\_\_\_  
Portland, Maine, February 9, 1970

PERMIT ISSUED

FEB 11 1970

CITY OF PORTLAND

To the INSPECTOR OF BUILDINGS, PORTLAND, MAINE

The undersigned hereby applies for a permit to erect alter repair demolish install the following building structure equipment in accordance with the Laws of the State of Maine, the Building Code and Zoning Ordinance of the City of Portland, plans and specifications, if any, submitted herewith and the following specifications:

Location 74 Massachusetts Ave. Within Fire Limits? \_\_\_\_\_ Dist. No. \_\_\_\_\_  
Owner's name and address Joseph Macais, 74 Mass. Ave. Telephone \_\_\_\_\_  
Lessee's name and address \_\_\_\_\_ Telephone \_\_\_\_\_  
Contractor's name and address All State Home Imp Co., 217 Brighton Ave. Telephone \_\_\_\_\_  
Architect \_\_\_\_\_ Specifications \_\_\_\_\_ Plans \_\_\_\_\_ No. of sheets \_\_\_\_\_  
Proposed use of building Dwelling No. families 1  
Last use \_\_\_\_\_ No. families \_\_\_\_\_  
Material frame No. stories 1 1/2 Heat \_\_\_\_\_ Style of roof \_\_\_\_\_ Roofing \_\_\_\_\_  
Other buildings on same lot \_\_\_\_\_  
Estimated cost \$ \_\_\_\_\_ Fee \$ 5.00

### General Description of New Work

To cover outside walls of building with aluminum siding

It is understood that this permit does not include installation of heating apparatus which is to be taken out separately by and in the name of the heating contractor. **PERMIT TO BE ISSUED TO** contractor

### Details of New Work

Is any plumbing involved in this work? \_\_\_\_\_ Is any electrical work involved in this work? \_\_\_\_\_  
Is connection to be made to public sewer? \_\_\_\_\_ If not, what is proposed for sewage? \_\_\_\_\_  
Has septic tank notice been sent? \_\_\_\_\_ Form notice sent? \_\_\_\_\_  
Height average grade to top of plate \_\_\_\_\_ Height average grade to highest point of roof \_\_\_\_\_  
Size, front \_\_\_\_\_ depth \_\_\_\_\_ No. stories \_\_\_\_\_ solid or filled land? \_\_\_\_\_ earth or rock? \_\_\_\_\_  
Material of foundation \_\_\_\_\_ Thickness, top \_\_\_\_\_ bottom \_\_\_\_\_ cellar \_\_\_\_\_  
Kind of roof \_\_\_\_\_ Rise per foot \_\_\_\_\_ Roof covering \_\_\_\_\_  
No. of chimneys \_\_\_\_\_ Material of chimneys \_\_\_\_\_ of lining \_\_\_\_\_ Kind of heat \_\_\_\_\_ fuel \_\_\_\_\_  
Framing Lumber—Kind \_\_\_\_\_ Dressed or full size? \_\_\_\_\_ Corner posts \_\_\_\_\_ Sills \_\_\_\_\_  
Size Girder \_\_\_\_\_ Columns under girders \_\_\_\_\_ Size \_\_\_\_\_ Max. on centers \_\_\_\_\_  
Studs (outside walls and carrying partitions) 2x4-16" O. C. Bridging in every floor and flat roof span over 8 feet.  
Joists and rafters: 1st floor \_\_\_\_\_, 2nd \_\_\_\_\_, 3rd \_\_\_\_\_, roof \_\_\_\_\_  
On centers: 1st floor \_\_\_\_\_, 2nd \_\_\_\_\_, 3rd \_\_\_\_\_, roof \_\_\_\_\_  
Maximum span: 1st floor \_\_\_\_\_, 2nd \_\_\_\_\_, 3rd \_\_\_\_\_, roof \_\_\_\_\_  
If one story building with masonry walls, thickness of walls? \_\_\_\_\_ height? \_\_\_\_\_

### If a Garage

No. cars now accommodated on same lot \_\_\_\_\_, to be accommodated \_\_\_\_\_ number commercial cars to be accommodated \_\_\_\_\_  
Will automobile repairing be done other than minor repairs to cars habitually stored in the proposed building? \_\_\_\_\_

APPROVED:

\_\_\_\_\_  
\_\_\_\_\_  
\_\_\_\_\_

### Miscellaneous

Will work require disturbing of any tree on a public street? no  
Will there be in charge of the above work a person competent to see that the State and City requirements pertaining thereto are observed? yes

All State Home Imp. Co.

CS 301

FILE COPY

Signature of owner

BY: John A. Little



NOTES

Permit No. 57/134  
Location 144-145th St. & 42nd Ave. S.W.  
Owner Edgar J. ...  
Date of permit 11/1/59  
Approved \_\_\_\_\_

1	DATE	
2	DESCRIPTION	
3	AMOUNT	
4	PERCENT	
5	TOTAL	
6	REMARKS	
7	DATE	
8	DESCRIPTION	
9	AMOUNT	
10	PERCENT	
11	TOTAL	
12	REMARKS	
13	DATE	
14	DESCRIPTION	
15	AMOUNT	
16	PERCENT	
17	TOTAL	
18	REMARKS	
19	DATE	
20	DESCRIPTION	
21	AMOUNT	
22	PERCENT	
23	TOTAL	
24	REMARKS	
25	DATE	
26	DESCRIPTION	
27	AMOUNT	
28	PERCENT	
29	TOTAL	
30	REMARKS	

5-5-59 Completed

*(Large handwritten X)*

115-D-19 p. 1 of 2

10-7-53

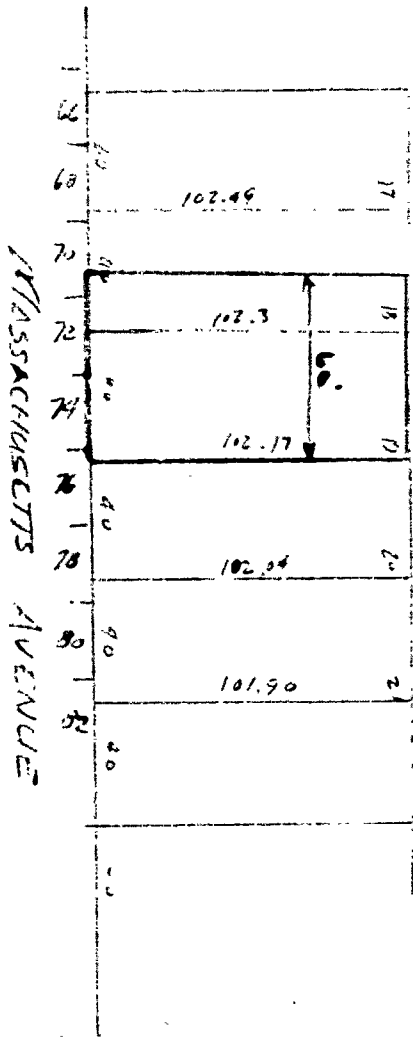



# APPLICATION FOR PERMIT

Class of Building or Type of Structure Third Class  
Portland, Maine, Oct. 7, 1958

PERMIT NO. 01407  
OCT 7 1958

To the INSPECTOR OF BUILDINGS, PORTLAND, MAINE

The undersigned hereby applies for a permit to erect ~~alter-repair-remolish~~ install the following building structure equipment in accordance with the Laws of the State of Maine, the Building Code and Zoning Ordinance of the City of Portland, plans and specifications, if any, submitted herewith and the following specifications:

Location 11-74 Massachusetts Ave. Within Fire Limits? no Dist. No. \_\_\_\_\_  
 Owner's name and address Peter Lascanio, 28 Bayland St. Telephone \_\_\_\_\_  
 Lessee's name and address \_\_\_\_\_ Telephone \_\_\_\_\_  
 Contractor's name and address owner Telephone 4-2588  
 Architect \_\_\_\_\_ Specifications \_\_\_\_\_ Plans yes No. of sheets 5  
 Proposed use of building Dwelling No. families 1  
 Last use \_\_\_\_\_ No. families \_\_\_\_\_  
 Material frame No. stories 1 1/2 Heat \_\_\_\_\_ Style of roof \_\_\_\_\_ Roofing \_\_\_\_\_  
 Other building on same lot \_\_\_\_\_  
 Estimated cost \$ 10,000 Fee \$ 10.00

### General Description of New Work

To construct 1 1/2-story frame dwelling house 24' x 32'

It is understood that this permit does not include installation of heating apparatus which is to be taken out separately by and in the name of the heating contractor. PERMIT TO BE ISSUED TO owner

### Details of New Work

Is any plumbing involved in this work? yes Is any electrical work involved in this work? yes  
 Is connection to be made to public sewer? yes If not, what is proposed for sewage? \_\_\_\_\_  
 Has septic tank notice been sent? \_\_\_\_\_ Form notice sent? yes  
 Height average grade to top of plate 10' Height average grade to highest point of roof 18'  
 Size front 32' depth 24' No. stories 1 1/2 solid or filled land? solid earth or rock? earth  
 Material of foundation concrete at least 4' below grade Thickness, top 10" bottom 12" cellar yes  
 Material of underpinning " to sill \_\_\_\_\_ Height \_\_\_\_\_ Thickness \_\_\_\_\_  
 Kind of roof pitch Rise per foot 10" Roof covering Asphalt Class C Urd. Lab.  
 No. of chimneys 1 Material of chimneys brick of lining tile Kind of heat f.h. water fuel oil  
 Framing Lumber—Kind hemlock Dressed or full size? dressed Corner posts 4x6 Sills 2x8 box  
 Size Girder 6x10 fir Columns under girders lally Size 3" Max. on centers 7'5"  
 Kind and thickness of outside sheathing of exterior walls? \_\_\_\_\_  
 Studs (outside walls and carrying partitions) 2x4-16" O. C. Bridging in every floor and flat roof span over 8 feet.  
 Joists and rafters: 1st floor 2x6, 2nd 2x8 ceiling, 3rd \_\_\_\_\_, roof 2x8  
 On centers: 1st floor 16", 2nd 16", 3rd \_\_\_\_\_, roof 20"  
 Maximum span: 1st floor 12', 2nd \_\_\_\_\_, 3rd \_\_\_\_\_, roof 16'

If one story building with masonry walls, thickness of walls? \_\_\_\_\_ height? \_\_\_\_\_

### If a Garage

No. cars now accommodated on same lot \_\_\_\_\_, to be accommodated \_\_\_\_\_ number commercial cars to be accommodated \_\_\_\_\_  
 Will automobile repairing be done other than minor repairs to cars habitually stored in the proposed building? \_\_\_\_\_

APPROVED:  
OK 10-7-58 TTR

### Miscellaneous

Will work require disturbing of any tree on a public street? no  
 Will there be in charge of the above work a person competent to see that the State and City requirements pertaining thereto are observed? yes  
Peter Lascanio

INSPECTION COPY agl Signature of owner by: Peter R. Lascanio

Fm

NOTES

10-13-58 Forms OK  
 10-28-58 R.K. to QIA  
 close in QIA  
 5-5-59 Final all OK.

11/20

X

Permit No. 58/1497

Location 72-74 Massachusetts St

Owner Fleece Dan Curcio

Date of permit 10/7/58

Notif. closing-in

Inspn. closing-in 10-28-58 QIE

Final Notif:

Final Inspn. 5-5-59 QIE

Cert. of Occupancy issued 5/5/59 QIE

Staking Out Notice

Form Check Notice

(COPY)



CITY OF PORTLAND, MAINE  
Department of Building Inspection

### Certificate of Occupancy

LOCATION 72-74 Massachusetts Ave.

Issued to Peter Pacciano, 38 Mayland St.

Date of Issue May 5, 1959

This is to certify that the building, premises, or part thereof, at the above location, built—altered—changed as to use under Building Permit No. 52/1407, has had final inspection, has been found to conform substantially to requirements of Zoning Ordinance and Building Code of the City, and is hereby approved for occupancy or use, limited or otherwise, as indicated below.

PORTION OF BUILDING OR PREMISES  
Entire

APPROVED OCCUPANCY  
One family dwelling house

Limiting Conditions:

This certificate supersedes  
certificate issued

Approved:

*Nelson F. Cartwright*  
(Date) Inspector

*Albert J. Sears*  
Inspector of Buildings

Notice: This certificate identifies lawful use of building or premises, and ought to be transferred from owner to owner when property changes hands. Copy will be furnished to owner or lessee for one dollar.

