

Cross Section → Floor / Ceiling 1st → 2nd Floor

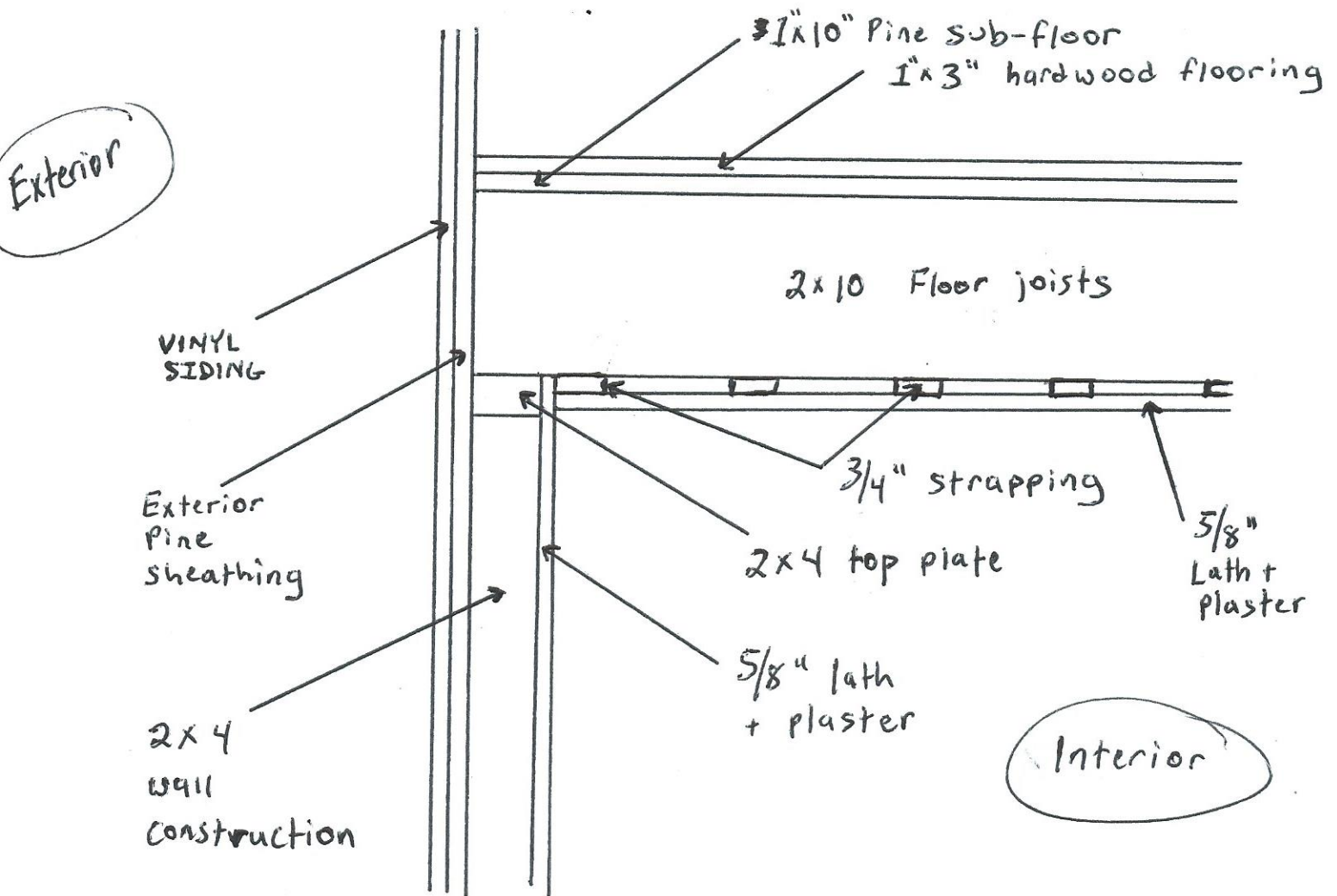

Plan for work: lath and plaster will be removed from all walls and ceilings. Strapping will be removed. Insulation will be added to walls: R-19 Batted, backed insulation. R-19 batted, backed insulation and 1/2" sound board will be added to ceilings. 5/8" wall board will be hung on walls. 1/2" wall board will be hung on ceilings.