

87 WHITNEY AVE.

R-5

REAR: 20' min - 50' plus shown  
Side: (1 story) 8' min - 12' plus shown  
FRONT: 20' min - 25' indicated

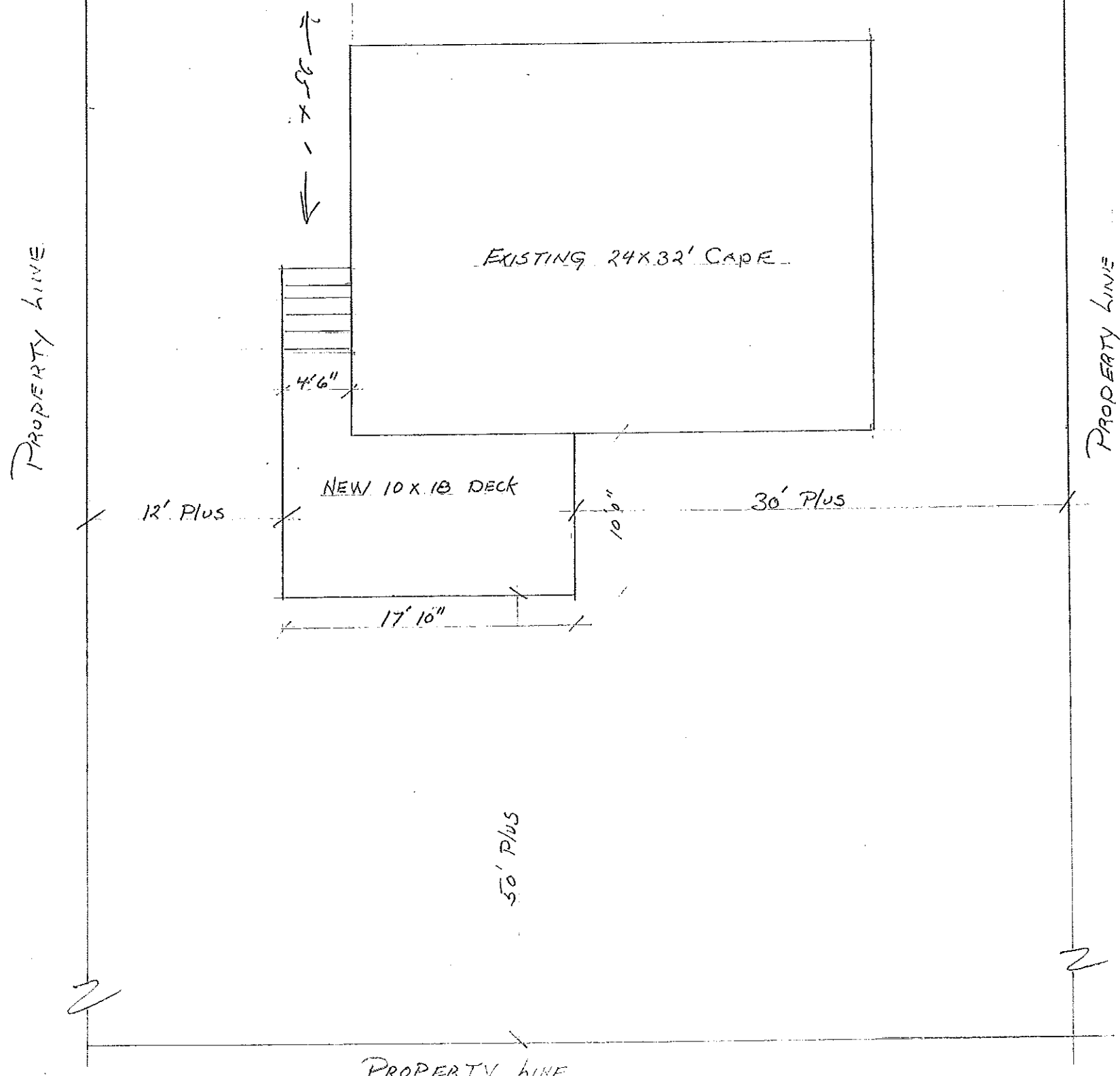

RECEIVED  
MAR 28 2012  
Dept. of Building Inspections  
City of Portland Maine

4'6"  
7'0"  
10'0"  
1'6"

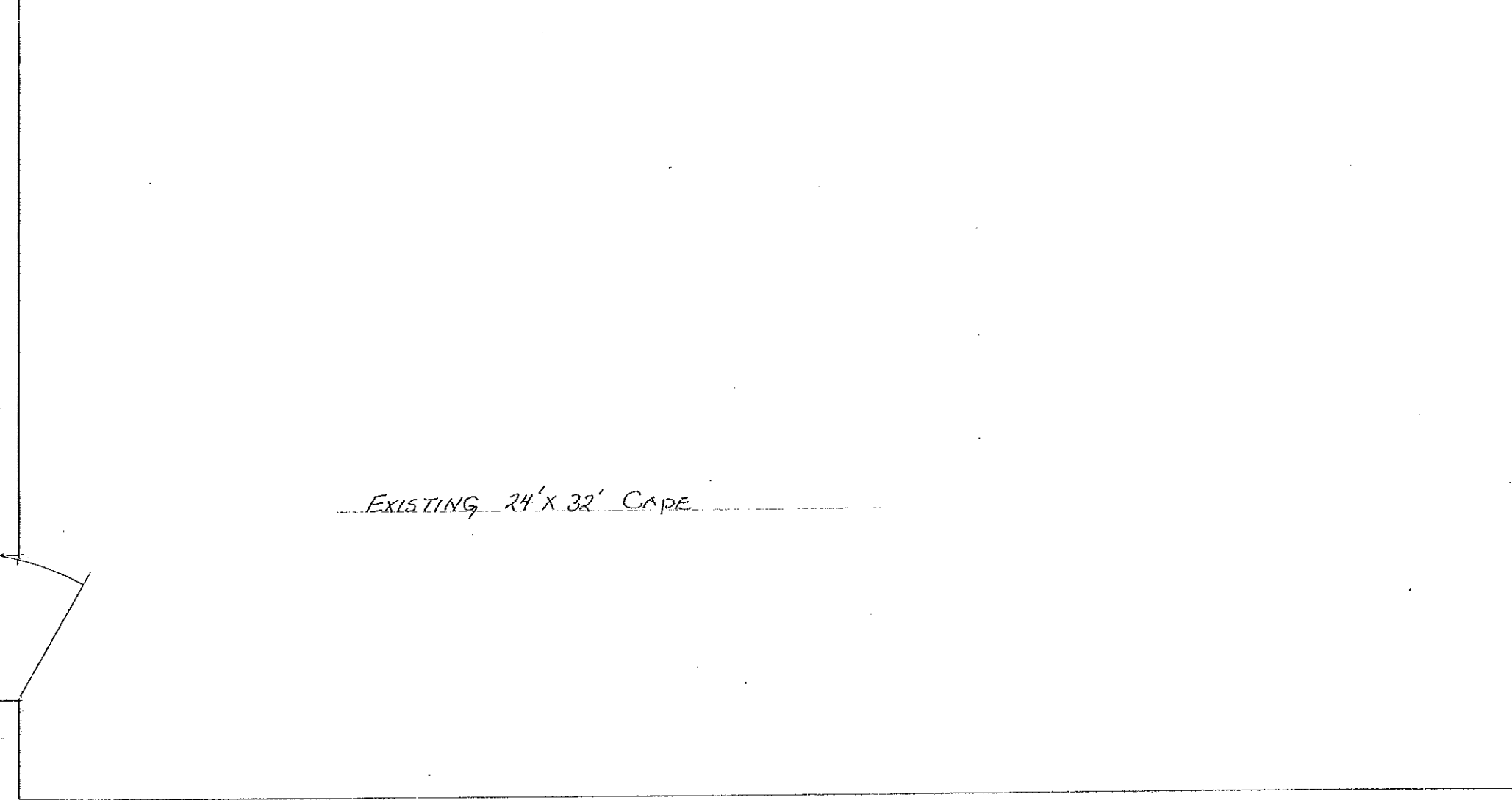
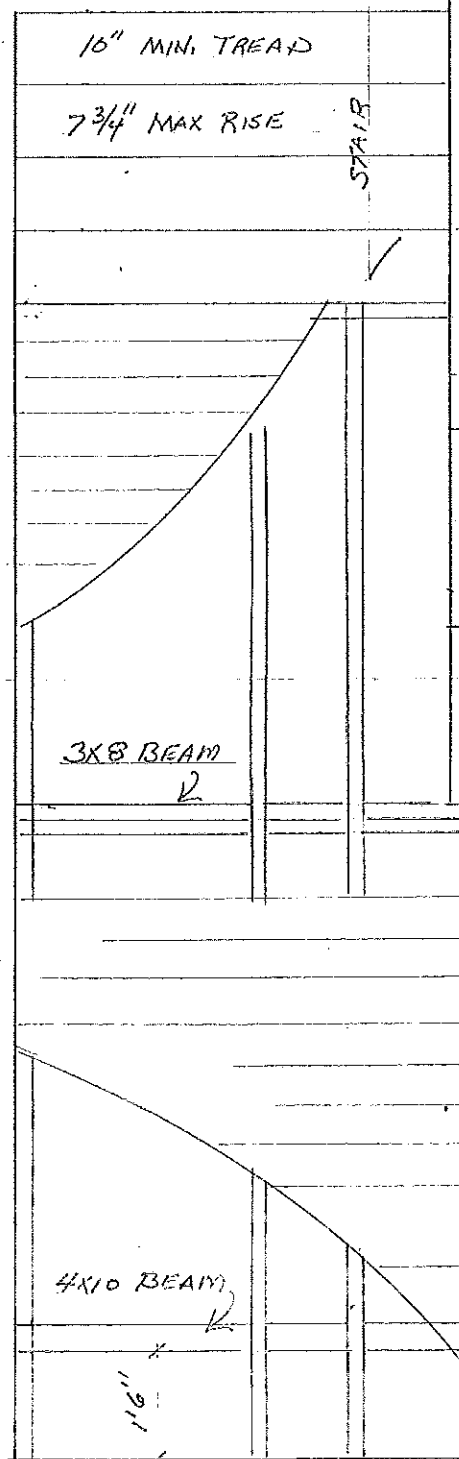

EXISTING 24' X 32' CAPE

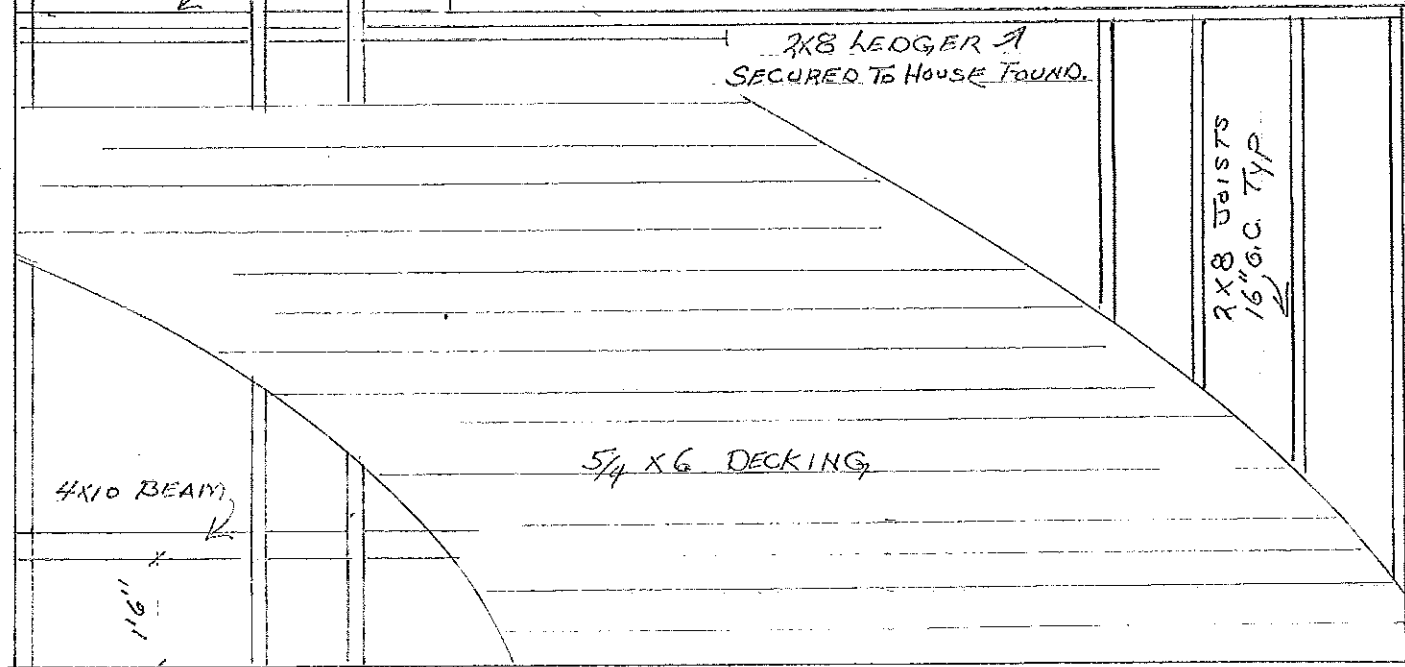

17' 10"

10'0"

10" MIN. TREAD  
7 3/4" MAX RISE

STAIR

3 X 8 BEAM

2 X 8 LEDGER  
SECURED TO HOUSE FOUND.

2 X 8 BEAMS  
16" O.C. TYP

5/4 X 6 DECKING

4 X 10 BEAM

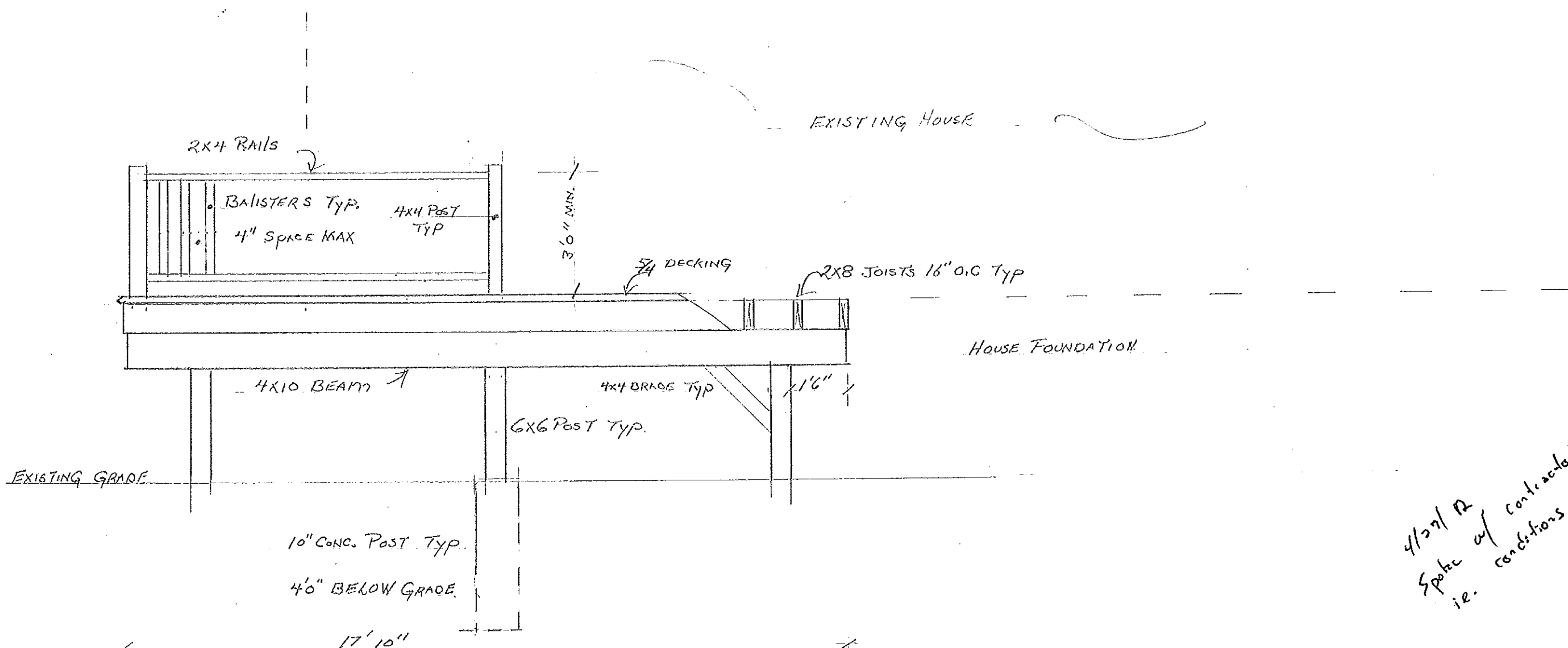

4/27/12  
 Spoke w/ contractor  
 re. conditions of permit  
 @

