

City of Portland, Maine - Building or Use Permit Application

389 Congress Street, 04101 Tel: (207) 874-8703, Fax: (207) 874-8716

Permit No: 03-1279	Issue Date:	CBL: 186 C014001
-----------------------	-------------	---------------------

Location of Construction: 49 Whitney Ave	Owner Name: Petersen Mabelle S	Owner Address: 51 Whitney Ave	Phone:
Business Name:	Contractor Name: Maine Wide	Contractor Address: PO Box 2106 Augusta	Phone 8004521940
Lessee/Buyer's Name	Phone:	Permit Type: Additions - Dwellings	Zone:

Past Use: Single Family	Proposed Use: Single Family w/replacement 20' x 24' garage in same footprint	Permit Fee: \$102.00	Cost of Work: \$8,540.00	CEO District: 3
Proposed Project Description: Replace 20' x 24' garage that has collapsed in same footprint		FIRE DEPT: <input type="checkbox"/> Approved <input type="checkbox"/> Denied	INSPECTION: Use Group: Type:	
		Signature:	Signature:	
PEDESTRIAN ACTIVITIES DISTRICT (P.A.D.)				
Action: <input type="checkbox"/> Approved <input type="checkbox"/> Approved w/Conditions <input type="checkbox"/> Denied				
Signature: Date:				

Permit Taken By: kwd	Date Applied For: 10/01/2003	Zoning Approval		
1. This permit application does not preclude the Applicant(s) from meeting applicable State and Federal Rules. 2. Building permits do not include plumbing, septic or electrical work. 3. Building permits are void if work is not started within six (6) months of the date of issuance. False information may invalidate a building permit and stop all work..	Special Zone or Reviews <input type="checkbox"/> Shoreland <input type="checkbox"/> Wetland <input type="checkbox"/> Flood Zone <input type="checkbox"/> Subdivision <input type="checkbox"/> Site Plan Maj <input type="checkbox"/> Minor <input type="checkbox"/> MM <input type="checkbox"/> Date:	Zoning Appeal <input type="checkbox"/> Variance <input type="checkbox"/> Miscellaneous <input type="checkbox"/> Conditional Use <input type="checkbox"/> Interpretation <input type="checkbox"/> Approved <input type="checkbox"/> Denied Date:	Historic Preservation <input type="checkbox"/> Not in District or Landmark <input type="checkbox"/> Does Not Require Review <input type="checkbox"/> Requires Review <input type="checkbox"/> Approved <input type="checkbox"/> Approved w/Conditions <input type="checkbox"/> Denied Date:	

Expired

CERTIFICATION

I hereby certify that I am the owner of record of the named property, or that the proposed work is authorized by the owner of record and that I have been authorized by the owner to make this application as his authorized agent and I agree to conform to all applicable laws of this jurisdiction. In addition, if a permit for work described in the application is issued, I certify that the code official's authorized representative shall have the authority to enter all areas covered by such permit at any reasonable hour to enforce the provision of the code(s) applicable to such permit.

SIGNATURE OF APPLICANT	ADDRESS	DATE	PHONE
------------------------	---------	------	-------

RESPONSIBLE PERSON IN CHARGE OF WORK, TITLE	DATE	PHONE
---	------	-------

All Purpose Building Permit Application

If you or the property owner owes real estate or personal property taxes or user charges on any property within the City, payment arrangements must be made before permits of any kind are accepted.

Location/Address of Construction: 51+52 Whitney Avenue Zone R5		
Total Square Footage of Proposed Structure 480 SF	Square Footage of Lot 6,355 SF	
Tax Assessor's Chart, Block & Lot Chart# 186 Block# C Lot# 14	Owner: Nancy Peterson	Telephone: 733-4556
Lessee/Buyer's Name (If Applicable) N/A	Applicant name, address & telephone: Nancy Peterson 51+52 Whitney Avenue Portland ME 04103	Cost Of Work: \$ 8,540 Fee: \$ 102 ⁰⁰
Current use: Residential House		
If the location is currently vacant, what was prior use: N/A		
Approximately how long has it been vacant: N/A		
Proposed use: Residential Garage		
Project description: 24 W x 20 L Garage as per plot plan & cross section to replace collapsed garage of same size & location		
Contractor's name, address & telephone: MAINE-WIDE CONSTRUCTION 1-800-452-1940 POB 2106, AUGUSTA ME 04338-2106		
Who should we contact when the permit is ready: MAINE-WIDE CONSTRUCTION		
Mailing address: POB 2106, AUGUSTA ME 04338-2106		
Phone: 800-452-1940		



IF THE REQUIRED INFORMATION IS NOT INCLUDED IN THE SUBMISSIONS THE PERMIT WILL BE AUTOMATICALLY DENIED AT THE DISCRETION OF THE BUILDING/PLANNING DEPARTMENT, WE MAY REQUIRE ADDITIONAL INFORMATION IN ORDER TO APPROVE THIS PERMIT.

I hereby certify that I am the Owner of record of the named property, or that the owner of record authorizes the proposed work and that I have been authorized by the owner to make this application as his/her authorized agent. I agree to conform to all applicable laws of this jurisdiction. In addition, if a permit for work described in this application is issued, I certify that the Code Official's authorized representative shall have the authority to enter all areas covered by this permit at any reasonable hour to enforce the provisions of the codes applicable to this permit.

Signature of applicant: N. Peterson/maine-wide	Date: 9-29-03
--	---------------

This is not a permit, you may not commence ANY work until the permit is issued

BY
MCI

MAINE-WIDE CONSTRUCTION, INC.

1-800-452-1940

P.O. Box 2106, Augusta, ME 04338-2106

Fax: 207-622-7528

SC

CROSS SECTION: R. P.

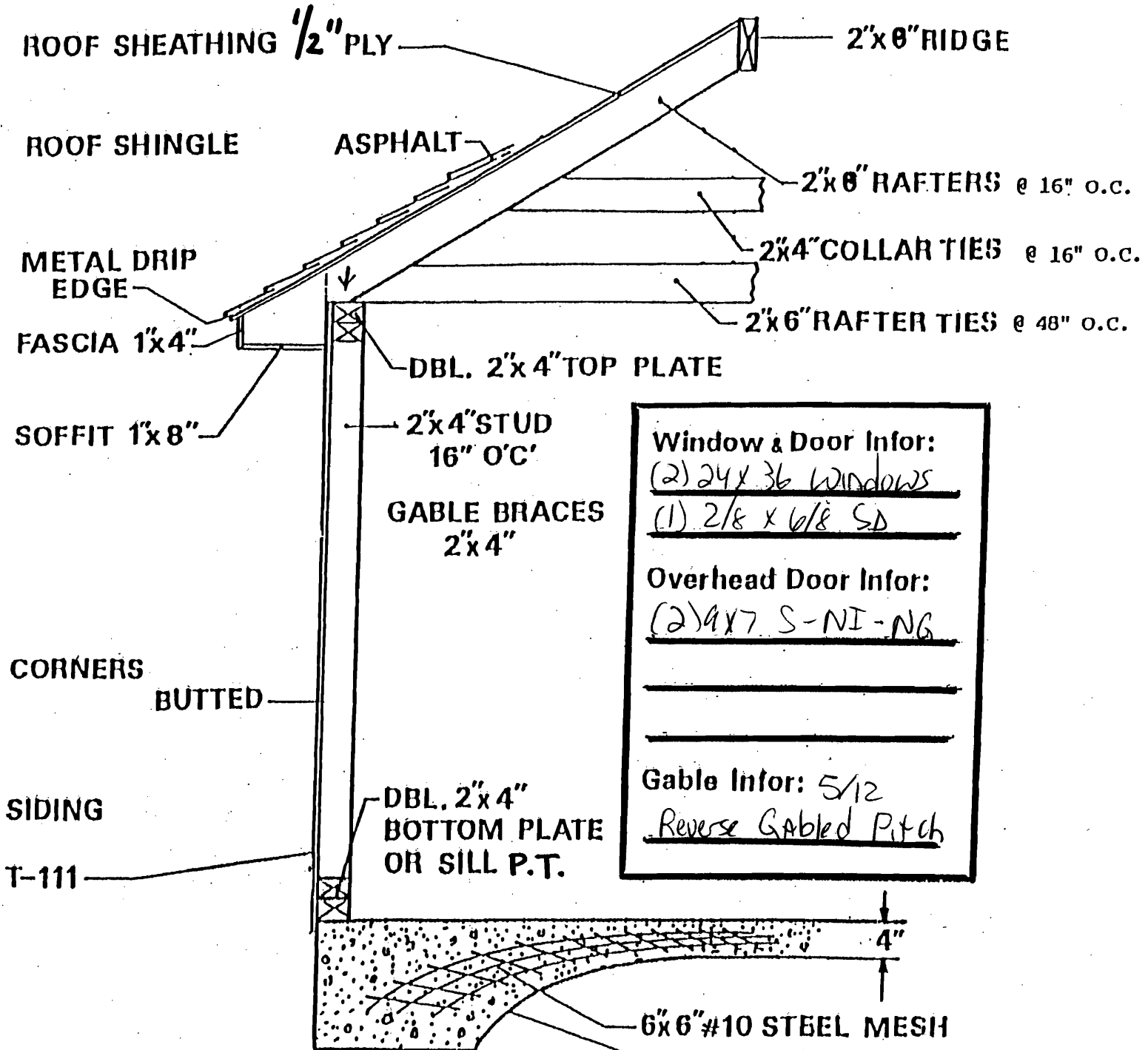

Anchor bolts in slab
 Db1 2x10 Headers over OHD(s)
 2x6 Headers over Service Door & Windows
 Studded Gables
 2x8 Ridge & Rafters

UNHEATED BUILDINGS

Additional measures are required when using a FPSF on an unheated building. While a drainage layer is only recommended under wing insulation for heated buildings, a 6-inch drainage layer is always required under unheated FPSF designs. Additionally, the horizontal ground insulation extends not only as a wing beyond the perimeter of the building, but continues under the entire unheated portion of the building. This insulation layer can be installed either directly under the slab as shown in Figure 18, or entirely at one level as shown in Figure 19. In either case, the compressive load of the building on the insulation must be determined to compare to the compressive resistance of the foam (see design examples). The horizontal insulation must have a minimum of 10 inches of soil cover.

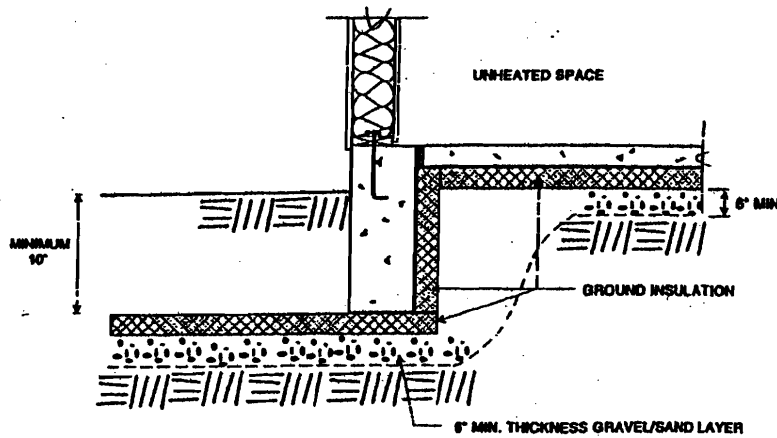

Figure 18. FPSF Design for Unheated Space with Independent Slab and Stem Wall.

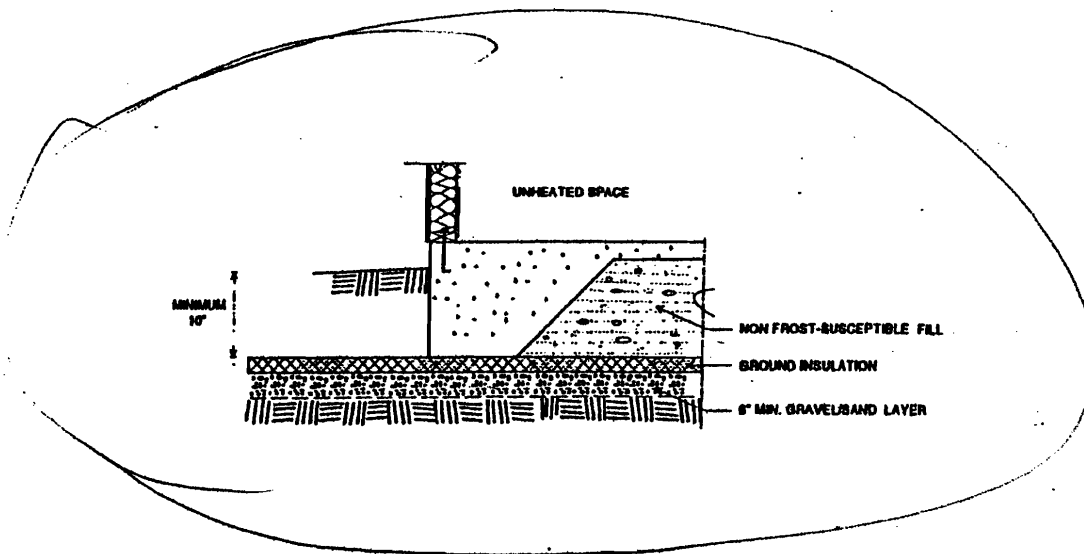
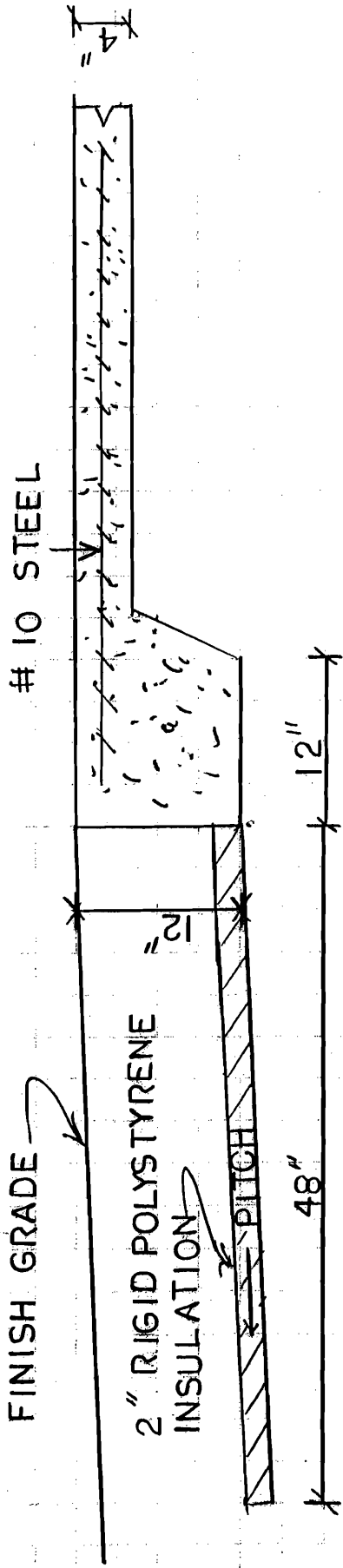
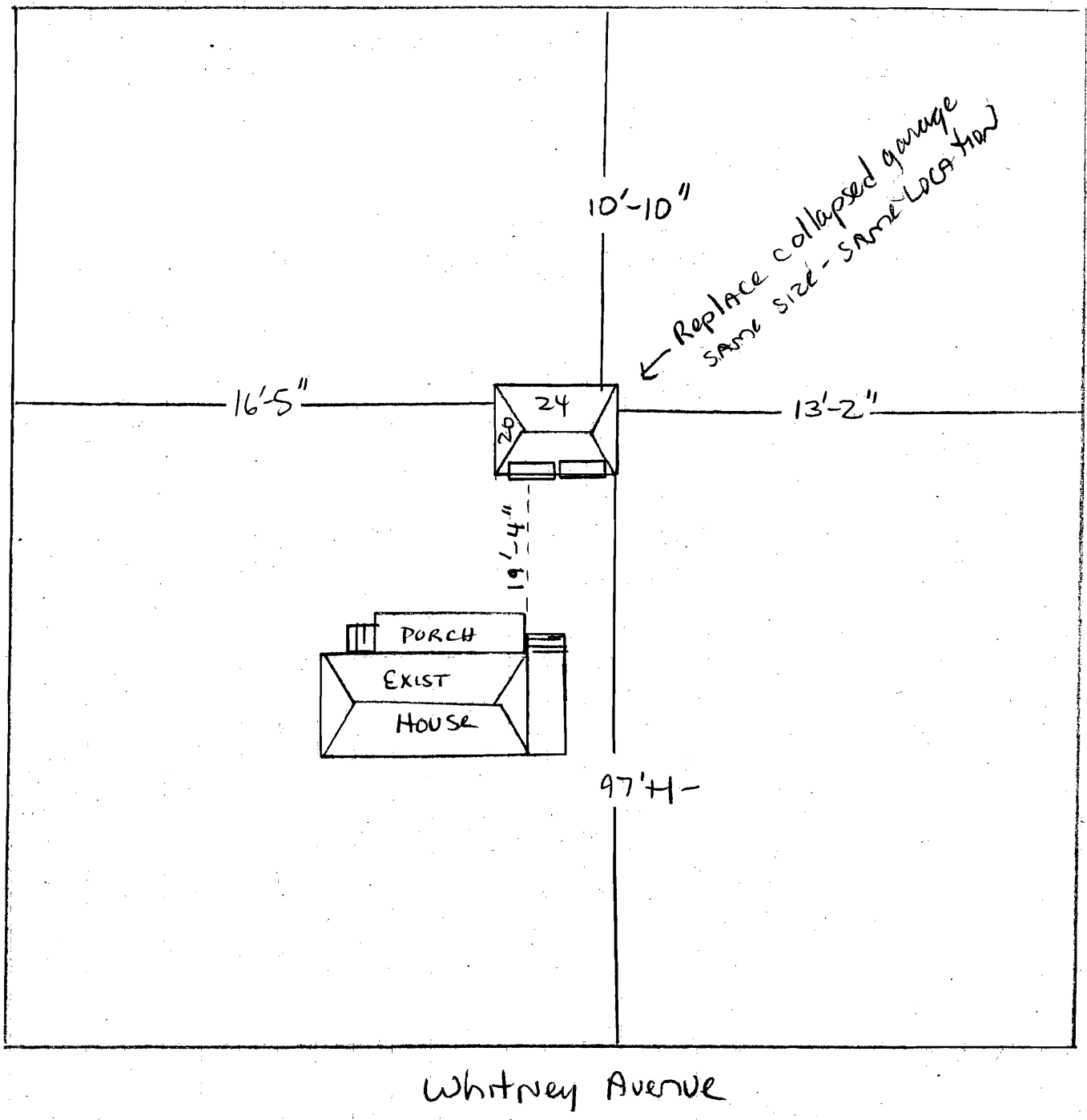

Figure 19. FPSF Design for Unheated Buildings with Insulation in Single Plane.



		MAKING-WIDE CONSTRUCTION INC.	
Scale 1/4" = 1'-0"	Approved By	Drawn By	JTC
Date 12-19-01		Period	
Drawn For	FROST RESISTANT SCAB		
Location			Drawing # 1

Nancy Petersen
51 + 52 Whitney Avenue



City of Portland, Maine - Building or Use Permit

389 Congress Street, 04101 Tel: (207) 874-8703, Fax: (207) 874-8716

Permit No: 03-1279	Date Applied For: 10/01/2003	CBL: 186 C014001
------------------------------	--	----------------------------

Location of Construction: 49 Whitney Ave	Owner Name: Petersen Mabelle S	Owner Address: 51 Whitney Ave	Phone:
Business Name:	Contractor Name: Maine Wide	Contractor Address: PO Box 2106 Augusta	Phone: (800) 452-1940
Lessee/Buyer's Name	Phone:	Permit Type: Additions - Dwellings	

Proposed Use: Single Family w/replacement 20' x 24' garage in same footprint	Proposed Project Description: Replace 20' x 24' garage that has collapsed in same footprint
--	---

Dept: Zoning	Status: Pending	Reviewer: Tammy Munson	Approval Date:	Ok to Issue: <input type="checkbox"/>
Note:				
Dept: Building	Status: Pending	Reviewer: Tammy Munson	Approval Date:	Ok to Issue: <input type="checkbox"/>
Note:				

Comments: 10/20/2003-kwd: this permit was originally entered as #03-1207, a duplicat permit number. Duplication discovered on 10/17/2003, corrected on 10/20/2003. Kwd. 10/2/2003-kwd: Structure has already fallen down. Need documentation of when building collapsed and what it looked like (possibly receipt showing dates of when debris was removed, insurance claims, dated pictures, etc.) discussed w/Tim at Maine Wide. Tmm did input on original permit input. Kwd
