

DISPLAY THIS CARD ON PRINCIPAL FRONTAGE OF WORK
CITY OF PORTLAND

BU **PERMIT** ION

Permit Number: 091071

Please Read
Application And
Notes, If Any,
Attached

This is to certify that CURRY KATHLEEN E /Home Depot

has permission to 8'x 8' Shed

AT 148 ROCKLAND AVE

CP 185 G00200

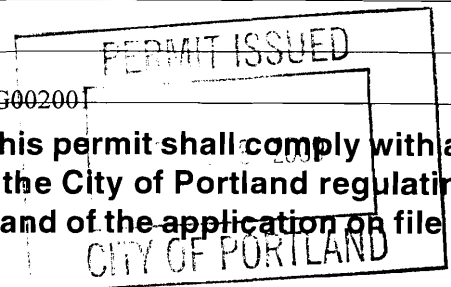

provided that the person or persons, firm or corporation accepting this permit shall comply with all of the provisions of the Statutes of Maine and of the Ordinances of the City of Portland regulating the construction, maintenance and use of buildings and structures, and of the application on file in this department.

Apply to Public Works for street line and grade if nature of work requires such information.

Notification of inspection must be given and written permission procured before this building or part thereof is lath or other work is set-in. 2 HOUR NOTICE IS REQUIRED.

A certificate of occupancy must be procured by owner before this building or part thereof is occupied.

OTHER REQUIRED APPROVALS

Fire Dept. _____

Health Dept. _____

Appeal Board _____

Other _____

Department Name

James H. Nault 9/28/09
Director - Building & Inspection Services

PENALTY FOR REMOVING THIS CARD

City of Portland, Maine - Building or Use Permit Application
 389 Congress Street, 04101 Tel: (207) 874-8703, Fax: (207) 874-8716

Permit No: 09-1071	Issue Date:	CBL: 185 G002001
-----------------------	-------------	---------------------

Location of Construction: 148 ROCKLAND AVE	Owner Name: CURRY KATHLEEN E	Owner Address: 350 PREBLE ST	Phone:
Business Name:	Contractor Name: Home Depot	Contractor Address: 245 Riverside St. Portland	Phone: 2077610600
Lessee/Buyer's Name	Phone:	Permit Type: Sheds	Zone: R5

Past Use: Single Family Home	Proposed Use: Single Family Home - 8'x 8' Shed	Permit Fee: <u>40</u> \$30.00	Cost of Work: <u>71325</u> \$999.00	CEO District: 3
Proposed Project Description: 8'x 8' Shed		FIRE DEPT: <input type="checkbox"/> Approved <input type="checkbox"/> Denied	INSPECTION: Use Group: <u>R3</u> Type: <u>SB</u> <u>IRC 2003</u>	
		Signature:	Signature: <u>Jm 9/28/09</u>	
PEDESTRIAN ACTIVITIES DISTRICT (P.A.D.)				
Action: <input type="checkbox"/> Approved <input type="checkbox"/> Approved w/Conditions <input type="checkbox"/> Denied				
Signature: _____ Date: _____				

Permit Taken By: Ldobson	Date Applied For: 09/28/2009	Zoning Approval		
-----------------------------	---------------------------------	------------------------	--	--

- This permit application does not preclude the Applicant(s) from meeting applicable State and Federal Rules.
- Building permits do not include plumbing, septic or electrical work.
- Building permits are void if work is not started within six (6) months of the date of issuance. False information may invalidate a building permit and stop all work..

Special Zone or Reviews	Zoning Appeal	Historic Preservation
<input type="checkbox"/> Shoreland	<input type="checkbox"/> Variance	<input checked="" type="checkbox"/> Not in District or Landmark
<input type="checkbox"/> Wetland	<input type="checkbox"/> Miscellaneous	<input checked="" type="checkbox"/> Does Not Require Review
<input type="checkbox"/> Flood Zone	<input type="checkbox"/> Conditional Use	<input type="checkbox"/> Requires Review
<input type="checkbox"/> Subdivision	<input type="checkbox"/> Interpretation	<input type="checkbox"/> Approved
<input type="checkbox"/> Site Plan	<input type="checkbox"/> Approved	<input type="checkbox"/> Approved w/Conditions
Maj <input type="checkbox"/> Minor <input type="checkbox"/> MM <input type="checkbox"/>	<input type="checkbox"/> Denied	<input type="checkbox"/> Denied
Date: <u>Jm 9/28</u>	Date: _____	Date: <u>Jm 9/28</u>

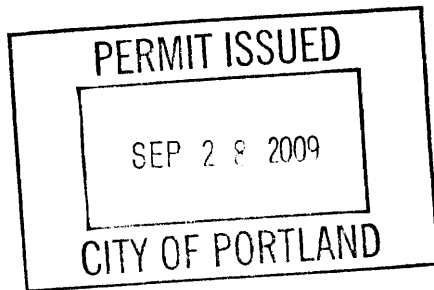

CERTIFICATION

I hereby certify that I am the owner of record of the named property, or that the proposed work is authorized by the owner of record and that I have been authorized by the owner to make this application as his authorized agent and I agree to conform to all applicable laws of this jurisdiction. In addition, if a permit for work described in the application is issued, I certify that the code official's authorized representative shall have the authority to enter all areas covered by such permit at any reasonable hour to enforce the provision of the code(s) applicable to such permit.

SIGNATURE OF APPLICANT	ADDRESS	DATE	PHONE
RESPONSIBLE PERSON IN CHARGE OF WORK, TITLE		DATE	PHONE

BUILDING PERMIT INSPECTION PROCEDURES

Please call 874-8703 or 874-8693 (ONLY)

to schedule your inspections as agreed upon

Permits expire in 6 months, if the project is not started or ceases for 6 months.

The Owner or their designee is required to notify the inspections office for the following inspections and provide adequate notice. Notice must be called in 48-72 hours in advance in order to schedule an inspection:

By initializing at each inspection time, you are agreeing that you understand the inspection procedure and additional fees from a "Stop Work Order" and "Stop Work Order Release" will be incurred if the procedure is not followed as stated below.

A Pre-construction Meeting will take place upon receipt of your building permit.

 X **Building Location Inspection:**

Certificate of Occupancy is not required for certain projects. Your inspector can advise you if your project requires a Certificate of Occupancy. All projects DO require a final inspection.

If any of the inspections do not occur, the project cannot go on to the next phase, REGARDLESS OF THE NOTICE OR CIRCUMSTANCES.

CERIFICATE OF OCCUPANICES MUST BE ISSUED AND PAID FOR, BEFORE THE SPACE MAY BE OCCUPIED.

Signature of Applicant/Designee

Date

Thomas H. Mankley

Signature of Inspections Official

9/28/09

Date

Date

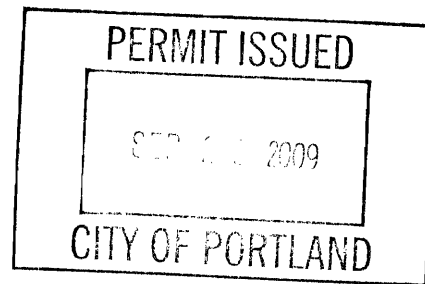

CBL: 185 G002001

Building Permit #: 09-1071

City of Portland, Maine - Building or Use Permit
 389 Congress Street, 04101 Tel: (207) 874-8703, Fax: (207) 874-8716

Permit No: 09-1071	Date Applied For: 09/28/2009	CBL: 185 G002001
------------------------------	--	----------------------------

Location of Construction: 148 ROCKLAND AVE	Owner Name: CURRY KATHLEEN E	Owner Address: 350 PREBLE ST	Phone:
Business Name:	Contractor Name: Home Depot	Contractor Address: 245 Riverside St. Portland	Phone (207) 761-0600
Lessee/Buyer's Name	Phone:	Permit Type: Sheds	

Proposed Use: Single Family Home - 8'x 8' Shed	Proposed Project Description: 8'x 8' Shed
--	---

Dept: Zoning	Status: Approved	Reviewer: Tom Markley	Approval Date: 09/28/2009
Note:			Ok to Issue: <input checked="" type="checkbox"/>
1) This property shall remain a single family dwelling. Any change of use shall require a separate permit application for review and approval.			
Dept: Building	Status: Approved with Conditions	Reviewer: Tom Markley	Approval Date: 09/28/2009
Note:			Ok to Issue: <input checked="" type="checkbox"/>
1) This structure is exempt from meeting the City of Portland Building Code based on size.			



General Building Permit Application

If you or the property owner owes real estate or personal property taxes or user charges on any property within the City, payment arrangements must be made before permits of any kind are accepted.

Location/Address of Construction: <u>180 Rockland Ave.</u>		
Total Square Footage of Proposed Structure/Area <u>8x8</u>	Square Footage of Lot <u>6000</u>	Number of Stories <u>1</u>
Tax Assessor's Chart, Block & Lot Chart# <u>185</u> Block# <u>6</u> Lot# <u>2</u>	Applicant *must be owner, Lessee or Buyer* Name <u>Kathleen Curry</u> Address <u>350 Preble St.</u> City, State & Zip <u>Portland ME 04106</u>	Telephone: <u>207-799-3635</u>
Lessee/DBA (If Applicable)	Owner (if different from Applicant) Name Address City, State & Zip	Cost Of Work: \$ <u>1327.00</u> C of O Fee: \$ _____ Total Fee: \$ <u>40</u>
Current legal use (i.e. single family) <u>single family</u> Number of Residential Units <u>1</u> If vacant, what was the previous use? _____ Proposed Specific use: _____ Is property part of a subdivision? <u>No</u> If yes, please name _____ Project description: <u>8x8 shed</u>		
Contractor's name: <u>Home Depot</u> Address: <u>300 Clark's Pond Parkway</u> City, State & Zip <u>South Portland ME 04106</u> Telephone: <u>207-879-2500</u> Who should we contact when the permit is ready: <u>Kathleen Curry</u> Telephone: <u>207-799-3635</u> Mailing address: <u>350 Preble St. South Portland</u>		

Please submit all of the information outlined on the applicable Checklist. Failure to do so will result in the automatic denial of your permit.

In order to be sure the City fully understands the full scope of the project, the Planning and Development Department may request additional information prior to the issuance of a permit. For further information or to download copies of this form and other applications visit the Inspections Division on-line at www.portlandmaine.gov, or stop by the Inspections Division office, room 315 City Hall or call 874-8703.

I hereby certify that I am the Owner of record of the named property, or that the owner of record authorizes the proposed work and that I have been authorized by the owner to make this application as his/her authorized agent. I agree to conform to all applicable laws of this jurisdiction. In addition, if a permit for work described in this application is issued, I certify that the Code Official's authorized representative shall have the authority to enter all areas covered by this permit at any reasonable hour to enforce the provisions of the codes applicable to this permit.

Signature: Kathleen Curry Date: 9/28/09

This is not a permit; you may not commence ANY work until the permit is issued.

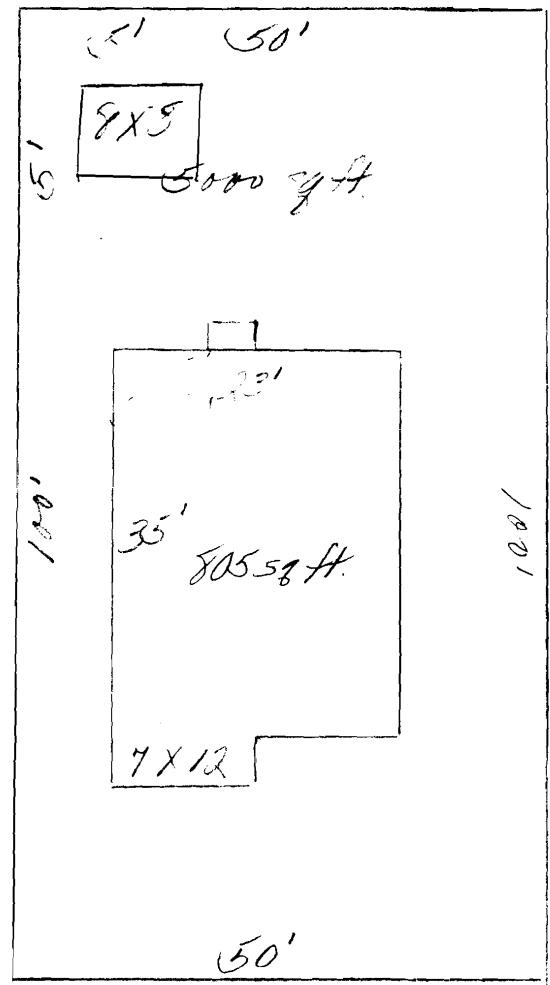

150 Rockland Ave.
Portland

Price Includes
Delivery &
Installation

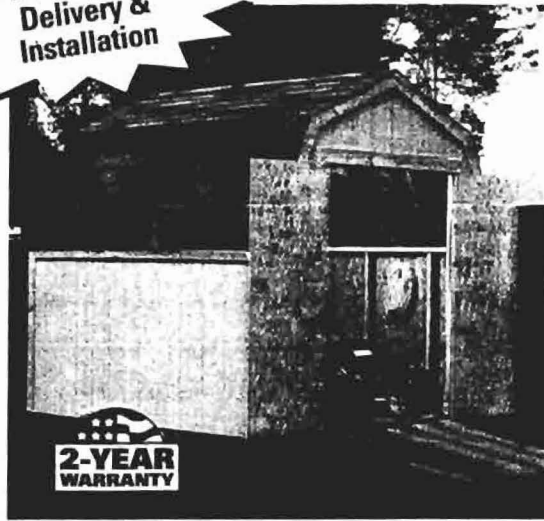

8' x 8' Val-U Shed Only \$999

Why spend your weekends building a shed when we can do it for you at such a great price!

- 54" double door with keyed lock entry
- 2" x 4" PT floor joists, 16" on center
- Pre-primed Smart Siding with natural trim — paint to match your house.

SKU #466-390

OPTIONS

Tough Floor II

- NEW! 2" x 6" pressure treated floor joists
- NEW! 12" on center spacing
- Pressure treated plywood floor

Great Deal!

Just \$169

Save Big!

- Val-U Bundle: 4' Ramp, Vents, Lifetime Warranty \$159
- Gable Vents (pair) \$34
- Ramp 4' Long \$69
- 6' Heavy duty \$119
- Upgrade to Lifetime Warranty \$99
- Anchor Kit \$149

799-31035

The Tough Floor Just Got Tougher!

Tough Floor II

Increases floor strength up to 200%

- NEW! 2" x 6" pressure treated floor joists
- NEW! 12" on center spacing
- Pressure treated plywood floor

Just \$169!

Any Size, Any Shed

Does not apply to Monarch, Garage or Country Barn models



Configure your shed online with our shed customizer!

www.shedsusa.com/configurator