

**City of Portland, Maine - Building or Use Permit Application**

389 Congress Street, 04101 Tel: (207) 874-8703, Fax: (207) 874-8716

Permit No: 10-1165	Issue Date:	CBL: 185 C001001
-----------------------	-------------	---------------------

Location of Construction: 580 BRIGHTON AVE	Owner Name: ROSEMONT RED BRICK HOUSE	Owner Address: 559 BRIGHTON AVE	Phone:
Business Name:	Contractor Name: Applied Refrigeration Services	Contractor Address: 33 Northwood Drive Windham	Phone: 2078930145
Lessee/Buyer's Name	Phone:	Permit Type: HVAC	Zone: B-1

Past Use: Commercial "Rosemont Market"	Proposed Use: Commercial "Rosemont Market" - Install Refrigeration units and Coolers	Permit Fee: \$370.00	Cost of Work: \$35,000.00	CEO District: 3	<i>zone</i>
		FIRE DEPT: <input checked="" type="checkbox"/> Approved <input type="checkbox"/> Denied <i>*See Condition</i>	INSPECTION: Use Group: <i>M</i> Type: <i>HAZ</i> <i>IMC-2003</i>		

Proposed Project Description: Install Refrigeration units and Coolers	Signature: <i>(RG)</i>	Signature: <i>AMB 10/5/10</i>
PEDESTRIAN ACTIVITIES DISTRICT (P.A.D.)		
Action: <input type="checkbox"/> Approved <input type="checkbox"/> Approved w/Conditions <input type="checkbox"/> Denied		
Signature: _____ Date: _____		

Permit Taken By: Idobson	Date Applied For: 09/17/2010	<b>Zoning Approval</b>
-----------------------------	---------------------------------	------------------------

- This permit application does not preclude the Applicant(s) from meeting applicable State and Federal Rules.
- Building permits do not include plumbing, septic or electrical work.
- Building permits are void if work is not started within six (6) months of the date of issuance. False information may invalidate a building permit and stop all work..

Special Zone or Reviews	Zoning Appeal	Historic Preservation
<input type="checkbox"/> Shoreland	<input type="checkbox"/> Variance	<input checked="" type="checkbox"/> Not in District or Landmark
<input type="checkbox"/> Wetland	<input type="checkbox"/> Miscellaneous	<input type="checkbox"/> Does Not Require Review
<input type="checkbox"/> Flood Zone	<input type="checkbox"/> Conditional Use	<input type="checkbox"/> Requires Review
<input type="checkbox"/> Subdivision	<input type="checkbox"/> Interpretation	<input type="checkbox"/> Approved
<input type="checkbox"/> Site Plan	<input type="checkbox"/> Approved	<input type="checkbox"/> Approved w/Conditions
Maj <input type="checkbox"/> Minor <input type="checkbox"/> MM <input type="checkbox"/>	<input type="checkbox"/> Denied	<input type="checkbox"/> Denied
Date: <i>9/20/10</i>	Date: _____	Date: _____

**PERMIT ISSUED**

OCT - 5 2010

City of Portland

**CERTIFICATION**

I hereby certify that I am the owner of record of the named property, or that the proposed work is authorized by the owner of record and that I have been authorized by the owner to make this application as his authorized agent and I agree to conform to all applicable laws of this jurisdiction. In addition, if a permit for work described in the application is issued, I certify that the code official's authorized representative shall have the authority to enter all areas covered by such permit at any reasonable hour to enforce the provision of the code(s) applicable to such permit.

SIGNATURE OF APPLICANT \_\_\_\_\_ ADDRESS \_\_\_\_\_ DATE \_\_\_\_\_ PHONE \_\_\_\_\_

RESPONSIBLE PERSON IN CHARGE OF WORK, TITLE \_\_\_\_\_ DATE \_\_\_\_\_ PHONE \_\_\_\_\_

**City of Portland, Maine - Building or Use Permit**

389 Congress Street, 04101 Tel: (207) 874-8703, Fax: (207) 874-8716

<b>Permit No:</b> 10-1165	<b>Date Applied For:</b> 09/17/2010	<b>CBL:</b> 185 C001001
------------------------------	--	----------------------------

<b>Location of Construction:</b> 580 BRIGHTON AVE	<b>Owner Name:</b> ROSEMONT RED BRICK HOUSE	<b>Owner Address:</b> 559 BRIGHTON AVE	<b>Phone:</b>
<b>Business Name:</b>	<b>Contractor Name:</b> Applied Refrigeration Services	<b>Contractor Address:</b> 33 Northwood Drive Windham	<b>Phone:</b> (207) 893-0145
<b>Lessee/Buyer's Name</b>	<b>Phone:</b>	<b>Permit Type:</b> HVAC	

<b>Proposed Use:</b> Commercial "Rosemont Market" - Install Refrigeration units and Coolers	<b>Proposed Project Description:</b> Install Refrigeration units and Coolers
--	---

**Dept:** Zoning      **Status:** Approved with Conditions      **Reviewer:** Marge Schmuckal      **Approval Date:** 09/20/2010

**Note:** Ok to Issue:

- 1) the units shall not exede 55 dBAs at the property lines. The information submitted shouvs that this unit will not excede the maximum level allowed. Any complaint will be followed up and enforced. If the units in the real world excede the allowable maximums, the owner shall take mitigating steps to bring the unit(s) into compliance.
- 2) All conditions on the previous permits are still in force.

**Dept:** Building      **Status:** Approved with Conditions      **Reviewer:** Jeanine Bourke      **Approval Date:** 10/05/2010

**Note:** Ok to Issue:

- 1) Installation shall comply with 2003 International Mechanical Code
- 2) Equipment must be installed in compliance per the manufacturer's specifications

**Dept:** Fire      **Status:** Approved with Conditions      **Reviewer:** Capt Keith Gautreau      **Approval Date:** 09/28/2010

**Note:** Ok to Issue:

- 1) Install shall comply with all manufacture's specifications.

**Comments:**

10/5/2010-jmb: confirmed with inspectors NLA and BF that the stairs have not been installed, separate permit required for review and approval

**PERMIT ISSUED**

OCT - 5 2010

City of Portland



FILL IN AND SIGN WITH INK

PERMIT ISSUED

# APPLICATION FOR PERMIT HEATING OR POWER EQUIPMENT

OCT - 5 2010

City of Portland

To the INSPECTOR OF BUILDINGS, PORTLAND, ME.

The undersigned hereby applies for a permit to install the following heating, cooking or power equipment in accordance with the Laws of Maine, the Building Code of the City of Portland, and the following specifications:

Location / CBL 185-C-1- Use of Building Retail/Grocery Date 9-17-10  
 Name and address of owner of appliance Rockport Market 580 Brighton Ave  
Portland ME  
 Installer's name and address Applied Refrigeration Services 33 Northwood Dr Windham ME  
 Telephone 207-993-0145

### Location of appliance:

- Basement  Floor  
 Attic  Roof

### Type of Fuel:

- Gas  Oil  Solid

Appliance Name: Heatcraft/Fujitsu

U.L. Approved  Yes  No

Will appliance be installed in accordance with the manufacture's installation instructions?  Yes  No

IF NO Explain: \_\_\_\_\_

### The Type of License of Installer:

- Master Plumber # \_\_\_\_\_  
 Solid Fuel # \_\_\_\_\_  
 Oil # \_\_\_\_\_  
 Gas # \_\_\_\_\_  
 Other 0294238711987

### Type of Chimney:

- Masonry Lined  
 Factory built \_\_\_\_\_  
 Metal  
 Factory Built U.L. Listing # \_\_\_\_\_  
 Direct Vent  
 Type \_\_\_\_\_ UL# \_\_\_\_\_

### Type of Fuel Tank

- Oil  
 Gas

Size of Tank \_\_\_\_\_

Number of Tanks \_\_\_\_\_

Distance from Tank to Center of Flame \_\_\_\_\_ feet.

Cost of Work: \$ 44,000 \$35,000

Permit Fee: \$ 370

RECEIVED  
 SEP 17 2010  
 Dept. of Building Inspections  
 City of Portland Maine

### Approved

Fire: \_\_\_\_\_  
 Ele.: \_\_\_\_\_  
 Bldg.: \_\_\_\_\_

### Approved with Conditions

- See attached letter or requirement

Signature of Installer

Inspector's Signature

Date Approved





FILL IN AND SIGN WITH INK

# APPLICATION FOR PERMIT HEATING OR POWER EQUIPMENT

**PERMIT ISSUED**

OCT - 5 2010

To the INSPECTOR OF BUILDINGS, PORTLAND, ME.

The undersigned hereby applies for a permit to install the following heating, cooking or power equipment in accordance with the Laws of Maine, the Building Code of the City of Portland, and the following specifications:

Location / CBL 135-C-1 Use of Building Retail Grocery Date 9-17-10  
 Name and address of owner of appliance Rosemont Market 580 Brighton Ave  
Portland ME  
 Installer's name and address Applied Refrigeration Services 33 Northwood Dr Windham ME  
 Telephone 207 943-0145

### Location of appliance:

- Basement  Floor <sup>1st</sup>  
 Attic  Roof

### Type of Fuel:

- Gas  Oil  Solid

Appliance Name: Heat Exchanger / Fujitsu

U.L. Approved  Yes  No

Will appliance be installed in accordance with the manufacture's installation instructions?  Yes  No

IF NO Explain: \_\_\_\_\_

### The Type of License of Installer:

- Master Plumber # \_\_\_\_\_  
 Solid Fuel # \_\_\_\_\_  
 Oil # \_\_\_\_\_  
 Gas # \_\_\_\_\_  
 Other 279 483 571 1987

### Type of Chimney:

- Masonry Lined  
 Factory built \_\_\_\_\_  
 Metal  
 Factory Built U.L. Listing # \_\_\_\_\_  
 Direct Vent  
 Type \_\_\_\_\_ UL# \_\_\_\_\_

### Type of Fuel Tank

- Oil  
 Gas

Size of Tank \_\_\_\_\_

Number of Tanks \_\_\_\_\_

Distance from Tank to Center of Flame \_\_\_\_\_ feet.

Cost of Work: \$ ~~44,000~~ \$35,000

Permit Fee: \$ 370

### Approved

Fire: \_\_\_\_\_  
 Ele.: \_\_\_\_\_  
 Bldg.: \_\_\_\_\_

### Approved with Conditions

- See attached letter or requirement

Inspector's Signature \_\_\_\_\_

Date Approved \_\_\_\_\_

Signature of Installer [Signature]

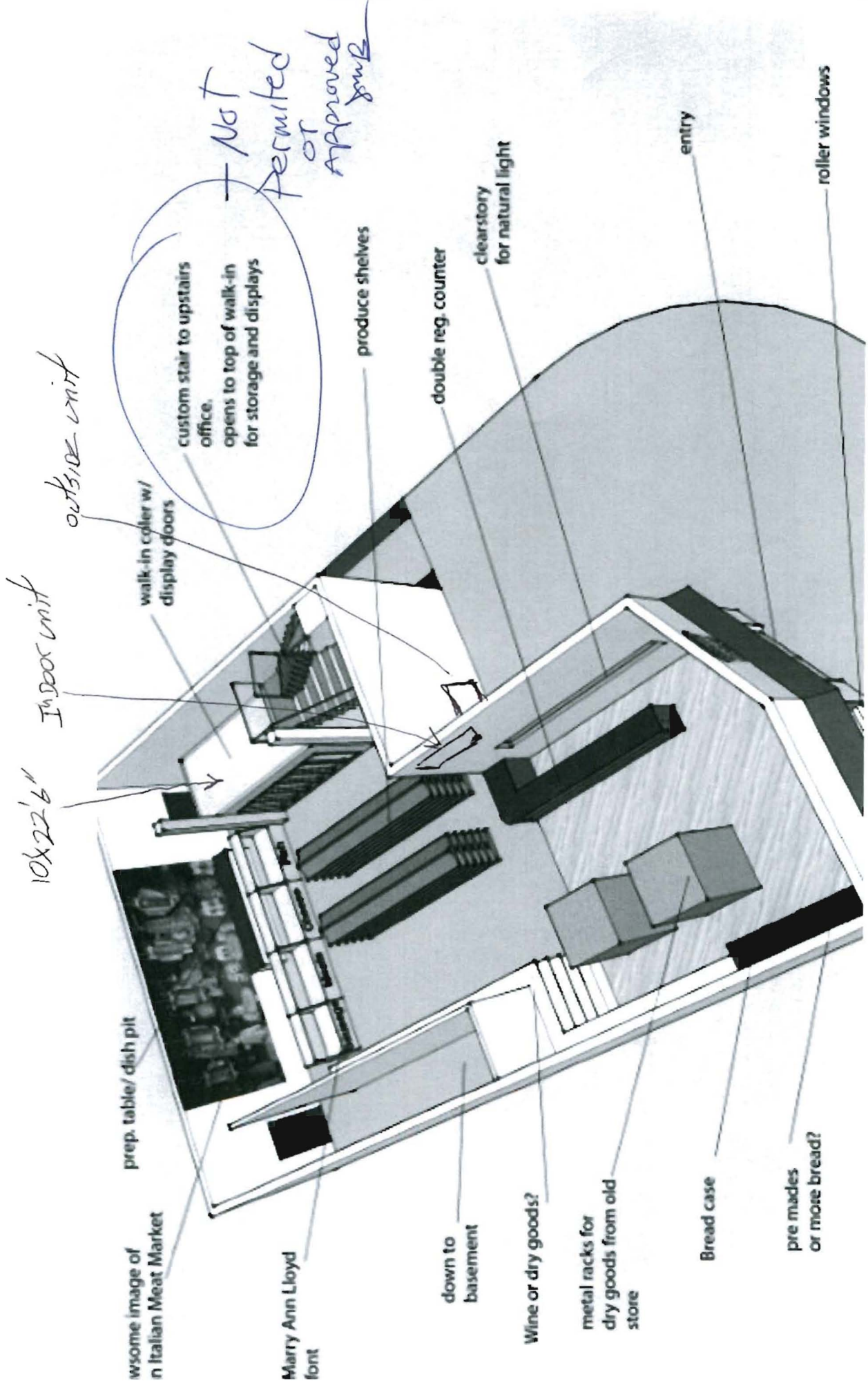

NOT Permitted or Approved JMB

custom stair to upstairs office. opens to top of walk-in for storage and displays

outside unit

walk-in cooler w/ display doors

produce shelves

double reg. counter

clearstory for natural light

entry

roller windows

Indoor unit

10x22'6"

prep. table/dish pit

some image of Italian Meat Market

Marry Ann Lloyd font

down to basement

Wine or dry goods?

metal racks for dry goods from old store

Bread case

pre makes or more bread?





**CITY OF PORTLAND, MAINE**  
Department of Building Inspections

**Original Receipt**

9.17 20 10

Received from John Taylor

Location of Work 580 Brighton

Cost of Construction \$ \_\_\_\_\_ Building Fee: \_\_\_\_\_

Permit Fee \$ \_\_\_\_\_ Site Fee: \_\_\_\_\_

Certificate of Occupancy Fee: \_\_\_\_\_

Total: 370

Building (IL) \_\_\_\_\_ Plumbing (I5) \_\_\_\_\_ Electrical (I2) \_\_\_\_\_ Site Plan (U2) \_\_\_\_\_

Other ITUAC

CBL: 185-C-1

Check #: CC Total Collected \$ 370

**No work is to be started until permit issued.  
Please keep original receipt for your records.**

Taken by: [Signature]

WHITE - Applicant's Copy  
YELLOW - Office Copy  
PINK - Permit Copy



33 Northwood Drive, Windham, ME 04062  
Phone: (207) 893-0145 • Fax: (207) 692-2275  
[art@appliedrefrigeration.com](mailto:art@appliedrefrigeration.com) • [www.appliedrefrigeration.com](http://www.appliedrefrigeration.com)  
Licensed, Insured, Certified

To: Portland City Hall

Attn: Lannie Dobson

Date: 9-19-10

# of Pages 7  
(incl. cover):

Comments: Lannie, Here are the cut sheets for the new refrigeration for Rosemont Market on Brighton Ave. If you need any more info please call or email me.

Thanks,

A handwritten signature in black ink, appearing to read "Art Green", written over a white background.

Art Green



33 Northwood Drive, Windham, ME 04062  
Phone: (207) 893-0145 • Fax: (207) 692-2275  
[art@appliedrefrigeration.com](mailto:art@appliedrefrigeration.com) • [www.appliedrefrigeration.com](http://www.appliedrefrigeration.com)  
Licensed, Insured, Certified

To: Portland City Hall

Attn: Lannie Dobson

Date: 9-19-10

# of Pages 7  
(incl. cover):

Comments: Lannie, Here are the cut sheets for the new refrigeration for Rosemont Market on Brighton Ave. If you need any more info please call or email me.

Thanks,

A handwritten signature in black ink, appearing to read "Art Green".

Art Green



**Submittal Data: System 24RLXS  
ASU24RLXS & AOU24RLXS**

*Heat Pump  
HVAC*



Job Name: \_\_\_\_\_ Location: \_\_\_\_\_  
 Purchaser: \_\_\_\_\_  
 Engineer: \_\_\_\_\_  
 Submitted To: \_\_\_\_\_ For:  Reference  Approval  Construction  
 Submitted By: \_\_\_\_\_  
 Unit Designation: \_\_\_\_\_ Schedule No. \_\_\_\_\_ Model No.: \_\_\_\_\_

**Capacities:**

Cooling	22,000 BTU/h
Outdoor Design Temp. <i>F° DB/WB</i>	95/75
Heating	27,600 BTU/h
Outdoor Design Temperature <i>F° DB/WB</i>	47/43
HSPF	10
SEER	18
EER <i>Cooling/Heating</i>	12.5/11.6
Voltage/Frequency/Phase	208-230/60/1

**Indoor Unit:**

Noise Level Cooling <i>db (A) - H/ M/ L/ Q</i>	49/ 42/ 37/ 33
Noise Level Heating <i>db (A) - H/ M/ L/ Q</i>	49/ 42/ 37/ 33
Weight	31 lbs.

**Outdoor Unit:**

Noise Level <i>Cooling/Heating</i>	54/55
Recommended Fuse Size	30A
Min. Ampacity	7.9A
Running Current <i>Cooling</i>	7.9A
Running Current <i>Heating</i>	10.5A
Weight	137 lbs.

**Refrigerant Piping:**

Max Ht. Difference	98 ft.
Max Total or Combined Length	164 ft.
Discharge Vapor Line (O.D.)	3/8 in.
Suction (O.D.)	5/8 in.

- Six year compressor warranty
- Two year parts warranty
- Digital wireless remote control
- 4-way automatic louvers
- Min Heat (50F heating set point)
- Built in Low Ambient
- Auto Restart/ Reset
- 24 hour timer
- Optional Wired Remote Control
- Dry mode
- Refrigerant R410A
- Quiet Mode

**OUTLINE AND DIMENSIONS**

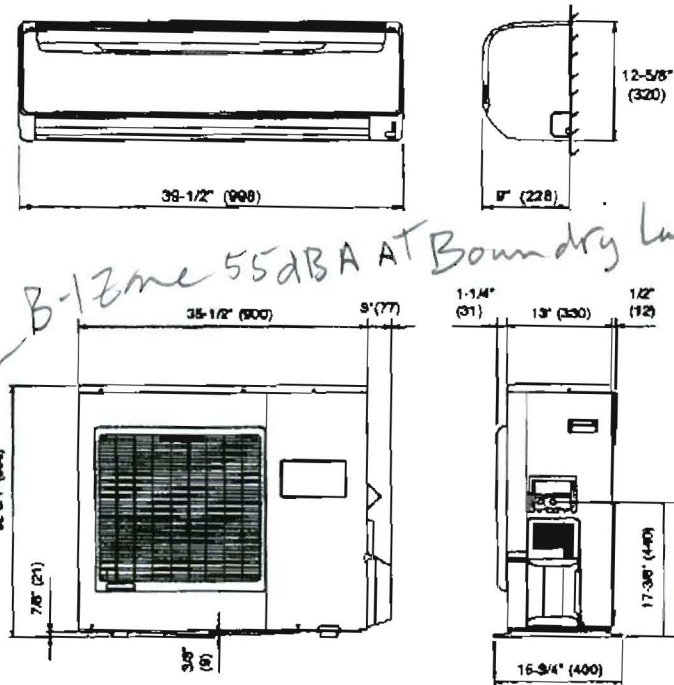

**Notes:**

\_\_\_\_\_

### Physical Data

*Walk-In Cooler*

#### Model ACM Air Defrost

Model	No. of Fans	Connections (in.)		Approx. Net Wt.	
		Inlet OD	Suction OD	lbs.	kg
ACM052	1	1/2	7/8	42	19
ACM076	2	1/2	7/8	54	24
ACM090	2	1/2	7/8	70	32
ACM102	3	1/2	7/8	83	38
ACM108	3	1/2	7/8	105	48
ACM134	3	1/2	7/8	117	53
ACM156	4	1/2	7/8	123	56
ACM179	4	1/2	7/8	149	68
ACM208	4	1/2	1-1/8	164	74
ACM249	5	1/2	1-1/8	205	94

#### Model ECM Electric Defrost

Model	No. of Fans	Connections (in.)		Approx. Net Wt.	
		Inlet OD	Suction OD	lbs.	kg
ECM040	1	1/2	7/8	90	41
ECM054	2	1/2	7/8	120	54
ECM065	2	1/2	7/8	120	54
ECM090	3	1/2	7/8	150	73
ECM130	3	1/2	7/8	174	79
ECM174	4	1/2	1-1/8	218	99

### Dimensional Data

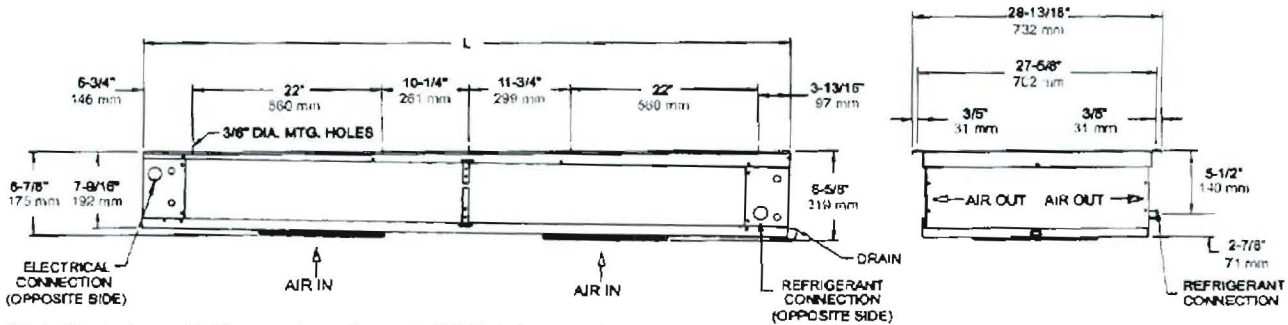

NOTE: All units have 1/4" OD external equalizer and 3/4" FPT drain connection

#### Model ACM Air Defrost

Model	No. of Fans	Dimensions	
		in.	mm
ACM052	1	31-1/2	800
ACM076	2	53-1/2	1,359
ACM090	2	53-1/2	1,359
ACM102	3	53-1/2	1,359
ACM108	3	75-1/2	1,918
ACM134	3	75-1/2	1,918
ACM156	4	75-1/2	1,918
ACM179	4	97-1/2	2,477
ACM208	4	97-1/2	2,477
ACM249	5	119-1/2	3,035

#### Model ECM Electric Defrost

Model	No. of Fans	Dimensions	
		in.	mm
ECM040	1	31-1/2	800
ECM054	2	53-1/2	1,359
ECM065	2	53-1/2	1,359
ECM090	3	75-1/2	1,918
ECM130	3	75-1/2	1,918
ECM174	4	97-1/2	2,477



## Specifications

*Walk In Cooler*

### Model ACM Air Defrost | 60 Hz

Model	HP	Shaded Pole				PSC Motor				EC Motor			
		115/1/60		208 230/1/60		115/1/60		208 230/1/60		115/1/60		208 230/1/60	
		Amps	Watts	Amps	Watts	Amps	Watts	Amps	Watts	Amps	Watts	Amps	Watts
ACM052	1/15	2.1	135	1.1	135	0.9	90	0.5	90	0.9	55	0.5	55
ACM076	1/15	4.2	270	2.2	270	1.8	180	1.0	180	1.8	110	1.0	110
ACM090	1/15	4.2	270	2.2	270	1.8	180	1.0	180	1.8	110	1.0	110
ACM102	1/15	4.2	270	2.2	270	1.8	180	1.0	180	1.8	110	1.0	110
ACM108	1/15	6.3	405	3.3	405	2.7	270	1.5	270	2.7	165	1.5	165
ACM134	1/15	6.3	405	3.3	405	2.7	270	1.5	270	2.7	165	1.5	165
ACM156	1/15	6.3	405	3.3	405	2.7	270	1.5	270	2.7	165	1.5	165
ACM179	1/15	8.4	540	4.4	540	3.6	360	2.0	360	3.6	220	2.0	220
ACM208	1/15	8.4	540	4.4	540	3.6	360	2.0	360	3.6	220	2.0	220
ACM249	1/15	10.5	675	5.5	675	4.5	450	2.5	450	4.5	275	2.5	275

### Model ACM Air Defrost | 50 Hz

Model	HP	PSC Motor				EC Motor			
		110/1/50		220/1/50		110/1/50		220/1/50	
		Amps	Watts	Amps	Watts	Amps	Watts	Amps	Watts
ACM052	1/15	0.8	80	0.4	80	0.9	55	0.5	55
ACM076	1/15	1.7	160	0.8	160	1.8	110	1.0	110
ACM090	1/15	1.7	160	0.8	160	1.8	110	1.0	110
ACM102	1/15	2.5	240	1.2	240	1.8	110	1.0	110
ACM108	1/15	2.5	240	1.2	240	2.7	165	1.5	165
ACM134	1/15	2.5	240	1.2	240	2.7	165	1.5	165
ACM156	1/15	3.3	320	1.6	320	2.7	165	1.5	165
ACM179	1/15	3.3	320	1.6	320	3.6	220	2.0	220
ACM208	1/15	3.3	320	1.6	320	3.6	220	2.0	220
ACM249	1/15	4.2	400	2.0	400	4.5	275	2.5	275

### Model ECM Electric Defrost | 60 Hz

Model	HP	Shaded Pole Motor		PSC Motor		EC Motor		Heater
		208 230/1/60		208 230/1/60		208 230/1/60		
		Amps	Watts	Amps	Watts	Amps	Watts	Watts
ECM040	1/15	1.1	135	0.5	90	0.5	55	5.3
ECM054	1/15	2.2	270	1.0	180	1.0	110	8.7
ECM065	1/15	2.2	270	1.0	180	1.0	110	8.7
ECM090	1/15	3.3	405	1.5	270	1.5	165	15.7
ECM130	1/15	3.3	405	1.5	270	1.5	165	15.7
ECM174	1/15	4.4	540	2.0	360	2.0	220	20.9

### Model ECM Electric Defrost | 50 Hz

Model	HP	PSC Motor		EC Motor		Heater
		220/1/50		220/1/50		
		Amps	Watts	Amps	Watts	Watts
ECM040	1/15	0.4	80	0.5	55	5.3
ECM054	1/15	0.8	160	1.0	110	8.7
ECM065	1/15	0.8	160	1.0	110	8.7
ECM090	1/15	1.2	240	1.5	165	15.7
ECM130	1/15	1.2	240	1.5	165	15.7
ECM174	1/15	1.6	320	2.0	220	20.9

**NOTE:** Shaded pole motors are standard for all 60 Hz units and PSC motors are standard for all 50 Hz units



**Performance Data**

*Walk-In Looker*

**Model ACM Air Defrost | 60 Hz**

Model	Capacity				Fan Data		
	10 F TD 25 F SST BTUH	6 C TD 4 C SST Watts	15 F TD 25 F SST BTUH	8 C TD 4 C SST Watts	No.	CFM	m·H
ACM052	5,200	1,520	7,800	2,280	1	610	1,035
ACM076	7,800	2,320	11,400	3,340	2	1,300	2,210
ACM090	9,000	2,640	13,500	3,950	2	1,260	2,140
ACM102	10,280	2,990	15,300	4,480	2	1,220	2,075
ACM108	10,800	3,160	16,200	4,750	3	1,950	3,315
ACM134	13,400	3,920	20,100	5,890	3	1,890	3,210
ACM156	15,600	4,570	23,400	6,850	3	1,830	3,110
ACM179	17,900	5,240	26,850	7,860	4	2,520	4,285
ACM208	20,800	6,100	31,200	9,140	4	2,440	4,145
ACM249	24,900	7,290	37,350	10,940	5	3,050	5,185

**Model ACM Air Defrost | 50 Hz<sup>†</sup>**

Model	Capacity				Fan Data		
	10 F TD 25 F SST BTUH	6 C TD 4 C SST Watts	15 F TD 25 F SST BTUH	8 C TD 4 C SST Watts	No.	CFM	m·H
ACM052	4,950	1,450	7,410	2,170	1	550	935
ACM076	7,220	2,110	9,880	2,890	2	1,170	1,990
ACM090	8,550	2,500	12,830	3,760	2	1,135	1,930
ACM102	9,690	2,840	14,540	4,260	2	1,100	1,865
ACM108	10,260	3,000	15,390	4,510	3	1,755	2,985
ACM134	12,790	3,730	19,420	5,190	3	1,700	2,890
ACM156	14,820	4,340	22,230	6,510	3	1,650	2,800
ACM179	17,010	5,090	25,290	7,620	4	2,270	3,855
ACM208	19,760	5,790	29,640	8,680	4	2,200	3,735
ACM249	23,660	6,930	35,400	9,490	5	2,745	4,665

**Model ECM Electric Defrost | 60 Hz**

Model	Capacity				Fan Data		
	10 F TD 20 F SST BTUH	6 C TD 29 C SST Watts	12 F TD 20 F SST BTUH	7 C TD 29 C SST Watts	No.	CFM	m·H
ECM040	4,000	1,170	4,800	1,410	1	610	1,037
ECM054	5,400	1,580	6,480	1,900	2	1,300	2,210
ECM065	6,500	1,900	7,800	2,280	2	1,260	2,142
ECM090	9,000	2,640	10,800	3,160	3	1,950	3,315
ECM130	13,000	3,810	15,600	4,570	3	1,830	3,111
ECM174	17,400	5,100	20,880	6,120	4	2,440	4,148

**Model ECM Electric Defrost | 50 Hz<sup>†</sup>**

Model	Capacity				Fan Data		
	10 F TD 20 F SST BTUH	6 C TD 29 C SST Watts	12 F TD 20 F SST BTUH	7 C TD 29 C SST Watts	No.	CFM	m·H
ECM040	3,800	1,110	4,560	1,335	1	550	993
ECM054	5,130	1,500	6,160	1,890	2	1,170	1,989
ECM065	6,180	1,810	7,410	2,170	2	1,135	1,928
ECM090	8,550	2,500	10,260	3,000	3	1,755	2,983
ECM130	12,350	3,620	14,820	4,340	3	1,650	2,800
ECM174	16,530	4,840	19,840	5,810	4	2,200	3,733

<sup>†</sup> For EC motors, use 60 Hz capacity and airflow values (Units with EC motors operating at 50 Hz will not see a reduction in performance due to the electronic control of the motor)

# Dimensional Drawings of Cabinets

*W91k-In Looker*

## OUTDOOR

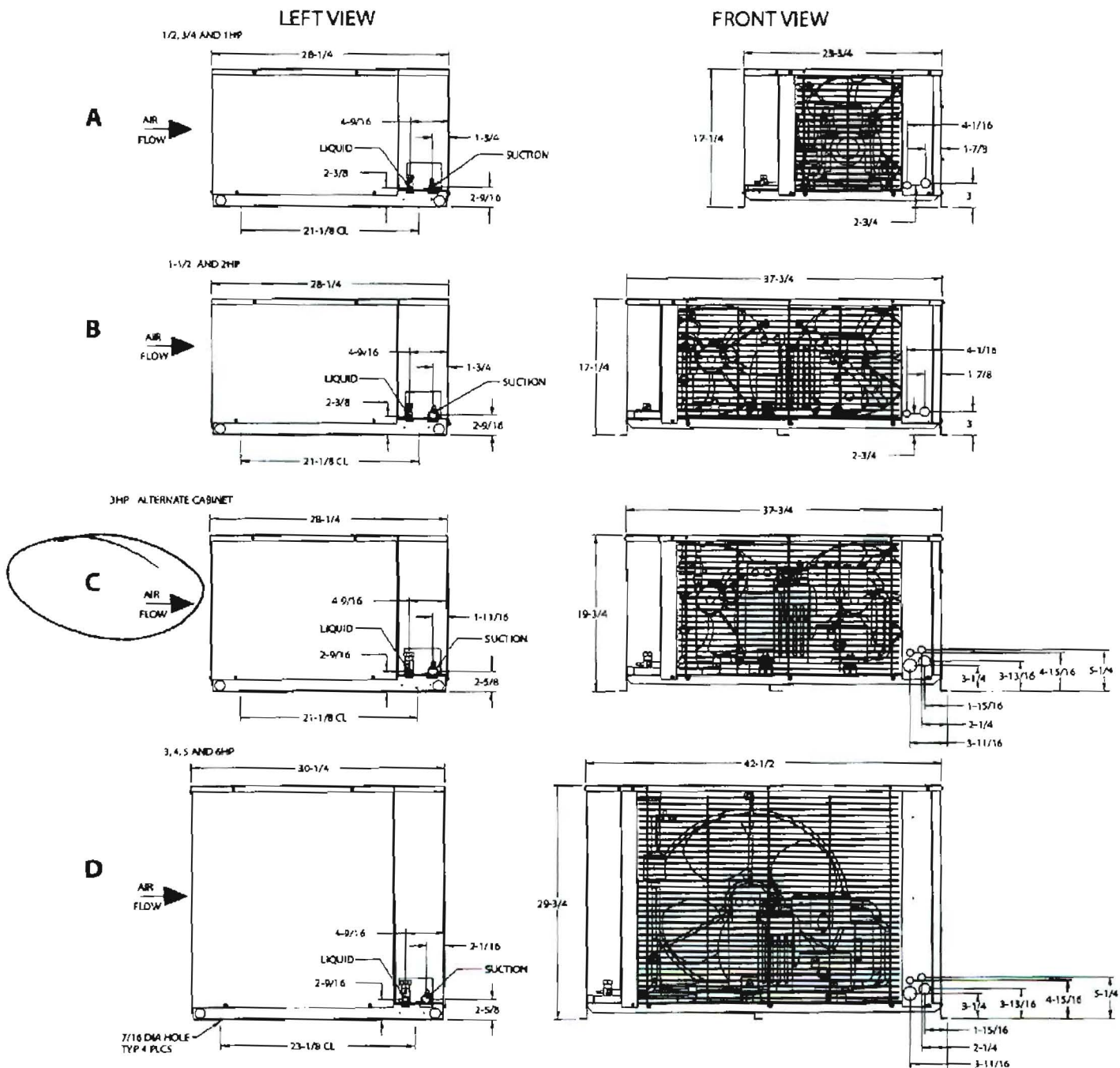



# SCROLL COMPRESSORS Unit Specifications

*W/1/2-In Looker*

Model	Fig.	Compressor	Connections (ID)		Receiver 90% Full Lbs.	Fan(s)	Dimensions			Net Wt. Lbs.	Sound Data dBA
			Liquid	Suction			D (In.)	W (In.)	H (In.)		
LZ*020M6	C	ZS15K4E	1/2	7/8	14	2	28-1/4	37-3/4	19-3/4	209	71
LZ*025M6	C	ZS19K4E	1/2	7/8	14	2	28-1/4	37-3/4	19-3/4	218	73
LZ*030M6	D	ZS21K4E	1/2	7/8	20	1	30-1/4	42-1/2	29-3/4	287	72
LZ*035M6	D	ZS26K4E	1/2	7/8	20	1	30-1/4	42-1/2	29-3/4	290	74
LZ*045M6	D	ZS30K4E	1/2	1-1/8	20	1	30-1/4	42-1/2	29-3/4	317	73
LZ*055M6	D	ZS38K4E	1/2	1-1/8	20	1	30-1/4	42-1/2	29-3/4	317	74
LZ*060M6	D	ZS45K43	1/2	1-1/8	20	1	30-1/4	42-1/2	29-3/4	317	76
LZ*020L6	C	ZF06K4E	1/2	7/8	14	2	28-1/4	37-3/4	19-3/4	209	71
LZ*025L6	C	ZF08K4E	1/2	7/8	14	2	28-1/4	37-3/4	19-3/4	218	73
LZ*030L6	C	ZF09K4E	1/2	7/8	14	2	28-1/4	37-3/4	19-3/4	218	71
LZ*035L6	C	ZF11K4E	1/2	7/8	14	2	28-1/4	37-3/4	19-3/4	217	73
LZ*045L6	D	ZF13K4E	1/2	1-1/8	20	1	30-1/4	42-1/2	29-3/4	307	73
LZ*055L6	D	ZF15K4E	1/2	1-1/8	20	1	30-1/4	42-1/2	29-3/4	313	74
LZ*060L6	D	ZF18K4E	1/2	1-1/8	20	1	30-1/4	42-1/2	29-3/4	317	76

\* = T for Outdoor, N for Indoor, S for Beacon II™

† = See Dimensional Drawings for details. † = Estimated sound pressure values are 10 feet from the unit. For estimating sound pressure from the unit at different distances, deduct the following from the unit values: 20 feet, deduct 6 dBA for 40 feet; deduct 12 dBA for 80 feet; deduct 18 dBA. This data is typical of "free field" conditions for horizontal air cooled condensing units at the outlet of the discharge air. The actual sound measurements may vary depending on the condensing unit installation. Factors such as reflecting walls, background noise and mounting conditions may have a significant influence on this data.

# SCROLL COMPRESSORS - Electrical Data

Model Number	Part Number	Power Supply			Compressor		Fan Motor			MCA		MOPD		Evap. Fan Amps	Defrost Heater Amps
		Volts	Ph	Hz	RLA	LRA	Qty.	HP	FLA	Air	Elec.	Air	Flec.		
LZ*020M6B	ZS15K4E-PFV	208-230	1	60	12.2	61.0	2	1/15	1.0	20	38	25	40	12.0	30
LZ*020M6C	ZS15K4E-TF5	208-230	3	60	8.3	55.0	2	1/15	1.0	15	24	15	25	9.0	19
LZ*020M6D	ZS15K4E-TFD	460	3	60	3.8	27.0	2	1/15	1.0	15	24	15	25	^	^
LZ*025M6B	ZS19K4E-PFV	208-230	1	60	14.7	73.0	2	1/15	1.0	20	38	30	45	12.0	30
LZ*025M6C	ZS19K4E-TF5	208-230	3	60	8.7	63.0	2	1/15	1.0	15	29	20	30	11.0	23
LZ*025M6D	ZS19K4E-TFD	460	3	60	4.5	31.0	2	1/15	1.0	15	24	15	25	^	^
LZ*030M6B	ZS21K4E-PFV	208-230	1	60	14.7	88.0	1	1/3	3.5	22	38	35	45	12.0	30
LZ*030M6C	ZS21K4E-TF5	208-230	3	60	9.9	77.0	1	1/3	3.5	20	38	25	40	12.0	30
LZ*030M6D	ZS21K4E-TFD	460	3	60	5.1	39.0	1	1/3	1.9	15	24	15	25	^	^
LZ*035M6B	ZS26K4E-PFV	208-230	1	60	18.6	109.0	1	1/3	3.5	27	39	45	50	12.0	30
LZ*035M6C	ZS26K4E-TF5	208-230	3	60	12.2	88.0	1	1/3	3.5	20	38	30	40	12.0	30
LZ*035M6D	ZS26K4E-TFD	460	3	60	6.4	44.0	1	1/3	1.9	15	24	15	25	^	^
LZ*045M6B	ZS30K4E-PFV	208-230	1	60	24.0	129.0	1	1/3	3.5	34	59	50	60	11.0	47
LZ*045M6C	ZS30K4E-TF5	208-230	3	60	13.5	99.0	1	1/3	3.5	20	44	30	45	12.0	35
LZ*045M6D	ZS30K4E-TFD	460	3	60	7.4	49.5	1	1/3	1.9	15	29	15	30	11.0	23
LZ*055M6B	ZS38K4E-PFV	208-230	1	60	28.8	169.0	1	1/3	3.5	40	59	50	60	12.0	47
LZ*055M6C	ZS38K4E-TF5	208-230	3	60	19.2	123.0	1	1/3	3.5	28	44	45	50	12.0	35
LZ*055M6D	ZS38K4E-TFD	460	3	60	8.7	62.0	1	1/3	1.9	15	29	20	30	10.0	23
LZ*060M6C	ZS45K4E-TF5	208-230	3	60	21.5	156.0	1	1/3	3.5	30	44	50	60	12.0	35
LZ*060M6D	ZS45K4E-TFD	460	3	60	8.3	70.0	1	1/3	1.9	15	29	20	30	10.6	23
LZ*020L6B	ZF06K4E-PFV	208-230	1	60	12.2	61.0	2	1/15	1.0	20	38	25	40	12.0	30
LZ*020L6C	ZF06K4E-TF5	208-230	3	60	8.3	55.0	2	1/15	1.0	15	24	15	25	9.0	19
LZ*020L6D	ZF06K4E-TFD	460	3	60	3.8	27.0	2	1/15	1.0	15	24	15	25	^	^
LZ*025L6B	ZF08K4E-PFV	208-230	1	60	14.7	73.0	2	1/15	1.0	20	38	30	45	12.0	30
LZ*025L6C	ZF08K4E-TF5	208-230	3	60	8.7	63.0	2	1/15	1.0	15	29	20	30	11.0	23
LZ*025L6D	ZF08K4E-TFD	460	3	60	4.5	31.0	2	1/15	1.0	15	24	15	25	^	^
LZ*030L6B	ZF09K4E-PFV	208-230	1	60	14.7	88.0	2	1/15	1.0	20	38	30	45	12.0	30
LZ*030L6C	ZF09K4E-TF5	208-230	3	60	9.9	77.0	2	1/15	1.0	15	24	20	25	6.0	19
LZ*030L6D	ZF09K4E-TFD	460	3	60	5.1	39.0	2	1/15	1.0	15	15	15	15	^	^
LZ*035L6B	ZF11K4E-PFV	208-230	1	60	18.6	109.0	2	1/15	1.0	24	38	40	50	12.0	30
LZ*035L6C	ZF11K4E-TF5	208-230	3	60	12.2	88.0	2	1/15	1.0	20	29	25	30	6.0	23
LZ*035L6D	ZF11K4E-TFD	460	3	60	6.4	44.0	2	1/15	1.0	15	15	15	15	^	^
LZ*045L6B	ZF13K4E-PFV	208-230	1	60	24.0	129.0	1	1/3	3.5	34	45	50	60	11.0	30
LZ*045L6C	ZF13K4E-TF5	208-230	3	60	13.5	99.0	1	1/3	3.5	20	38	30	40	11.0	30
LZ*045L6D	ZF13K4E-TFD	460	3	60	7.4	49.5	1	1/3	1.9	15	24	15	25	9.0	19
LZ*055L6B	ZF15K4E-PFV	208-230	1	60	28.8	169.0	1	1/3	3.5	40	50	50	60	10.0	30
LZ*055L6C	ZF15K4E-TF5	208-230	3	60	19.2	123.0	1	1/3	3.5	28	40	45	50	10.0	30
LZ*055L6D	ZF15K4E-TFD	460	3	60	8.7	62.0	1	1/3	1.9	15	24	20	25	8.0	19
LZ*060L6C	ZF18K4E-TF5	208-230	3	60	21.5	156.0	1	1/3	3.5	30	44	50	60	12.0	35
LZ*060L6D	ZF18K4E-TFD	460	3	60	8.3	70.0	1	1/3	1.9	15	29	20	30	11.0	23

\* = T for Outdoor, N for Indoor, S for Beacon II™

Per UL and NEC, RLA values have been calculated by dividing the Maximum Continuous Current (MCC) by 1.56.

^ Power supplied by customer

† Consult factory for 50 HZ applications.