

# DR MICHAEL BUFO... PROPOSED OFFICE LAYOUT

## LIGHTING SPECIFICATIONS

AUGUST 2, 2013

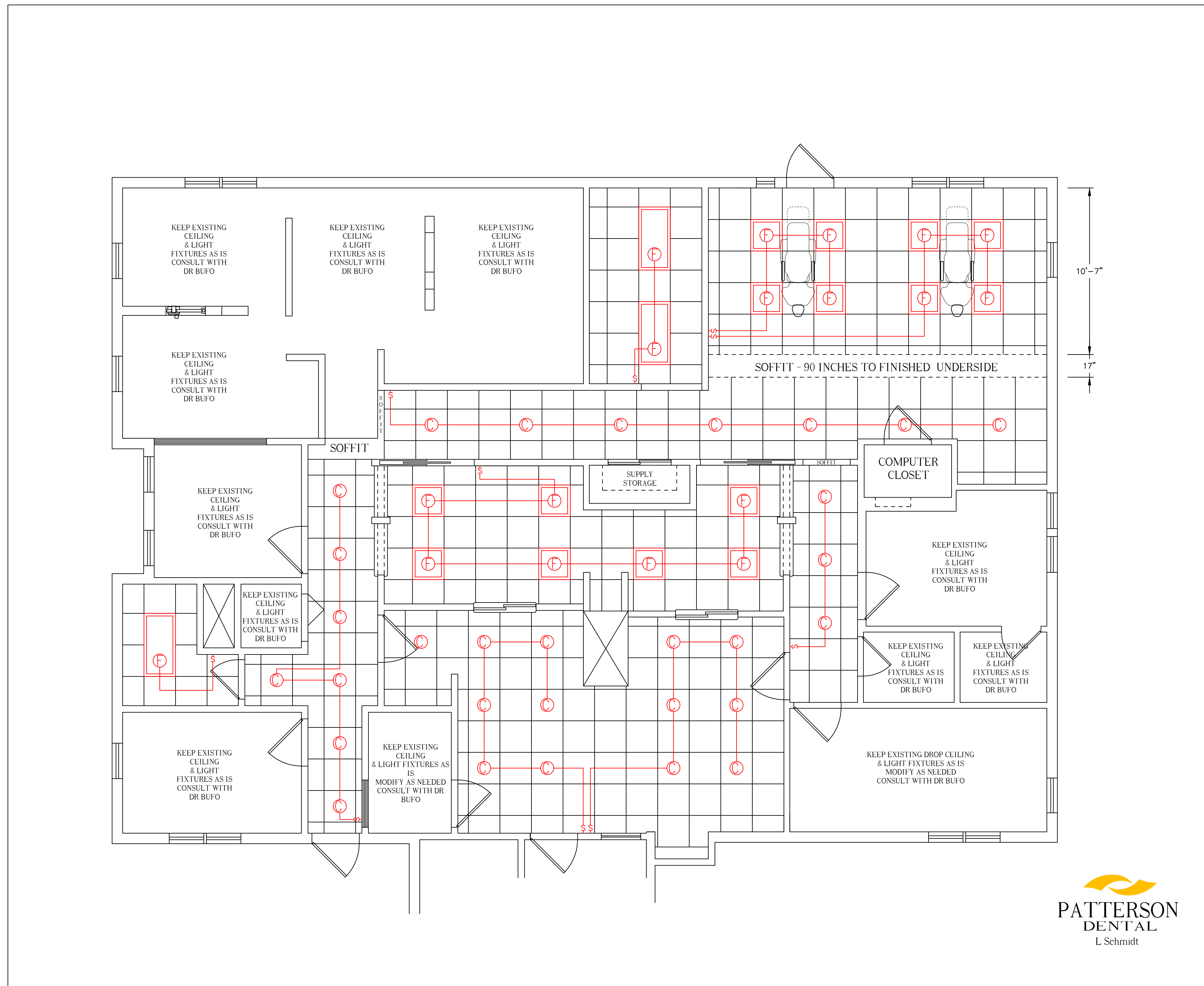

**LIGHTING SPECIFICATIONS**

- Ⓢ INCANDESCENT LIGHT – Selection to be approved by doctor.
- Ⓛ FOUR TUBE 2X4 FLORESCENT LIGHT FIXTURE – Selection to be approved by doctor. COLOR CORRECTED FULL SPECTRUM TUBES WITH PRISMATIC LENS RECOMMENDED.
- Ⓛ FOUR TUBE 2X4 FLORESCENT LIGHT FIXTURE – Selection to be approved by doctor. COLOR CORRECTED FULL SPECTRUM TUBES WITH PRISMATIC LENS RECOMMENDED.
- Ⓢ WALL SWITCH – To control ceiling lights, wall recepticles, etc.

**PATTERSON DENTAL**  
L Schmidt

**PATTERSON DENTAL**  
L Schmidt

202 Gannett Drive  
South Portland, ME  
800 639-1801

**PATTERSON DENTAL**

Designed by  
L Schmidt

THESE DRAWINGS AND SPECIFICATIONS ARE THE PROPERTY OF PATTERSON DENTAL. NO PART OF THESE DRAWINGS OR SPECIFICATIONS MAY BE REPRODUCED, COPIED, OR TRANSMITTED IN ANY FORM OR BY ANY MEANS, ELECTRONIC OR MECHANICAL, INCLUDING PHOTOCOPYING, RECORDING, OR BY ANY INFORMATION STORAGE AND RETRIEVAL SYSTEM, WITHOUT THE WRITTEN PERMISSION OF PATTERSON DENTAL SUPPLY, INC. ALL DIMENSIONS SHALL TAKE PREFERENCE OVER SCALE DIMENSIONS AND SHALL BE VERIFIED ON THE JOB SITE. ALL WORK SHALL BE BROUGHT TO THE ATTENTION OF PATTERSON DENTAL SUPPLY PRIOR TO THE COMMENCEMENT OF ANY WORK. THE CONTRACTOR SHALL BE RESPONSIBLE FOR ALL CURRENT AMERICAN NATIONAL STANDARDS AND CODES. THE CONTRACTOR SHALL ALSO BE RESPONSIBLE FOR ALL REQUIRED BACKFLOW PREVENTING TO THE CONSTRUCTION OF THIS PROJECT.

**DENTAL OFFICE BUILDING**  
DR M BUFO  
612 BRIGHTON AVE  
PORTLAND MAINE

DATE: AUGUST 2, 2013  
SCALE: 1/4" = 1'-0"

REVISED	DATE:

SHEET NO.

**D6**

6 of 6

THESE DIAGRAMS ARE NOT AN ARCHITECTURAL PLAN. THESE DIAGRAMS ARE NOT DRAWN TO ARCHITECTURAL SCALE NOR DO THEY INCLUDE ALL OF THE REQUIREMENTS THAT MAY BE REQUIRED FOR AN ARCHITECT TO PROVIDE YOU WITH COMPLETE ARCHITECTURAL PLANS. PATTERSON'S DIAGRAMS MAY NOT BE SUBMITTED AS FINISHED ARCHITECTURAL DRAWINGS FOR THE PURPOSE OF OBTAINING A BUILDING PERMIT. IF YOU SHOULD CHOOSE TO USE PATTERSON'S DIAGRAM IN THE PLACEMENT OF YOUR EQUIPMENT, YOU SHOULD RETAIN A REGISTERED ARCHITECT TO CONVERT THE DIAGRAM INTO PROPER AND COMPLETE ARCHITECTURAL PLANS. PATTERSON WILL WORK WITH THE ARCHITECT YOU SELECT TO DEVELOP COMPLETE ARCHITECTURAL PLANS.