

DR MICHAEL BUFO... PROPOSED OFFICE LAYOUT

GENERAL SPECIFICATIONS

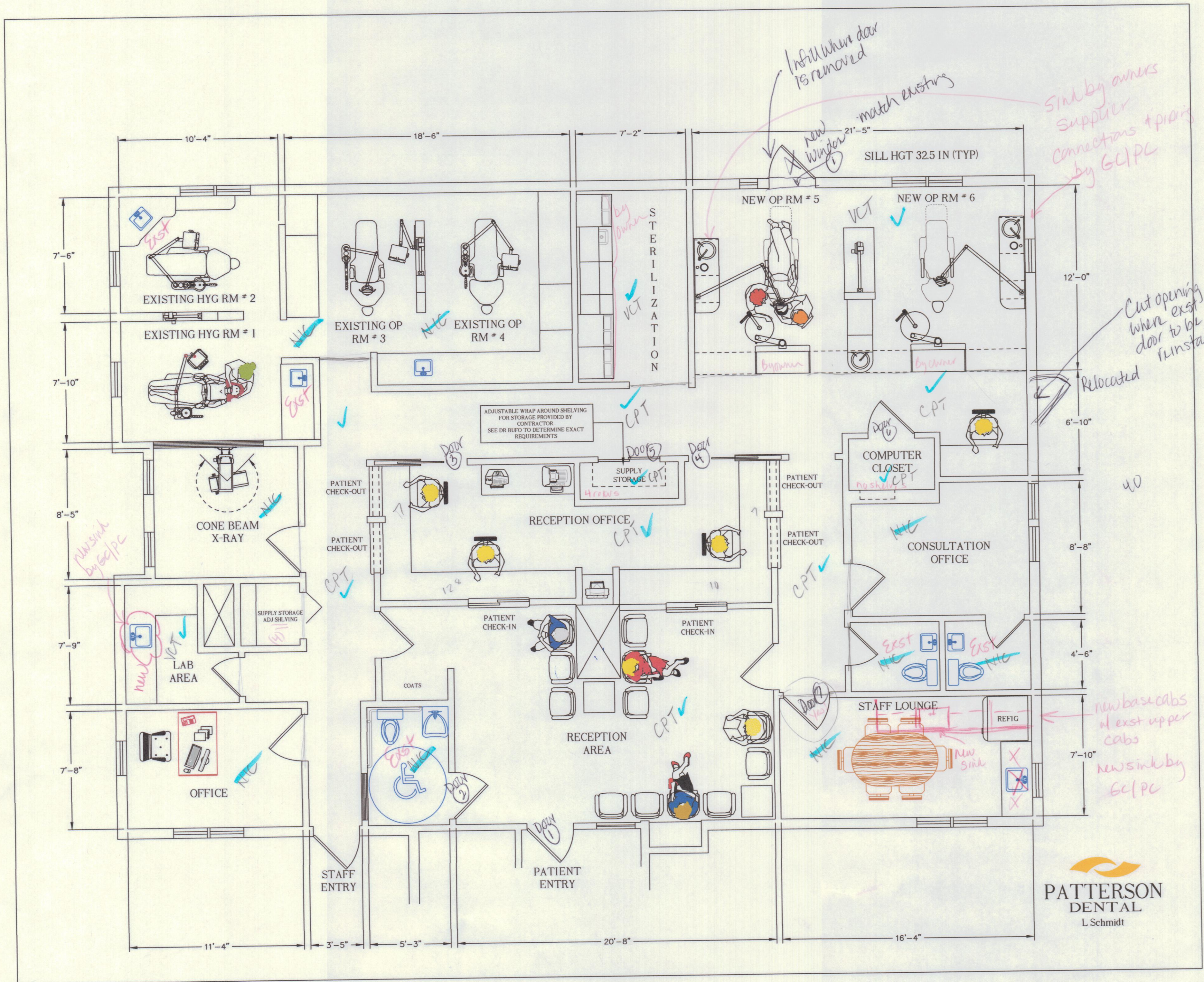

AUGUST 2, 2013

GENERAL SPECIFICATIONS

CONTRACTOR - OWNER - DOCTOR PLEASE READ

- The filing of registered architect's plans with the building department shall be the responsibility of the contractor, tenant or owner. This shall be agreed upon beforehand and incorporated into the lease, such party paying all fees incurred.
- The contractor shall comply with all state and city laws, ordinances, rules, regulations, and codes pertaining to the construction of this office. He shall also file necessary plans and applications with the city departments and pay for, and obtain, all certificates of approval.
- Dimensions are to finished floors, walls and ceilings. The contractor assumes all responsibility for accuracy of field measurements and conditions. Written specifications shall have precedence over scaled drawings.
- No responsibility will be assumed by PATTERSON DENTAL SUPPLY or any of its employees, if the plans and/or specifications are deviated from. Changes must be approved in writing.
- All plumbing and electrical lines are to be concealed, unless otherwise specified.
- All labor and material necessary to changes in existing plumbing, carpentry and electrical work must be done by the contractor and IS NOT INCLUDED IN THE COST OF THE DENTAL EQUIPMENT.
- The contractor shall remove rubbish and do all patching after roughing in is completed.
- Air conditioning and heating systems are recommended to turn the air in suite six times per hour minimum, and maintain 68 to 75 degrees throughout the suite. Thermostat to be located in suite. One register in each room, minimum. Contractor shall determine size and location of units, ducts and electrical and/or plumbing lines as necessary.
- Rough and finish for dental equipment is to be in accordance with mfg templates for the dental equipment being installed. A representative of PATTERSON DENTAL SUPPLY, INC. will position said templates in their appropriate locations, at which time all specifications will be explained to the contractor or sub-contractor. All specified sizes of pipes, tubings, etc. must be rigidly followed as well as proper heights adhered to. Any infractions on sizes or heights of pipes, tubings or fittings will have to be corrected before the equipment can be installed and such extra expense will be the responsibility of the contractor or sub-contractor.
- The doctor shall designate responsibility for providing and installing custom cabinetry and formica counter tops (other than those purchased from Patterson Dental Supply, Inc.) in the lab, staff lounge, reception office, doctor's private office, etc.
- Doctor shall make arrangements for installation of telephones, inter-communications and music systems before walls are closed in.
- Circuit breaker box for suite to be located in suite and conveniently accessible. Location to be approved by the Doctor.
- Provide locks on all outside and reception room doors. Provide bathroom-style locks on all bathroom doors.
- A FINAL CHECK of all roughing must be made by a PATTERSON DENTAL representative BEFORE PARTITIONS ARE CLOSED and/or prior to THE POURING OF CONCRETE FLOORS.
- Install main water, air (and gas, where necessary) shutoffs for each operatory, lab or sterilization area.
- The Patterson Dental Supply Inc. representative shall give instructions to the GENERAL CONTRACTOR ONLY. All communications and coordination with tradesmen shall be the responsibility of the general contractor.
- Patterson Dental Supply technicians will assemble and connect to mechanical services, such as electrical, cold water, gas, air, vacuum, whichever are required for operation of a particular item, provided such mechanical services are SUPPLIED COMPLETELY by other trades and are brought to positions specified by a Patterson Dental representative and are supplied with proper connections, fittings or junctions. We will connect to such fittings or junctions provided our service technicians are permitted to do so with state and local building codes.

202 Gannett Drive
South Portland, ME
800 639-1801



Designed by
L Schmidt

THESE DIAGRAMS AND SPECIFICATIONS ARE THE PROPERTY OF PATTERSON DENTAL SUPPLY, INC. AND ARE TO BE USED ONLY FOR THE PROJECT AND LOCATION SPECIFICALLY IDENTIFIED HEREIN. NO PART OF THESE DIAGRAMS OR SPECIFICATIONS ARE TO BE REPRODUCED OR TRANSMITTED IN ANY FORM OR BY ANY MEANS, ELECTRONIC OR MECHANICAL, INCLUDING PHOTOCOPYING, RECORDING, OR BY ANY INFORMATION STORAGE AND RETRIEVAL SYSTEM, WITHOUT THE WRITTEN PERMISSION OF PATTERSON DENTAL SUPPLY, INC. ANY CHANGES OR MODIFICATIONS TO THESE DIAGRAMS OR SPECIFICATIONS SHALL BE THE RESPONSIBILITY OF THE ARCHITECT OR CONTRACTOR. PATTERSON DENTAL SUPPLY, INC. IS NOT RESPONSIBLE FOR ANY LIABILITY ARISING FROM THE USE OF THESE DIAGRAMS OR SPECIFICATIONS. THE CONTRACTOR OR SUB-CONTRACTOR SHALL BE RESPONSIBLE FOR ALL REQUIRED LOCAL, STATE AND FEDERAL PERMITS AND REGULATIONS PERTAINING TO THE CONSTRUCTION OF THIS PROJECT.

DENTAL OFFICE BUILDING
DR M BUFO
612 BRIGHTON AVE
PORTLAND MAINE

DATE: AUGUST 2, 2013
SCALE: 1/4" = 1'-0"

REVISED	DATE:

SHEET NO.

D1
1 of 6

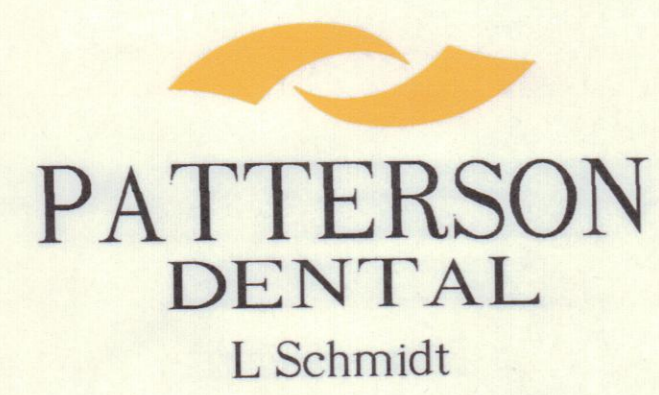

57

THESE DIAGRAMS ARE NOT AN ARCHITECTURAL PLAN. THESE DIAGRAMS ARE NOT DRAWN TO ARCHITECTURAL SCALE. NOR DO THEY REFLECT ALL OF THE REQUIREMENTS THAT MAY BE REQUIRED FOR AN ARCHITECT TO PROVIDE YOU WITH COMPLETE ARCHITECTURAL PLANS. PATTERSON'S DIAGRAMS MAY NOT BE SUBMITTED AS FINISHED ARCHITECTURAL DRAWINGS FOR THE PURPOSE OF OBTAINING A BUILDING PERMIT. IF YOU SHOULD CHOOSE TO USE PATTERSON'S DIAGRAMS IN THE PLACEMENT OF YOUR EQUIPMENT, YOU SHOULD RETAIN A REGISTERED ARCHITECT TO CONVERT THE DIAGRAM INTO PROPER AND COMPLETE ARCHITECTURAL PLANS. PATTERSON WILL WORK WITH THE ARCHITECT YOU SELECT TO DEVELOP COMPLETE ARCHITECTURAL PLANS.