

DR MICHAEL BUFO... PROPOSED OFFICE LAYOUT

PLUMBING SPECIFICATIONS

AUGUST 2, 2013

PLUMBING SPECIFICATIONS

The plumber shall run all piping in accordance with local regulations. All plumbing lines are to be concealed, unless otherwise specified. During the dental equipment installation THE PLUMBER MUST BE ON THE JOB TO CONNECT ALL PLUMBING LINES to the "dental" modular cabinet sinks & faucets.
 Manufacturer's specification templates for all dental equipment will be provided by a Patterson Dental representative. The representative will also supervise the location of said templates in coordination with the general contractor.

DWV

DENTAL UNIT WITH VACUUM - Install 1/2" MPT cold water, 1/2" MPT air, & 5/8" OD vacuum pipes, where specified, above finished floor or out from wall. See manufacturer's specification template for positioning. These dimensions are CRITICAL. The plumber must comply with measurements on the mfg templates. Adapters and valves, where indicated, must be rigidly conformed to. Provide a water pressure regulator, if the pressure exceeds 150 psi.

DW

DENTAL UNIT WITH WASTE & NO VACUUM - Install 1/2" MPT cold water, & 1/2" MPT air, & 1-1/2" WASTE where specified, above finished floor. See manufacturer's specification template for positioning. These dimensions are CRITICAL. The plumber must comply with measurements on the mfg templates. Adapters and valves, where indicated, must be rigidly conformed to. Provide a water pressure regulator, if the pressure exceeds 150 psi.

W-TEC

MODULAR CABINET SINK AND SINGLE LEVER FAUCET - Install waste, hot and cold water lines 18" above floor. Supplied and installed by plumber unless noted (NIC). The lab area requires installation for waste, hot, & cold water lines at 21" AFF

PT

PLASTER TRAP - Install for lab sink and model trimmer. Supplied by the doctor via Patterson and installed by plumber. Brace trap to support weight of full trap and to simplify the removal of the container for cleaning (see detail).

MT

MODEL TRIMMER - Install cold water line with a chrome angle stop...1/2" X 3/8" compression Model trimmer has a 1" male nipple for flexible waste pipe connection. Plumber to run waste line from trimmer to sink tailpipe/plaster trap with tee into sink strainer tailpipe connection. Provided by doctor and installed by plumber (see detail).

AO

AIR OUTLET - Terminate with angle stop...1/2" X 3/8" compression. Install as noted on plan. See the Patterson Dental Representative.

SO

SUCTION OUTLET - Incorporated into dental unit plumbing as designated on the plan. See the Patterson Dental Representative.

NIC

NIC - FIXTURES are NOT to be in the plumbers contract. However, where these items do appear, the contractor shall provide the labor and materials to insure proper installation. See manufacturer's templates and specifications.

UTILITIES LOCATED IN THE BASEMENT

CA

COMPRESSED AIR SYSTEM - TIE IN TO THE EXISTING...
 Run 1/2" copper or pex to all termination points that require compressed air as indicated on the floor plan.
 Terminate with an angle stop...1/2" X 3/8" compression. See the Patterson Dental Rep.

CV

SUCTION UNIT - DRY VACUUM SYSTEM - TIE IN TO THE EXISTING
TRUNK LINE - Run 1-1/2" trunk line in schedule 40 PVC piping below the finished floor. Avoid installation of hard 90 degree turns. Use long sweep fittings or two 45 degree elbows as needed. Install reduction bushings just beneath termination points & convert to 1/2" (5/8"OD) copper & extend above the finished floor. Install 90 degree elbow with a 3" - 4" nipple & terminate with a cap. The cap is removed during the dental equipment installation & a 5/8" ID tubing is slipped over the pipe.

FW

FILTERED WATER SYSTEM - TIE IN TO THE EXISTING...
 Run 1/2" copper or pex to all termination points that require cold water as indicated on the floor plan.
 Terminate with an angle stop...1/2" X 3/8" compression. See the Patterson Dental Rep.

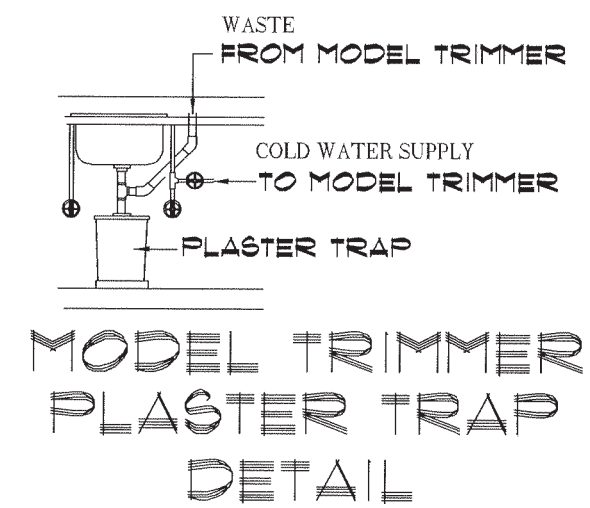

THESE DIAGRAMS ARE NOT AN ARCHITECTURAL PLAN. THESE DIAGRAMS ARE NOT DRAWN TO ARCHITECTURAL SCALE. NOR DO THEY INDICATE ALL OF THE REQUIREMENTS THAT MAY BE REQUIRED FOR AN ARCHITECT TO PROVIDE YOU WITH COMPLETE ARCHITECTURAL PLANS. PATTERSON'S DIAGRAMS MAY NOT BE SUBMITTED AS FINISHED ARCHITECTURAL DRAWINGS FOR THE PURPOSE OF OBTAINING A BUILDING PERMIT. IF YOU SHOULD CHOOSE TO USE PATTERSON'S DIAGRAM IN THE PLACEMENT OF YOUR EQUIPMENT, YOU SHOULD RETAIN A REGISTERED ARCHITECT TO CONVERT THE DIAGRAM INTO PROPER AND COMPLETE ARCHITECTURAL PLANS. PATTERSON WILL WORK WITH THE ARCHITECT YOU SELECT TO DEVELOP COMPLETE ARCHITECTURAL PLANS.

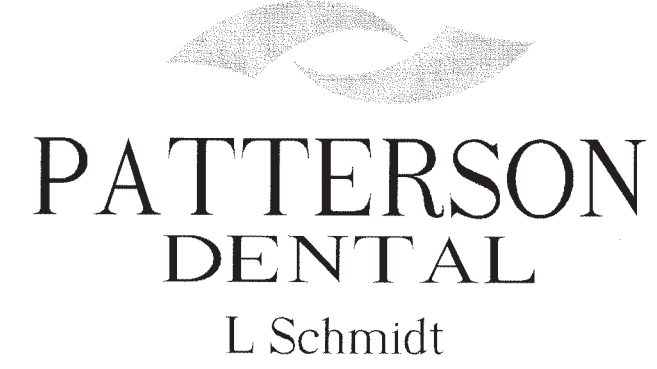
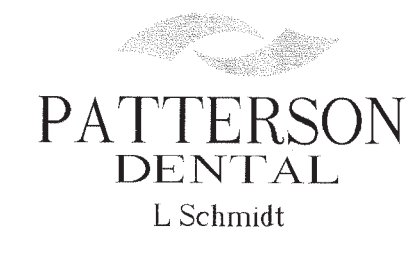
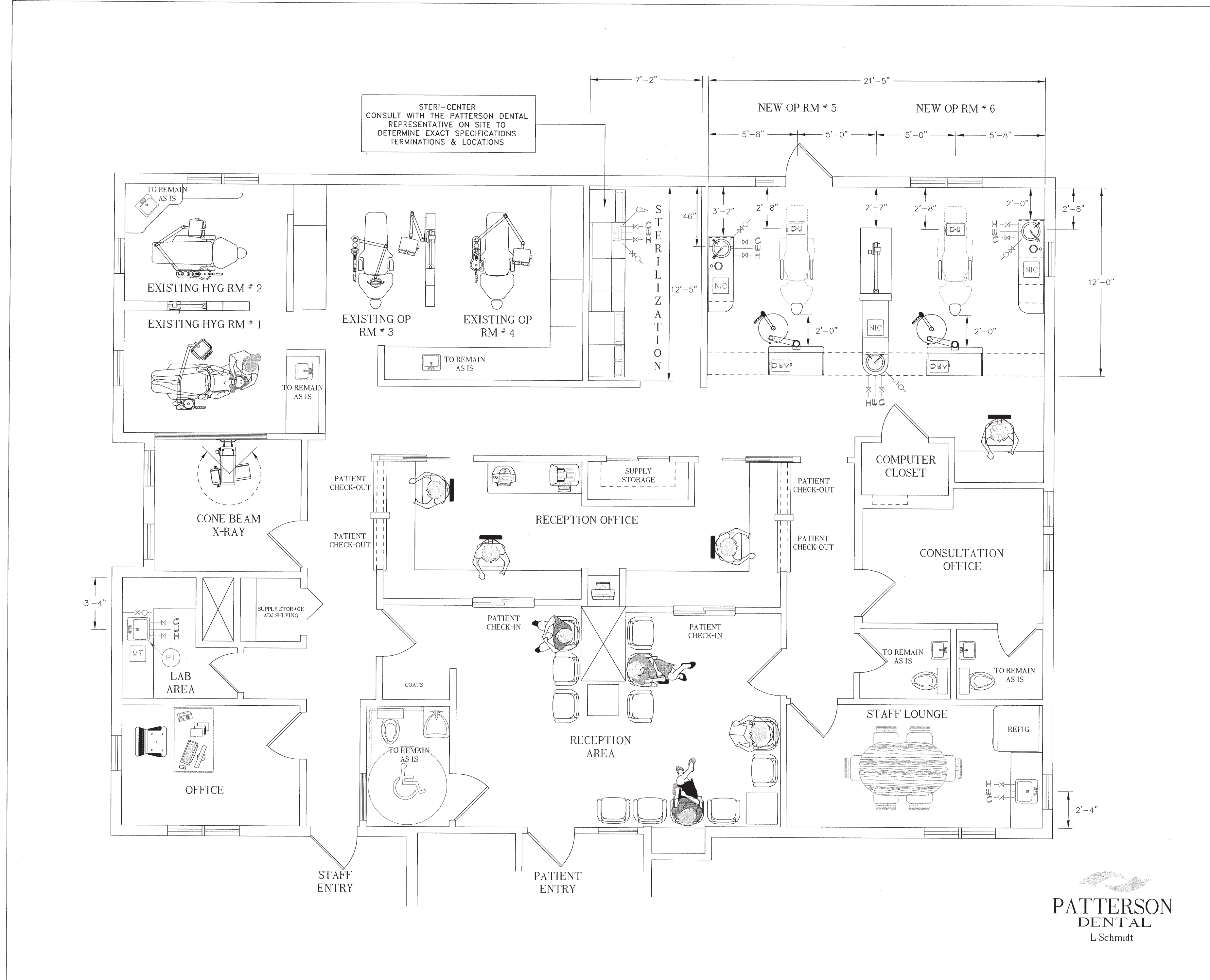

202 Gannett Drive
 South Portland, ME
 800 639-1801

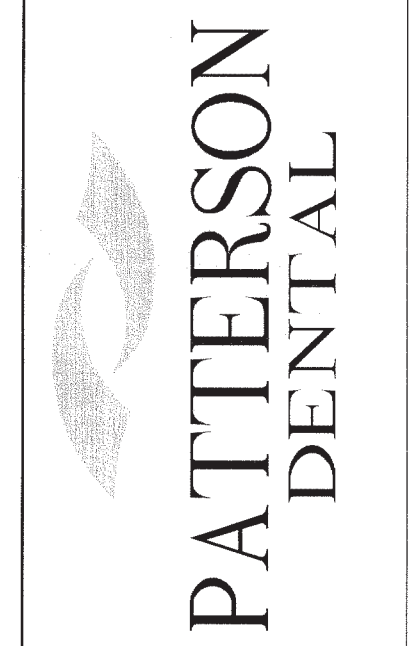

Designed by
 L Schmidt

THESE DIAGRAMS ARE NOT AN ARCHITECTURAL PLAN. THESE DIAGRAMS ARE NOT DRAWN TO ARCHITECTURAL SCALE. NOR DO THEY INDICATE ALL OF THE REQUIREMENTS THAT MAY BE REQUIRED FOR AN ARCHITECT TO PROVIDE YOU WITH COMPLETE ARCHITECTURAL PLANS. PATTERSON'S DIAGRAMS MAY NOT BE SUBMITTED AS FINISHED ARCHITECTURAL DRAWINGS FOR THE PURPOSE OF OBTAINING A BUILDING PERMIT. IF YOU SHOULD CHOOSE TO USE PATTERSON'S DIAGRAM IN THE PLACEMENT OF YOUR EQUIPMENT, YOU SHOULD RETAIN A REGISTERED ARCHITECT TO CONVERT THE DIAGRAM INTO PROPER AND COMPLETE ARCHITECTURAL PLANS. PATTERSON WILL WORK WITH THE ARCHITECT YOU SELECT TO DEVELOP COMPLETE ARCHITECTURAL PLANS.

DENTAL OFFICE BUILDING
 DR M BUFO
 612 BRIGHTON AVE
 PORTLAND MAINE

DATE: AUGUST 2, 2013
 SCALE: 1/4" = 1'-0"

REVISED	DATE:

SHEET NO.

BUFO Interior Renovation
 P1 Plumbing
 Stamped