

DR MICHAEL BUFO... PROPOSED OFFICE LAYOUT

LIGHTING SPECIFICATIONS

AUGUST 2, 2013

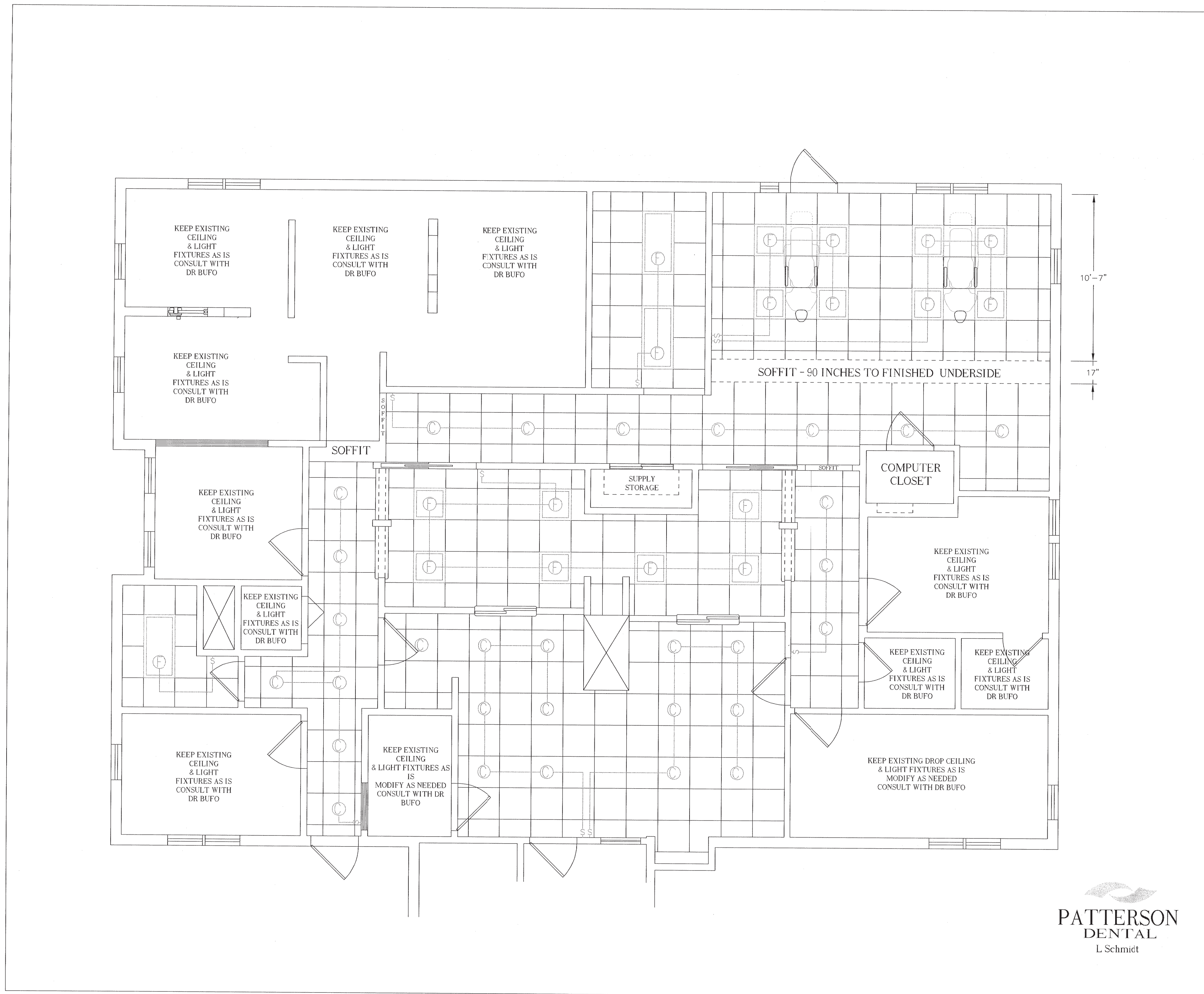

LIGHTING SPECIFICATIONS

- INCANDESCENT LIGHT - Selection to be approved by doctor.
- □ □ □ □ FOUR TUBE 2X4 FLORESCENT LIGHT FIXTURE - Selection to be approved by doctor. COLOR CORRECTED FULL SPECTRUM TUBES WITH PRISMATIC LENS RECOMMENDED.
- □ □ □ □ FOUR TUBE 2X4 FLORESCENT LIGHT FIXTURE - Selection to be approved by doctor. COLOR CORRECTED FULL SPECTRUM TUBES WITH PRISMATIC LENS RECOMMENDED.
- Ⓢ WALL SWITCH - To control ceiling lights, wall receptacles, etc.

PATTERSON DENTAL
L Schmidt

PATTERSON DENTAL
L Schmidt

202 Gannett Drive
South Portland, ME
800 639-1801

PATTERSON DENTAL

Designed by
L Schmidt

THESE DRAWINGS AND SPECIFICATIONS ARE THE PROPERTY OF PATTERSON DENTAL SUPPLY AND THE USE IS LIMITED TO A SPECIFIC PROJECT FOR THE PERSON OR FIRM FOR WHOM THEY WERE PREPARED. NO PART OF THESE DRAWINGS OR SPECIFICATIONS ARE TO BE REPRODUCED OR COPIED IN ANY MANNER WITHOUT THE WRITTEN PERMISSION OF PATTERSON DENTAL SUPPLY, INC. WRITTEN DIMENSIONS SHALL TAKE PREFERENCE OVER SCALE DIMENSIONS AND ANY DISCREPANCIES OR CHANGES SHALL BE BROUGHT TO THE ATTENTION OF PATTERSON DENTAL SUPPLY PRIOR TO THE COMMENCEMENT OF ANY WORK. DISCREPANCIES SHALL BE THE RESPONSIBILITY OF THE USER. CURRENT AMERICAN DIMENSIONAL SYSTEMS SHALL APPLY UNLESS OTHERWISE SPECIFIED. THE CONTRACTOR SHALL COMPLY WITH ALL STATE, CITY AND LOCAL CODES PERTAINING TO THE CONSTRUCTION OF THIS PROJECT.

DENTAL OFFICE BUILDING
DR M BUFO
612 BRIGHTON AVE
PORTLAND MAINE

DATE: AUGUST 2, 2013
SCALE: 1/4" = 1'-0"

REVISED	DATE:

SHEET NO.

BUFO Interior Renovation
A2 Reflected Ceiling Plan
Stamp

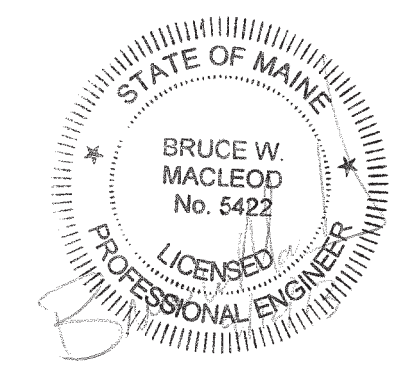

THESE DIAGRAMS ARE NOT AN ARCHITECTURAL PLAN. THESE DIAGRAMS ARE NOT DRAWN TO ARCHITECTURAL SCALE, NOR DO THEY INCLUDE ALL OF THE REQUIREMENTS THAT MAY BE REQUIRED FOR AN ARCHITECT TO PROVIDE YOU WITH COMPLETE ARCHITECTURAL PLANS. PATTERSON'S DIAGRAMS MAY NOT BE SUBMITTED AS PROPOSED ARCHITECTURAL DRAWINGS FOR THE PURPOSE OF OBTAINING A BUILDING PERMIT. IF YOU SHOULD CHOOSE TO USE PATTERSON'S DIAGRAM IN THE PLACEMENT OF YOUR EQUIPMENT, YOU SHOULD RETAIN A REGISTERED ARCHITECT TO CONVERT THE DIAGRAM INTO PROPER AND COMPLETE ARCHITECTURAL PLANS. PATTERSON WILL WORK WITH THE ARCHITECT YOU SELECT TO DEVELOP COMPLETE ARCHITECTURAL PLANS.