

| SHEET INDEX | DWG NO. | SHEET NO. |
|--|---------|-----------|
| PROPOSED UST SITE PLAN | CFG14.0 | 1 OF 8 |
| MATERIAL LIST | CFG14.1 | 2 OF 8 |
| TANK INSTALLATION DETAILS | CFG14.2 | 3 OF 8 |
| TANK INSTALLATION DETAILS | CFG14.3 | 4 OF 8 |
| SUMP & PIPING DETAILS | CFG14.4 | 5 OF 8 |
| SUMP & PIPING DETAILS | CFG14.5 | 6 OF 8 |
| TANK INSTALLATION DETAILS | CFG14.6 | 7 OF 8 |
| DISPENSER APRON PLAN, SECTIONS AND DETAILS | CFG14.7 | 8 OF 8 |

EXISTING TANK NOTES

| TANK CAPACITY | CONTENT | MATERIAL | INSTALLED | INTENT |
|--------------------|----------|----------|-----------|---------------|
| (1-1) 8,000 gallon | gasoline | SW FRP | 8-1-96 | TO BE REMOVED |
| (2-1) 8,000 gallon | gasoline | SW FRP | 8-1-96 | TO BE REMOVED |
| (3-1) 8,000 gallon | gasoline | SW FRP | 8-1-96 | TO BE REMOVED |

NEW TANK INSTALLATION NOTES

- The new underground storage tanks were installed in the month of 20.
- All underground tanks to be double-walled fiberglass.
- | TANK# | CONTENT | CAPACITY | MATERIAL | INSTALLED |
|-------|------------|----------------|----------|-----------|
| (4-1) | REG. UNL. | 12,000 gallons | dwf | proposed |
| (4-2) | DIESEL | 8,000 gallons | dwf | proposed |
| (5-1) | REG. UNL. | 12,000 gallons | dwf | proposed |
| (5-2) | PREM. UNL. | 8,000 gallons | dwf | proposed |
- The interstitial space of a double-walled tank shall be continuously monitored for both water and stored product (VEEDER-ROOT TLS-350, w/ #WR794380-303 Hydrostatic Sensor - Brine) and be equipped with an audio/visual alarm system.
- All supply lines are (SMITH FIBERCAST) double-walled fiberglass. All vent lines are single-walled fiberglass below grade.
- Piping shall be designed and installed to allow for testing without excessive excavation.
- Provide an overflow prevention valve on all fill tubes (A1100-EVR-056)
- A line leak detector shall be provided on the discharge of all remote pumps (FE PETRO)
- There are 2 - 4" slotted PVC observation wells. (1 @ opposite corner of the tank installation.)
- OWNER/OPERATOR: (day or night)
CUMBERLAND FARMS INC.
100 CROSSING BLVD.
FRAMINGHAM, MA 01702
(508) 270-1400

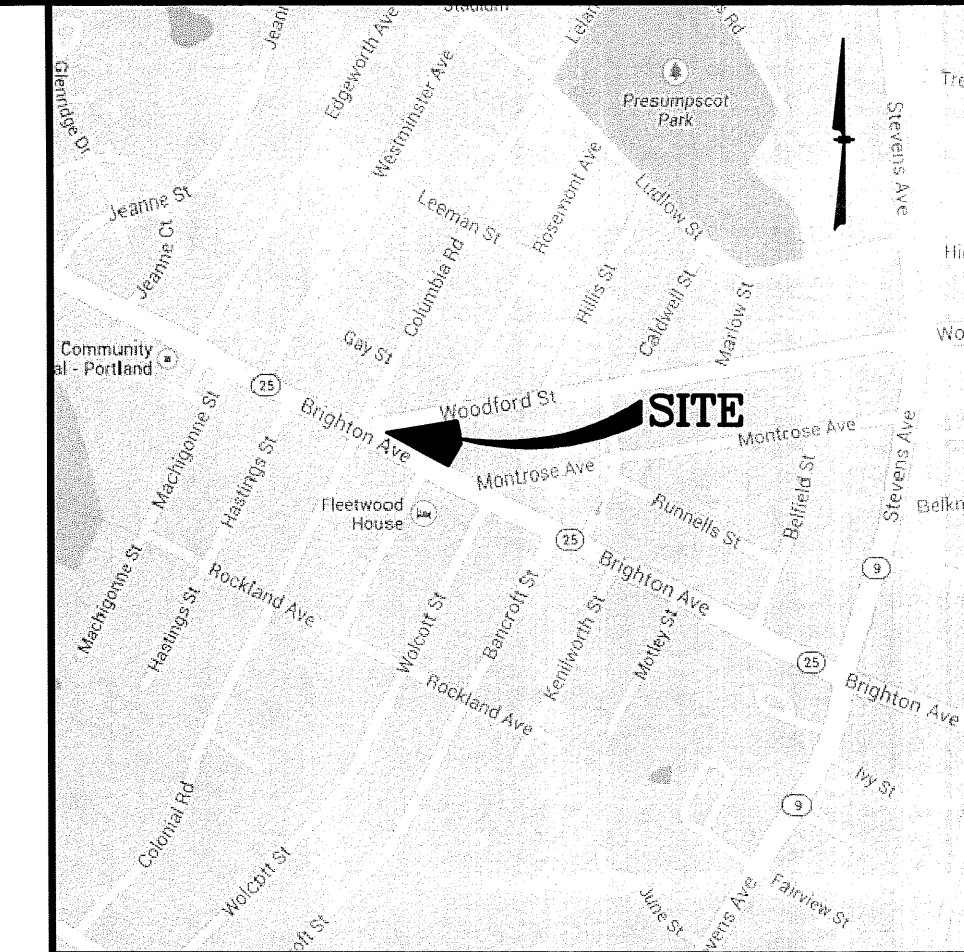

LOCATION MAP
(NOT TO SCALE)

NOTES:

- EXISTING MDEP REGISTRATION #8190. SITE IS IDENTIFIED BY MDEP AS: 569 BRIGHTON AVENUE.
- THE INTENT OF THIS PLAN IS TO SHOW THE INSTALLATION OF TWO NEW 20,000 GALLON COMPARTMENTALIZED UNDERGROUND FUEL STORAGE TANKS, PRODUCT PIPING AND VENT PIPING.
- EXISTING BOUNDARY AND TOPOGRAPHIC INFORMATION AS SHOWN WAS PREPARED BY CONTROL POINT ASSOCIATES, INC. (PLAN REF#1)
- THE UNDERGROUND STORAGE SYSTEM WILL BE TESTED BY THE CERTIFIED TANK INSTALLER PRIOR TO BACKFILLING AS FOLLOWS:
 A. PRODUCT PIPING (NOV - RED THREAD I/A)
 THE FOLLOWING TESTS SHALL BE CERTIFIED BY THE INSTALLER PRIOR TO BACKFILLING AND COPIES OF THE RESULTS SHALL BE PROVIDED TO THE OWNER AT THE TIME OF BACKFILL INSPECTION.
 PRIMARY LINE:
 VISUALLY INSPECT ALL JOINTS FOR PROPER INSERTION AND ADHESIVE CURE PRIOR TO PRESSURIZING THE SYSTEM. A GAP BETWEEN THE ADHESIVE BEAD AND THE FITTING SHOULD INDICATE THAT THE POSSIBILITY OF JOINT FAILURE EXISTS. MAKE ANY NECESSARY REPAIRS BEFORE PRESSURIZING THE SYSTEM.
 CHECK THE INTEGRITY OF THE JOINTS BY PRESSURIZING THE SYSTEM TO 25 PSIG AND HOLDING THE PRESSURE FOR A MINIMUM OF ONE MINUTE. SOAP ALL JOINTS TO TEST FOR LEAKS.
 IF THERE ARE NO LEAKS, RAISE THE LINE PRESSURE IN THE SYSTEM TO A MAXIMUM OF 50 PSIG. AGAIN, HOLD THE PRESSURE FOR AT LEAST ONE MINUTE AND SOAP ALL JOINTS TO CHECK FOR LEAKS.
 SECONDARY LINE:
 PERFORM AN AIR TEST AT 10 PSIG AND MAINTAIN THE PRESSURE FOR A MINIMUM PERIOD OF ONE HOUR, OR LONG ENOUGH TO SOAP ALL JOINTS, BEFORE BACKFILL. THE CONTRACTOR SHALL MAINTAIN THE REQUIRED PRESSURE FOR A MINIMUM OF 2 HOURS AFTER THE BACKFILL PROCESS HAS BEEN COMPLETED. THE RESULTS OF THIS POST BACKFILL TEST SHALL BE CERTIFIED BY THE INSTALLER AND RESULTS SHALL BE PROVIDED TO THE OWNER WITHIN 30 DAYS OF THE TEST.
 B. TANKS
 EACH NEW TANK SHALL BE PRECISION TIGHTNESS TESTED BY A QUALIFIED TECHNICIAN.
- THE CONTRACTOR SHALL CALL DISOFA 1-888-344-7233 AT LEAST 72 WORKING HOURS PRIOR TO ANY EXCAVATION.
- ALL CONSTRUCTION AND EQUIPMENT MUST CONFORM TO THE APPLICABLE REGULATIONS AND CODES OF THE CITY, THE STATE OF MAINE (MDEP CHAPTER 691), AND THE NFPA.
- CONTRACTOR SHALL PROVIDE AT LEAST 5 DAYS ADVANCE NOTICE TO THE LOCAL FIRE DEPARTMENT AND THE OWNER TO INSPECT THE INSTALLATION PRIOR TO FINAL BACKFILL.
- UNDERGROUND TANKS TO BE FILLED BY GRAVITY.
- CONTRACTOR TO HAVE "FCI" CERTIFICATION.
- CONTRACTOR TO VERIFY WITH OWNER THE PRODUCT PIPING LAYOUT AS SHOWN ON THIS PLAN PRIOR TO CONSTRUCTION.
- CONTRACTOR TO PROVIDE FLEXIBILITY ON ALL VENT LINES VIA FLEX CONNECTORS, OR BY PROVIDING AT LEAST FOUR FEET OF STRAIGHT RUN (2" PIPE) AND SIX FEET OF STRAIGHT RUN (3" PIPE) BETWEEN CHANGES IN DIRECTION GREATER THAN 30 DEGREES.
- CONTRACTOR TO ADJUST GRADES AS REQUIRED OVER THE TANK MAT TO ENSURE THAT IT SHEETS ANY STORMWATER RUNOFF.
- PARKING LOT TO BE SEALCOATED. GENERAL CONTRACTOR TO MATCH EXISTING GRADES ON-SITE. ALL ADA ACCESSIBLE PARKING STALLS AND ACCESS AISLES CANNOT EXCEED 2% SLOPE IN ANY DIRECTION.
- REMOVE AND DECOMMISSION EXISTING STAGE II GASOLINE VAPOR RECOVERY PIPING AS NECESSARY.

PLAN REFERENCES:

- BOUNDARY & TOPOGRAPHIC SURVEY; PREPARED FOR CUMBERLAND FARMS; PREPARED BY CONTROL POINT ASSOCIATES, INC.; DATE: 8-21-13; SCALE: 1"=20'.

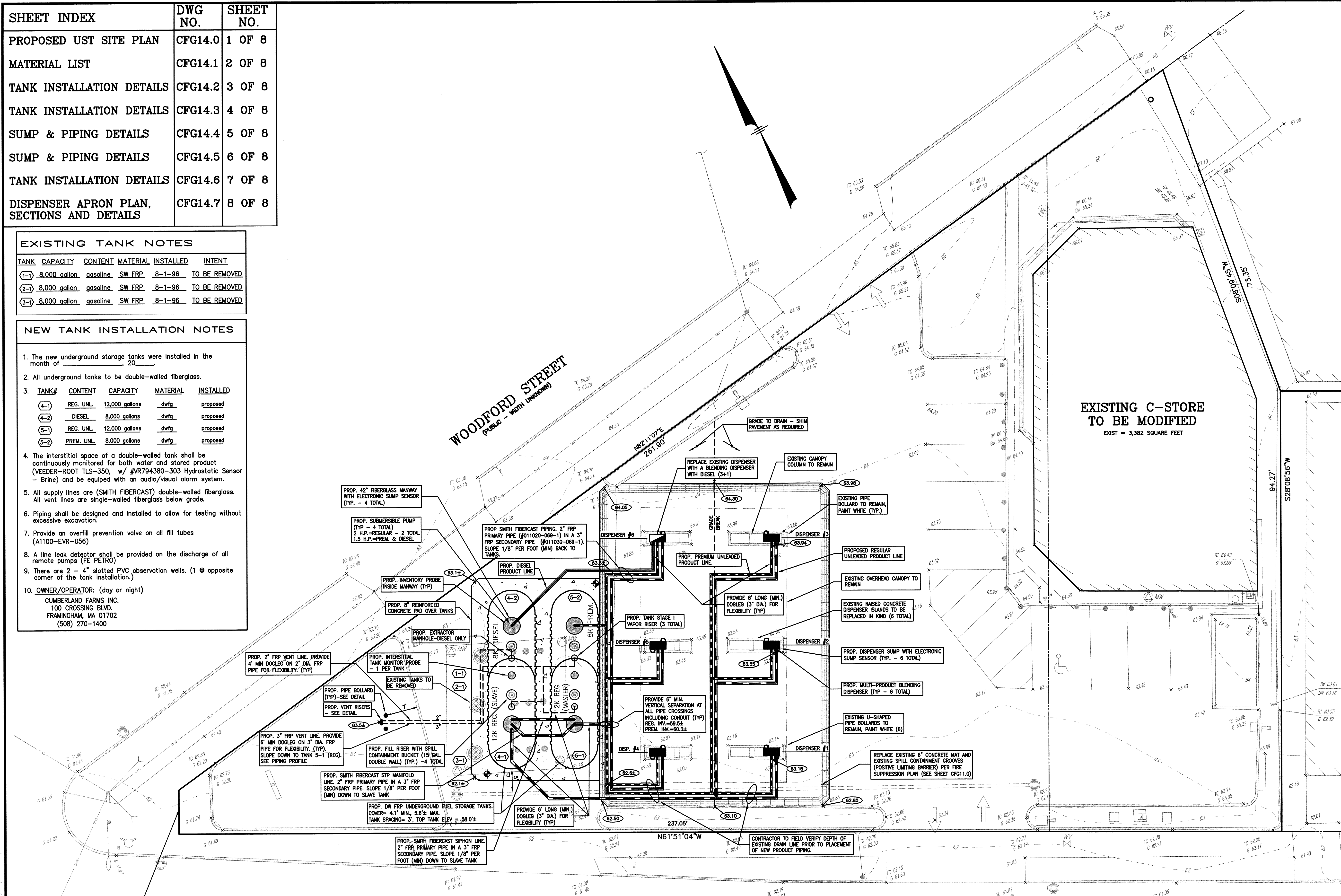

DIG SAFE

MA-ME-NH-VT
1-888-NICE-ONE
NY-1-800-922-7982
CT-1-800-922-4455

GRAPHIC SCALE
(IN FEET)
1 inch = 10 ft

BRIGHTON AVENUE
(A.K.A. ROUTE 25)
(PUBLIC - VARIABLE WIDTH)

REVISIONS

| NO. | DATE | REV. BY. | DESCRIPTION |
|-----|------|----------|-------------|
| | | | |
| | | | |
| | | | |
| | | | |

21,521 SQUARE FEET
0.494 ACRES
V #1614
Store #5613
Gas Station #1848

PROPOSED UST SITE PLAN
CFG14.0

44 Stiles Road, Suite One
Salem, New Hampshire 03079
(603) 893-0720
ENGINEERS • PLANNERS • SURVEYORS
www.mhfdesign.com

MHF Design Consultants, Inc.

512 WOODFORD STREET
PORTLAND, ME

CUMBERLAND FARMS INC.
100 CROSSING BLVD.
FRAMINGHAM, MA 01702

SCALE 1"=10'
DATE: JAN 21, 2014
FILE: 3403TP.DWG
DRAWN BY: HS
CHECKED BY: HS

PROPOSED UST SITE PLAN
CFG14.0

MHF PROJECT NO. 340313 SHEET 1 OF 8

